

01 FLOOR PLAN  
 SCALE 3/16"=1'-0"  
 NORTH 1 REF

- ### KEY NOTES
1. CONTRACTOR SHALL DEMOLISH CHWS, CWS, SA AND EXHAUST DUCT CAN OP IN PLACE.
  2. CONTRACTOR SHALL PROVIDE CHWS/R LINES AS INDICATED ON PLAN. CHWS/R SHALL BE EXTENDED ABOVE ROOF AND CONNECT TO WSBP-1, 2, 3 & 4 RESPECTIVELY.
  3. WSBP-1 & 4 SHALL BE PROVIDED WITH ACCESS PANELS TO SERVICE SHUT-OFF VALVES FILTER.
  4. ROUTE COPPER CONDENSATE LINE DOWN IN WALL AND OUT BELOW COUNTER TOP. CONNECT TO TRAIL BRICE WITH APPROVED FITTING.
  5. ROUTE COPPER CONDENSATE LINE DOWN IN WALL AND OUT ABOVE FLOOR SINK WITH CODE COMPLIANT AIR CAP.
  6. SLOPE CONDENSATE DRAIN LINE 1/4" PER FOOT.
  7. CONTRACTOR SHALL PROVIDE 36"x36" ACCESS PANEL.
  8. CONTRACTOR SHALL PROVIDE 36"x36" ACCESS PANEL.
  9. EXISTING HOUSE EXHAUST DUCTWORK.
  10. EXISTING HOUSE DUCT SEE AIR DUCTWORK.
  11. 12" EXHAUST DUCT UP THRU ROOF TO EXHAUST FAN. VERIFY SIZE WITH KITCHEN EQUIPMENT DRAWINGS.
  12. 24" S.A. R. S.A. DUCT THRU ROOF FROM WSBP-2 TRANSITION TO 34" X 12" AND RUN AS REQUIRED IN CEILING SPACE.
  13. 24" X 12" OUTDOOR AIR THROUGH ROOF TO MAU-1.
  14. 24" X 8" MAKE UP AIR SUPPLY DROP TO PLENUM-810 CFM EACH TYPICAL. 3 PLACES. VERIFY SIZE WITH KITCHEN EQUIP. DWGS.
  15. 36"x36" RETURN AIR DUCT UP THROUGH ROOF.
  16. 36"x36" RETURN AIR DUCT UP THROUGH ROOF.
  17. FULL SIZE SUPPLY AND RETURN DUCTWORK UP THROUGH ROOF. KITCHEN HOOD AND SUPPLY PLENUM BY KITCHEN EQUIPMENT CONTRACTOR. METALS BY MECHANICAL CONTRACTOR. REFER TO KITCHEN EQUIPMENT DRAWINGS FOR ADDITIONAL INFORMATION.
  18. 18" X 18" GREASE EXHAUST DUCT RISEN FROM HOOD P.O.C. TO MAIN RISER (FAN LEG). VERIFY SIZE WITH KITCHEN EQUIP. DWGS.
  19. 18" X 18" GREASE EXHAUST DUCT THRU ROOF TO EXHAUST FAN. VERIFY SIZE WITH KITCHEN EQUIP. DWGS.
  20. 24" X 12" GREASE EXHAUST DUCT THRU ROOF TO EXHAUST FAN. VERIFY SIZE WITH KITCHEN EQUIP. DWGS.
  21. 24" X 12" MAKE UP AIR SUPPLY DROP TO PLENUM-1024 CFM EACH. TYPICAL. 3 PLACES. VERIFY SIZE WITH KITCHEN EQUIP. DWGS.
  22. 24" X 8" MAKE UP AIR SUPPLY DROP TO PLENUM-774 CFM EACH. TYPICAL. 3 PLACES. VERIFY SIZE WITH KITCHEN EQUIP. DWGS.
  23. 12" X 12" GREASE EXHAUST DUCT RISEN FROM HOOD P.O.C. TO MAIN RISER (FAN LEG). VERIFY SIZE WITH KITCHEN EQUIP. DWGS.
  24. 18" X 18" GREASE EXHAUST DUCT THRU ROOF TO EXHAUST FAN. VERIFY SIZE WITH KITCHEN EQUIP. DWGS.
  25. 18" X 18" GREASE EXHAUST DUCT THRU ROOF TO EXHAUST FAN. VERIFY SIZE WITH KITCHEN EQUIP. DWGS.
  26. 18" X 18" GREASE EXHAUST DUCT THRU ROOF TO EXHAUST FAN. VERIFY SIZE WITH KITCHEN EQUIP. DWGS.
  27. 18" X 18" GREASE EXHAUST DUCT THRU ROOF TO EXHAUST FAN. VERIFY SIZE WITH KITCHEN EQUIP. DWGS.
  28. 30" X 30" S.A. DUCT THRU ROOF FROM WSBP-3.
  29. 30" X 30" S.A. DUCT THRU ROOF FROM WSBP-4. TRANSITION TO 30" X 16" S.A. AND 30" X 14" R.A. RUN AS REQUIRED IN CEILING SPACE.

- ### GENERAL NOTES
1. THE CONTRACTORS AND SUBCONTRACTORS SHALL BE RESPONSIBLE FOR REVIEW OF THE GENERAL NOTE SPECIFICATIONS AND ALL OTHER DRAWINGS FOR ADDITIONAL REQUIREMENTS WHICH MAY NOT BE SPECIFICALLY CALLED OUT IN THIS PORTION OF THE CONSTRUCTION DOCUMENTS.
  2. THE INSTALLATION SHALL COMPLY WITH AND BE INSTALLED IN ACCORDANCE WITH LOCAL CODES AND THE AUTHORITIES HAVING JURISDICTION.
  3. DRAWINGS AND SPECIFICATIONS GOVERN WHERE THEY EXCEED CODE REQUIREMENTS.
  4. COORDINATE ALL WORK WITH OTHER TRADES AND CONTRACTORS.
  5. DO NOT ROUTE ANY DUCT OVER ELECTRICAL EQUIPMENT.
  6. PROVIDE INSULATED FLEXIBLE DUCT CONNECTIONS TO DIFFUSERS. FLEX DUCT LENGTH NOT TO EXCEED 8'-0".
  7. VERIFY THE EXACT MOUNTING FRAME REQUIRED FOR EACH AIR DEVICE. CONTRACTOR SHALL PROVIDE A MAKE-UP INSTALLATION OF THE LINEAR DIFFUSER AND PLENUM BOX FOR THE DINING AND BAR AREA.
  8. PROVIDE ALL MANUAL BALANCE DAMPERS WITH CONCEALED DAMPER REGULATOR REQUIRED TO BALANCE EACH SYSTEM. SEE DETAILS FOR YOUNG REGULATOR INSTALLATION.
  9. CONTRACTOR SHALL SEAL EXISTING DUCTWORK TO PROVIDE PROPER AIR BALANCE.

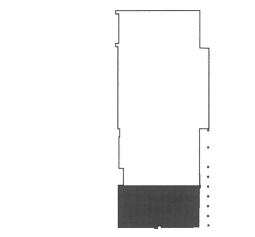

**KEY PLAN**  
 SCALE: N.T.S. REF:

**T.M.A.D.** • STRUCTURAL  
**T.A.I.D.R.G.** • MECHANICAL  
**C.A.I.N.E.S.** • ELECTRICAL  
 1550 East Mesquite Avenue, Suite 100  
 Phoenix, Arizona 85014  
 Phone: 602.971.1133 Fax: 602.971.0775  
 Email: [info@tmaad.com](mailto:info@tmaad.com) Project No: 16110-019



**Tenant Improvement**  
**Dominick's at Scottsdale Quarter - Bldg C**  
 15116 North Scottsdale Road  
 Scottsdale, Arizona 85254

Date	8.12.2010
Revisions	
3.3.2010 CITY COMMENTS	
Project No.	
Sheet	
<b>M100</b>	
FLOOR PLAN	



