



www.greenbergfarrow.com  
 1430 West Peachtree Street, NW  
 Suite 200  
 Atlanta, GA 30309  
 t: 404.601.4000

COPYRIGHT 2021  
 AND AS SUCH REMAINS THE PROPERTY OF  
 CHIPOTLE MEXICAN GRILL, INC. PERMISSION FOR  
 USE OF THIS DOCUMENT IS LIMITED AND CAN BE  
 EXTENDED ONLY BY WRITTEN AGREEMENT WITH  
 CHIPOTLE MEXICAN GRILL, INC.



CHIPOTLE MEXICAN GRILL, INC.  
 PO BOX 182566  
 COLUMBUS, OH 43218-2566  
 TELEPHONE: (614) 318-2482  
 INTERNET: WWW.CHIPOTLE.COM

STORE NO.: 3672  
 NEWTON  
 121 WATER STREET  
 NEWTON, NJ 07860

REV.	DATE	DESCRIPTION
1	10/21/2021	REVISED PERMIT SET

Engineer

ROBERT BLAKE SMITH  
 License No. 24GE05637900  
 Drawn: THOMAS JORDAN  
 Checked: ROSS WATERS

Project No.  
 20191490.0

Contents:  
 CAPTIVEAIRE SHOP  
 DRAWINGS

M400

FOR QUESTIONS, CALL THE  
 Highwoods Group  
 REGION 40  
 PHONE: (919) 875-0420  
 EMAIL: reg40@captivaire.com

PATENT NUMBERS  
 AC-PSP (UNITED STATES) - US PATENT 7963830 B2  
 AC-PSP WALL (CANADA) - CA PATENT 2820509  
 AC-PSP ISLAND (CANADA) - CA PATENT 2520330

**HOOD INFORMATION - JOB#5080020**

HOOD NO.	TAG	MODEL	MANUFACTURER	LENGTH	MAX COOKING TEMP	TYPE	APPLIANCE DUTY	DESIGN CFM/FT	TOTAL EXH CFM	EXHAUST PLENUM RISER(S)				MUA CFM	AC CFM	HOOD CONSTRUCTION	HOOD CONFIG			
										WIDTH	LENG	HEIGHT	DIA				CFM	VEL	SP	END TO END
1		5424	CAPTIVEAIRE	14' 3"	600 DEG	I	HEAVY	225	3200	10"	15"	4"	1600	1536	-0.854"	1950	798	430 SS WHERE EXPOSED	ALONE	ALONE

**HOOD INFORMATION**

HOOD NO.	TAG	FILTER(S)				LIGHT(S)				UTILITY CABINET(S)				FIRE SYSTEM	HOOD HANGING WEIGHT		
		TYPE	QTY	HEIGHT	LENGTH	EFFICIENCY @ 7 MICRONS	QTY	TYPE	WIRE GUARD	LOCATION	SIZE	TYPE	SIZE			ELECTRICAL MODEL #	SWITCHES QUANTITY
1		CAPTRATE SOLID FILTER	10	16"	16"	85% SEE FILTER SPEC	10	L55 SERIES E26	ND	RIGHT	12"x54"x24"	ANSUL R102	3.0/3.0	SC-311110MA	1 LIGHT 1 FAN	YES	1103 LBS

**HOOD OPTIONS**

HOOD NO.	TAG	OPTION
1		FIELD WRAPPER 18.00' HIGH FRONT, RIGHT. FIELD WRAPPER 6.00' HIGH LEFT. RIGHT QUARTER END PANEL 23" TOP WIDTH, 0" BOTTOM WIDTH, 23" HIGH 430 SS. LEFT QUARTER END PANEL 23" TOP WIDTH, 0" BOTTOM WIDTH, 23" HIGH 430 SS. INSULATION FOR BACK OF HOOD. FULL DIMENSION HANGING BRACKET - FRONT.

**PERFORATED SUPPLY PLENUM(S)**

HOOD NO.	TAG	POS	LENGTH	WIDTH	HEIGHT	TYPE	RISER(S)			
							MUA	LENG	DIA	CFM
1		Front	183"	22"	6"		10"	28"	650	0.166"
						MUA	10"	28"	650	0.166"
						AC	10"	28"	650	0.166"
						AC	8"	114	0.041"	
						AC	8"	114	0.041"	
						AC	8"	114	0.041"	
						AC	8"	114	0.041"	
						AC	8"	114	0.041"	
						AC	8"	114	0.041"	

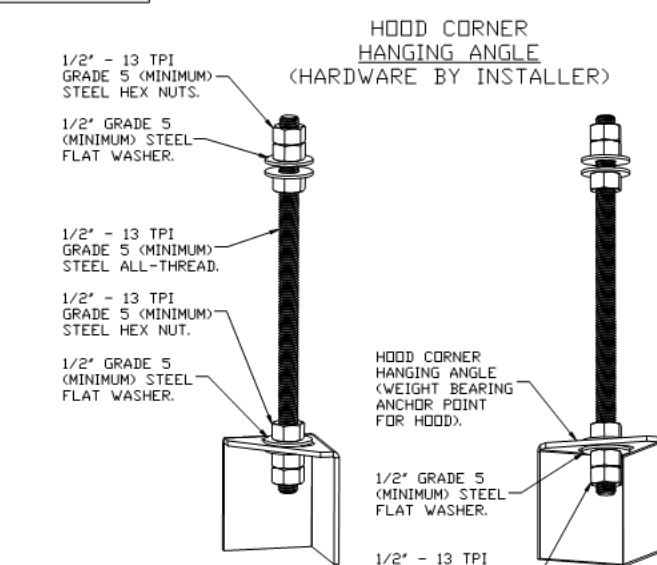

**ASSEMBLY INSTRUCTIONS**

HANGING ANGLE MUST BE SUPPORTED WITH 1/2" - 13 TPI GRADE 5 (MINIMUM) ALL-THREAD, SANDWICH HANGING ANGLES AND CEILING ANCHOR POINTS WITH 1/2" GRADE 5 (MINIMUM) STEEL FLAT WASHERS AND 1/2" - 13 TPI GRADE 5 (MINIMUM) HEX NUTS AS SHOWN. MUST USE DOUBLED HEX NUT CONFIGURATION BENEATH HOOD HANGING ANGLES AND ABOVE CEILING ANCHORS. MAINTAIN 1/4" OF EXPOSED THREADS BENEATH BOTTOM HEX NUT. TORQUE ALL HEX NUTS TO 57 FT-LBS.

**SPECIFICATION: CAPTRATE® GREASE-STOP® SOLID FILTER**

THE CAPTRATE GREASE-STOP SOLID FILTER IS A SINGLE-STAGE FILTER FEATURING A UNIQUE S-Baffle DESIGN IN CONJUNCTION WITH A SLOTTED REAR Baffle DESIGN TO DELIVER EXCEPTIONAL FILTRATION EFFICIENCY.  
 FILTER IS STAINLESS STEEL CONSTRUCTION, AND SIZED TO FIT INTO STANDARD 2-INCH DEEP HOOD CHANNEL(S).  
 UNITS SHALL INCLUDE STAINLESS STEEL HANDLES AND A FASTENING DEVICE TO SECURE THE TWO COMPONENTS WHEN ASSEMBLED.  
 GREASE EXTRACTION EFFICIENCY PERFORMANCE SHALL REMOVE AT LEAST 75% OF GREASE PARTICLES FIVE MICRONS IN SIZE, AND 85% GREASE PARTICLES SEVEN MICRONS IN SIZE AND LARGER, WITH A CORRESPONDING PRESSURE DROP NOT TO EXCEED 1.0 INCHES OF WATER GAUGE.  
 THE CAPTRATE GREASE-STOP SOLID WAS TESTED TO ASTM STANDARD ASTM F2519-05. MANUFACTURER APPROVED FOR USE IN SOLID FUEL APPLICATIONS AS A SPARK ARRESTER.  
 EFFICIENCY VS. PARTICLE DIAMETER  
 PRESSURE DROP VS. FLOW RATE

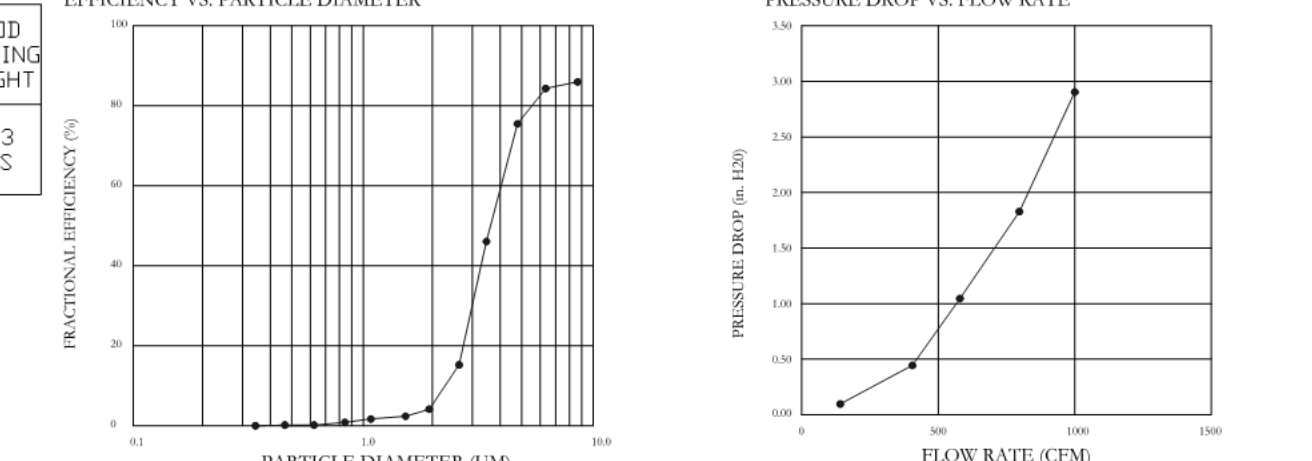

CAPTRATE FILTERS ARE BUILT IN COMPLIANCE WITH:  
 NFPA #96.  
 NSF STANDARD #2.  
 UL STANDARD #1046.  
 INT. MECH. CODE (IMC).  
 ULC-S649.

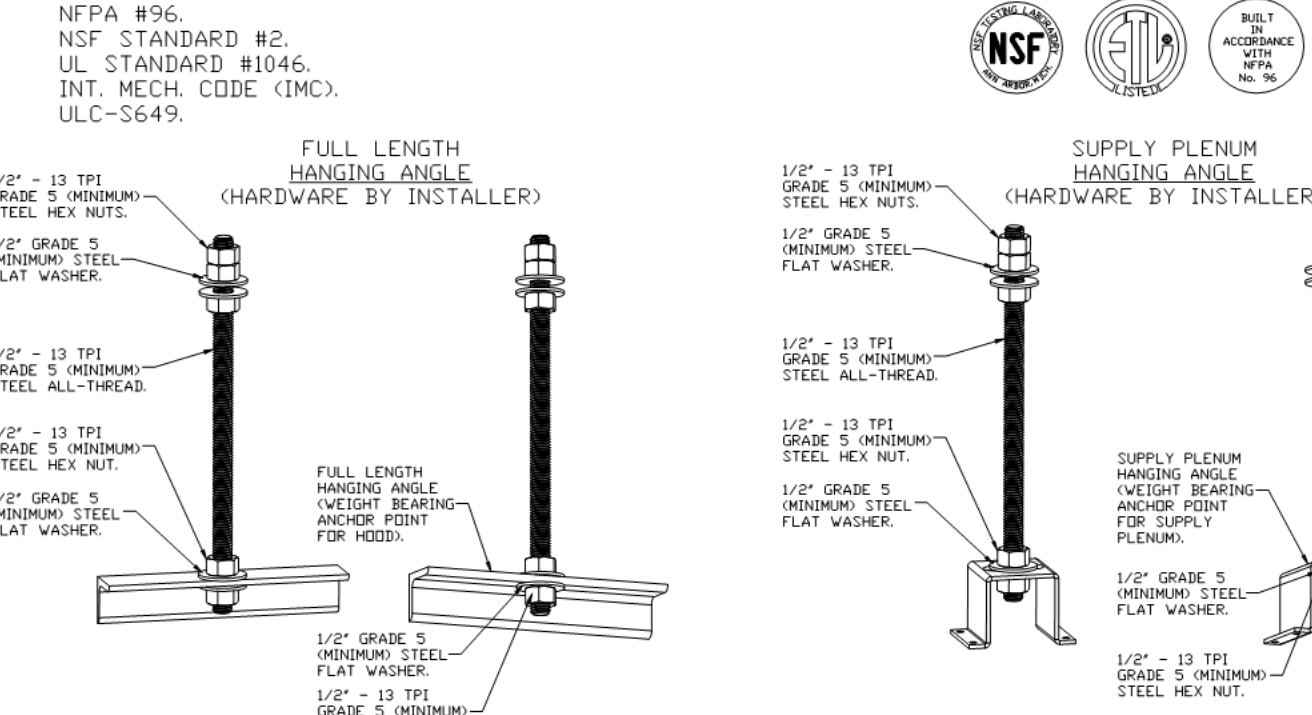

**ASSEMBLY INSTRUCTIONS**

HANGING ANGLE MUST BE SUPPORTED WITH 1/2" - 13 TPI GRADE 5 (MINIMUM) ALL-THREAD, SANDWICH HANGING ANGLES AND CEILING ANCHOR POINTS WITH 1/2" GRADE 5 (MINIMUM) STEEL FLAT WASHERS AND 1/2" - 13 TPI GRADE 5 (MINIMUM) HEX NUTS AS SHOWN. MUST USE DOUBLED HEX NUT CONFIGURATION ABOVE CEILING ANCHORS. SINGLE HEX NUT BENEATH HANGING ANGLE IS ACCEPTABLE FOR FULL LENGTH HANGING ANGLES. MAINTAIN 1/4" OF EXPOSED THREADS BENEATH BOTTOM HEX NUT. TORQUE ALL HEX NUTS TO 57 FT-LBS.

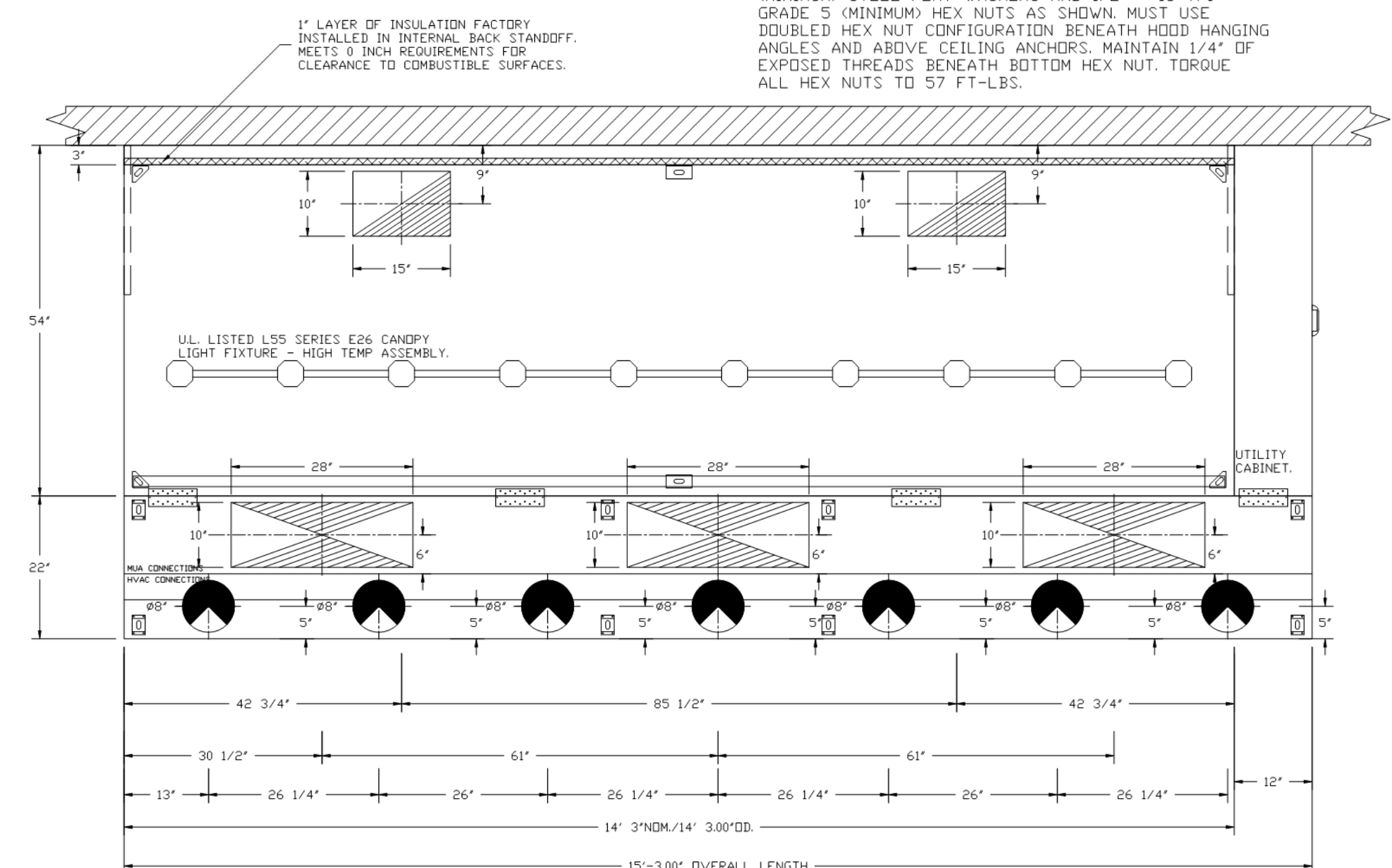

PLAN VIEW - HOOD #1  
 14' 3.00" LONG 5424ND-2-ACSPSP-F  
 NOTE: ADDITIONAL HANGING ANGLES PROVIDED FOR HOODS 12" AND LONGER.  
 ACSPSP SHIPS LOOSE FOR FIELD INSTALLATION

**REVISIONS**

NO.	DESCRIPTION	DATE

**CAPTIVEAIRE**  
 Highwoods Group  
 www.captiveaire.com  
 4641 Paragon Park Rd., Raleigh, Nc. 27616 PHONE: (919) 875-0420 FAX: (919) 875-0577 EMAIL: reg40@captivaire.com

CHIPOTLE NEWTON NJ #3672  
 NEWTON, NJ, 07860

DATE: 9/9/2021  
 DWG.#: 5080020  
 DRAWN BY: JMB-40  
 SCALE: 3/4" = 1'-0"  
 MASTER DRAWING

**SHEET NO.**  
 1

Consultant:



www.greenbergfarrow.com  
 1430 West Peachtree Street, NW  
 Suite 200  
 Atlanta, GA 30309  
 t: 404.601.4000

COPYRIGHT 2021  
 THIS DRAWING IS AN INSTRUMENT OF SERVICE  
 AND AS SUCH REMAINS THE PROPERTY OF  
 CHIPOTLE MEXICAN GRILL, INC. PERMISSION FOR  
 USE OF THIS DOCUMENT IS LIMITED AND CAN BE  
 EXTENDED ONLY BY WRITTEN AGREEMENT WITH  
 CHIPOTLE MEXICAN GRILL, INC..



CHIPOTLE MEXICAN GRILL, INC.  
 PO BOX 182566  
 COLUMBUS, OH 43218-2566  
 TELEPHONE: (614) 318-2482  
 INTERNET: WWW.CHIPOTLE.COM

STORE NO.: 3672

NEWTON  
 121 WATER STREET  
 NEWTON, NJ 07860

REV.	DATE	DESCRIPTION
09/13/2021	LL SET	
10/18/2021	PERMIT SET	
10/21/2021	REVISED PERMIT SET	

Engineer

ROBERT BLAKE SMITH  
 License No. 24GE05637900

Drawn: THOMAS JORDAN  
 Checked: ROSS WATERS

Project No.  
 20191490.0

Contents:  
 CAPTIVEAIRE SHOP  
 DRAWINGS

M403

**EXHAUST FAN INFORMATION - JOB#5080020**

FAN UNIT NO	TAG	QTY	FAN UNIT MODEL #	MANUFACTURER	CFM	ESP	RPM	MOTOR ENCL	HP	BHP	PHASE	VOLT	FLA	DISCHARGE VELOCITY	WEIGHT (LBS)	SDNES
1	EF-1	1	DU240HFA	CAPTIVEAIRE	3200	1.500	861	DDP, PREMIUM	3.000	1.6950	3	208	10.2	727 FPM	298	16.3
2	EF-2	1	DR12HF	CAPTIVEAIRE	150	0.600	1293	TEAD-ECM	0.250	0.0940	1	115	2.9		49	7.2

**MUA FAN INFORMATION - JOB#5080020**

FAN UNIT NO	TAG	QTY	FAN UNIT MODEL #	BLOWER	HOUSING	MIN CFM	DESIGN CFM	ESP	RPM	MOTOR ENCL	HP	BHP	PHASE	VOLT	FLA	MCA	MDCP	WEIGHT (LBS)	SDNES
3	MAU-1	1	A1-D.250-15D	15MF-1-MOD	A1-D.250	1000	1950	0.500	2040	DDP, PREMIUM	2.000	1.3600	3	208	6.1	7.7A	15A	494	21

**GAS FIRED MAKE-UP AIR UNIT(S)**

FAN UNIT NO	TAG	INPUT BTUs	OUTPUT BTUs	TEMP RISE	REQUIRED INPUT GAS PRESSURE	GAS TYPE	BURNER EFFICIENCY(%)
3	MAU-1	146149	134457	66°F	7 IN. W.C. - 14 IN. W.C.	NATURAL	92

**FAN OPTIONS**

FAN UNIT NO	TAG	QTY	DESCRIPTION
1	EF-1	1	GREASE BDX.
		1	REMOVE HINGE KIT LABEL FROM THE FAN BASE.
		1	2 YEAR PARTS WARRANTY.
2	EF-2	1	I 12-BDD DAMPER.
		1	ECM WIRING PACKAGE - MANUAL DR 0-10VDC REFERENCE SPEED CONTROL (TELCO MOTOR), CCW ROTATION.
		1	2 YEAR PARTS WARRANTY.
3	MAU-1	1	MOTORIZED BACKDRAFT DAMPER FOR A1-D HOUSING. MEETS AMCA CLASS 1A RATING.
		1	LOW FIRE START.
		1	INLET PRESSURE GAUGE, 0-35".
		1	MANIFOLD PRESSURE GAUGE, ±5 TO 15" W.C.
		1	SEPARATE 120V WIRING PACKAGE (REQUIRED AND USED ONLY FOR DCV DR PREWIRE WITH VFD) - THREE PHASE ONLY.
1	2 YEAR PARTS WARRANTY.		

**FAN ACCESSORIES**

FAN UNIT NO	TAG	EXHAUST				SUPPLY		
		GREASE CUP	GRAVITY DAMPER	WALL MOUNT	SIDE DISCHARGE	GRAVITY DAMPER	MOTORIZED DAMPER	WALL MOUNT
1	EF-1	YES						
2	EF-2		YES					
3	MAU-1						YES	

**CURB ASSEMBLIES**

NO	DN FAN	TAG	WEIGHT	ITEM	SIZE
1	# 1		43 LBS	CURB	31.500"W X 31.500"L X 20.000"H ALONG LENGTH, RIGHT VENTED.
2	# 2	EF-2	31 LBS	CURB	17.500"W X 17.500"L X 26.000"H .
3	# 3	MAU-1	75 LBS	CURB	21.000"W X 21.000"L X 20.000"H INSULATED.
# 3				RAIL	4.000"W X 4.000"L X 36.000"H ALONG LENGTH, RIGHT.

FAN #1 DU240HFA - EXHAUST FAN (CF-1)

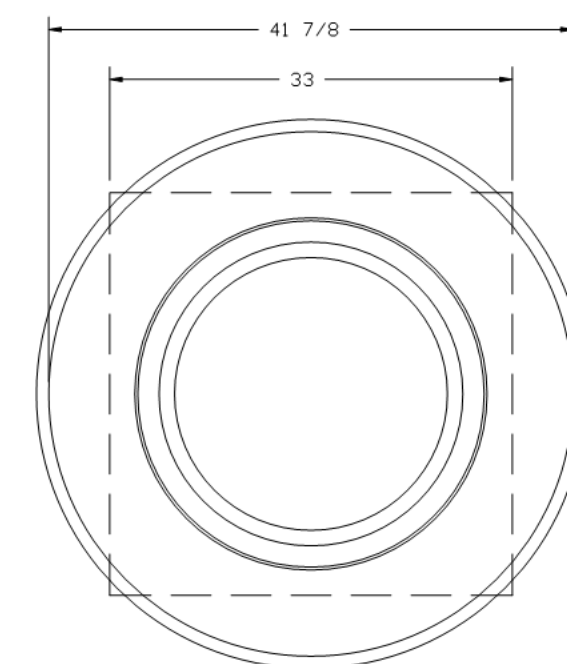
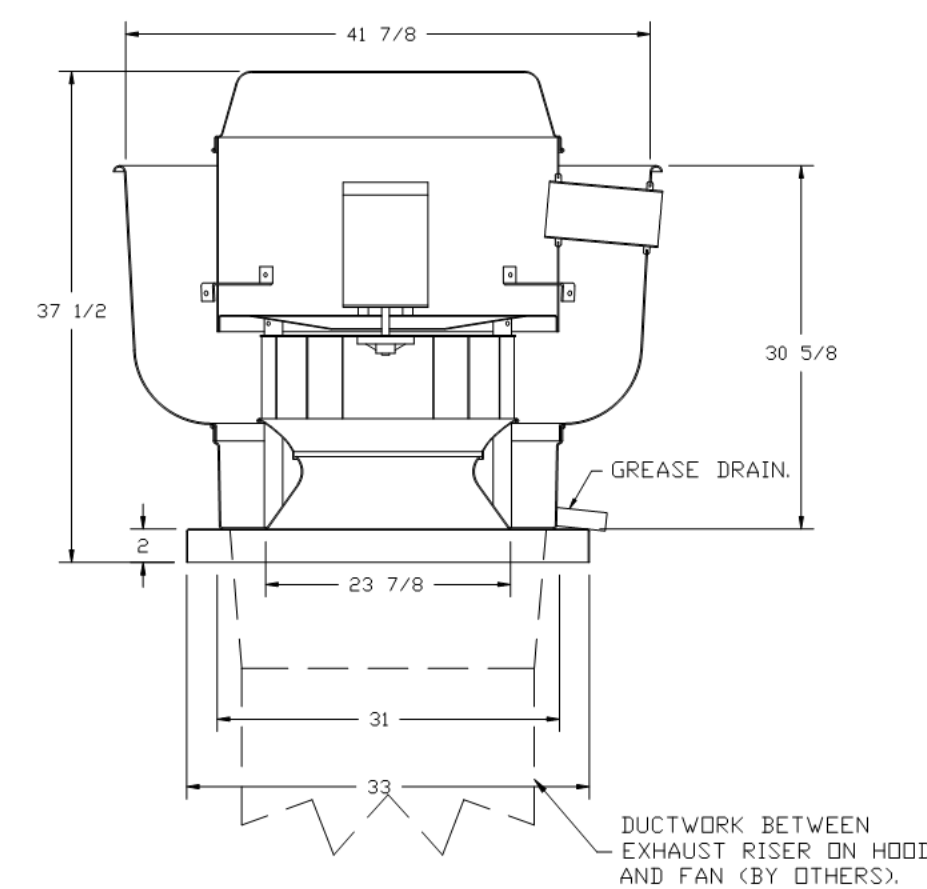

TOP VIEW

**FEATURES:**

- DIRECT DRIVE CONSTRUCTION (NO BELTS/PULLEYS).
- ROOF MOUNTED FANS.
- RESTAURANT MODEL.
- UL705 AND UL762 AND ULC-S645
- VARIABLE SPEED CONTROL.
- INTERNAL WIRING.
- THERMAL OVERLOAD PROTECTION (SINGLE PHASE).
- HIGH HEAT OPERATION 300°F (149°C).
- GREASE CLASSIFICATION TESTING.
- NEMA 3R SAFETY DISCONNECT SWITCH.

**NORMAL TEMPERATURE TEST**

EXHAUST FAN MUST OPERATE CONTINUOUSLY WHILE EXHAUSTING AIR AT 300°F (149°C) UNTIL ALL FAN PARTS HAVE REACHED THERMAL EQUILIBRIUM, AND WITHOUT ANY DETERIORATING EFFECTS TO THE FAN WHICH WOULD CAUSE UNSAFE OPERATION.

**ABNORMAL FLARE-UP TEST**

EXHAUST FAN MUST OPERATE CONTINUOUSLY WHILE EXHAUSTING BURNING GREASE VAPORS AT 600°F (316°C) FOR A PERIOD OF 15 MINUTES WITHOUT THE FAN BECOMING DAMAGED TO ANY EXTENT THAT COULD CAUSE AN UNSAFE CONDITION.

**OPTIONS**

- GREASE BDX.
- REMOVE HINGE KIT LABEL FROM THE FAN BASE.
- 2 YEAR PARTS WARRANTY.

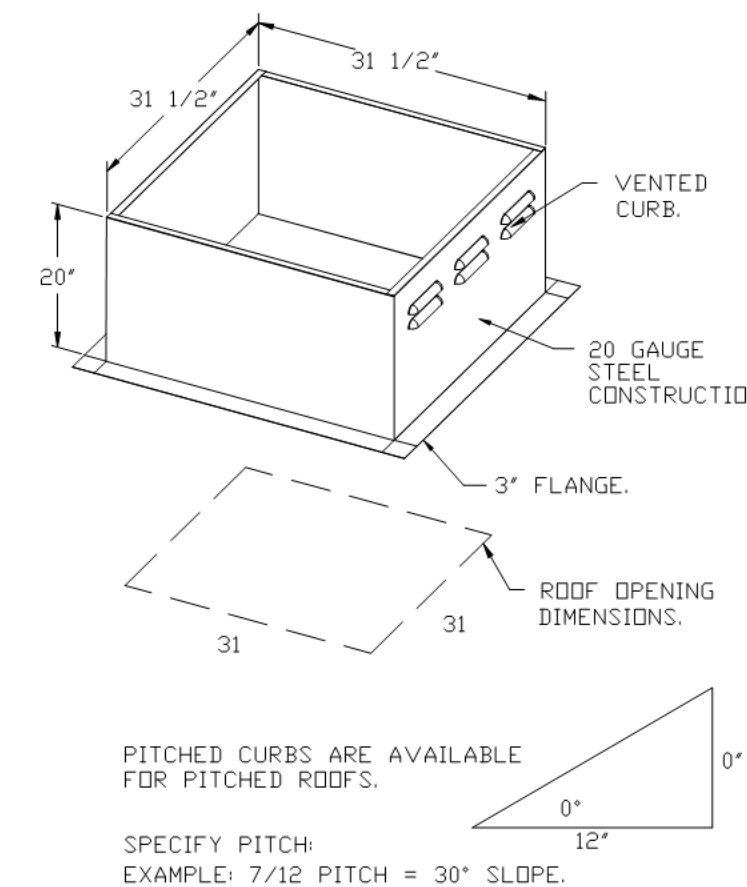

PITCHED CURBS ARE AVAILABLE FOR PITCHED ROOFS.  
 SPECIFY PITCH:  
 EXAMPLE: 7/12 PITCH = 30° SLOPE.

REVISIONS	
DESCRIPTION	DATE



CHIPOTLE NEWTON NJ #3672  
 NEWTON, NJ, 07860

DATE: 9/9/2021  
 DWG.#: 5080020  
 DRAWN BY: JMB-40  
 SCALE: 3/4" = 1'-0"  
 MASTER DRAWING

SHEET NO. 4