

BLOCKING NOTES

REFER TO A2-11 FOR BLOCKING NOTES

GENERAL CONTRACTOR TO PROVIDE ALTERNATE BID FOR LANDLORD OWNED ITEMS THAT WILL REPAIRED/REPLACED.

NOTE: NOTHING TO BE STORED OR STOCKED IN HALLWAY. HALLWAY TO REMAIN CLEAR AND FULLY ACCESSIBLE AT ALL TIMES. THIS INCLUDES STORAGE, TRASH AND DUNNAGE.

KEYNOTES

- 1 4" DIA PVC SLEEVE FOR SODA LINES FROM ABOVE CEILING TO INSIDE CABINET. PROVIDE ONE SLEEVE FOR EACH SODA MACHINE
- 2 REFER TO SANDWICH WALL DETAIL 3/A6-02 & ELEC DWGS FOR MORE INFORMATION
- 3 EXISTING ELECTRICAL PANEL TO REMAIN. SEE (E) SHEETS FOR ADDITIONAL INFO.
- 4 NEW 6" HIGH CONCRETE CURB. SEE INTERIOR ELEVATION FOR ADDITIONAL INFO. - SEE 10/A6-02
- 5 PROPOSED WALL MOUNTED EXTERIOR SIGN, NOT SHOWN. COORDINATE W/ SIGN VENDOR FOR MOUNTING / ELECTRICAL REQ'S & VERIFY FINAL DESIGN. SIGNS TO BE PERMITTED SEPARATELY.
- 6 EXISTING STAINLESS STEEL BEVERAGE CABINET. SEE EQUIPMENT PLAN K1-01, T/ COUNTER TO BE 34" - SEE 5/A6-03
- 7 MANUAL ANSUL PULL STATION FOR HOOD SHALL BE LOCATED 4'-0" A.F.F. & AT LEAST 10'-0" AWAY FROM THE HAZARD IN THE DIRECTION OF THE EXIT TRAVEL. COORDINATE EXACT LOCATION WITH LOCAL FIRE DEPARTMENT. PROVIDE STAINLESS STEEL COVER GUARD FOR THE ANSUL PULL STATION. SEE "HOOD FIRE SUPPRESSION" NOTE ON G3-02.
- 8 EXISTING SHUNT TRIP REQUIRED CIRCUITING LOCATED BENEATH THE HOOD IS EXISTING TO REMAIN. SEE E SHEETS FOR ADDITIONAL INFO.

PLAN GENERAL NOTES

1. EGRESS DOORS SHALL BE READILY OPENABLE FROM THE EGRESS SIDE WITHOUT THE USE OF A KEY OR SPECIAL KNOWLEDGE OR EFFORT.
2. ALL FIRE RATED DOORS TO BE SELF-CLOSING.
3. ALL INTERIOR FINISHES TO BE CLASS A WITH FLAME SPREAD RATING OF 0-25
4. CONTRACTOR IS REQUIRED TO HANG FIVE GUYS INTERIOR SIGN PACKAGE.
5. DO NOT FASTEN STUDS OR GYPSUM BD. TO TOP RUNNER OF NON-BEARING GYP.BD. PARTITIONS. CUT STUDS AND GYP.BD. 1/2" MAX. SHORT TO ALLOW FOR VERTICAL SLAB DEFLECTION.
6. ALL DIMENSIONS TO BE FINISHED SURFACE UNO.
7. GC TO COORDINATE ALL CEILING HEIGHTS WITH BUILDING SYSTEMS. OWNER TO APPROVE ALL CEILING HEIGHTS. BEFORE INSTALLATION.
8. THE ARCHITECT WILL NEITHER HAVE CONTROL OVER OR CHARGE OF, NOR BE RESPONSIBLE FOR, THE CONSTRUCTION MEANS, METHODS, TECHNIQUES, SEQUENCES OR PROCEDURES, OR FOR THE SAFETY PRECAUTIONS AND PROGRAMS IN CONNECTION WITH THE WORK, SINCE THESE ARE SOLELY THE CONTRACTOR'S RIGHTS AND RESPONSIBILITIES.
9. TEMPERED GLASS: ALL GLAZED DOORS, ANY GLAZED PANEL ADJACENT TO ANY DOOR & ANY GLAZED PANEL WHICH MEETS ALL OF THE FOLLOWING CONDITIONS SHALL ALL BE TEMPERED:
 - A. EXPOSED AREA OF AN INDIVIDUAL PAIN GREATER THAN 9 S.F.
 - B. EXPOSED BOTTOM EDGE LESS THAN 18" A.F.F.
 - C. EXPOSED TOP EDGE GREATER THAN 36" A.F.F.
 - D. ONE OR MORE WALKING SURFACE(S) WITHIN 36" HORIZONTALLY OF THE PLANE OF THE GLAZING.

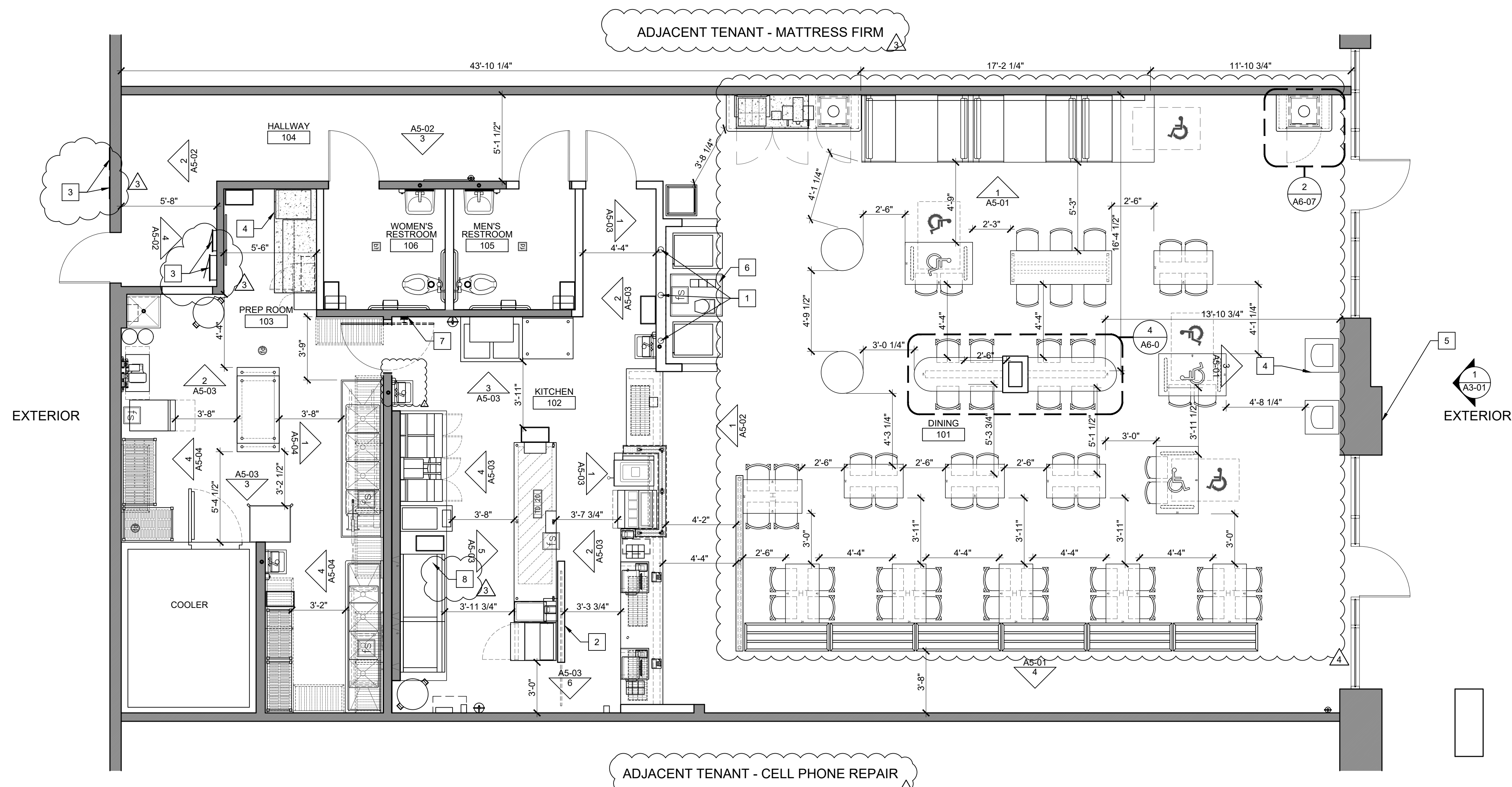

- ### LEGEND
- NEW INSULATION IN WALL, REFER TO PARTITION SCHEDULE FOR SPEC
 - NEW PARTIAL HEIGHT WALL W/ SST CAP
 - NEW COUNTERTOP WALL
 - NEW METAL STUD WALL, A2-11 FOR WALL TYPE
 - EXISTING WALL FRAMING W/ NEW FINISHES, SEE FINISH PLAN

1 FLOOR PLAN
1/4"=1'-0"

Municipal Approval Stamps

FIVE GUYS®
10718 RICHMOND HIGHWAY
LORTON, VA 22079

Client

THESE DRAWINGS AND SPECIFICATIONS ARE THE CONFIDENTIAL AND PROPRIETARY PROPERTY OF FIVE GUYS ENTERPRISES, LLC AND SHALL NOT BE COPIED OR REPRODUCED WITHOUT WRITTEN AUTHORIZATION.

PABLO CREEK PLAZA
STORE # FL-329
3267 HODGES BLVD, SUITE 6
JACKSONVILLE, FL 32224

Project

BIG RED ROOSTER
a JLL company
398 S. MILL AVE, SUITE 201
TEMPE, AZ 85281
480.626.6304 | www.bigredrooster.com

DAVID A. UDKOW, ARCHITECT
11881 N. 113th WAY
SCOTTSDALE, AZ 85259
480.614.3385 PH
480.614.0209 FAX
davidudkow@cox.net EMAIL

Architect of Record

Consultant

Rev	Description	Date
4	CLIENT COMMENTS	06-20-18
3	CITY COMMENTS	02-26-18
2	HEALTH COMMENTS	02-02-18
1	CITY COMMENTS	01-02-18
	PERMIT/BIDDING/ LL REVIEW	11-08-17

Seal

PERMIT/ BIDDING/ LL REV

Store Number FGO-314

Approved BRR

Title

FLOOR PLAN

Sheet

A2-12