

**HVAC Submittal 230500-06**

- NO EXCEPTION       NO EXCEPTION  
AS CORRECTED
- AS NOTED BELOW     REVISE AND RESUBMIT

Checking is only for conformance with the design concept of the Project. Contractor is responsible for dimensions to be confirmed and correlated at the job site; for electrical characteristics; for information that pertains solely to the fabrication processes or to techniques of construction; and for coordination of the work of all trades. Approval of items does not relieve the contractor from complying with all requirements of the Contract Document.

Swyger & Associates - Consulting Engineers  
By Bill Junpsta  
Date 8/18/23

- 1. Dishwasher Fan by Cook: No Exception As Corrected**
  - An adapter roof curb is required to sit on the old RTU curb.**

**Mechanical Engineer assumes no responsibility for sizes or quantities, Contractor to verify sizes and counts.**  
**Mechanical Engineer assumes no responsibility for voltage, Contractor to verify proper voltage before ordering.**



# SUBMITTAL COVER SHEET

**Job Name/Number:** Bethany Elementary School – Job #2302002

**Date:** 8/8/2023

**Submittal #:** 230500-07

**Subcontractor/Vendor:** Action Mechanical  
*Kitchen Scope Exhaust Fan PD*

**Description:** \_\_\_\_\_

<b>Submittal Type:</b>	<u>                    </u> <b>Shop Drawings</b>	<u>                    </u> <b>Sample</b>
	<u>                    </u> <b>Product Data</b>	<u>                    </u> <b>Color Chart</b>
	<u>                    </u> <b>Test Report</b>	<u>                    </u> <b>Other</b>

Please complete the following information; if not applicable, please mark as "N/A":

**\*Color/Finish Selections Required:** \_\_\_\_\_

**\*Lead Time from Approval:** \_\_\_\_\_

**\*Electrical Requirements:** \_\_\_\_\_

**SHELCO, LLC**

WE HEREBY STATE THAT THIS DOCUMENT HAS BEEN REVIEWED FOR CONFORMANCE WITH THE DESIGN CONCEPT AND GENERAL COMPLIANCE WITH THE CONTRACT DOCUMENTS. THIS IN NO WAY RELEASES THE SUBCONTRACTOR / SUPPLIER FROM HIS RESPONSIBILITY TO ADHERE TO THE REQUIREMENTS OF THE CONTRACT DRAWINGS AND SPECIFICATIONS, INCLUDING ALL DIMENSIONS, QUANTITIES, AND PERFORMANCE CRITERIA.

           NO EXCEPTIONS TAKEN

  X   EXCEPTIONS NOTED

           EXCEPTIONS NOTED – RESUBMIT

           REJECTED

           REJECTED – NOT REVIEWED

           INFORMATION/CONFIRMATION

BY:   TM  

DATE:   8/8/2023  

**Architect/Engineer Stamp**



**SUBMITTAL**

**PROJECT:** BETHANY ELEMENTARY SCHOOL– KITCHEN  
ADDITION  
CLOVER, SC

**ENGINEER:** SWYGERT & ASSOCIATES CONSULTING  
ENGINEERS  
COLUMBIA, SC

**CONTRACTOR:** ACTION MECHANICAL CONTRACTORS, INC.  
CHARLOTTE, NC

**EQUIPMENT:** EXHAUST FANS BY LOREN COOK

**SUPPLIER:** HAHN-MASON AIR SYSTEMS, INC.  
4901 DWIGHT EVANS ROAD, STE. 120  
CHARLOTTE, NORTH CAROLINA 28217

**SUBMITTED BY:**

A handwritten signature in black ink that reads "David Petrovski". The signature is written in a cursive style and is positioned above a horizontal line.

David Petrovski

Per the fan schedule  
on dwg M001, exhaust  
fan EF-2 DW is to be  
interlocked with  
dishwasher fan control.  
See note #4

HAHN-MASON AIR SYSTEMS, INC.  
P.O. BOX 31248  
CHARLOTTE, NC 28231-1248

Telephone: 704-523-5000  
Fax: 704-523-5171  
08/04/2023 3:23 PM



**COOK**  
c UL US



MARK: EF-2 DW

PROJECT: BETHANY ELEMENTARY - KITCHEN ADDITI...

DATE: 8/4/2023

# ACED-EC

**Downblast Centrifugal Exhaust Ventilator  
Roof Mounted/Direct Drive**

**Electronically Commutated Vari-Flow® Motor**

**STANDARD CONSTRUCTION FEATURES:**

All aluminum housing - Backward inclined all aluminum wheel - Two piece top cap with stainless steel quick release latches (sizes 101 - 135) - Welded curb cap corners - Birdscreen - Permanently lubricated ball bearing electronically commutated motor - Power rated in Input Watts - Corrosion resistant fasteners - Transit tested packaging.

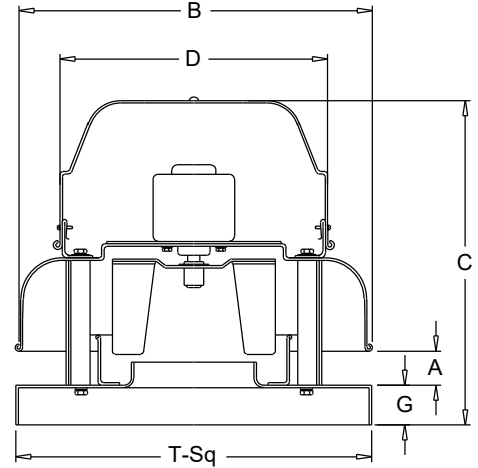

**Performance**

Qty	Catalog Number	Flow (CFM)	SP (inwc)	Fan RPM	Input Watts	FEG	FEI	Speed Control
1	100C17DEC	600	.500	1668	133	n/a(<1HP)	1.88	EC

Altitude (ft): 768 Temperature (F): 70

**Motor Information**

HP	RPM	Volts/Ph/Hz	Enclosure
1/4	1725	115/1/60	OPEN -EC



Motor is electronically/thermally protected.

**Sound Data Inlet Sound Power by Octave Band**

1	2	3	4	5	6	7	8	LwA	dBA	Sones
64	78	75	64	62	56	50	45	70	58	9.0

- Distance from Sound source 5 ft

**Accessories:**

- FAN MOUNTED SPEED CONTROL
- DISCONNECT NEMA 1 PRE-WIRED
- BD-12 DAMPER
- ROOF CURB RCG 16 13.5H -C+T+N

**Dimensions (inches)**

A	2-1/2
B O.D.	18-3/4
C	16-13/16
D O.D.	16-3/4
G	2
T Sq.	18
Roof Open. Sq.*	13-1/2

NOTE: Accessories may affect dimensions shown.

Weight(lbs)***	Shipping	60	Unit	52
----------------	----------	----	------	----

\* Roof opening size for curbs supplied by Cook only.

\*\*\*Includes fan, motor & accessories.

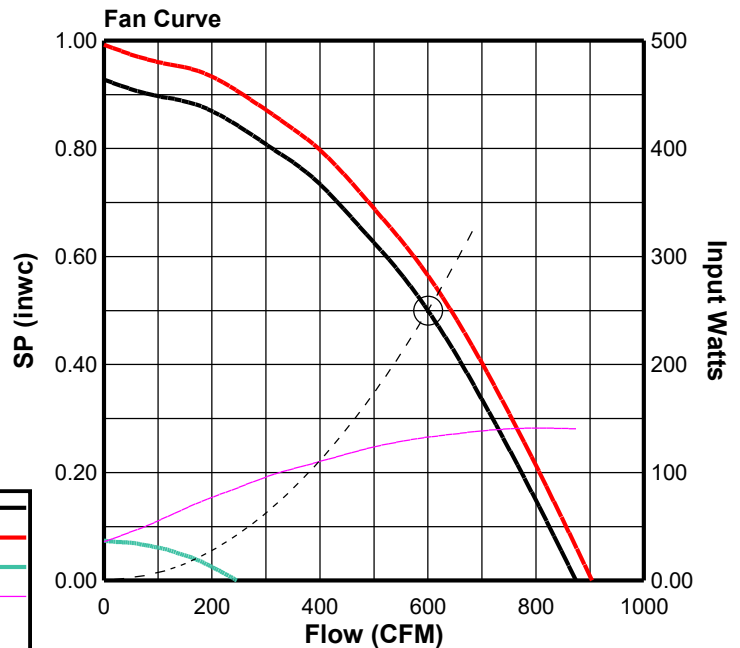



## Speed Control

Internal Speed Control  
Electronically Commutated (EC) Motor  
Type M

### STANDARD CONSTRUCTION FEATURES:

Integral potentiometer with slotted screw for speed adjustment.

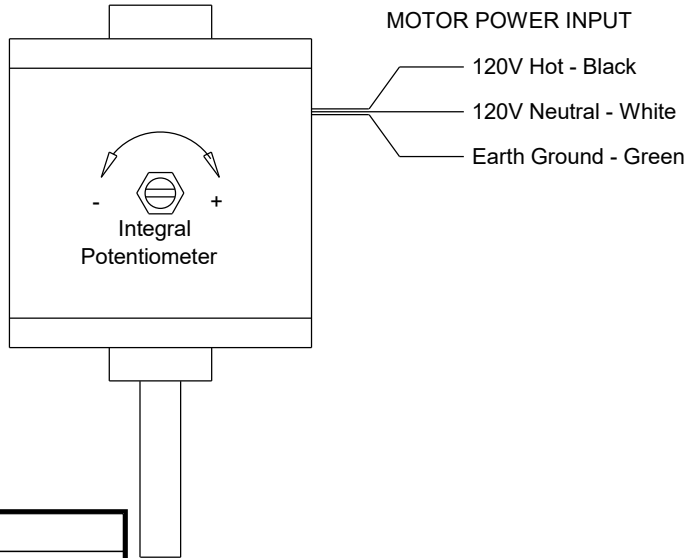

### Dimensions (inches)

Mark	Qty	Description
EF-2 DW	1	OPEN -1/4HP - 115V/1 PH/ 60 1725/0000 -EC



## BD

### Gravity Backdraft Damper

#### STANDARD CONSTRUCTION FEATURES:

.020 Aluminum blades - .060 aluminum frame -  
Aluminum hinge pins - Nylon bushings.

#### Notes:

Max. operating temperature 200 Deg F (95 Deg C).

Max. discharge velocity 2000 fpm.

Sizes 36 thru 60 are shipped as 2 panels.

Sizes 66 and 78 are shipped as 6 panels.

These may require assembly.

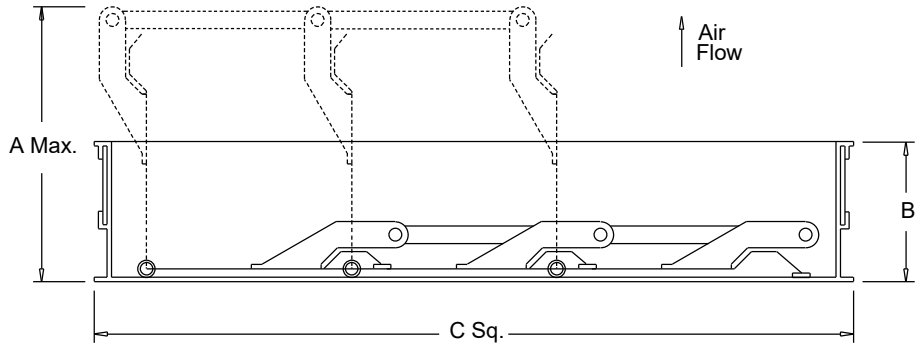

#### Dimensions (inches)

Mark	Qty	Description	A Max.	B	C Sq.	# Panels
EF-2 DW	1	BD-12 DAMPER	5-3/16	1-7/8	11-3/4	1



# RCG

## Galvanized Steel Roof Curb

### STANDARD CONSTRUCTION FEATURES:

18 gauge galvanized steel - 1-1/2",  
 3 lbs. density thermal and acoustical insulation - Continuously welded corners - Wood nailer.

### Options:(As noted below\*)

- 1) No wood nailer (deduct 1-1/2" for actual height).
- 2) Damper tray.
- 3) Liner.
- 4) Gasket on wood nailer.
- 5) Lorenized coating.
- 6) Enamel coating.
- 7) Burglar bars.

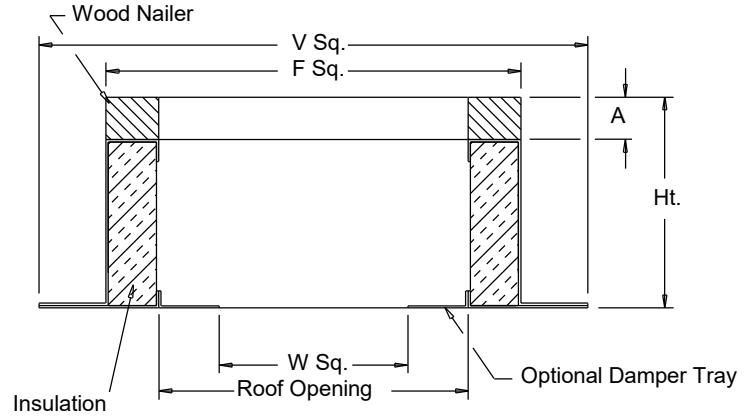

### Dimensions (inches)

Mark	Qty	Description	Ht	Options*	A	F Sq.	V Sq.	W Sq.	Roof Opening
EF-2 DW	1	RCG 16	13.5	2;	1-1/2	16-1/2	20-1/2	9-3/4	13-1/2