



SARPINO'S RICHMOND CENTER - SAINT LOUIS MO

CheckList Information

Name :	PRE-LEASE/DESIGN SITE CONDITIONS	Status :	Not Completed
Assigned Organization :	National TAB	Asset :	
Requesting Organization :	National TAB		
Created Date :	08/20/2024 - Dan Hertenstein - National TAB		

CheckList Item Details

INTERIOR PHOTO SET 1

Comment:

INTERIOR PHOTO SET 2

Comment:

INTERIOR PHOTO SET 3

Comment:

FRONT BUILDING PHOTO SET

Comment:

REAR BUILDING PHOTO SET

Comment:

EXISTING ROOF TOP PACKAGE DETAILS

Comment:

- [Open](#) HVAC_Suite_6554_168089735
08/20/2024

EXISTING ROOF TOP PLAN VIEW

Comment:

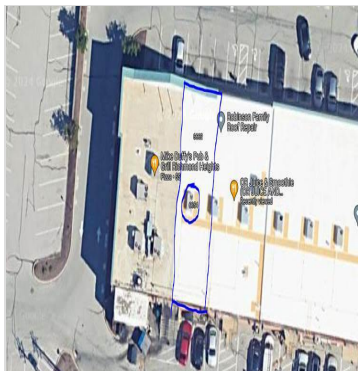

**SARPINO_S_STL_ROOF_
PIC_2_1777921294
08/20/2024**

GAS METER - CURRENT GAS LINE SIZE TO ROOF

Comment:

GAS METER DETAILS

Comment:

GAS METER DISTANCE TO BOH DOOR ENTRANCE TO SARPINO'S

Comment:

EXISTING ELECTRICAL PANEL MAKE, MODEL, VOLT AND AMP RATING

Comment:

PICTURE OF ELECTRICAL PANEL LINE CARD, AMP BREAKERS

Comment:

ARE THERE ANY SLAVE PANELS, IF SO - LIST THE SLAVE PANELS MAKE, MODEL, VOLT AND AMP RATING AND TAKE PICTURES OF THE INTERIOR PANEL BREAKERS AND LINE CARD

Comment:

WATER HEATER MAKE, MODEL, GPM CAPACITY AND BTUH. TAKE PHOTO'S OF UNIT

Comment:

Does the space have sprinkler heads, if so create a layout of the head locations within the space

Comment:

Notate where the fire alarm panel is, make, model and distance from the space.

Comment:

Does the current space have a tie in to the building alarm fire panel for RTU smoke and hood fire detection?

Comment:

Are the demising walls fully sheetrocked and fire caulked to the ceiling. If possible create a small hole to determine if it is one or two layers of rockboard installed.

Comment:

What is the structural trusses form from (steel, wood, concrete, etc)

Comment:

What is the center to center spacing between trusses

Comment:

Do the trusses run from front to back or side to side, is there a center support beam located in the space, draw truss plan to show it's layout

Comment:

What is the ceiling height, what is the roof deck height

Comment:

Is there an existing restroom, create layout to show it's location

Comment:

Take dimensions and photo's of any existing restrooms

Comment:
