

- GENERAL NOTES:**
- SEE PIPING PLANS FOR CONDENSATE AND VRF PIPING.
- KEYNOTES:**
- ROUTE 6" FLUE VENT FROM WATER HEATER CONNECTION UP THRU ROOF ABOVE. FLUE VENT SHALL BE CONSTRUCTED OF SCHEDULE 40 SOLID PVC PIPE. INSTALL VENT PER MANUFACTURER INSTRUCTIONS. ANY HORIZONTAL RUNS SHALL SLOPE BACK TOWARDS WATER HEATER AT A MINIMUM OF 1/4 INCH PER LINEAR FOOT.
  - ROUTE 6" COMBUSTION AIR VENT FROM WATER HEATER CONNECTION TO EXTERIOR WALL AS SHOWN. PROVIDE ANGLED WALL CAP WITH WIRE MESH SCREEN AT VENT TERMINATION. MAINTAIN A MINIMUM OF 1" BETWEEN EACH TERMINATION. INSTALL VENT PER MANUFACTURER INSTRUCTIONS.
  - GAS-FIRED WATER HEATER. SEE PLUMBING DRAWINGS FOR MORE INFORMATION. TYPICAL.
  - PROVIDE GEAR TYPE VOLUME DAMPER WITH MEMORY STOPS. YOUNG REGULATOR OR EQUAL. THIS IS TYPICAL FOR ALL STAIR PRESSURIZATION VOLUME DAMPERS.
  - PROVIDE 2-HR FIRE WRAP FROM THE SHAFT PENETRATION TO ROOF PENETRATION.
  - 30"x20" EA UP TO KEF-R01 ON ROOF ABOVE. TRANSITION DUCT TO MATCH FAN CONNECTION SIZE.
  - 12"x12" EA UP TO KEF-R02 ON ROOF ABOVE. TRANSITION DUCT TO MATCH FAN CONNECTION SIZE.
  - 20"x20" EA UP TO KEF-R03 ON ROOF ABOVE. TRANSITION DUCT TO MATCH FAN CONNECTION SIZE.
  - TYPE 1 KITCHEN HOOD. SEE FOOD SERVICE DRAWINGS FOR HOOD INFORMATION. SIZE AND BALANCE ALL EXHAUST DUCT AND MAKE-UP DUCT CONNECTIONS PER FOOD SERVICE PLANS.
  - 16"x16" SA DN FROM MAJ-R01 ON ROOF ABOVE.
  - 16"x16" SA DN FROM MAJ-R01 ON ROOF ABOVE.
  - PROVIDE SINGLE CONTROLLER EQUAL TO MODEL PASCR165 FOR THE CONTROL OF ALL FOUR PATIO HEATERS.
  - DISHWASHER EXHAUST DUCT SHALL BE ALUMINUM CONSTRUCTION AND SLOPE TOWARDS DISHWASHER CONNECTIONS. DISHWASHER CONNECTIONS TO WAREWASHER BY KITCHEN CONSULTANT. SEE FOOD SERVICE PLANS.
  - SMOKE DETECTOR WIRED TO SHUT DOWN VRF INDOOR UNIT UPON DETECTION OF SMOKE. SMOKE DETECTOR PROVIDED BY FIRE ALARM. SEE FIRE ALARM DRAWINGS FOR EXACT LOCATION.

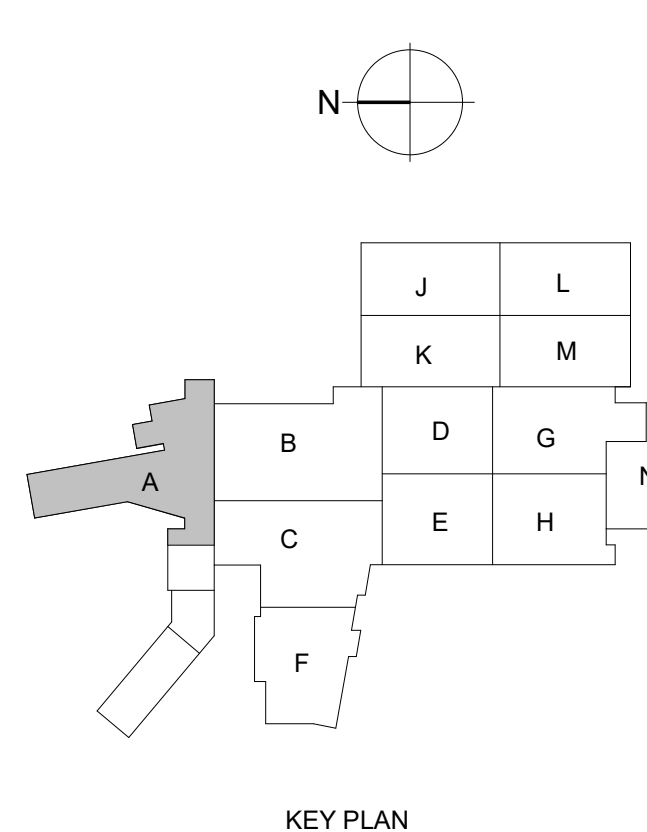

KEY PLAN

**BULLETIN 28**  
 03/29/2024

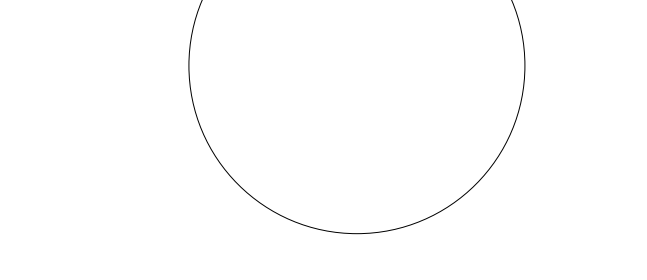

PIC (PS)	DL (CF)
PM (SP)	DTL (KB)
ISSUE	01/31/2023
JOB	30611.00
DRAWN	MWM
SCALE	As indicated

REVISIONS

5	2023-0214	BULLETIN 01
6	2023-0315	BULLETIN 02
10	2023-0427	BULLETIN 06
28	2024-0125	BULLETIN 22
31	2024-0229	BULLETIN 28

1 HVAC DUCTWORK - TWELFTH FLOOR LEVEL  
 1/8" = 1'-0"



