

COPYRIGHT 2025. ALL DRAWINGS AND SPECIFICATIONS SHALL REMAIN THE PROPERTY OF ANNEX ENGINEERING GROUP AND MAY NOT BE USED, DUPLICATED OR ALTERED WITHOUT THE WRITTEN CONSENT OF THE ENGINEER.

CAVA
 CAVA #580 - WILLOWBROOK, IL
 7135 KINGERY HIGHWAY
 WILLOWBROOK, IL 60527
 FOR CAVA
 14 Ridge Square NW #500, WASHINGTON, DC 20016

PROJECT NUMBER:
CAV152
 ISSUE DATE
 PERMIT SET 12.20.2024
 REVISION 1 01.31.2025
 REVISION 2 03.31.25
 CAPTIVE AIR HOOD DRAWINGS FOR REFERENCE ONLY
 SHEET:

H1.1

CAPTIVE
 Maryland Mechanical
 8120 Woodmont Avenue, Suite 720, Bethesda, MD, 20814 PHONE: (800) 988-0881 FAX: 9192275931 EMAIL: reg76@captiveaire.com

Cava - Willowbrook, IL
 7135 Kingery Highway,
 Willowbrook, IL, 60527

DATE: 12/11/2024
 DWG.#: 7217865
 DRAWN BY: AJP-32
 SCALE: 3/4" = 1'-0"
MASTER DRAWING
 SHEET NO. 1

REVISIONS	
DESCRIPTION	DATE

FOR QUESTIONS, CALL THE
 Maryland Mechanical
 REGION 76
 PHONE: (800) 988-0881
 EMAIL: reg76@captiveaire.com

PATENT NUMBERS
 AC-PSP (UNITED STATES) - US PATENT 7963830 B2.
 AC-PSP WALL (CANADA) - CA PATENT 2820509.
 AC-PSP ISLAND (CANADA) - CA PATENT 2520330.

HOOD INFORMATION - JOB#7217865

HOOD NO	TAG	MODEL	MANUFACTURER	LENGTH	MAX COOKING TEMP	TYPE	APPLIANCE DUTY	DESIGN CFM/FT	TOTAL EXH CFM	EXHAUST PLENUM RISER(S)				MUA CFM	AC CFM	HOOD CONSTRUCTION	HOOD CONFIG			
										WIDTH	LENG	HEIGHT	DIA				CFM	VEL	SP	END TO END
1		6030 ND-2-AC-PSP-F	CAPTIVEAIRE	11' 7"	600 DEG	I	HEAVY	200	2317		4"	16"	2317	1659	-0.765"	1854	926	430 SS WHERE EXPOSED	ALONE	ALONE

HOOD INFORMATION

HOOD NO	TAG	TYPE	FILTER(S)				LIGHT(S)				UTILITY CABINET(S)				FIRE SYSTEM PIPING	HOOD HANGING WEIGHT	
			QTY	HEIGHT	LENGTH	EFFICIENCY @ 7 MICRONS	QTY	TYPE	WIRE GUARD	LOCATION	SIZE	TYPE	SIZE	ELECTRICAL MODEL #			SWITCHES QUANTITY
1		CAPTRATE SOLO FILTER	8	20"	16"	85% SEE FILTER SPEC	6	L55 SERIES E26	NO	LEFT	12"x60"x30"	TANK FS	4.0/4.0	DCV-1111	1 LIGHT 1 FAN	YES	1152 LBS

HOOD OPTIONS

HOOD NO	TAG	OPTION
1		FIELD WRAPPER 10.00" HIGH FRONT, LEFT. RIGHT END STANDOFF (FINISHED) 1" WIDE 60" LONG INSULATED. INSULATION FOR BACK OF HOOD. LEFT VERTICAL END PANEL 27" TOP WIDTH, 21" BOTTOM WIDTH, 80" HIGH INSULATED 430 SS.

PERFORATED SUPPLY PLENUM(S)

HOOD NO	TAG	POS	LENGTH	WIDTH	HEIGHT	TYPE	RISER(S)				
							WIDTH	LENG	DIA	CFM	SP
1		Front	152"	22"	6"	MUA	8"	36"		618	0.171"
						MUA	8"	36"		618	0.171"
						MUA	8"	36"		618	0.171"
						AC	8"	26"		463	0.113"
						AC	8"	26"		463	0.113"

GREASE DUCT & CHIMNEY SPECIFICATIONS:
 PROVIDE GREASE DUCT EQUAL TO CAPTIVEAIRE SYSTEMS MODEL "DW" ROUND 20 GAUGE 430 STAINLESS STEEL DUCTWORK. MODEL "DW" IS LISTED TO UL-1978 AND IS INSTALLED USING "V" CLAMP LOCKING CONNECTIONS SEALED WITH 3M FIRE BARRIER 2000 PLUS. MODEL "DW" DOES NOT REQUIRE WELDING PROVIDING IT HAS BEEN INSTALLED PER THE MANUFACTURES INSTALLATION GUIDE.
 PROVIDE RATED ACCESS DOORS AT EVERY CHANGE IN DIRECTION AND EVERY 12' ON CENTER. PER MANUFACTURES LISTING MODEL "DW" HORIZONTAL RUNS LESS THAN 75 FT. CAN BE SLOPED 1/16" PER 12", HORIZONTAL RUNS MORE THAN 75 FT. CAN BE SLOPED 3/16" PER 12".
 DUCT SHOULD BE SLOPED AS MUCH AS POSSIBLE TO REDUCE THE CHANCE OF GREASE ACCUMULATION IN HORIZONTAL RUNS.
 IF THE DUCT OR CHIMNEY IS WITHIN 18 INCHES OF COMBUSTIBLE MATERIAL, PROVIDE UL-2221 OR UL-103 HT LISTED DOUBLE WALL GREASE DUCT OR DOUBLE WALL CHIMNEY EQUAL TO CAPTIVEAIRE SYSTEMS MODEL "DW- 2R, 2R TYPE HT, 3R, OR 3Z" ROUND 20 GAUGE 430 STAINLESS INNER DUCT INSULATED WITH A 24 GAUGE 430 STAINLESS OUTER SHELL.

CAPTIVEAIRE SYSTEMS RECOMMENDS THE USE OF LISTED, PRE-FABRICATED ROUND GREASE EXHAUST DUCT TO REDUCE STATIC PRESSURE IN THE SYSTEM, MINIMIZE INSTALLATION AND INSPECTION TIMES, AND ENSURE DUCT IS LIQUID TIGHT

HVAC DISTRIBUTION NOTE
 HIGH VELOCITY DIFFUSERS OR HVAC RETURNS SHOULD NOT BE PLACED WITHIN TEN (10) FEET OF THE EXHAUST HOOD. PERFORATED DIFFUSERS ARE RECOMMENDED.

VERIFY CEILING HEIGHT
 _____' - _____"
 HEIGHT REQUIRED TO VERIFY THAT HOOD FITS SPACE AND TO SIZE THE ENCLOSURE PANELS

CUSTOMER APPROVAL TO MANUFACTURE:
 APPROVED AS NOTED
 APPROVED WITH NO EXCEPTION TAKEN
 REVISE AND RESUBMIT
 SIGNATURE _____
 YOUR TITLE _____ DATE _____

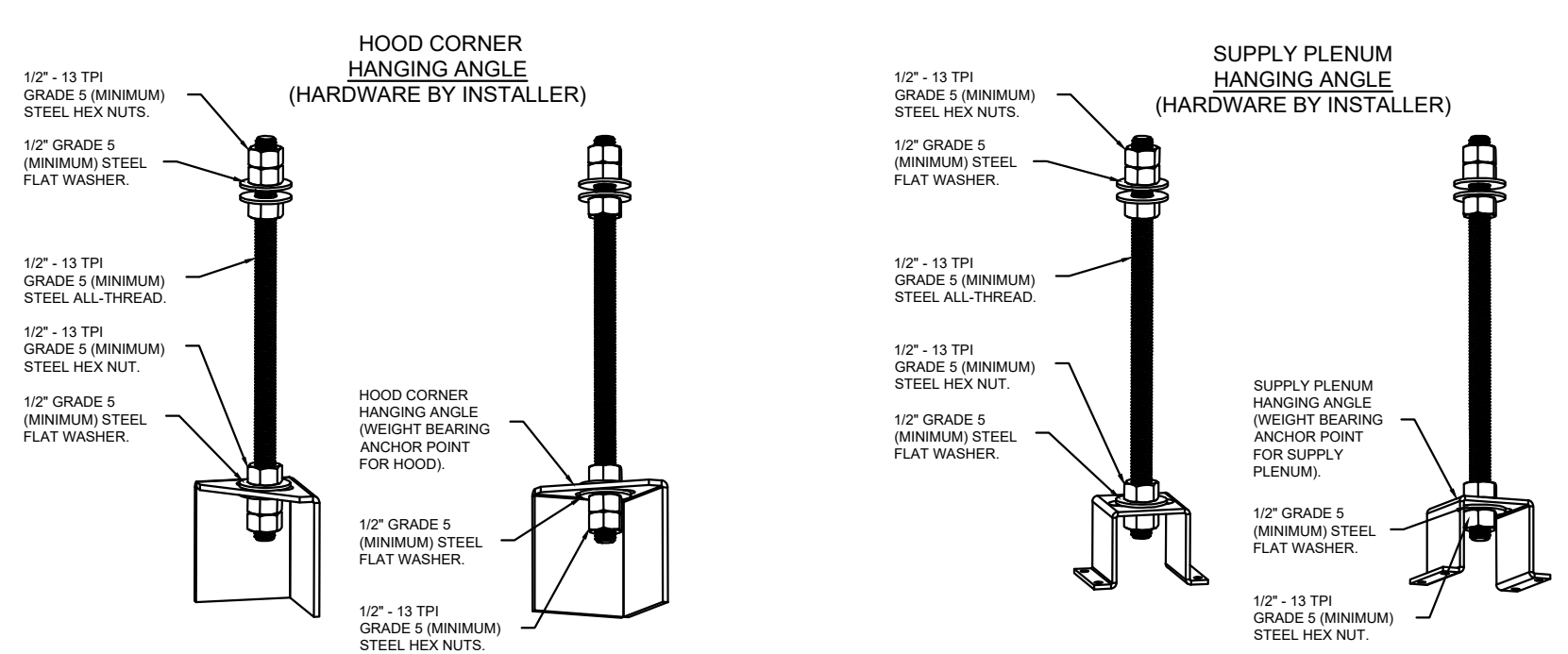

ASSEMBLY INSTRUCTIONS
 HANGING ANGLE MUST BE SUPPORTED WITH 1/2" - 13 TPI GRADE 5 (MINIMUM) ALL-THREAD. SANDWICH HANGING ANGLES AND CEILING ANCHOR POINTS WITH 1/2" GRADE 5 (MINIMUM) STEEL FLAT WASHERS AND 1/2" - 13 TPI GRADE 5 (MINIMUM) HEX NUTS AS SHOWN. MUST USE DOUBLED HEX NUT CONFIGURATION BENEATH HOOD HANGING ANGLES AND ABOVE CEILING ANCHORS. MAINTAIN 1/4" OF EXPOSED THREADS BENEATH BOTTOM HEX NUT. TORQUE ALL HEX NUTS TO 57 FT-LBS.

CLEARANCE TO COMBUSTIBLES

HOODS #	SURFACE	*CLEARANCE
1	TOP	18"
	FRONT	0"
	BACK	0"
	LEFT	0"
	RIGHT	0"

*0" CLEARANCE TO COMBUSTIBLES CONFORMS TO UL710 STANDARD.
 - HOOD MOUNTED UTILITY CABINETS REQUIRE 36" SERVICE CLEARANCE.

SPECIFICATION: CAPTRATE GREASE-STOP SOLO FILTER
 THE CAPTRATE GREASE-STOP SOLO FILTER IS A SINGLE-STAGE FILTER FEATURING A UNIQUE S-BAFFLE DESIGN IN CONJUNCTION WITH A SLOTTED REAR BAFFLE DESIGN, TO DELIVER EXCEPTIONAL FILTRATION EFFICIENCY.
 FILTER IS STAINLESS STEEL CONSTRUCTION, AND SIZED TO FIT INTO STANDARD 2-INCH DEEP HOOD CHANNEL(S).
 UNITS SHALL INCLUDE STAINLESS STEEL HANDLES AND A FASTENING DEVICE TO SECURE THE TWO COMPONENTS WHEN ASSEMBLED.
 GREASE EXTRACTION EFFICIENCY PERFORMANCE SHALL REMOVE AT LEAST 75% OF GREASE PARTICLES FIVE MICRONS IN SIZE, AND 85% GREASE PARTICLES SEVEN MICRONS IN SIZE AND LARGER, WITH A CORRESPONDING PRESSURE DROP NOT TO EXCEED 1.0 INCHES OF WATER GAUGE.
 THE CAPTRATE GREASE-STOP SOLO WAS TESTED TO ASTM STANDARD ASTM F2519-05. MANUFACTURER APPROVED FOR USE IN SOLID FUEL APPLICATIONS AS A SPARK ARRESTER.

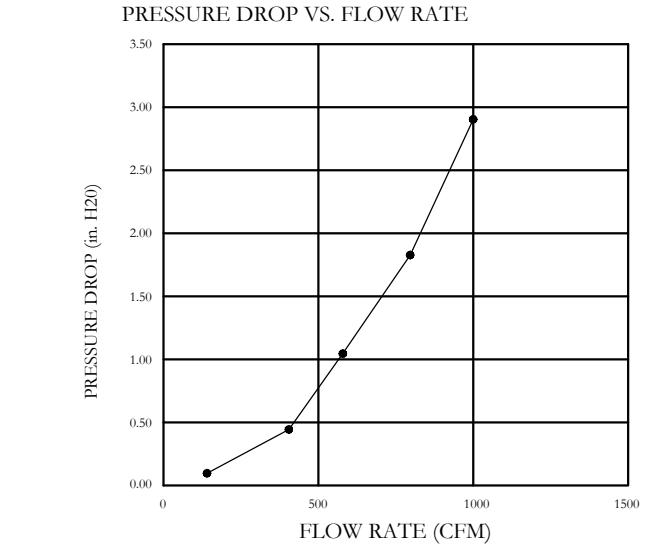
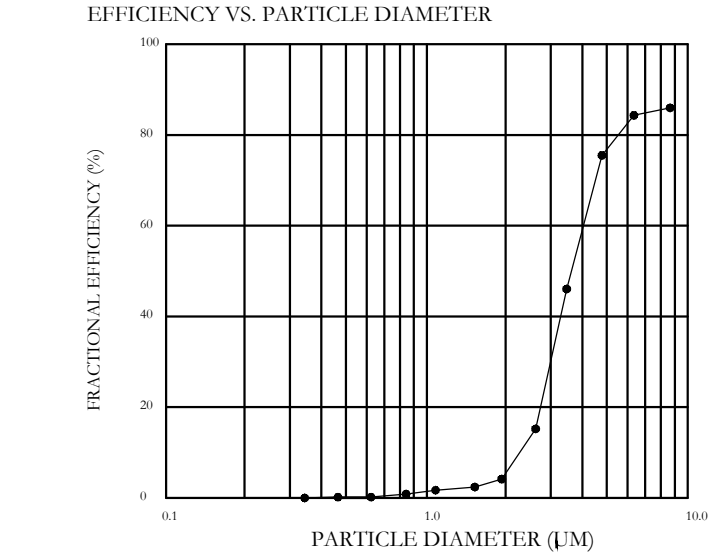

CAPTRATE FILTERS ARE BUILT IN COMPLIANCE WITH:
 NFPA #96
 NSF STANDARD #2
 UL STANDARD #1046
 INT. MECH. CODE (IMC)
 ULC-S649.



1" LAYER OF INSULATION FACTORY INSTALLED IN INTERNAL BACK STANDOFF MEETS 0 INCH REQUIREMENTS FOR CLEARANCE TO COMBUSTIBLE SURFACES.

1" LAYER OF INSULATION FACTORY INSTALLED IN 1.00" END STANDOFF MEETS 0" REQUIREMENTS CLEARANCE TO COMBUSTIBLE SURFACES.

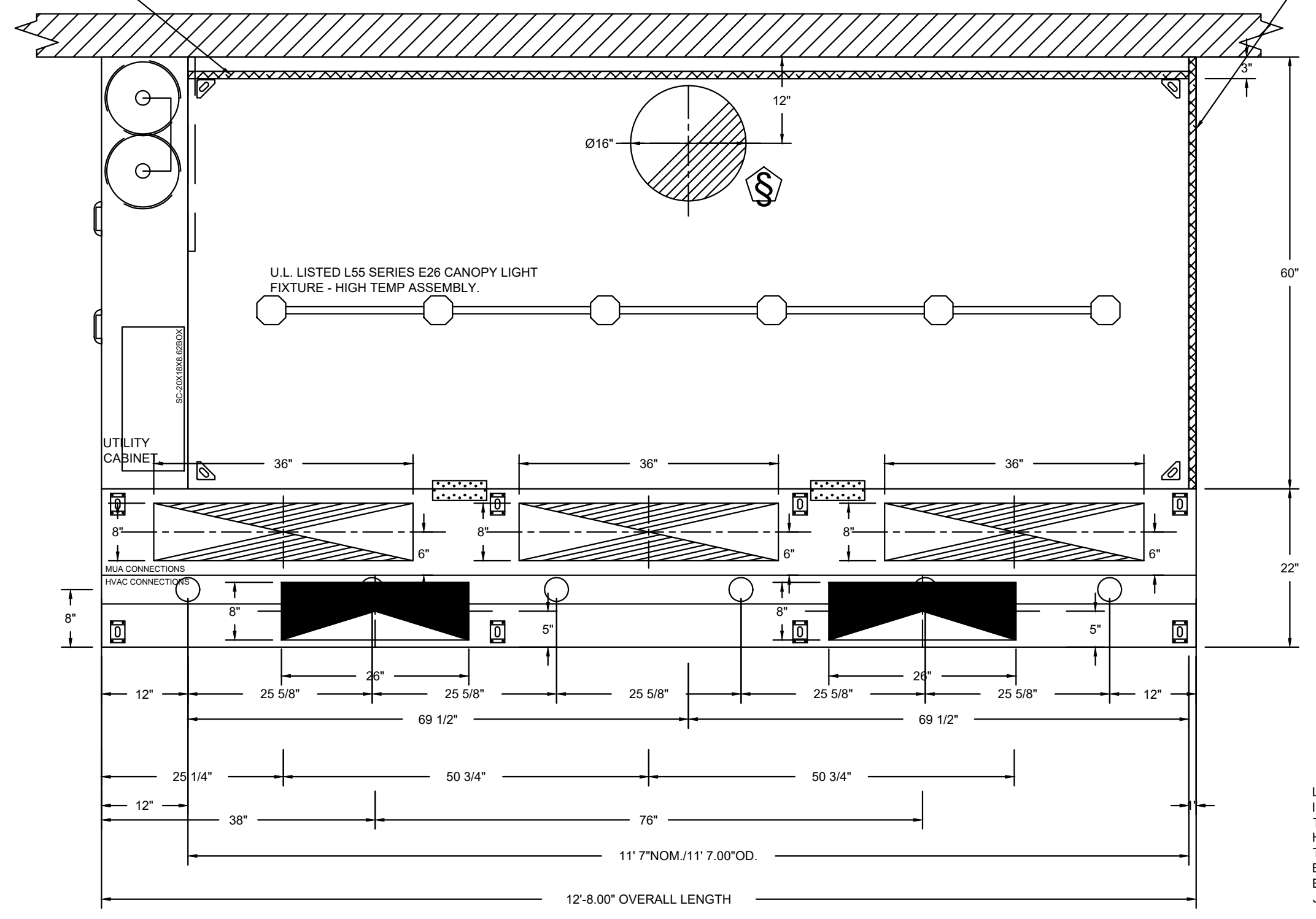

LIGHTING FOR ACPSP JOB # 7217865 - HOOD #1
 INPUT: 120V AC, 1 PHASE, 60/60HZ, 3.5 WATTS PER LIGHT.
 TO CONTROL LIGHTS WITH HOOD LIGHT SWITCH, WIRE PER HOOD ELECTRICAL CONTROL PANEL SCHEMATIC.
 TO CONTROL LIGHTS WITH BUILDING LIGHT SWITCH, WIRE BLACK AND WHITE WIRE TO A 120VAC SERVICE.
 END TO END ACPSPS REQUIRE 120VAC FIELD WIRING FROM J-BOX TO J-BOX. REPLACE LIGHTS WITH LED LIGHTS ONLY.

PLAN VIEW - HOOD #1
 11' 7.00" LONG 6030ND-2-ACPSP-F

ACPSP SHIPS LOOSE FOR FIELD INSTALLATION

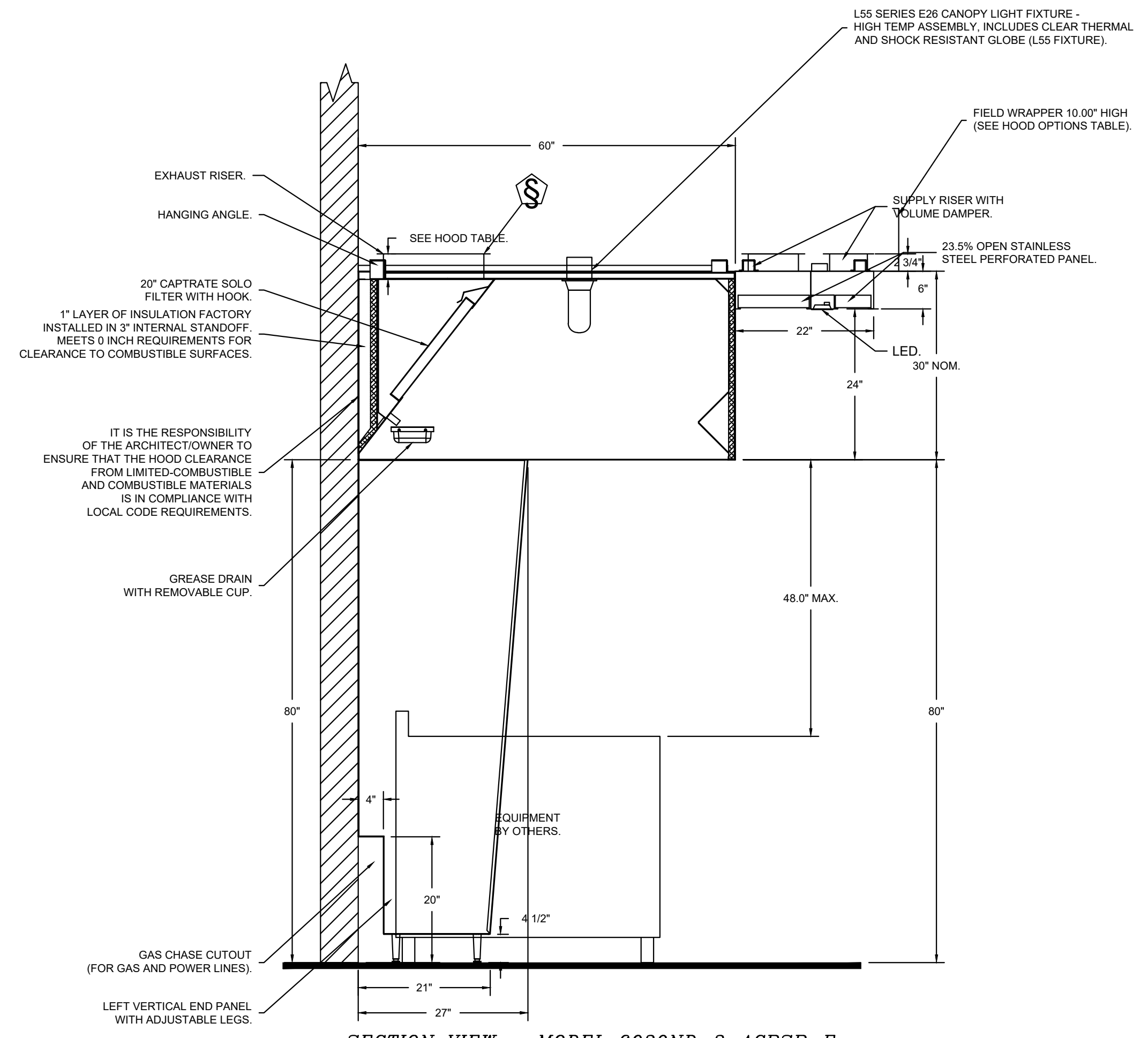

IT IS THE RESPONSIBILITY OF THE ARCHITECT/OWNER TO ENSURE THAT THE HOOD CLEARANCE FROM LIMITED-COMBUSTIBLE AND COMBUSTIBLE MATERIALS IS IN COMPLIANCE WITH LOCAL CODE REQUIREMENTS.

SECTION VIEW - MODEL 6030ND-2-ACPSP-F
 HOOD - #1

REVISIONS	
DESCRIPTION	DATE

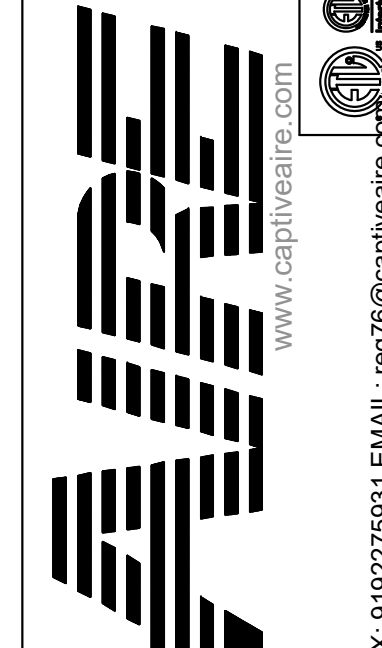

Maryland Mechanical

8120 Woodmont Avenue, Suite 720, Bethesda, MD, 20814 PHONE: (800) 988-0881 FAX: 9192279591 EMAIL: reg76@captivemechanical.com

Cava - Willowbrook, IL
 7135 Kingery Highway,
 Willowbrook, IL, 60527

DATE: 12/11/2024

DWG.#:
7217865

DRAWN BY:
AJP-32

SCALE:
3/4" = 1'-0"

MASTER DRAWING

SHEET NO.
2

annex
 ENGINEERING GROUP
 589 W. Nationwide Blvd. Ste. B
 Columbus, Ohio 43215
 tel: 614.481.2292



COPYRIGHT 2025. ALL DRAWINGS AND SPECIFICATIONS SHALL REMAIN THE PROPERTY OF ANNEX ENGINEERING GROUP AND MAY NOT BE USED, DUPLICATED OR ALTERED WITHOUT THE WRITTEN CONSENT OF THE ENGINEER.

CAVA
 CAVA #580 - WILLOWBROOK, IL
 7135 KINGERY HIGHWAY
 WILLOWBROOK, IL 60527
 FOR CAVA
 14 Ridge Square NW #500, WASHINGTON, DC 20016

PROJECT NUMBER:
CAV152

ISSUE	DATE
PERMIT SET	12.20.2024
REVISION 1	01.31.2025
REVISION 2	03.31.25

CAPTIVE AIRE HOOD DRAWINGS FOR REFERENCE ONLY

SHEET:

H1.2

CAPTIVE AIRE HOOD DRAWINGS FOR REFERENCE ONLY

FIRE SYSTEM INFORMATION – JOB#7217865

FIRE SYSTEM NO	TAG	TYPE	SIZE	MAX FP	DESIGN FP	INSTALLATION	
						SYSTEM	LOCATION ON HOOD
1		TANK FS	4.0/4.0	40	37	FIRE CABINET LEFT	LEFT, HOOD 1

GAS VALVE(S)

FIRE SYSTEM NO	TAG	TYPE	SIZE	SUPPLIED BY
1		SC ELECTRICAL	2.000	CAPTIVEAIRE SYSTEMS

GAS VALVE SIZING				GAS VALVE DIMENSIONS					INSTALLATION	PART NUMBERS						
TYPE	SIZE	VOLTAGE	MIN. INLET PRESSURE	MAX. INLET PRESSURE	FLOW AT 1 IN.W.C. DROP NATURAL GAS	FLOW AT 1 IN.W.C. DROP PROPANE	DIM "A"	DIM "B"	DIM "C"	DIM "D"	DIM "E"	DIM "G"	MOUNTING ORIENTATION	GAS VALVE PART NUMBER	STRAINER PART NUMBER	GAS VALVE/STRAINER KIT
ELECTRICAL	2"	120 VAC	0 PSI (0 IN.W.C.)	5 PSI (138 IN.W.C.)	2,940,500 BTU/HR	1,905,048 BTU/HR	7-5/8"	6-3/8"	7-1/4"	7-13-16"	15-5/8"	13-15/16"	HORIZONTAL	8214280	4417668	(SC)EGVA2

ELECTRIC GAS VALVES ONLY:
 3/4"-2" 120VAC GAS VALVES CAN BE MOUNTED WITH THE SOLENOID IN ANY POSITION ABOVE HORIZONTAL.
 2 1/2"-3" 120VAC GAS VALVES MUST BE MOUNTED WITH THE SOLENOID VERTICAL AND UPRIGHT.
 24VDC GAS VALVES MUST BE MOUNTED WITH THE SOLENOID VERTICAL AND UPRIGHT.

ALL GAS VALVES/STRAINERS:
 PROPER CLEARANCE MUST BE PROVIDED IN ORDER TO SERVICE THE STRAINERS A MINIMUM OF 4" CLEARANCE DISTANCE MUST BE PROVIDED AT THE BASE OF THE STRAINER. CUSTOMER MUST VERIFY BTU CONSUMPTION AS WELL AS PRESSURE RATING. SPECIFIC GRAVITY OF NATURAL GAS = 0.64, SPECIFIC GRAVITY OF LP = 1.52.

CALCULATIONS:
 TO CALCULATE GAS FLOW FOR OTHER THAN 1 IN.W.C. PRESSURE DROP:
 NEW BTU/HR = (BTU/HR AT 1 IN.W.C. PRESSURE DROP) X NEW PRESSURE DROP^{0.5}
 TO CALCULATE GAS FLOW FOR OTHER THAN 0.64 SPECIFIC GRAVITY:
 NEW BTU/HR = (BTU/HR AT 0.64) X (0.64 / NEW SPECIFIC GRAVITY)^{0.5}

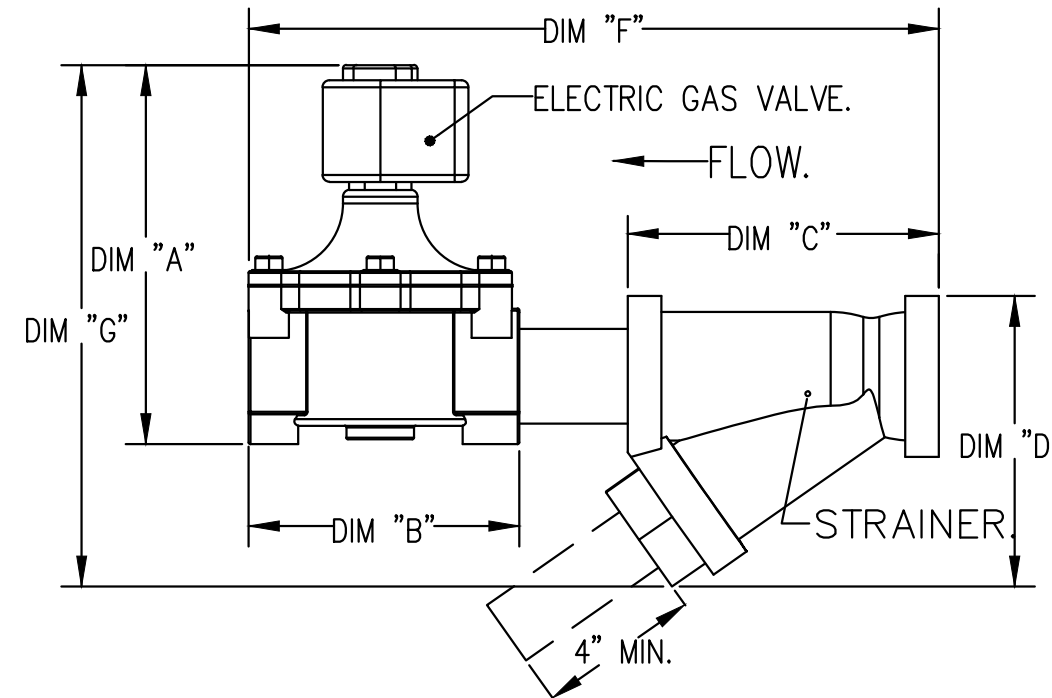

INCLUDES: FIELD INSTALLATION AND HOOKUP DURING NORMAL BUSINESS HOURS BY CERTIFIED INSTALLERS ONLY IN THE LOCATION NOTED ABOVE. TWO SITE VISITS ONLY (ONE VISIT TO SET PULL STATION & SYSTEM HOOKUP AND ONE VISIT FOR ONE TEST; ADDITIONAL VISITS WILL RESULT IN ADDITIONAL CHARGES). ONE MECHANICAL OR ELECTRICAL GAS VALVE PER SYSTEM AT A MAXIMUM SIZE OF 2". PERMIT, AND SYSTEM TEST.
 EXCLUDES: UNION LABOR & PREVAILING WAGE (LABOR & WAGES WILL BE ADDED IF APPLICABLE), GAS VALVE INSTALLATION, ELECTRICAL HOOKUP AND CONNECTIONS, HANGING OF FIRE CABINET, SHUNT TRIP, HANDHELD EXTINGUISHER(S), ON-SITE RE-PIPING DUE TO EQUIPMENT LAYOUT CHANGES.

- SYSTEM REQUIRES A MINIMUM OF 7 FT OF EQUIVALENT PIPE LENGTH BETWEEN TANK AND NEAREST APPLIANCE NOZZLE FOR MOST APPLIANCES. EACH 90 DEGREE ELBOW ADDS 1.3 FT OF EQUIVALENT LENGTH. SEE MANUAL FOR DETAILS

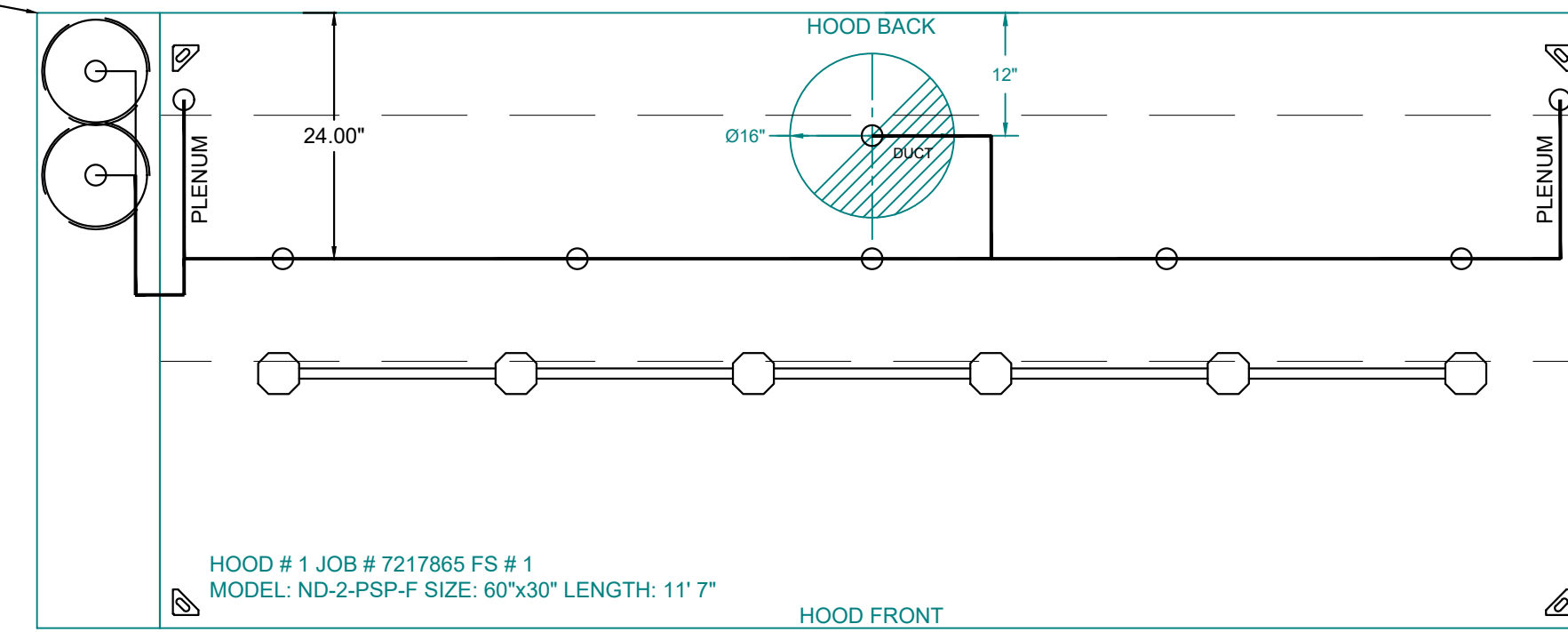

FACTORY PIPING EXTENDS A MAXIMUM OF 6" ABOVE THE TOP OF THE HOOD.

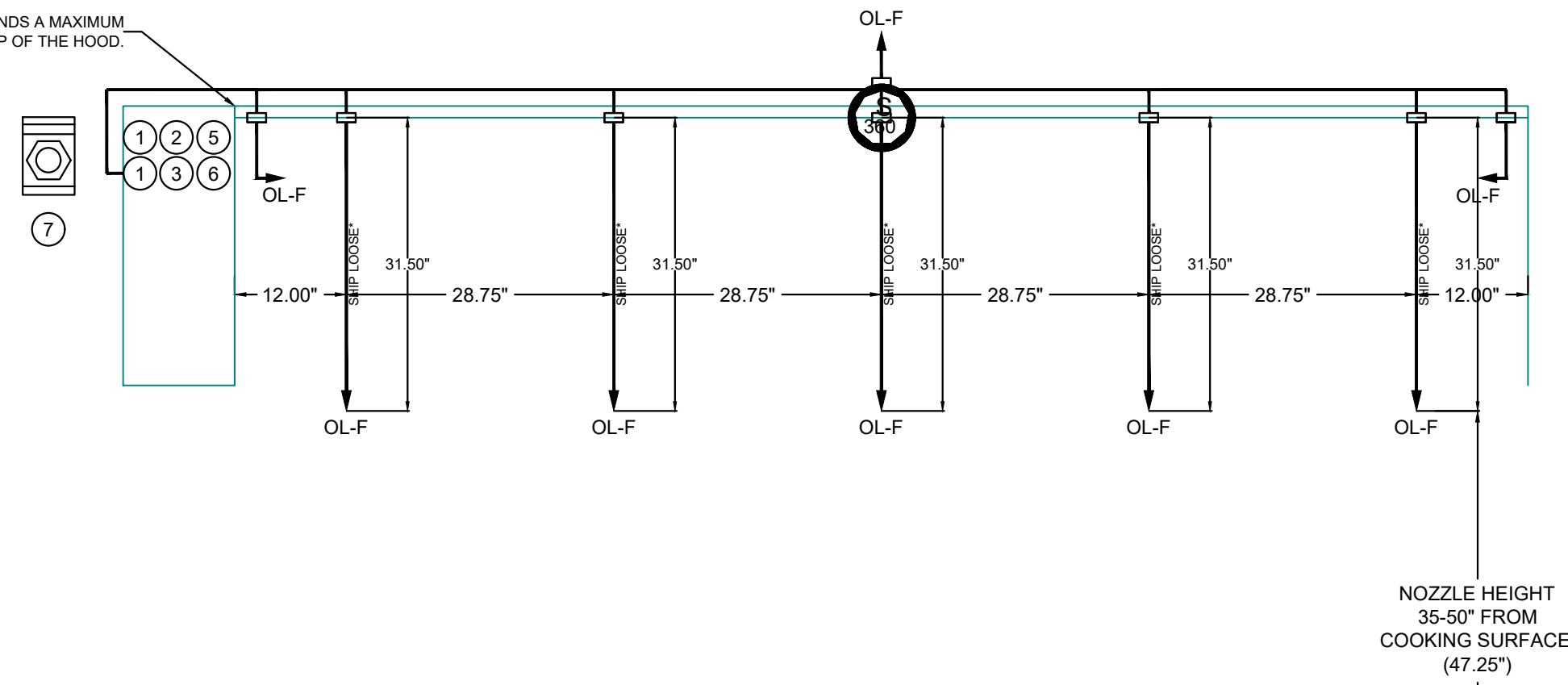

TANK OVERLAPPING PROTECTION - 30
 133.00" L X 24.00" D

FIRE SYSTEM PARTS LIST KEY

FIRE SYSTEM NO	TAG	KEY NUMBER - PART DESCRIPTION	QTY BY FACTORY	QTY BY DIST
1		0 - 0 - TANK FIRE SUPPRESSION POST-DISCHARGE PROCEDURE UTILITY CABINET LABEL SHEET.	1	0
		0 - 0 - TANK FIRE SUPPRESSION MAINTENANCE GUIDE UTILITY CABINET LABEL SHEET.	1	0
		0 - 0 - 12-F28021-32144-OT-360 DUCT FIRE THERMOSTAT WITH 12 FOOT WIRE LEADS. NO. CLOSE ON TEMP RISE AT 360°F. (A0034310).	1	0
		0 - 0 - 32-00002 QUIK SEAL - 1/2" (UL).	1	0
		0 - 0 - 4429K153 1/2" MALE NPT TO 1/2" FEMALE NPT ELBOW, BRASS.	2	0
		0 - 0 - 4429K422 1/2" X 1/4" BRASS REDUCING BUSHING.	1	0
		0 - 0 - 79525 1/2" 90 PRO-PRESS ELBOW WITH 1/2" NPT FEMALE CONNECTION, VIEGA.	1	0
		0 - 0 - 79580 1/2" X 1/2" PRO-PRESS TEE X 1/2" NPT FEMALE CONNECTION, VIEGA.	2	0
		0 - 0 - 87-120042-001 SECONDARY ACTUATOR VALVE (SVA) - SINGLE ACTUATOR, REQUIRES PRIMARY RELEASE ACTUATOR, TANK FIRE SUPPRESSION.	1	0
		0 - 0 - 87-120045-001 HOSE, SECONDARY ACTUATOR HOSE, 7.5" BRAIDED STAINLESS STEEL, TANK FIRE SUPPRESSION.	1	0
		0 - 0 - 87-300001-001 TANK - PRESSURIZED TANK USED FOR TANK FIRE SUPPRESSION.	2	0
		0 - 0 - 87-300030-001 PRIMARY ACTUATOR KIT (PAK) - ACTUATOR AND RELEASE SOLENOID ASSEMBLY, ONE NEEDED PER FIRE SYSTEM, SUPERVISED, TANK FIRE SUPPRESSION.	1	0
		0 - 0 - 87-300152-001 HARDWARE, SVA BOLTS, TANK FIRE SUPPRESSION.	8	0
		0 - 0 - 9055455PC PRO PRESS 1/2 PRESS X PRESS 90 ELBOW LD.	6	0
		0 - 0 - 9097200PC PRO PRESS PC611 1/2 PRESS TEE LD.	7	0
		0 - 0 - 98694A115 HARDWARE, DATANKLOCK LOCKING BRACKET SQUARE NUTS 5/16" ZINC, TANK FIRE SUPPRESSION.	4	0
		0 - 0 - A0034332 JUNCTION BOX FOR MANUAL PULL STATION. 1.5" DEEP BACK BOX, RED COLOR.	1	0
		0 - 0 - A31484 1/4" NPT SCHRADER VALVE AND CAP, JB INDUSTRIES. 1/4" FLARE X 1/4" MPT HALF UNION. USED ON TANK SERVICE PORT.	1	0
		0 - 0 - B1145 3/8" BLACK IRON 90 ELL.	3	0
		0 - 0 - DATANKLOCK DISCHARGE ADAPTER TANK LOCKING PLATE FOR FIRE SYSTEM TANK INSTALLATION IN UTILITY CABINETS, TANK FIRE SUPPRESSION.	2	0
		0 - 0 - TANK STRAP TANK STRAP - USED FOR TANK FIRE SUPPRESSION.	6	0
		0 - 0 - TFS-UCTANKBRACKET TANK BRACKET FOR FIRE SYSTEM TANK INSTALLATION IN UTILITY CABINETS, TANK FIRE SUPPRESSION.	2	0
		0 - 0 - WK-283952-000 DISCHARGE ADAPTER, TANK FIRE SUPPRESSION.	2	0
		16 - 16 - 79210 1/2" X 3/8" NPT MALE ADAPTER, VIEGA.	8	0
		16 - 16 - OL-F NOZZLE - TANK PROTECTION APPLIANCE COVERAGE NOZZLE (INCLUDES METAL BLOW OFF CAP, LANYARD, USED WITH CHROME-PLATED PIPE).	8	0
		26 - 26 - QSA-3/8 QUIK SEAL - 3/8" (UL).	8	0
		34 - 34 - A0034331 24VDC SINGLE ACTION MANUAL ACTUATION DEVICE (PUSH/PULL STATION) WITH PROTECTIVE COVER, ONE (1) NORMALLY OPEN CONTACT, RED COLOR.	1	0

NOTES

- FIELD PIPE DROPS AS SHOWN PIPING, ELBOWS, TEES, AND NOZZLES SUPPLIED BY CAS.
- FIELD INSTALLED DROP: FACTORY WILL PROVIDE QTY 2 60IN LONG PIECES OF CHROME PLATED PIPING SHIPPED LOOSE TO BE FIELD-INSTALLED.
- SHIP LOOSE DROP: FACTORY WILL PROVIDE THE EXACT CHROME PIPE LENGTH NEEDED SHIPPED LOOSE TO BE FIELD-INSTALLED.
- RELOCATE NOZZLES IF FLOW PATTERN IS BLOCKED BY SHELVING, SALAMANDERS, ETC.
- OVERLAPPING COVERAGE SHALL NOT BE USED ON ANY APPLIANCE WITH AN OBSTRUCTION.
- IF APPLICABLE, EXTENDED PRE-PIPED DROPS ARE SHIPPED LOOSE.
- FACTORY PIPING EXTENDS A MAXIMUM OF 6" ABOVE THE TOP OF THE HOOD.

- APPLIANCE DIMENSIONS LISTED REPRESENT THE COOKING SURFACE SIZE, NOT THE OVERALL APPLIANCE SIZE.
- THIS FIRE SYSTEM COMPLIES WITH U.L. 300 REQUIREMENTS.

- OL-F NOZZLE PART NUMBER REPLACES 3070-3/8H-10-SS

JOB #: 7217865.
 JOB NAME: CAVA - WILLOWBROOK, IL.

SYSTEM SIZE: TANK-SP-2 DESIGN FP: 37. MAXIMUM FP: 40.
 HOOD # 1 11' 7.00" LONG x 60" WIDE x 30" HIGH.
 RISER # 1 SIZE: 16" DIA.
 HOOD # 1 METAL BLOW-OFF CAPS INCLUDED.

- HEAVY-DUTY APPLIANCES (RATED 600°F) WILL REQUIRE AN ADDITIONAL DOWNSTREAM FIRESTAT IN THE EVENT THAT THE DUCTWORK CONTAINS ANY HORIZONTAL RUNS OVER 25 FT IN LENGTH.
- MEDIUM TO LIGHT-DUTY APPLIANCES (RATED 450°F) WILL NOT REQUIRE ANY ADDITIONAL DOWNSTREAM DETECTION.

AGENT DISTRIBUTION PIPING LIMITATIONS	
PIPE SECTION	MAX PIPE LENGTH (FT)
MAX SUPPLY LINE TO FIRST OVERLAPPING NOZZLE	42
OVERLAPPING NOZZLE APPLIANCE BRANCH	10
DEDICATED NOZZLE APPLIANCE BRANCH	10

LEGEND – FIRE CABINET TANK SYSTEM

- 4 GALLON TANK.
- PRIMARY ACTUATOR RELEASE.
- SECONDARY ACTUATOR RELEASE.
- PRESSURE SUPERVISION SWITCH.
- PRIMARY HOSE ASSEMBLY.
- SECONDARY HOSE ASSEMBLY.
- REMOTE MANUAL ACTUATION DEVICE.

REVISIONS

DESCRIPTION	DATE

CAPTIVEAIRE

Maryland Mechanical
 8120 Woodmont Avenue, Suite 720, Bethesda, MD, 20814 PHONE: (800) 988-0881 FAX: 9192275931 EMAIL: reg76@captiveaire.com

Cava - Willowbrook, IL
 7135 Kingery Highway,
 Willowbrook, IL, 60527

DATE: 12/11/2024

DWG.#: 7217865

DRAWN BY: AJP-32

SCALE: 3/4" = 1'-0"

MASTER DRAWING

SHEET NO. 3

CAPTIVEAIRE HOOD DRAWINGS FOR REFERENCE ONLY

annex
 ENGINEERING GROUP
 589 W. Nationwide Blvd. Ste. B
 Columbus, Ohio 43215
 tel: 614.481.2292

COPYRIGHT 2025. ALL DRAWINGS AND SPECIFICATIONS SHALL REMAIN THE PROPERTY OF ANNEX ENGINEERING GROUP AND MAY NOT BE USED, DUPLICATED OR ALTERED WITHOUT THE WRITTEN CONSENT OF THE ENGINEER.

CAVA
 CAVA #580 - WILLOWBROOK, IL
 7135 KINGERY HIGHWAY
 WILLOWBROOK, IL 60527
 FOR CAVA
 14 Ridge Square NW #500, WASHINGTON, DC 20016

PROJECT NUMBER: CAV152

ISSUE	DATE
PERMIT SET	12.20.2024
REVISION 1	01.31.2025
REVISION 2	03.31.25

CAPTIVEAIRE HOOD DRAWINGS FOR REFERENCE ONLY

SHEET: **H1.3**

EXHAUST FAN INFORMATION - JOB#7217865

FAN UNIT NO	TAG	QTY	FAN UNIT MODEL #	MANUFACTURER	CFM	ESP	RPM	MOTOR ENCL	HP	BHP	PHASE	VOLT	FLA	DISCHARGE VELOCITY	WEIGHT (LBS)	SONES
1	KEF	1	DUBSHFA	CAPTIVEAIRE	2317	1.000	1551	TEAO-ECM	1.000	0.6650	1	115	11.6	733 FPM	87	16.7

DOAS/RTU FAN SCHEDULE - JOB#7217865

FAN UNIT NO	TAG	QTY	DOAS/RTU MODEL #	MANUFACTURER	FAN INFORMATION		ELECTRICAL INFORMATION					COOLING INFORMATION					GAS HEAT INFORMATION				A2L MINIMUM ROOM VOLUME			NOTES											
					BLOWER	RETURN AIR CFM	MAX OUTSIDE AIR CFM	TOTAL CFM	WEIGHT (LBS)	ESP	HP	PHASE	VOLT	MCA	MOCP	OUTSIDE AIR DB	OUTSIDE AIR WB	MIXED AIR DB	MIXED AIR WB	LEAVING AIR DB	LEAVING AIR WB	DP	TOTAL		SENS.	IEER	ISMRE	GAS TYPE	INPUT BTUs	OUTPUT BTUs	TEMP RISE	REQUIRED INPUT GAS PRESSURE	ROOM AREA (FT2)	AIRFLOW (CFM)	HEIGHT (FT)
2	MAU	1	EARTU1-1.260-15-ST-MPU	ECON-AIR	15P-1	0	1854	1854	1273	0.500	2.00	3	208	29.4A	35A	87.0°F	77.9°F	87.0°F	77.9°F	72.3°F	69.1°F	67.7°F	64.0 MBH	28.5 MBH	17.9	6.1	NATURAL	220940	178961	79°F	7 IN. W.C. - 14 IN. W.C.	235	423	7.2	1,2,3,4,5,6,7,8,9,10,11,12,13,14

NOTES:

- INVERTER SCROLL COMPRESSOR WITH INTEGRATED OIL SENSOR. DIGITAL OR STAGED SCROLL NOT AN APPROVED EQUAL
- DIRECT DRIVE PLENUM BLOWER. BELT DRIVEN BLOWERS ARE NOT ACCEPTABLE
- INTEGRATED MONITORING VIA CELLULAR CONNECTION BY MANUFACTURER
- REFRIGERATION PRESSURE MONITORING ON HIGH AND LOW PRESSURE SIDE OF SYSTEM INCLUDED THROUGH DIGITAL INTERFACE
- EC MOTOR CONDENSING FANS
- ELECTRONIC EXPANSION VALVE. TXV NOT ACCEPTABLE
- SUCTION LINE ACCUMULATOR
- FACTORY COMMISSIONING WITH 5 YEAR PARTS WARRANTY, 25 YEAR WARRANTY ON STAINLESS STEEL HEAT EXCHANGER
- AVERAGING INTAKE, EVAP AND DISCHARGE TEMPERATURE SENSORS (DISCHARGE SENSOR TO BE FACTORY MOUNTED WITHIN UNIT)
- 81% EFFICIENT FURNACE, WITH MODULATING INDUCER TO MAINTAIN CONSTANT COMBUSTION EFFICIENCY ACROSS FIRING RANGE. 6:1 TURNDOWN WITH NG AND 5:1 TURNDOWN WITH LP
- SUPPLY CFM MONITORING INTEGRAL TO UNIT WITH CFM MEASUREMENT INCLUDED THROUGH DIGITAL INTERFACE
- 1" EXTERIOR DUAL-WALL CONSTRUCTION W/ R-4.3 INSULATION-MINIMUM 24GA EXTERIOR W/ 18GA BASE
- DOWN DISCHARGE/NO RETURN
- MINIMUM ROOM AREA ASSUMED 7.2' SUPPLY DIFFUSER HEIGHT AND IS CALCULATED PER UL60335-2-40 4TH ED. VALUES BASED ON FACTORY CHARGE. ACTUAL SITE CHARGE MAY DIFFER.

FAN OPTIONS

FAN UNIT NO	TAG	QTY	DESCRIPTION
1	KEF	1	ECM WIRING PACKAGE - PWM SIGNAL FROM ECPM03 PREWIRE (TELCO MOTOR), CCW ROTATION
		1	2 YEAR PARTS WARRANTY
2	MAU	1	INLET PRESSURE GAUGE, 0-35"
		1	MANIFOLD PRESSURE GAUGE, 0 TO 10" WC, 1 FURNACE
		1	SHIP LOOSE GAS STRAINER 3/4"
		1	CASLINK BUILDING MONITORING SYSTEM - INTERNET OR CELLULAR CONNECTION REQUIRED
		1	CONSTRUCTION MODE - MODIFIES START-UP SETTINGS TO ALLOW TEMPERING A BUILDING STILL UNDER CONSTRUCTION
		1	2" MERV 13 FILTERS FOR RTU1 (QTY. 4)
		1	2" MERV 8 FILTERS FOR RTU1 (QTY. 4)
		1	TOTAL CFM MONITORING
		1	RTU1 DOWN DISCHARGE
		1	RTU FIXED 100% OA INTAKE CONTROL
		1	CONTROL PANEL ENCLOSURE HEATER 100W - RECOMMENDED FOR WINTER DESIGN TEMPERATURES LESS THAN 0°F
		1	RTU HEATED FURNACE CONDENSATE DRAIN KIT. REQUIRED FOR WINTER DESIGN TEMP OF 0 DEGREES F AND LOWER
		1	DISCHARGE FIRESTAT SET TO 240°F
		1	FREEZE STAT
		1	INTAKE FIRESTAT SET TO 135°F
		1	RTU1 NO RETURN - 100% OA - MPU
		1	RTU1 CURB DUCT HANGER
		1	RTU BLOWER DOOR SWITCH
		1	24VAC FIRE INPUT
		1	5 TON MODULATING COOLING OPTION, 208/230V, R454B REFRIGERANT, VARIABLE SPEED COMPRESSOR, DL ECM CONDENSING FAN
		1	R454B LEAK DETECTOR OPTION FOR RTUS
1	SIZE 1 MOISTURE ELIMINATOR FOR SIZE 1, 5 TON RTU, NO REHEAT		
1	UNIT MOUNTED VFD CONFIGURED FOR DCV		
1	LOAD REACTOR MOUNTED IN FAN		
1	5 YEAR ENTIRE UNIT PARTS WARRANTY, 10 YEAR ENTIRE UNIT PARTS WARRANTY WITH REMOTE MONITORING AND CAPTIVEAIRE SERVICE CONTRACT, 25 YEAR STAINLESS STEEL FURNACE PARTS WARRANTY (SEE ADDITIONAL DETAILS)		
1	EXTERIOR GAS CONNECTION PROVIDED BY FACTORY WITH QUICK SEAL AND ANTI-ROTATION BRACKET		

FAN ACCESSORIES

FAN UNIT NO	TAG	EXHAUST				SUPPLY		
		GREASE CUP	GRAVITY DAMPER	WALL MOUNT	SIDE DISCHARGE	GRAVITY DAMPER	MOTORIZED DAMPER	WALL MOUNT
1	KEF							

CURB ASSEMBLIES

NO	ON FAN	TAG	WEIGHT	ITEM	SIZE
1	#1	KEF	40 LBS	CURB	23.000"W X 23.000"L X 26.000"H VENTED.
2	#2	MAU	123 LBS	CURB	41.000"W X 71.000"L X 28.000"H INSULATED.

HMI SCHEDULE				
UNIT NUMBER	HMI #	HMI LOCATION	TEMP AVERAGING	MODBUS ADDRESS
FAN #2	HMI #1 - UNIT	IN UNIT	NOT AVERAGED	55

GREASE DUCT & CHIMNEY SPECIFICATIONS:
 PROVIDE GREASE DUCT EQUAL TO CAPTIVEAIRE SYSTEMS MODEL "DW"
 ROUND 20 GAUGE 430 STAINLESS STEEL DUCTWORK. MODEL "DW"
 IS LISTED TO UL-1978 AND IS INSTALLED USING "Y" CLAMP LOCKING
 CONNECTIONS SEALED WITH 3M FIRE BARRIER 2000 PLUS. MODEL "DW"
 DOES NOT REQUIRE WELDING PROVIDING IT HAS BEEN INSTALLED PER
 THE MANUFACTURERS INSTALLATION GUIDE.
 PROVIDE RATED ACCESS DOORS AT EVERY CHANGE IN DIRECTION AND EVERY 12' ON CENTER. PER
 MANUFACTURERS LISTING MODEL "DW" HORIZONTAL RUNS LESS THAN 75 FT. CAN BE SLOPED 1/16" PER 12',
 HORIZONTAL RUNS MORE THAN 75 FT. CAN BE SLOPED 3/16" PER 12'
 DUCT SHOULD BE SLOPED AS MUCH AS POSSIBLE TO REDUCE THE CHANCE OF GREASE ACCUMULATION IN
 HORIZONTAL RUNS.
 IF THE DUCT OR CHIMNEY IS WITHIN 18 INCHES OF COMBUSTIBLE MATERIAL, PROVIDE UL-2221 OR UL-103 HT
 LISTED DOUBLE WALL GREASE DUCT OR DOUBLE WALL CHIMNEY EQUAL TO CAPTIVEAIRE SYSTEMS MODEL
 "DW-2R, 2R TYPE HT, 3R, OR 3Z" ROUND 20 GAUGE 430 STAINLESS INNER DUCT INSULATED WITH A 24 GAUGE
 430 STAINLESS OUTER SHELL.

CUSTOMER APPROVAL TO MANUFACTURE:

APPROVED AS NOTED	<input type="checkbox"/>
APPROVED WITH NO EXCEPTION TAKEN	<input type="checkbox"/>
NOTICE AND RETURN	<input type="checkbox"/>
SIGNATURE	_____
YOUR TITLE	_____

FAN #1 DUBSHFA - EXHAUST FAN (KEF)

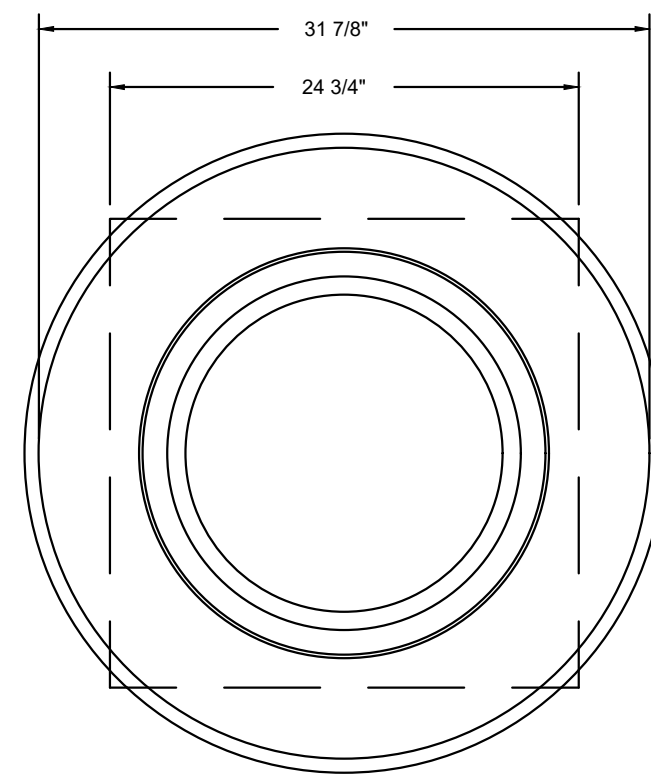
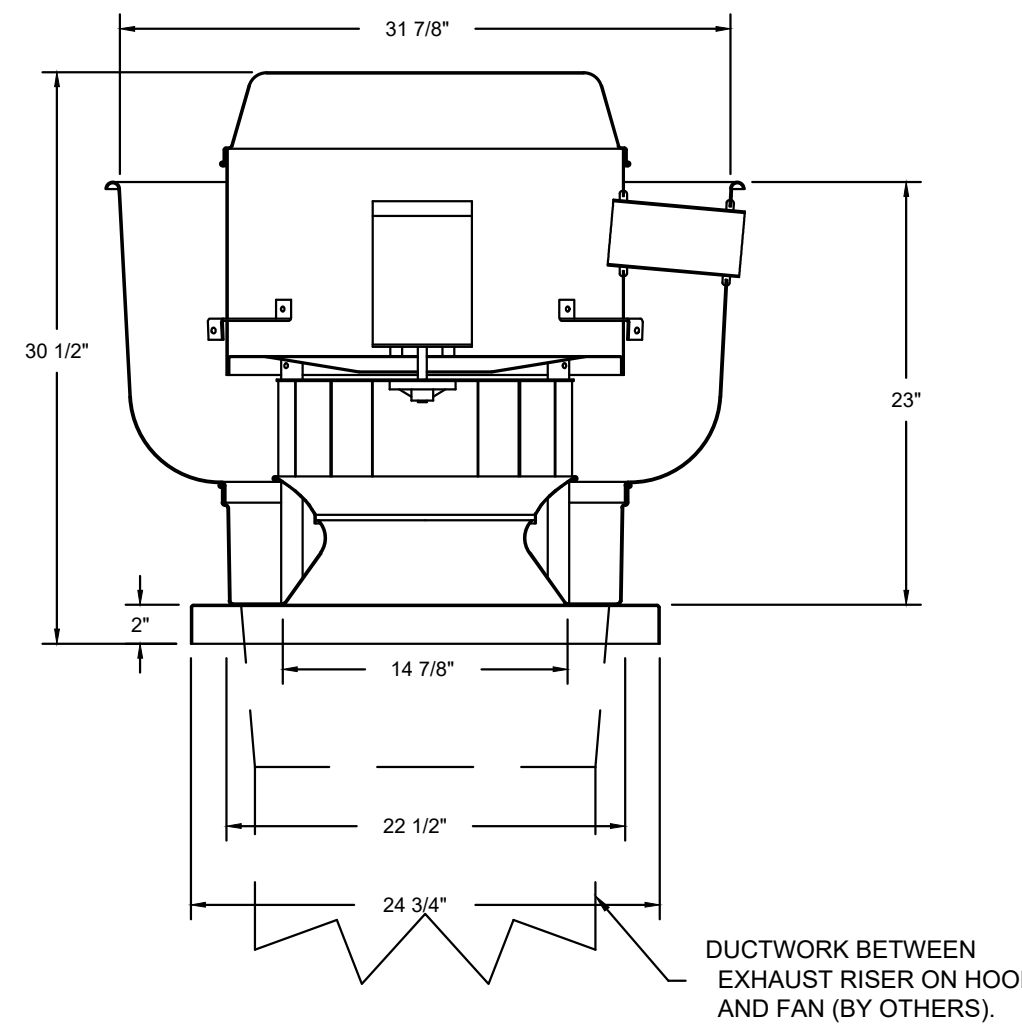

TOP VIEW

FEATURES:

- DIRECT DRIVE CONSTRUCTION (NO BELTS/PULLEYS)
- ROOF MOUNTED FANS
- RESTAURANT MODEL
- UL705
- VARIABLE SPEED CONTROL
- INTERNAL WIRING
- THERMAL OVERLOAD PROTECTION (SINGLE PHASE)
- HIGH HEAT OPERATION 300°F (149°C)
- NEMA 3R SAFETY DISCONNECT SWITCH

NORMAL TEMPERATURE TEST
 EXHAUST FAN MUST OPERATE CONTINUOUSLY WHILE EXHAUSTING AIR AT 300°F (149°C) UNTIL ALL FAN PARTS HAVE REACHED THERMAL EQUILIBRIUM, AND WITHOUT ANY DETERIORATING EFFECTS TO THE FAN WHICH WOULD CAUSE UNSAFE OPERATION.

OPTIONS

- ECM WIRING PACKAGE - PWM SIGNAL FROM ECPM03 PREWIRE (TELCO MOTOR), CCW ROTATION
- 2 YEAR PARTS WARRANTY

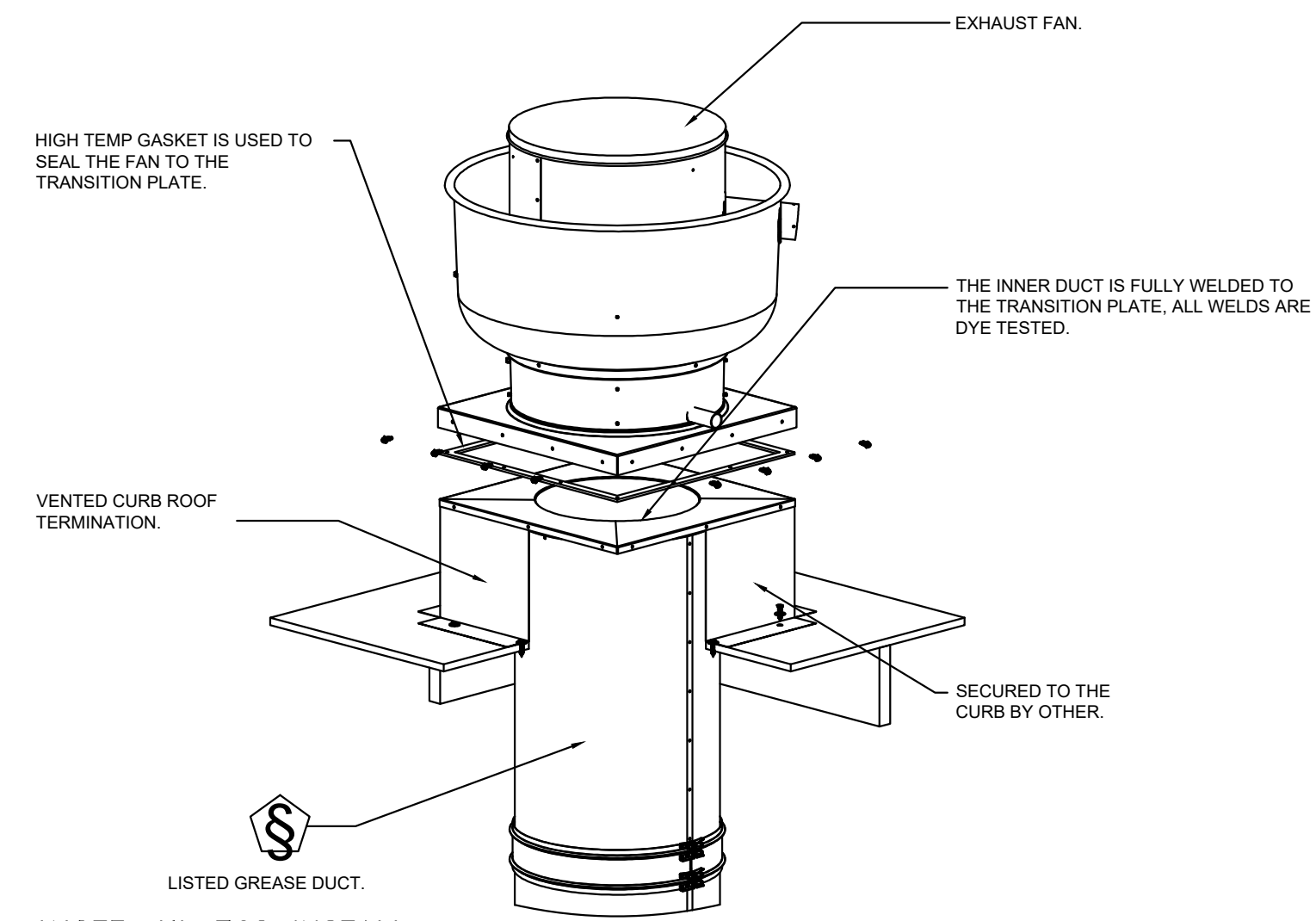
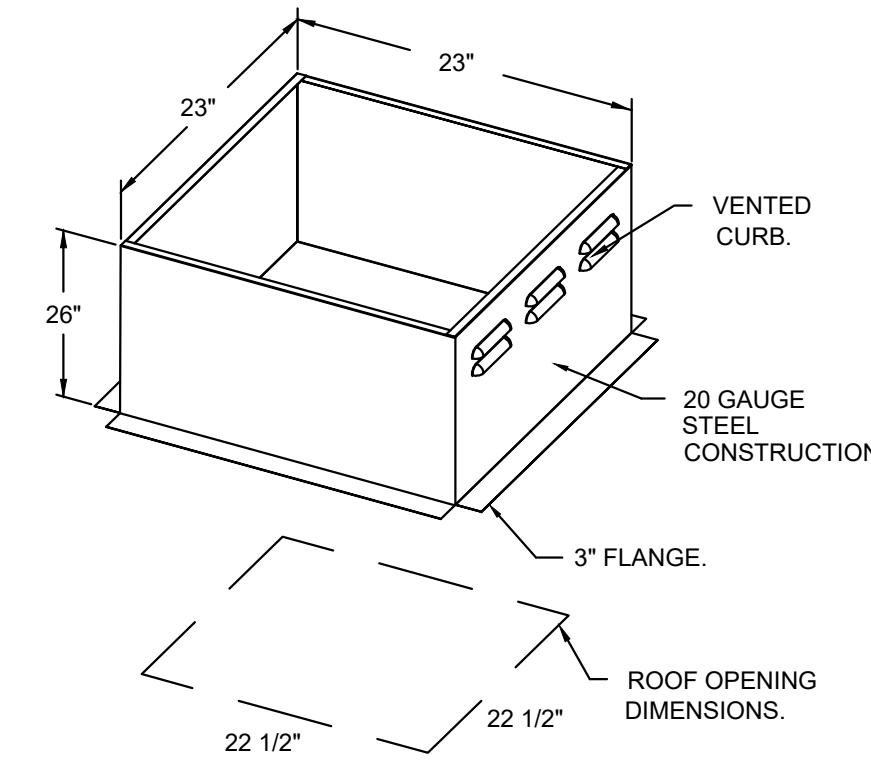

*NOTE: UL 762 INSTALL.

REVISIONS

DESCRIPTION	DATE

CAPTIVEAIRE
 Maryland Mechanical
 8120 Woodmont Avenue, Suite 720, Bethesda, MD, 20814
 PHONE: (800) 988-0881 FAX: 9192275931 EMAIL: reg76@captivaire.com

Cava - Willowbrook, IL
 7135 Kingery Highway,
 Willowbrook, IL, 60527

DATE: 12/11/2024

DWG #: 7217865

DRAWN BY: AJP-32

SCALE: 3/4" = 1'-0"

MASTER DRAWING

SHEET NO. 4

CAPTIVEAIRE HOOD DRAWINGS FOR REFERENCE ONLY

annex ENGINEERING GROUP
 589 W. Nationwide Blvd. Ste. B
 Columbus, Ohio 43215
 tel: 614.481.2292

COPYRIGHT 2025. ALL DRAWINGS AND SPECIFICATIONS SHALL REMAIN THE PROPERTY OF ANNEX ENGINEERING GROUP AND MAY NOT BE USED, DUPLICATED OR ALTERED WITHOUT THE WRITTEN CONSENT OF THE ENGINEER.

CAVA
 CAVA #580 - WILLOWBROOK, IL
 7135 KINGERY HIGHWAY
 WILLOWBROOK, IL 60527
 FOR CAVA
 14 Ridge Square NW #500, WASHINGTON, DC 20016

PROJECT NUMBER: CAV152

ISSUE	DATE
PERMIT SET	12.20.2024
REVISION 1	01.31.2025
REVISION 2	03.31.25

CAPTIVEAIRE HOOD DRAWINGS FOR REFERENCE ONLY

SHEET: **H1.4**

FAN #2 EARTU1-I.260-15-5T-MPU - HEATER (MAU)

NOTES:

- DO NOT OBSTRUCT OUTSIDE AIR INLET, OUTSIDE AIR COIL OR OUTSIDE AIR FAN.
- DENOTES CORNER WEIGHT.
- ROOF OPENING MUST BE 2" SMALLER THAN CURB DIMENSIONS IN BOTH DIRECTIONS.
- CONNECTION FROM BREAKER TO UNITS SAFETY DISCONNECT SWITCH TO BE COPPER WIRE ONLY.
- EXTERIOR GAS CONNECTION PROVIDED BY FACTORY WITH QUICK SEAL AND ANTI-ROTATION BRACKET.

*NOTE: SUPPLY DUCT MUST BE INSTALLED TO MEET SMACNA STANDARDS. A MINIMUM STRAIGHT DUCT LENGTH MUST BE MAINTAINED DOWNSTREAM OF UNIT DISCHARGE AS OUTLINED IN AMCA PUBLICATION 201. WHEN USING RECTANGULAR DUCTWORK, ELBOWS MUST BE RADIUS THROAT, RADIUS BACK WITH TURNING VANES. FLEXIBLE DUCTWORK AND SQUARE THROAT/SQUARE BACK ELBOWS SHOULD NOT BE USED. ANY TRANSITION AND/OR TURNS IN THE DUCTWORK WILL CAUSE SYSTEM EFFECT. SYSTEM EFFECT WILL DRASTICALLY INCREASE STATIC PRESSURE AND REDUCE AIRFLOW. DO NOT RELY ON UNIT TO SUPPORT DUCT IN ANY WAY. FAILURE TO PROPERLY SIZE DUCTWORK MAY CAUSE SYSTEM EFFECTS AND REDUCE PERFORMANCE OF THE EQUIPMENT. SUGGESTED STRAIGHT DUCT SIZE IS 20.75" x 21.5".

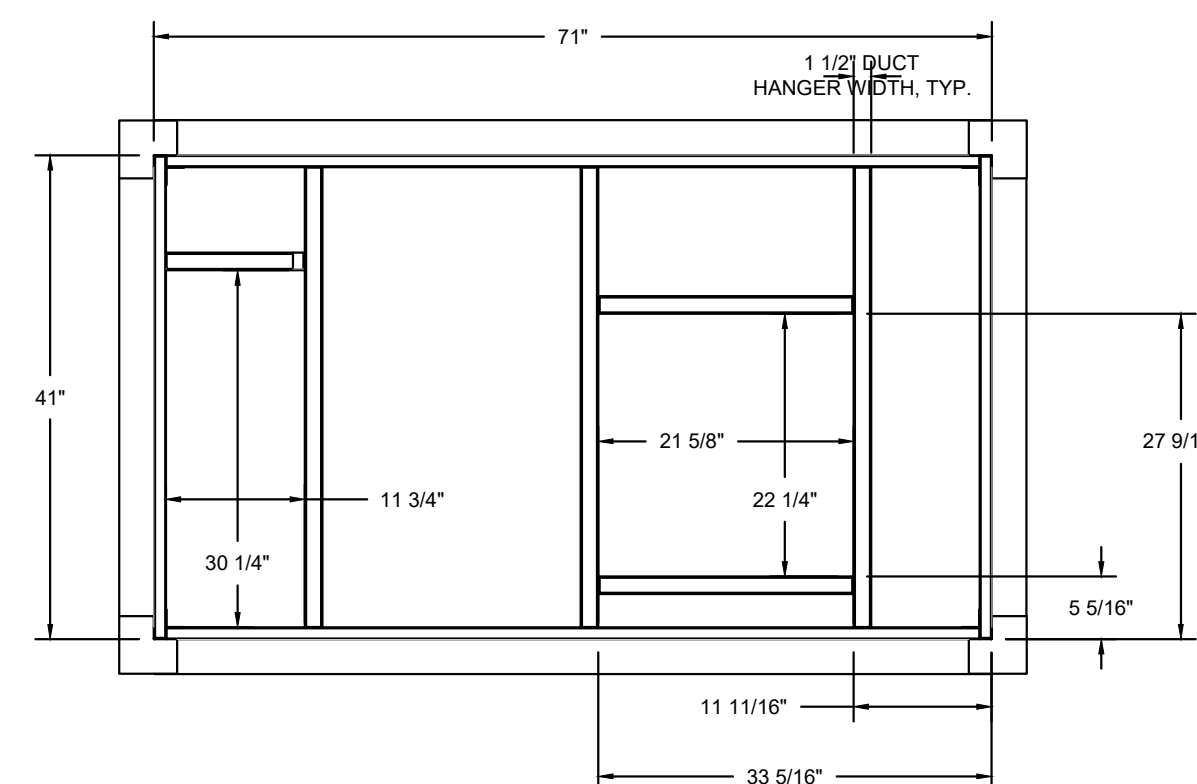
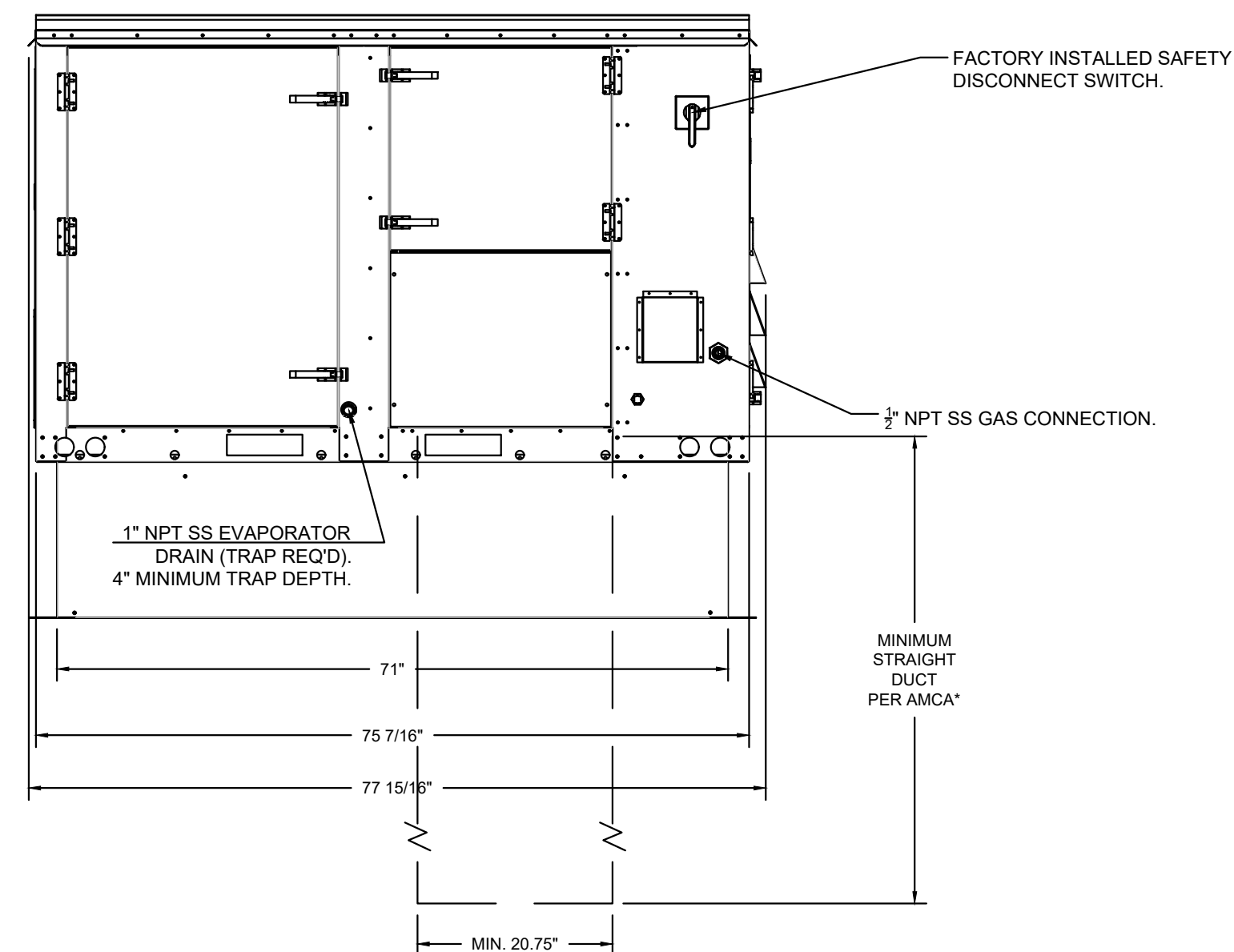
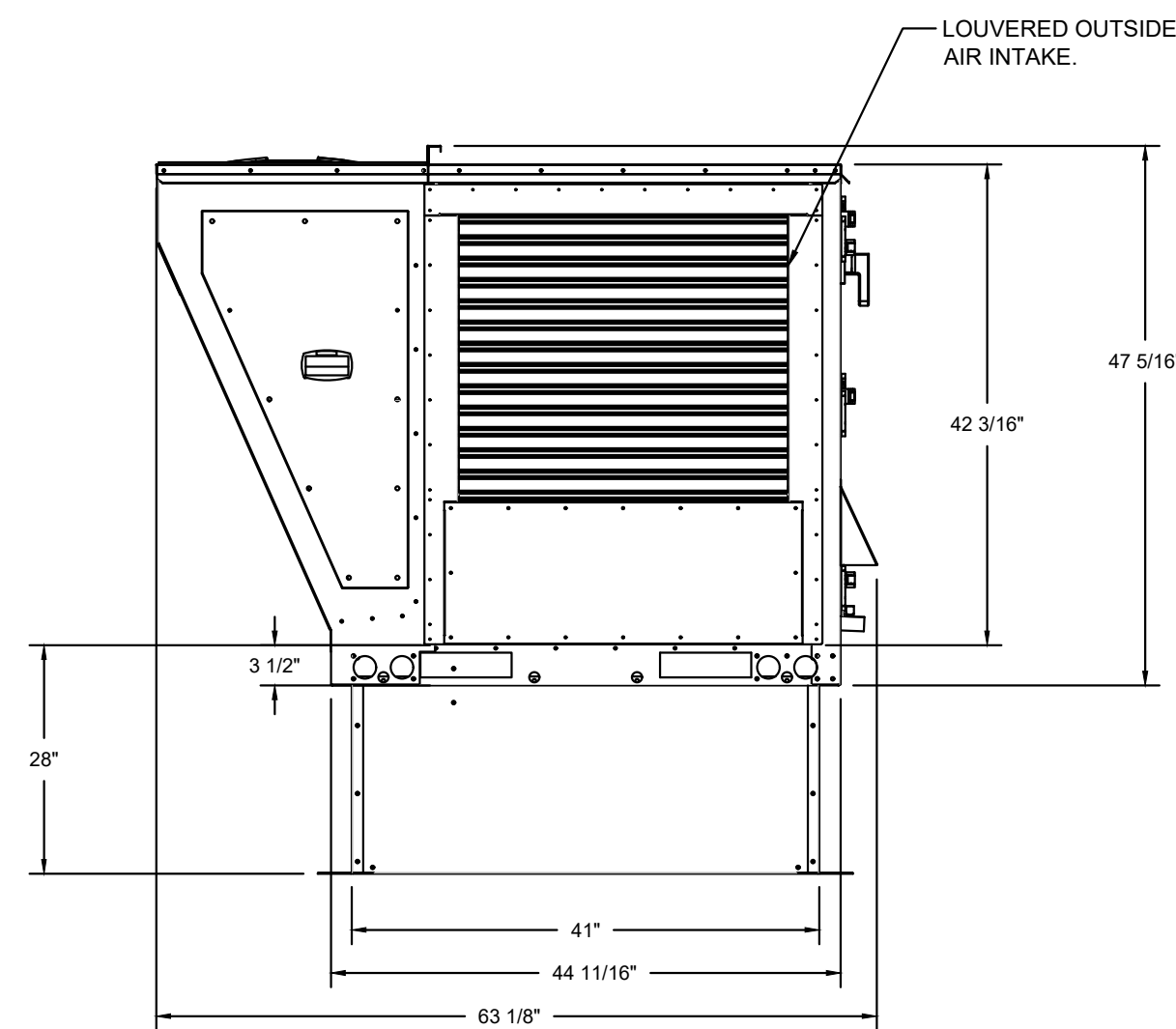
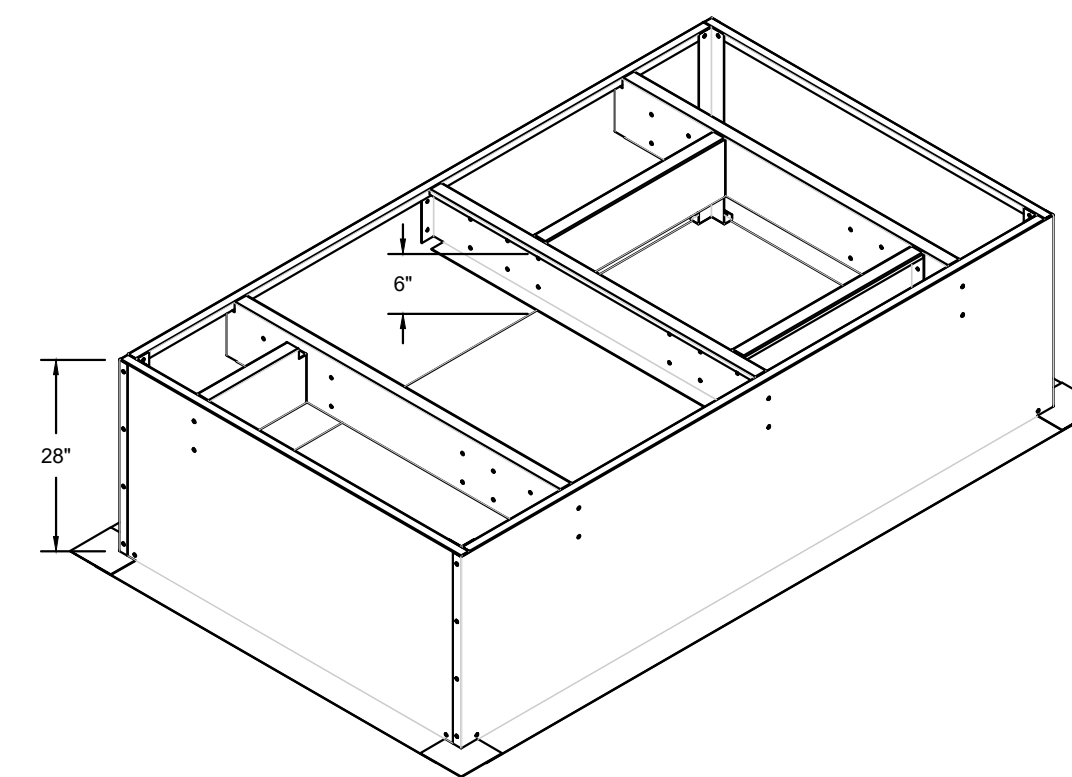
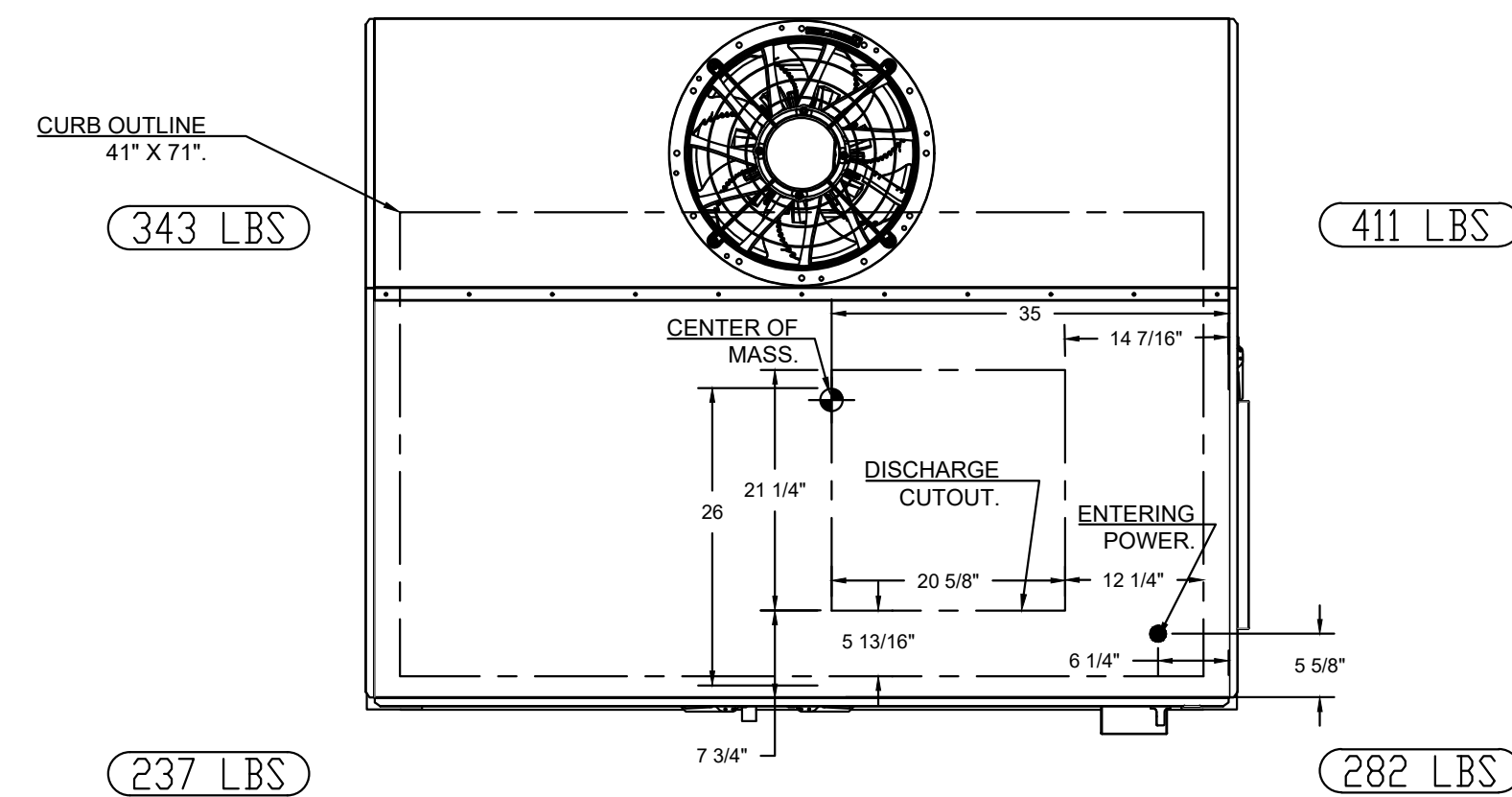
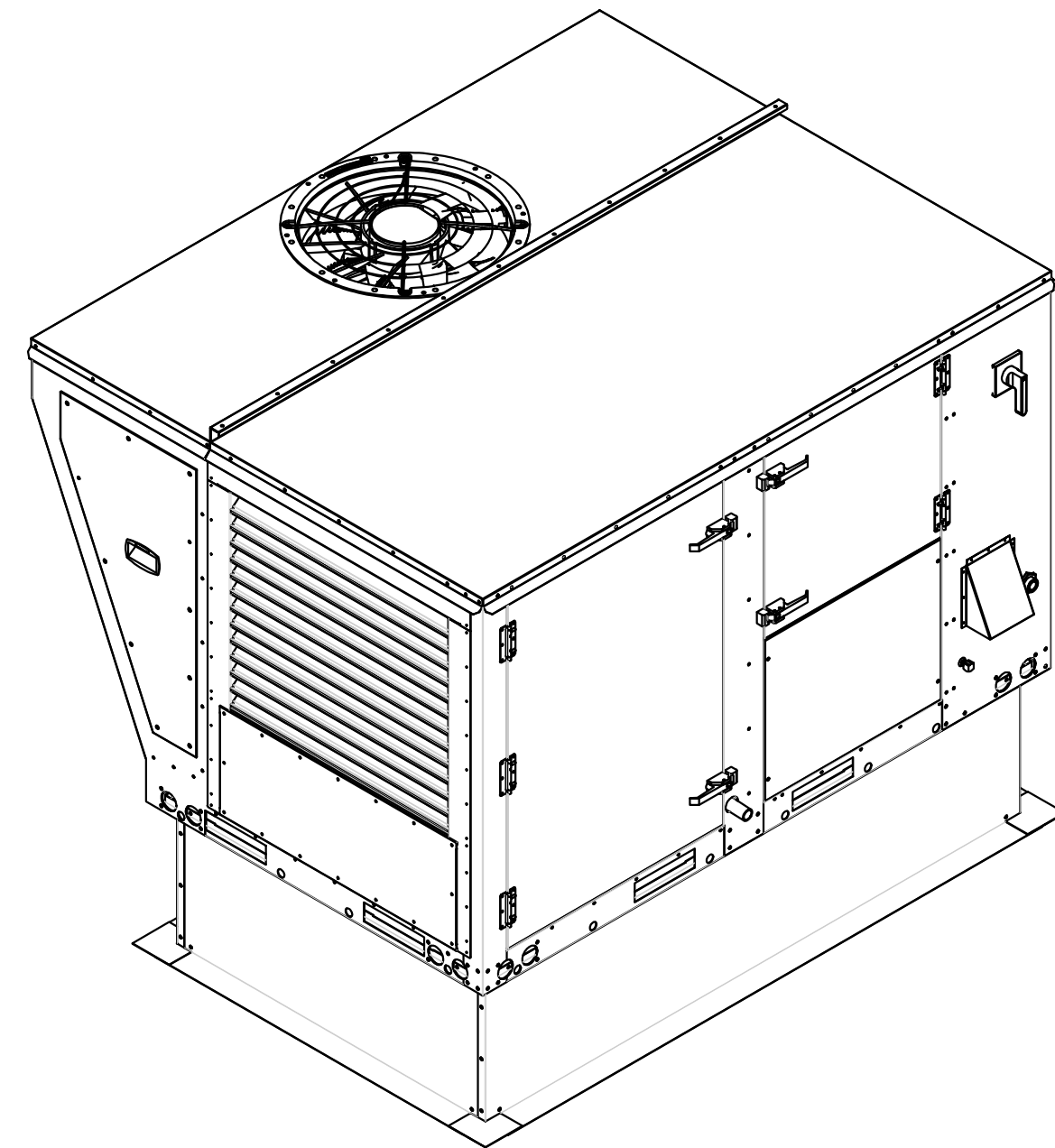

REVISIONS	
DESCRIPTION	DATE

CAPTIVE

Maryland Mechanical
8120 Woodmont Avenue, Suite 720, Bethesda, MD, 20814 PHONE: (800) 968-0881 FAX: 9192275931 EMAIL: reg76@captiveair.com

Cava - Willowbrook, IL
7135 Kingery Highway,
Willowbrook, IL, 60527

DATE: 12/11/2024

DWG.#:
7217865

DRAWN BY: AJP-32

SCALE:
3/4" = 1'-0"

MASTER DRAWING

SHEET NO.
5

COPYRIGHT 2025. ALL DRAWINGS AND SPECIFICATIONS SHALL REMAIN THE PROPERTY OF ANNEX ENGINEERING GROUP AND MAY NOT BE USED, DUPLICATED OR ALTERED WITHOUT THE WRITTEN CONSENT OF THE ENGINEER.

CAVA
CAVA #580 - WILLOWBROOK, IL
7135 KINGERY HIGHWAY
WILLOWBROOK, IL 60527
FOR CAVA
14 Ridge Square NW #500, WASHINGTON, DC 20016

PROJECT NUMBER:
CAV152

ISSUE	DATE
PERMIT SET	12.20.2024
REVISION 1	01.31.2025
REVISION 2	03.31.25

CAPTIVE AIRE HOOD DRAWINGS FOR REFERENCE ONLY

SHEET:

H1.5

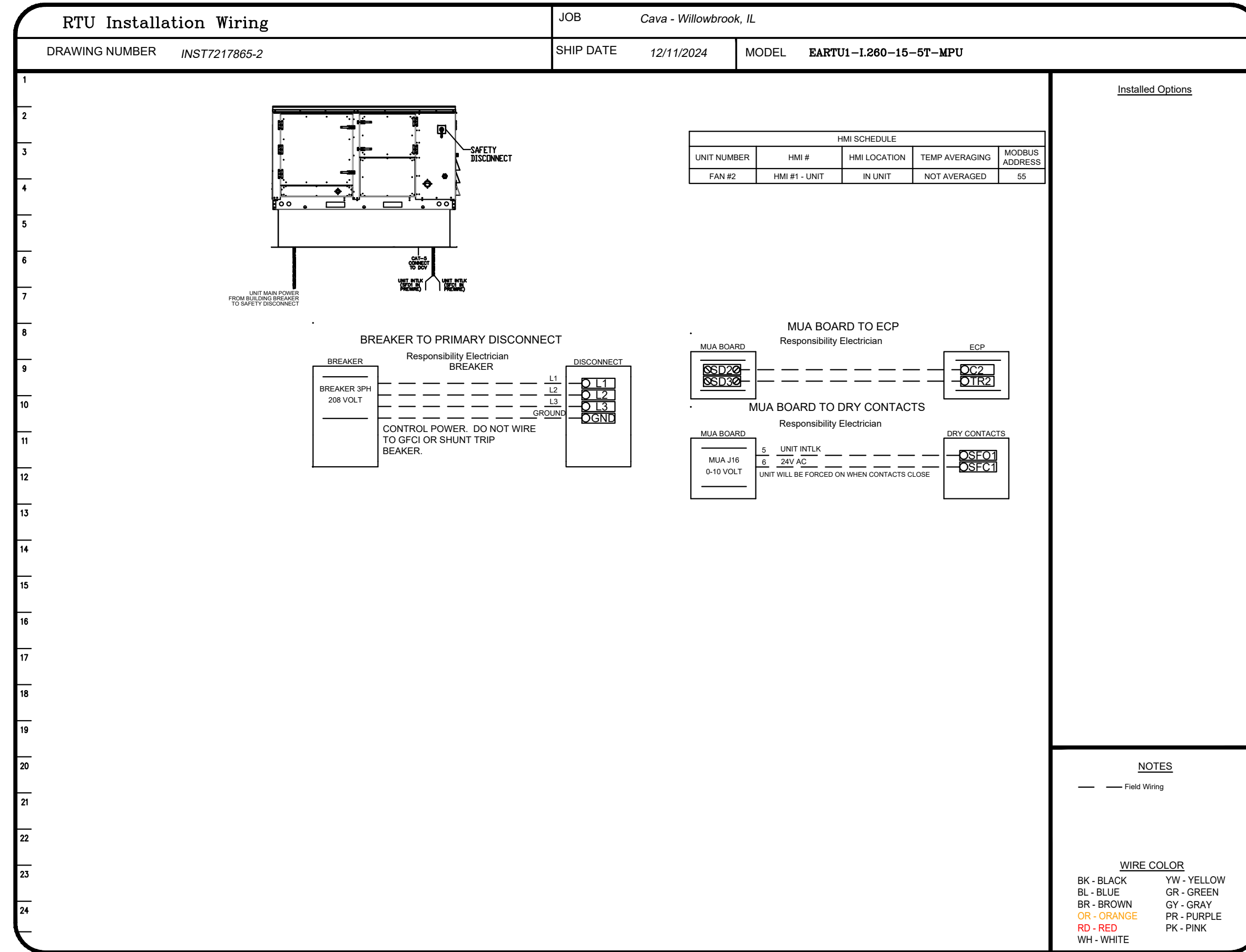
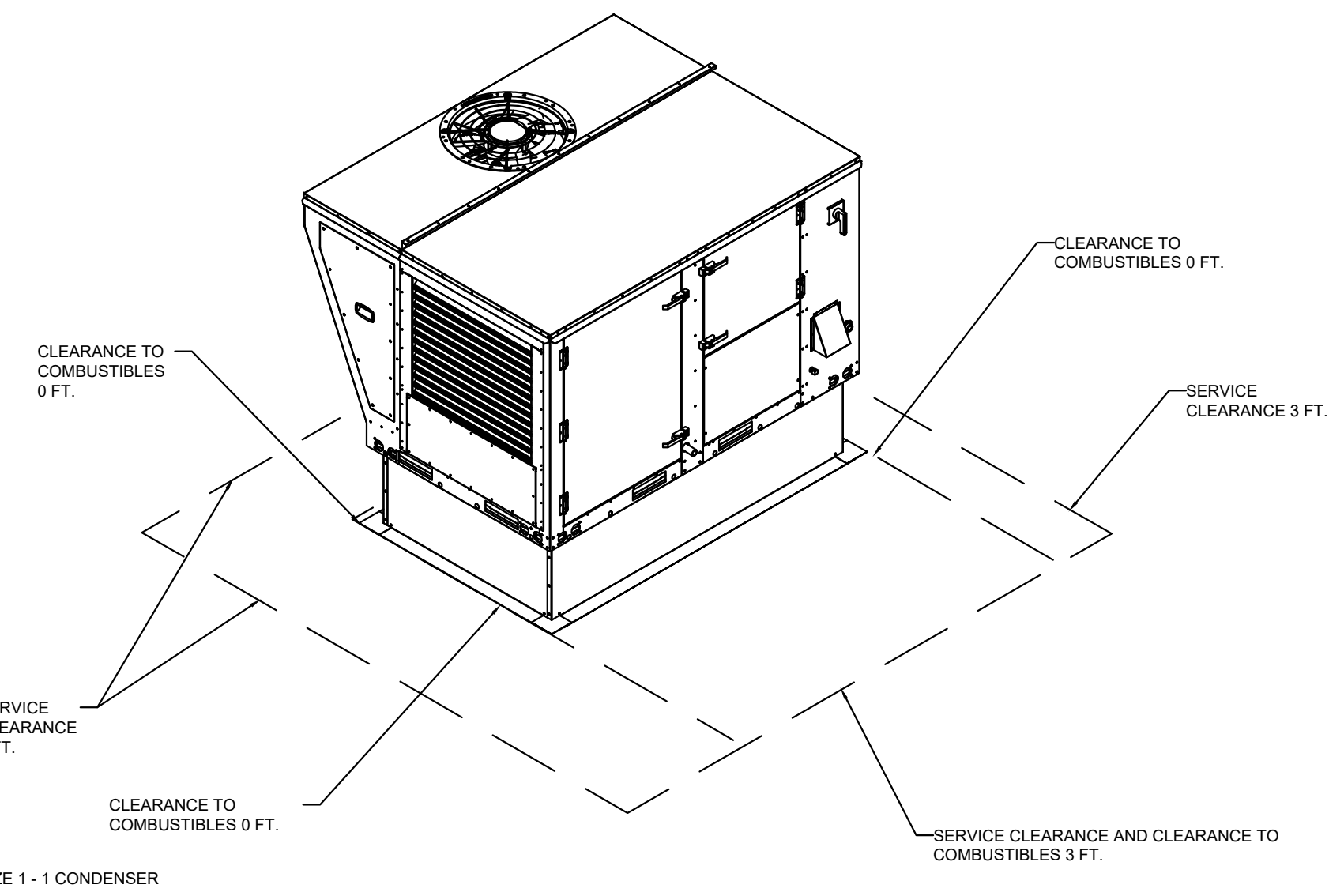

REVISIONS

NO.	DESCRIPTION	DATE

CAPTIVE

Maryland Mechanical

8120 Woodmont Avenue, Suite 720, Bethesda, MD, 20814 PHONE: (800) 988-0881 FAX: 9192278931 EMAIL: reg76@captivair.com

TYPICAL DOAS/RTU ROOF MOUNTING INSTALLATION INSTRUCTIONS

- SECURE THE CURB TO THE ROOF FRAMING MEMBERS BY DRILLING 1/4" PILOT HOLES IN THE CURB FLANGES AT LOCATIONS SHOWN IN THE DIAGRAM BELOW. USING 3/8" X 2" ZINC PLATED STEEL LAG BOLTS, AND ZINC PLATED WASHERS, SCREW THROUGH THE CURB FLANGES AND INTO THE ROOF FRAMING MEMBERS. A MINIMUM OF (5) LAG BOLTS ON EACH SHORT SIDE, AND (7) LAG BOLTS ON EACH LONG SIDE IS REQUIRED.
- SECURE THE UNIT BASE TO THE SIDE WALLS OF THE CURB USING (24) 1/4"-14 X 2" SELF-DRILLING, STEEL ZINC PLATED SCREWS. PRE-PUNCHED HOLES HAVE BEEN PROVIDED FOR EACH SCREW LOCATION.

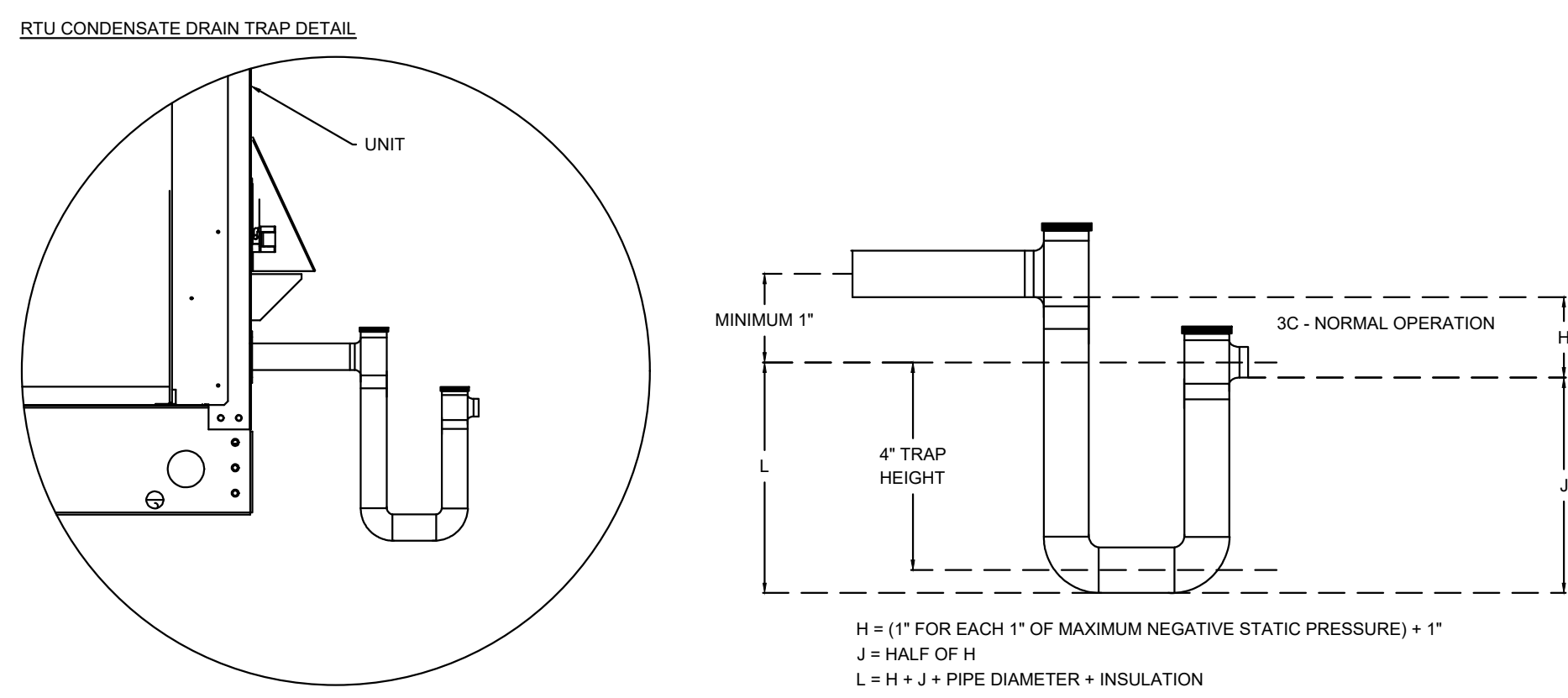

CAPTIVE AIR HOOD DRAWINGS FOR REFERENCE ONLY

annex ENGINEERING GROUP

589 W. Nationwide Blvd. Ste. B
Columbus, Ohio 43215
tel: 614.481.2292

COPYRIGHT 2025. ALL DRAWINGS AND SPECIFICATIONS SHALL REMAIN THE PROPERTY OF ANNEX ENGINEERING GROUP AND MAY NOT BE USED, DUPLICATED OR ALTERED WITHOUT THE WRITTEN CONSENT OF THE ENGINEER.

CAVA

CAVA #580 - WILLOWBROOK, IL
7135 KINGERY HIGHWAY
WILLOWBROOK, IL 60527
FOR CAVA
14 Ridge Square NW #500, WASHINGTON, DC 20016

Cava - Willowbrook, IL
7135 Kingery Highway,
Willowbrook, IL, 60527

DATE: 12/11/2024

DWG.#: 7217865

DRAWN BY: AJP-32

SCALE: 3/4" = 1'-0"

MASTER DRAWING

SHEET NO. 6

PROJECT NUMBER: CAV152

ISSUE	DATE
PERMIT SET	12.20.2024
REVISION 1	01.31.2025
REVISION 2	03.31.25

CAPTIVE AIR HOOD DRAWINGS FOR REFERENCE ONLY

SHEET: **H1.6**

ELECTRICAL PACKAGE - JOB#7217865

NO	TAG	PACKAGE #	LOCATION	SWITCHES		OPTION	FANS CONTROLLED					
				LOCATION	QUANTITY		FAN TAG	TYPE	#	HP	VOLT	FLA
1		DCV-1111	UTILITY CABINET LEFT	UTILITY CABINET LEFT	1 LIGHT	SMART CONTROLS DCV	KEF	EXHAUST	1	1,000	115	11.6
				HOOD # 1	1 FAN		MAU	SUPPLY	3	2,000	208	6.1

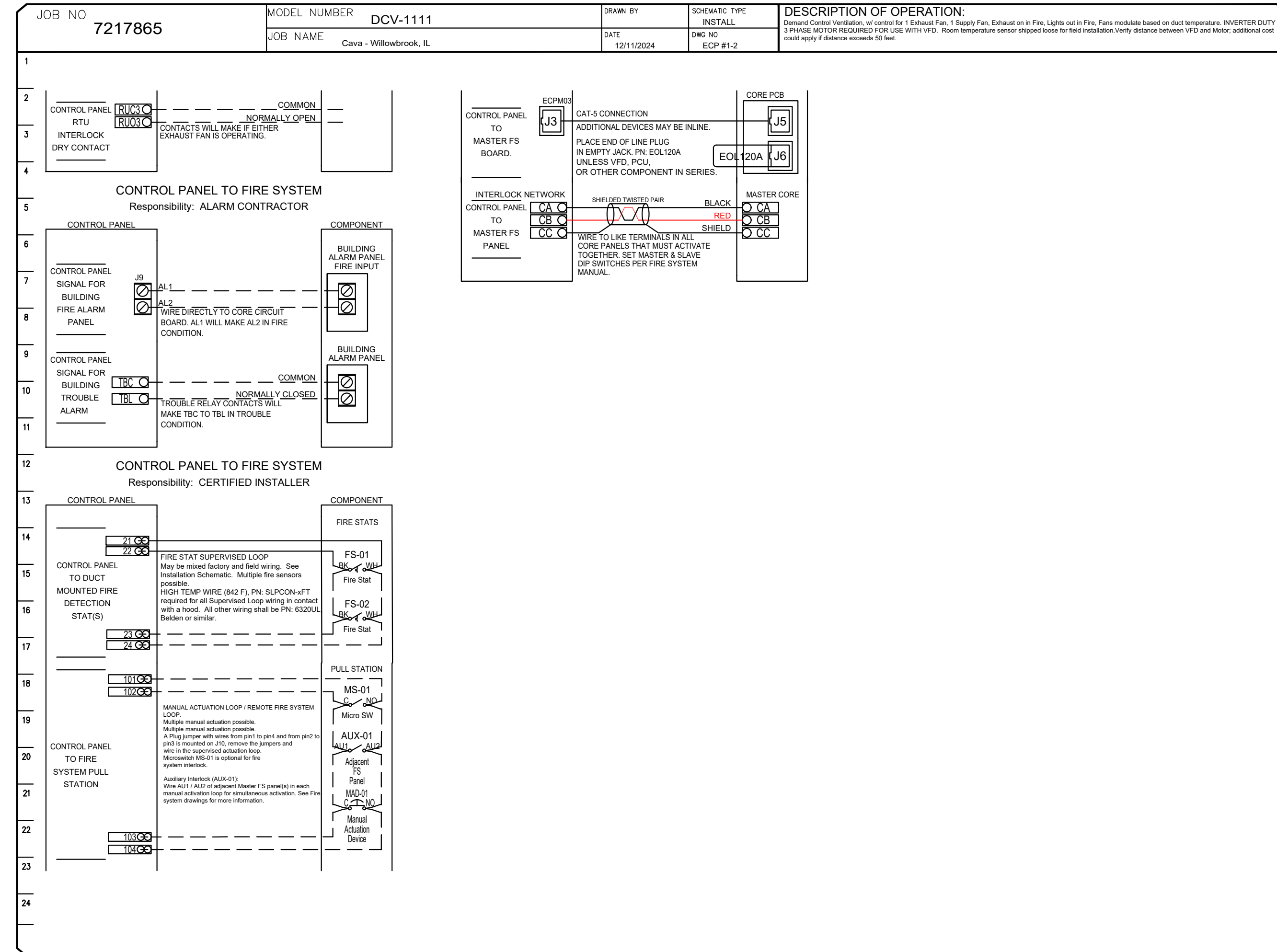
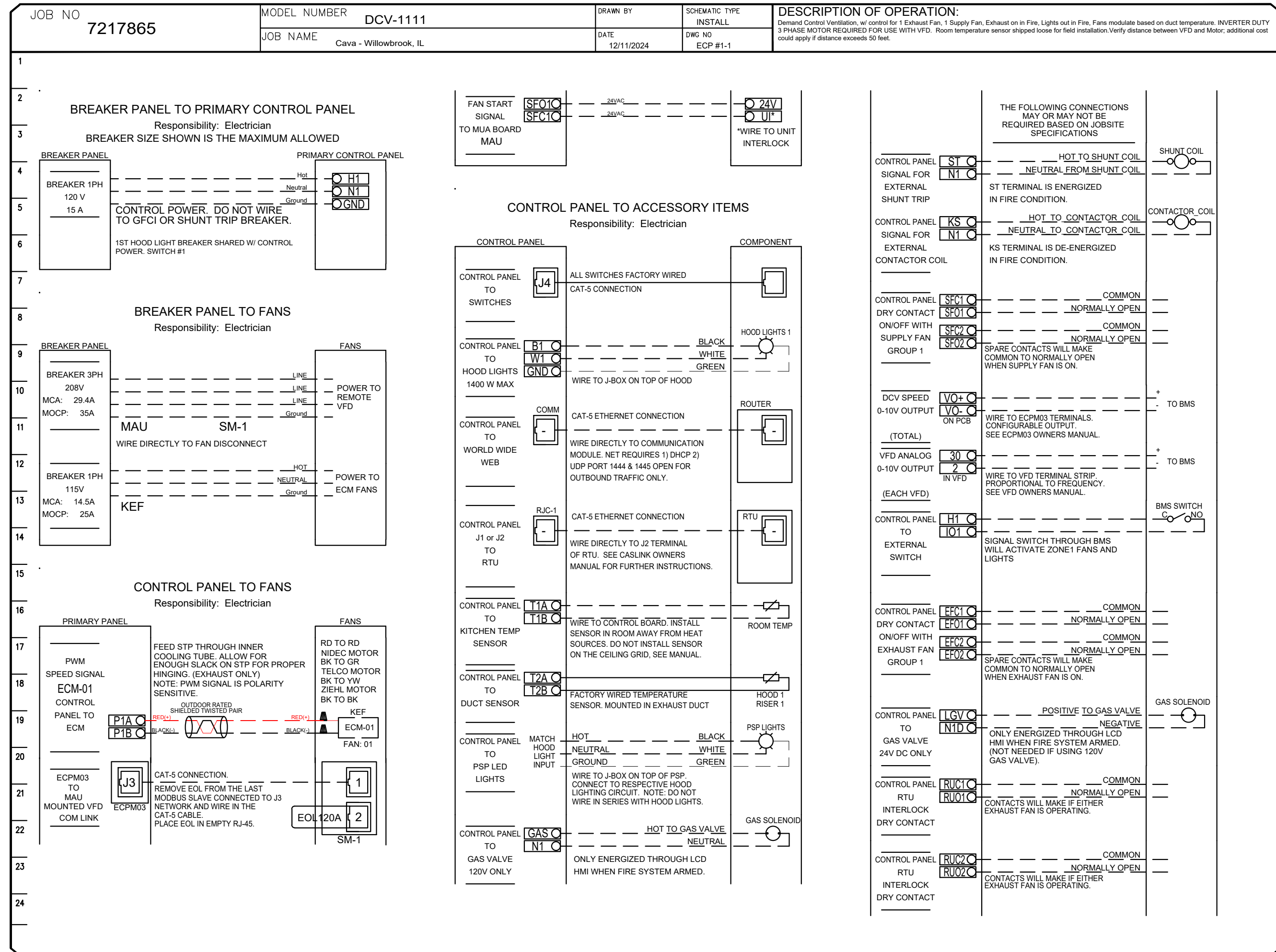

REVISIONS

NO.	DESCRIPTION	DATE

CAPTIVE

Maryland Mechanical
 8120 Woodmont Avenue, Suite 720, Bethesda, MD, 20814 PHONE: (800) 988-0881 FAX: 9192275931 EMAIL: reg76@captiveme.com

Cava - Willowbrook, IL
 7135 Kingery Highway,
 Willowbrook, IL, 60527

DATE: 12/11/2024

DWG.#:
 7217865

DRAWN BY:
 AJP-32

SCALE:
 3/4" = 1'-0"

MASTER DRAWING

SHEET NO.
 7

CAPTIVE AIRE HOOD DRAWINGS FOR REFERENCE ONLY

annex
 ENGINEERING GROUP
 589 W. Nationwide Blvd., Ste. B
 Columbus, Ohio 43215
 tel: 614.481.2292

COPYRIGHT 2025. ALL DRAWINGS AND SPECIFICATIONS SHALL REMAIN THE PROPERTY OF ANNEX ENGINEERING GROUP AND MAY NOT BE USED, DUPLICATED OR ALTERED WITHOUT THE WRITTEN CONSENT OF THE ENGINEER.

CAVA
 CAVA #580 - WILLOWBROOK, IL
 7135 KINGERY HIGHWAY
 WILLOWBROOK, IL 60527
 FOR CAVA
 14 Ridge Square NW #500, WASHINGTON, DC 20016

PROJECT NUMBER:
 CAV152

ISSUE	DATE
PERMIT SET	12.20.2024
REVISION 1	01.31.2025
REVISION 2	03.31.25

CAPTIVE AIRE HOOD DRAWINGS FOR REFERENCE ONLY

SHEET:
H1.7

DEMAND CONTROL VENTILATION HOOD CONTROL PANEL SPECIFICATIONS:

- CONTROLS SHALL BE LISTED BY ETL (UL 508A) AND SHALL COMPLY WITH DEMAND VENTILATION SYSTEM TURNDOWN REQUIREMENTS OUTLINED IN IECC 403.7.5 (2021).
- THE CONTROL ENCLOSURE SHALL BE NEMA 1 RATED AND LISTED FOR INSTALLATION INSIDE OF THE EXHAUST HOOD UTILITY CABINET. THE CONTROL ENCLOSURE MAY BE CONSTRUCTED OF STAINLESS STEEL OR PAINTED STEEL.
- TEMPERATURE PROBE(S) LOCATED IN THE EXHAUST DUCT RISER(S) SHALL BE CONSTRUCTED OF STAINLESS STEEL.
- A DIGITAL CONTROLLER SHALL BE PROVIDED TO ACTIVATE THE HOOD EXHAUST FANS DYNAMICALLY BASED ON A FIXED DIFFERENTIAL BETWEEN THE AMBIENT AND DUCT TEMPERATURES. THIS FUNCTION SHALL MEET THE REQUIREMENTS OF IMC 507.1.1.
- A DIGITAL CONTROLLER SHALL PROVIDE ADJUSTABLE HYSTERESIS SETTINGS TO PREVENT CYCLING OF THE FANS AFTER THE COOKING APPLIANCES HAVE BEEN TURNED OFF AND/OR THE HEAT IN THE EXHAUST SYSTEM IS REDUCED.
- A DIGITAL CONTROLLER SHALL PROVIDE AN ADJUSTABLE MINIMUM FAN RUN-TIME SETTING TO PREVENT FAN CYCLING.
- VARIABLE FREQUENCY DRIVES (VFDs) SHALL BE PROVIDED FOR FANS AS REQUIRED. THE DIGITAL CONTROLLER SHALL MODULATE THE VFDs BETWEEN A MINIMUM SETPOINT AND A MAXIMUM SETPOINT ON DEMAND. THE DUCT TEMPERATURE SENSOR INPUT(S) TO THE DIGITAL CONTROLLER SHALL BE USED TO CALCULATE THE SPEED REFERENCE SIGNAL.
- THE VFD SPEED RANGE OF OPERATION SHALL BE FROM 0% TO 100% FOR THE SYSTEM, WITH THE ACTUAL MINIMUM SPEED SET AS REQUIRED TO MEET MINIMUM VENTILATION REQUIREMENTS.
- AN INTERNAL ALGORITHM TO THE DIGITAL CONTROLLER SHALL MODULATE SUPPLY FAN VFD SPEED PROPORTIONAL TO ALL EXHAUST FANS THAT ARE LOCATED IN THE SAME FAN GROUP AS THE SUPPLY FAN.
- THE SYSTEM SHALL OPERATE IN PREP MODE DURING LIGHT COOKING LOAD OR COOL DOWN MODE WHEN SUFFICIENT HEAT REMAINS UNDERNEATH THE HOOD SYSTEM AFTER COOKING OPERATIONS HAVE COMPLETED. OPERATION DURING EITHER OF THESE PERIODS WILL DISABLE THE SUPPLY FANS AND PROVIDE AN EXHAUST FAN SPEED THAT IS EQUAL TO THE MINIMUM VENTILATION REQUIREMENT.
- A DIGITAL CONTROLLER SHALL DISABLE THE SUPPLY FAN(S), ACTIVATE THE EXHAUST FAN(S), ACTIVATE THE APPLIANCE SHUNT TRIP, AND DISABLE AN ELECTRIC GAS VALVE AUTOMATICALLY WHEN FIRE CONDITION IS DETECTED ON A COVERED HOOD.
- A DIGITAL CONTROLLER SHALL ALLOW FOR EXTERNAL BMS FAN CONTROL VIA DRY CONTACT (EXTERNAL CONTROL SHALL NOT OVERRIDE FAN OPERATION LOGIC AS REQUIRED BY CODE).
- AN LCD INTERFACE SHALL BE PROVIDED WITH THE FOLLOWING FEATURES:
 - A. ON/OFF PUSH BUTTON FAN & LIGHT SWITCH ACTIVATION.
 - B. INTEGRATED GAS VALVE RESET FOR ELECTRONIC GAS VALVES (NO RESET RELAY REQUIRED).
 - C. VFD FAULT DISPLAY WITH AUDIBLE & VISUAL ALARM NOTIFICATION.
 - D. DUCT TEMPERATURE SENSOR FAILURE DETECTION WITH AUDIBLE & VISUAL ALARM NOTIFICATION.
 - E. MIS-WIRED DUCT TEMPERATURE SENSOR DETECTION WITH AUDIBLE & VISUAL ALARM NOTIFICATION.
 - F. A SINGLE LOW VOLTAGE CAT-5 RJ45 WIRING CONNECTION.
 - G. AN ENERGY SAVINGS INDICATOR THAT UTILIZES MEASURED KWH FROM THE VFDs.

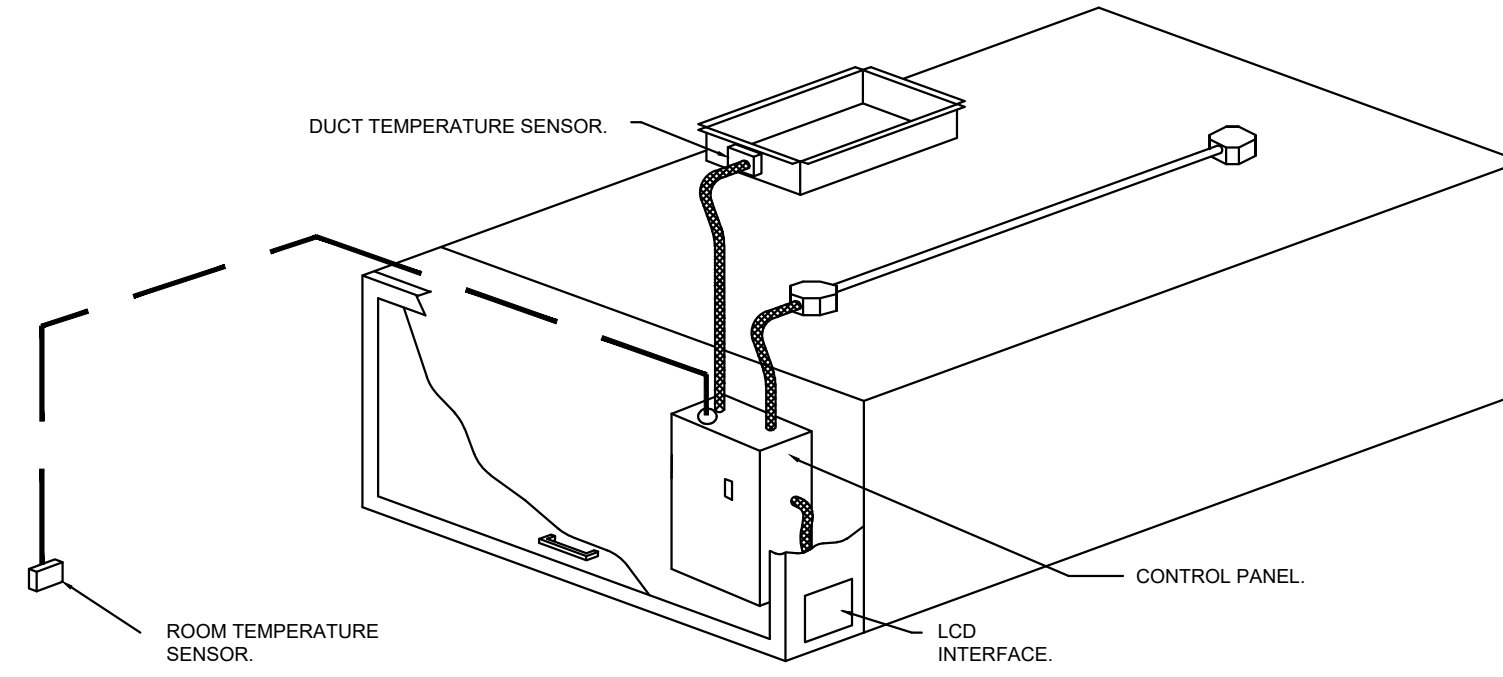

TYPICAL HOOD CONTROL PANEL INSTALLATION

SEQUENCE OF OPERATIONS:

THE HOOD CONTROL PANEL IS CAPABLE OF OPERATING IN ONE OR MORE OF THE FOLLOWING STATES AT ANY GIVEN TIME:

- **AUTOMATIC:** THE SYSTEM OPERATES BASED ON THE DIFFERENTIAL BETWEEN ROOM TEMPERATURE AND THE TEMPERATURE AT THE HOOD CAVITY OR EXHAUST DUCT COLLAR. FANS ACTIVATE AT A CONFIGURABLE TEMPERATURE DIFFERENTIAL THRESHOLD. DEPENDING ON THE JOB CONFIGURATION EACH FAN ZONE CAN BE CONFIGURED AS STATIC OR DYNAMIC. THESE TERMS REFER TO WHETHER A VARIABLE MOTOR (SUCH AS EC MOTORS OR VFD DRIVEN MOTORS) MODULATE WITH TEMPERATURE. IF THE PANEL IS EQUIPPED WITH VARIABLE SPEED FANS AND THE ZONE IS DEFINED AS "DYNAMIC", THESE WILL MODULATE WITHIN A USER-DEFINED RANGE BASED ON THE TEMPERATURE DIFFERENTIAL. PANELS EQUIPPED WITH VARIABLE SPEED FANS AND A FAN ZONE DEFINED AS "STATIC", FANS WILL RUN AT A SET SPEED CALCULATED FOR THE DRIVE. DEMAND CONTROL VENTILATION SYSTEMS ARE CAPABLE OF MODULATING EXHAUST AND MAKE UP AIR FAN SPEEDS PER THE REQUIREMENTS OUTLINED IN IECC 403.7.5 (2021).
- **MANUAL:** THE SYSTEM OPERATES BASED ON HUMAN INPUT FROM AN HMI.
- **SCHEDULE:** A WEEKLY SCHEDULE CAN BE SET TO RUN FANS FOR A SPECIFIED PERIOD THROUGHOUT THE DAY. THERE ARE THREE OCCUPIED TIMES PER DAY TO ALLOW FOR THE USER TO SET UP A TIME THAT IS SUITABLE TO THEIR NEEDS. ANY TIME THAT IS WITHIN THE DEFINED OCCUPIED TIME, THE SYSTEM WILL RUN AT MODULATION MODE AND FOLLOW THE FAN PROCEDURE ALGORITHM BASED ON TEMPERATURE DURING THIS TIME. DURING UNOCCUPIED TIME, THE SYSTEM WILL HAVE AN EXTRA OFFSET TO PREVENT UNINTENDED ACTIVATION OF THE SYSTEM DURING A TIME WHERE THE SYSTEM IS NOT BEING OCCUPIED.
- **OTHER:** THE SYSTEM OPERATES BASED ON THE INPUT FROM AN EXTERNAL SOURCE (DDC, BMS OR HARD-WIRED INTERLOCK).
- **FIRE:** UPON ACTIVATION OF THE HOOD FIRE SUPPRESSION SYSTEM, THE EXHAUST FAN WILL COME ON OR CONTINUE TO TO RUN, THE HOOD MAKEUP AIR WILL SHUTDOWN, AND A SIGNAL WILL BE SENT FOR ACTIVATING THE SHUNT TRIP BREAKER PROVIDED BY THE ELECTRICIAN. FUEL GAS WILL SHUT OFF VIA A MECHANICAL/ELECTRICAL GAS VALVE ACTUATED BY THE HOOD FIRE SUPPRESSION SYSTEM.

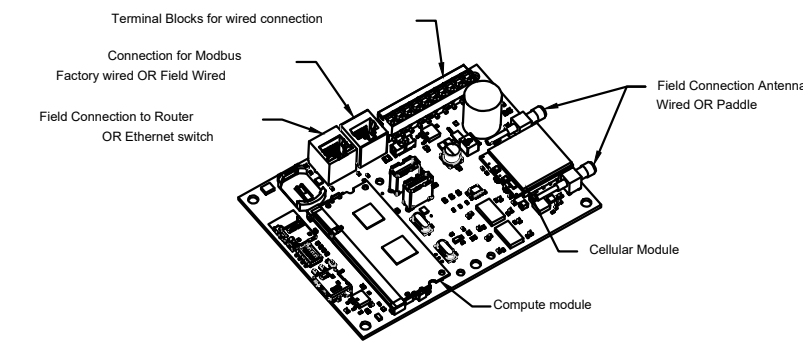

CASink Monitor and Control

- Hood control panel to support communications to cloud-based Building Management System.
- Hood Control Panel to allow cloud-based Building Management System to monitor real time parameters outlined as **MONITOR** in the points list.
- Hood Control Panel to allow cloud-based Building Management System to control parameters outlined as **CONTROL** in the points list.
- Hood Control Panel to allow cloud-based Building Management System to implement **SYSTEM ECONOMIZER** control strategies for fully integrated Building Management.

MONITORING AND CONTROL POINTS LIST

DCV Packages	Function	DC Packages	Function
Room Temperature	MONITOR	Room Temperature(s)	MONITOR
Duct Temperature(s)	MONITOR	Duct Temperature(s)	MONITOR
MUA Discharge Temperature	MONITOR	MUA Discharge Temperature	MONITOR
Kitchen RTU Discharge Temperature	MONITOR	Kitchen RTU Discharge Temperature	MONITOR
Fan Speed	MONITOR	Controller Faults	MONITOR
Fan Amperage	MONITOR	Fan Faults	MONITOR
Fan Power	MONITOR	Fan Status	MONITOR
TFD Faults	MONITOR	PCU Faults	MONITOR
Controller Faults	MONITOR	PCU Filter Clg Percentages	MONITOR
Fan Faults	MONITOR	Fan Condition	MONITOR
Fan Status	MONITOR	CORE Fire System	MONITOR
PCU Faults	MONITOR	Building Pressures	MONITOR
PCU Filter Clg Percentages	MONITOR	Fans Status(s)	MONITOR & CONTROL
Fire Condition	MONITOR	Light Buttons(s)	MONITOR & CONTROL
CORE Fire System	MONITOR	Flush Button	MONITOR & CONTROL
Building Pressures	MONITOR		
Prog Time Buttons	MONITOR & CONTROL		
Fans Buttons	MONITOR & CONTROL		
Light Buttons	MONITOR & CONTROL		
Flush Button	MONITOR & CONTROL		

SYSTEM DESIGN VERIFICATION (SDV)

IF ORDERED, CAS SERVICE WILL PERFORM A SYSTEM DESIGN VERIFICATION (SDV) ONCE ALL EQUIPMENT HAS HAD A COMPLETE START UP PER THE OPERATION AND INSTALLATION MANUAL. TYPICALLY, THE SDV WILL BE PERFORMED AFTER ALL INSPECTIONS ARE COMPLETE.

ANY FIELD RELATED DISCREPANCIES THAT ARE DISCOVERED DURING THE SDV WILL BE BROUGHT TO THE ATTENTION OF THE GENERAL CONTRACTOR AND CORRESPONDING TRADES ON SITE. THESE ISSUES WILL BE DOCUMENTED AND FORWARDED TO THE APPROPRIATE SALES OFFICE. IF CAS SERVICE HAS TO RESOLVE A DISCREPANCY THAT IS A FIELD ISSUE, THE GENERAL CONTRACTOR WILL BE NOTIFIED AND BILLED FOR THE WORK. SHOULD A RETURN TRIP BE REQUIRED DUE TO ANY FIELD RELATED DISCREPANCY THAT CANNOT BE RESOLVED DURING THE SDV, THERE WILL BE ADDITIONAL TRIP CHARGES.

DURING THE SDV, CAS SERVICE WILL ADDRESS ANY DISCREPANCY THAT IS THE FAULT OF THE MANUFACTURER. SHOULD A RETURN TRIP BE REQUIRED, THE GENERAL CONTRACTOR AND APPROPRIATE SALES OFFICE WILL BE NOTIFIED. THERE WILL BE NO ADDITIONAL CHARGES FOR MANUFACTURER DISCREPANCIES.

REVISIONS	
DESCRIPTION	DATE

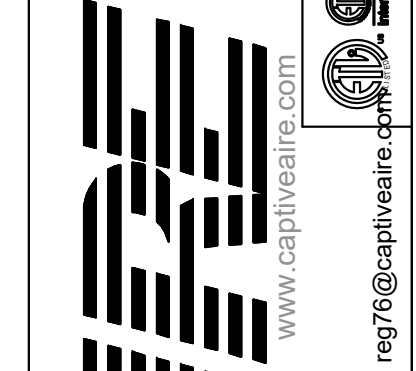

CAPTIVE AIR
 Maryland Mechanical
 6120 Woodmont Avenue, Suite 720, Bethesda, MD, 20814
 PHONE: (800) 988-0881 FAX: (919) 227-5931 EMAIL: reg76@captiveaire.com

Cava - Willowbrook, IL
 7135 Kingery Highway,
 Willowbrook, IL, 60527

DATE: 12/11/2024
DWG.#: 7217865
DRAWN BY: AJP-32
SCALE: 3/4" = 1'-0"
MASTER DRAWING

SHEET NO.
8

CAPTIVE AIR HOOD DRAWINGS FOR REFERENCE ONLY

annex
ENGINEERING GROUP
589 W. Nationwide Blvd. Ste. B
Columbus, Ohio 43215
tel: 614.481.2292

CAVA
CAVA #580 - WILLOWBROOK, IL
7135 KINGERY HIGHWAY
WILLOWBROOK, IL 60527
FOR CAVA
14 Ridge Square NW #500, WASHINGTON, DC 20016

COPYRIGHT 2025. ALL DRAWINGS AND SPECIFICATIONS SHALL REMAIN THE PROPERTY OF ANNEX ENGINEERING GROUP AND MAY NOT BE USED, DUPLICATED OR ALTERED WITHOUT THE WRITTEN CONSENT OF THE ENGINEER.

PROJECT NUMBER:	DATE
CAV152	12.20.2024
ISSUE	01.31.2025
PERMIT SET	03.31.25
REVISION 1	
REVISION 2	

CAPTIVE AIR HOOD DRAWINGS FOR REFERENCE ONLY

SHEET:
H1.8