

**1 FLOOR PLAN - HVAC**  
SCALE: 1/8"=1'-0"

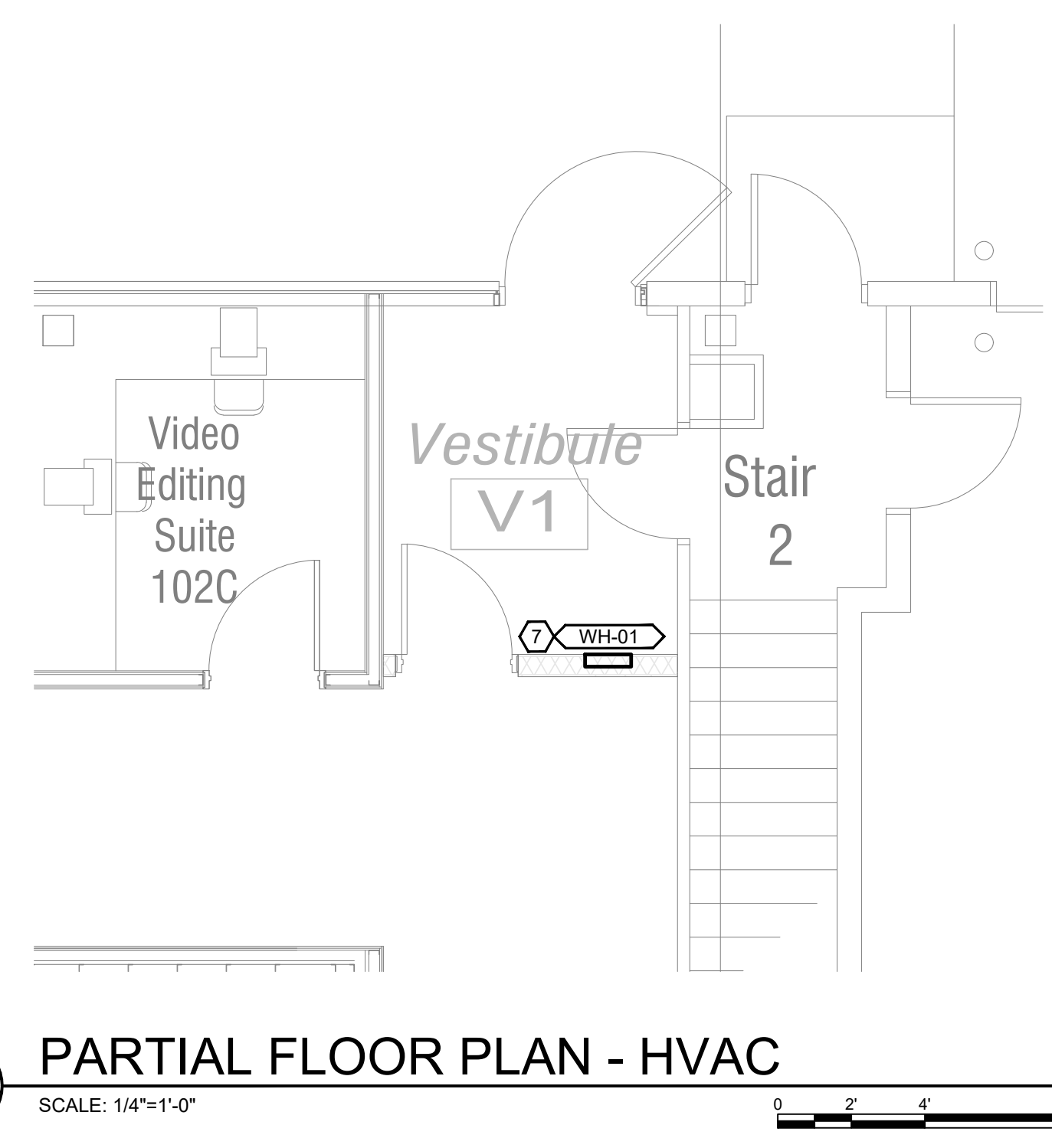

**1 PARTIAL FLOOR PLAN - HVAC**  
SCALE: 1/4"=1'-0"

**GENERAL NOTES:**

- A. REFER TO SHEET M0.1 FOR GENERAL NOTES.
- B. ALL EQUIPMENT SHALL BE INSTALLED IN STRICT ACCORDANCE WITH MANUFACTURERS INSTRUCTIONS.

**SHEET KEYNOTES:**

1. VAV BOX WITH HOT WATER COIL. PROVIDE DUCT TRANSITION ON EITHER SIDE AS REQUIRED.
2. INSTALL MINIMUM 3-FT STRAIGHT DUCT PIECE BETWEEN EXISTING ELBOWS TO ALLOW INSTALLATION OF DUCT SMOKE DETECTOR. MATCH EXISTING DUCT SIZE.
3. PROVIDE FULL-SIZE DUCTED SOUND TRAP EXTENDING MIN. 36" ABOVE TOP OF EXISTING PROPELLER FAN. SOUND TRAP SHALL BE INTERNALLY LINED WITH 1/2" ACOUSTIC INSULATION.
4. PROVIDE CONTINUOUS DUCT PLENUM BEHIND RETURN GRILLES. MINIMUM 24" TYPICAL OF ALL.
5. DUCTWORK ASSOCIATED WITH THIS ROOFTOP UNIT SHALL BE ROUTED AT 16'-0" AFF TO CONDITION PLENUM SPACE. TYPICAL.
6. COMBINATION TEMPERATURE-HUMIDITY SENSOR TO BE MOUNTED IN RETURN DUCTWORK. INITIAL SETPOINT SHALL BE 50°F (HEATING); 80°F/50% RH (COOLING).
7. ELECTRIC WALL HEATER TO BE INSTALLED AT 12" AFF.
8. ROOFTOP FAN TO BE MOUNTED ON 14" INSULATED CURB.
9. DUCTWORK ASSOCIATED WITH EF-K1 SHALL BE 304 STAINLESS STEEL MATERIAL.
10. DUCT STATIC PRESSURE SENSOR TO BE INSTALLED AT THIS LOCATION FOR UNIT SUPPLY FAN SPEED CONTROL.
11. DIFFERENTIAL PRESSURE SENSORS TO BE INSTALLED AT 12'-0" AFF FOR EXHAUST FAN MODULATION. INITIAL SETPOINT TO BE +0.05" W.C.

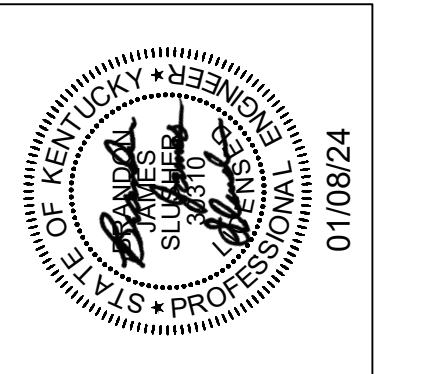

**Ignite Institute Renovations**  
Erlanger, Kentucky  
Boone Co. Board of Education  
Matt Turner - Superintendent

SHEET TITLE  
**FLOOR PLAN - HVAC**

BG #  
23-468  
REH #  
129-423  
DATE  
02/08/2024

**M1.1**