

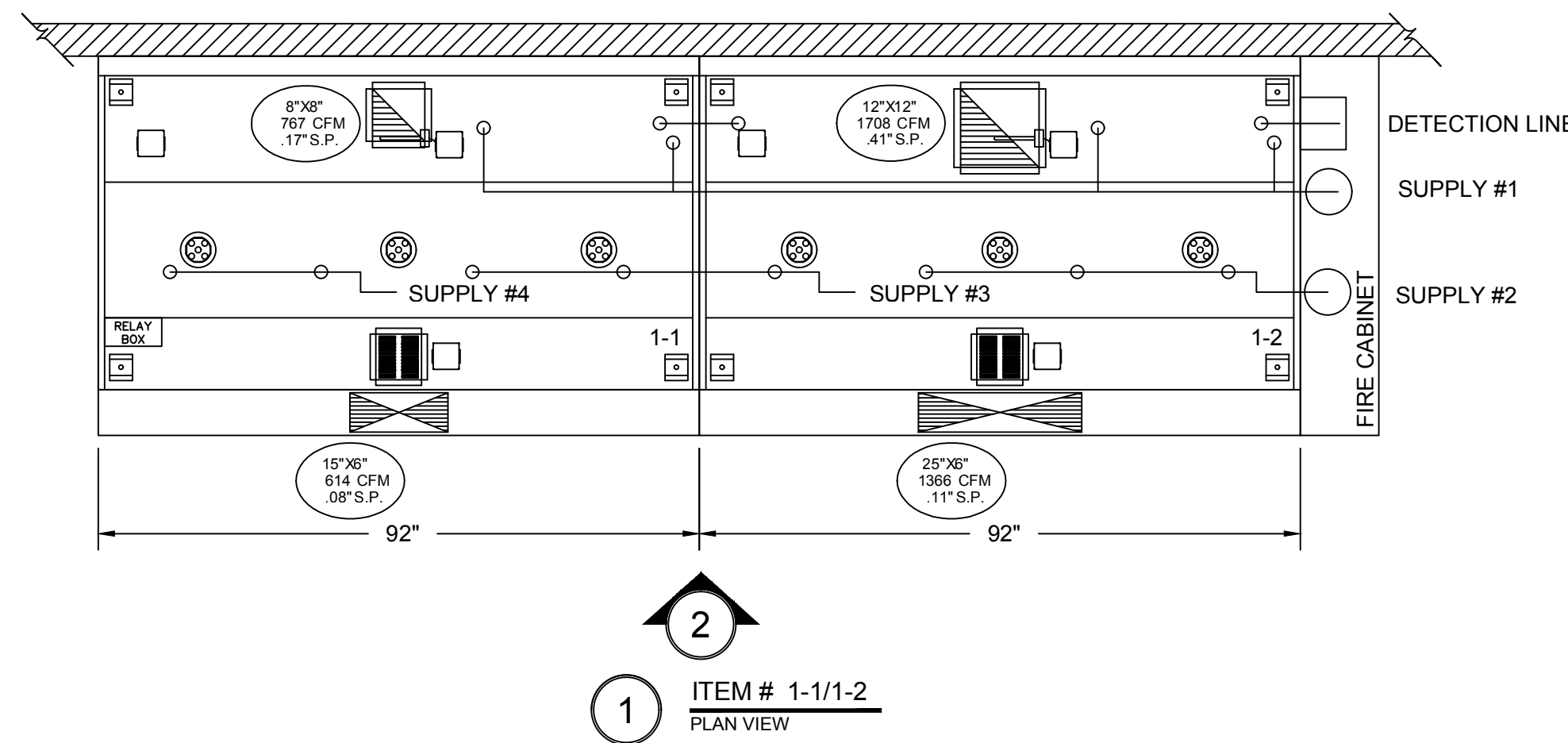

RESERVED FOR DOCUMENT BINDING

## ANSUL R-102 FIRE SUPPRESSION SYSTEM FIRE SYSTEM IS INTEGRAL WITH FACTORY DESIGN/PIPING/FIELD CERTIFICATION



1 ITEM # 1-1/1-2  
PLAN VIEW

**ANSUL R-102 SYSTEM**  
MOUNTED IN FIRE CABINET:  
(1) OEM REGULATED RELEASE  
(3) 3 GALLON TANKS

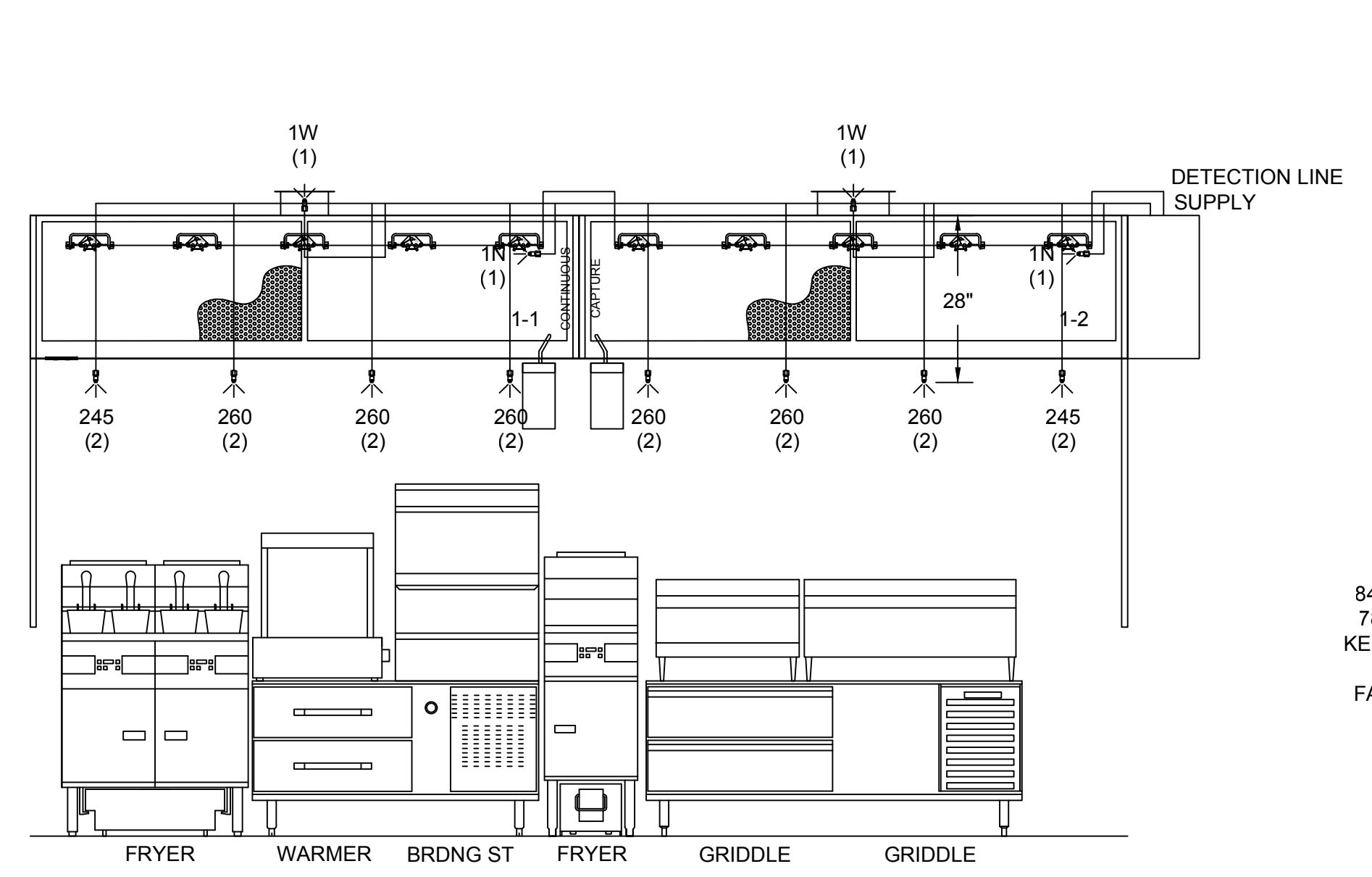

2 ITEM # 1-1/1-2  
ELEVATION VIEW

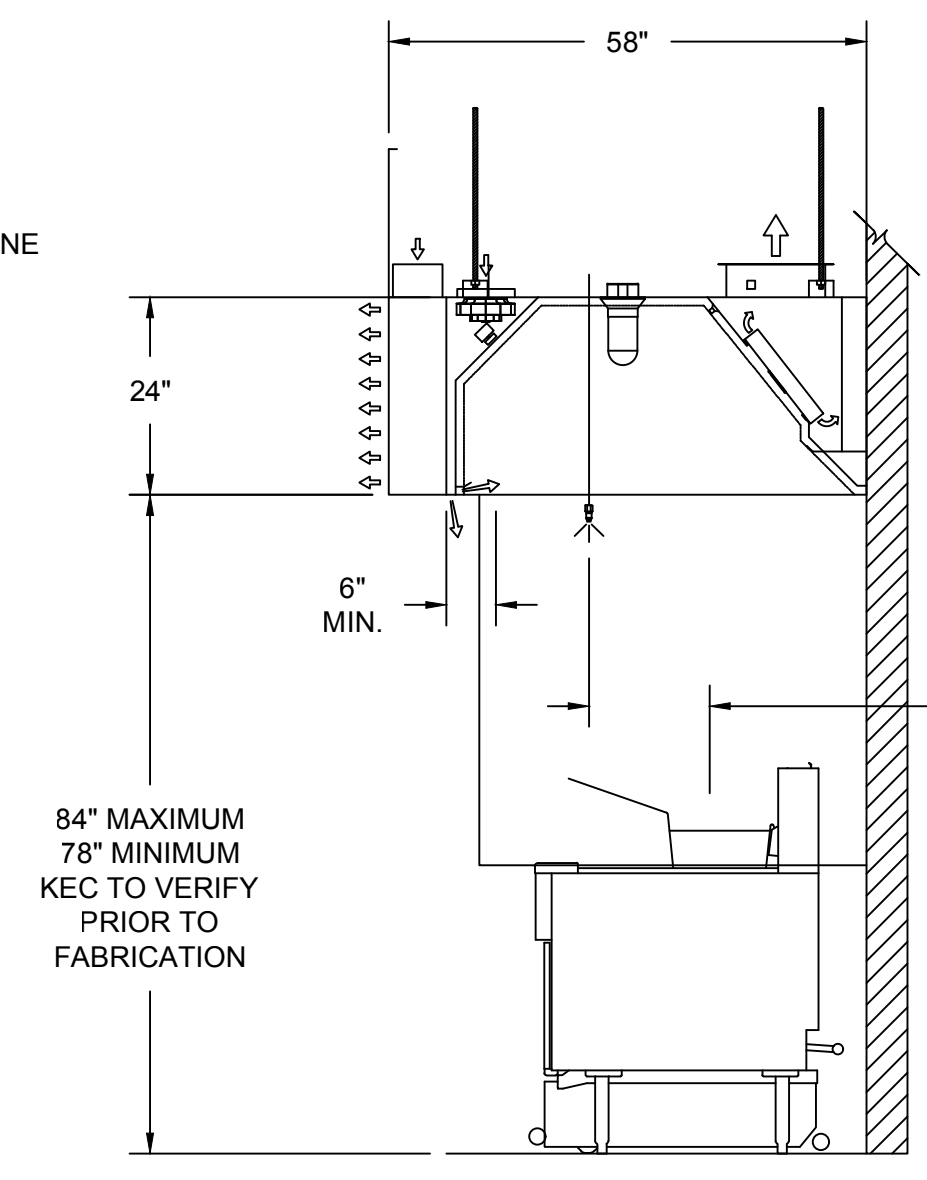

3 ITEM # 1-1/1-2  
SECTION VIEW

- 1) ANSUL R-102 FIRE SYSTEM
- 2) THREE TANK SYSTEM (9 GALLON)
- 3) 3/8" BLACK IRON PIPING (CONCEALED)
- 3/8" S.S. APPLIANCE DROPS (EXPOSED)
- 4) MECHANICAL GAS VALVE - (ADVISE SIZE)

ALL APPLIANCE DROPS TO HAVE SWIVELS

**\*\*NOTE\*\***  
**ANSUL R-102  
OVERLAPPING SYSTEM**

**FLOW POINT CHART**  
ANSUL R-102 FLOW POINT CALCULATION

NOZZLE TYPE	NOZZLE FLOW PT.	NOZZLE QUANTITY	TOTAL FLOW PT.
3N	3	0	#
290	2	0	#
260	2	6	#
245	2	2	#
230	2	0	#
23V	2	0	#
2120	2	0	#
1W	1	2	#
1E	1	2	#
1E	1	0	#
1/2N	1/2	0	#
TOTAL FLOW POINTS USED			#
MAX. SYSTEM FLOW POINTS:			24 (12 GALLON)

**NOTE:**  
HALTON COMPANY WILL SUPPLY ANSUL COMPONENTS AND PRE-PIPED HOODS PER PUBLISHED ANSUL GUIDELINES AND RECOMMENDATIONS. IT IS THE RESPONSIBILITY OF THE F.S.E.C. TO INFORM HALTON OF ANY SPECIAL REQUIREMENTS OF THE LOCAL JURISDICTION PRIOR TO RELEASE OF EQUIPMENT.

- ANSUL NOTES**
- GENERAL NOTES:**
- THIS INSTALLATION IS TO BE MADE IN ACCORDANCE WITH THE R-102 INSTALLATION MANUAL AND IN ACCORDANCE WITH ALL STATE AND LOCAL CODES.
  - THE WIRE ROPE FOR THE DETECTOR AND REMOTE PULL STATION IS TO BE INSTALLED BY AN AUTHORIZED AND FACTORY TRAINED DISTRIBUTOR OR SERVICE REPRESENTATIVE.
  - THIS INSTALLATION IS TO BE INSPECTED, PUT INTO OPERATION AND CERTIFIED BY AN AUTHORIZED AND FACTORY TRAINED DISTRIBUTOR OR SERVICE REPRESENTATIVE.
  - ELECTRICAL CONTACTS AND WIRING FOR APPLIANCE SHUT OFF TO BE PROVIDED BY THE ELECTRICAL CONTRACTOR.
  - ANSUL R-102 RESTAURANT FIRE SUPPRESSION SYSTEMS HAVE BEEN TESTED AND ARE LISTED BY UNDERWRITERS LABORATORIES INC. AS PRE-ENGINEERED SYSTEMS, AND WHEN INSTALLED AS SHOWN ON THIS DRAWING SHALL COMPLY WITH ALL RELEVANT ANSUL INSTALLATION RECHARGE INSPECTION AND MAINTENANCE MANUALS AND SHALL COMPLY WITH NFPA 96 WHEN INSTALLED AND CERTIFIED BY AUTHORIZED TRAINED ANSUL DISTRIBUTORS IN ACCORDANCE WITH THE MANUAL.
  - ALL AGENT DISTRIBUTION PIPING AND DETECTION CONDUIT HOOD PENETRATIONS MUST BE PROPERLY SEALED IN ACCORDANCE WITH NFPA 96.
- DISTRIBUTION PIPING REQUIREMENT NOTES:**
- PIPE SHALL BE 3/8" SCHEDULE 40 BLACK IRON, CHROME PLATED OR STAINLESS STEEL UNLESS OTHERWISE NOTED.
  - FINAL NOZZLE LOCATION MAY NOT VARY FROM LOCATION SHOWN.

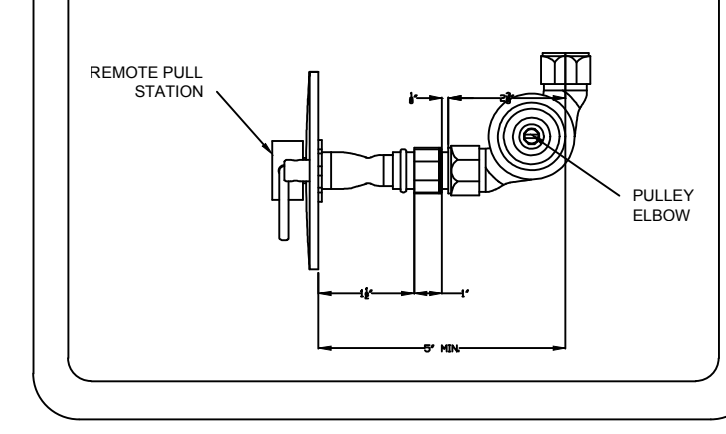
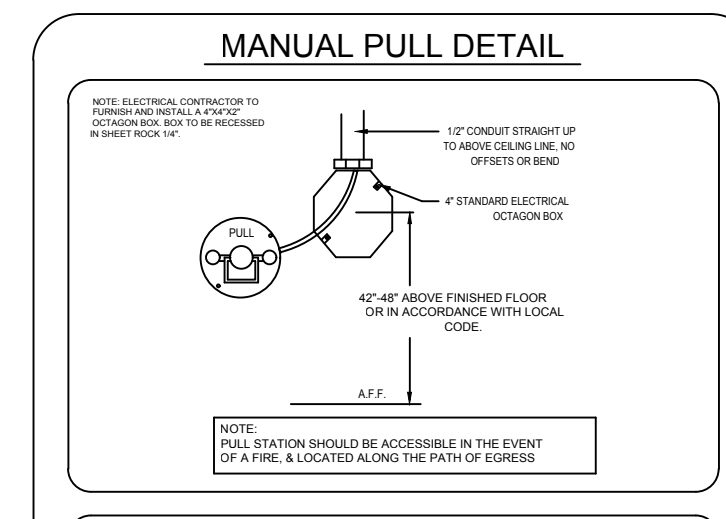
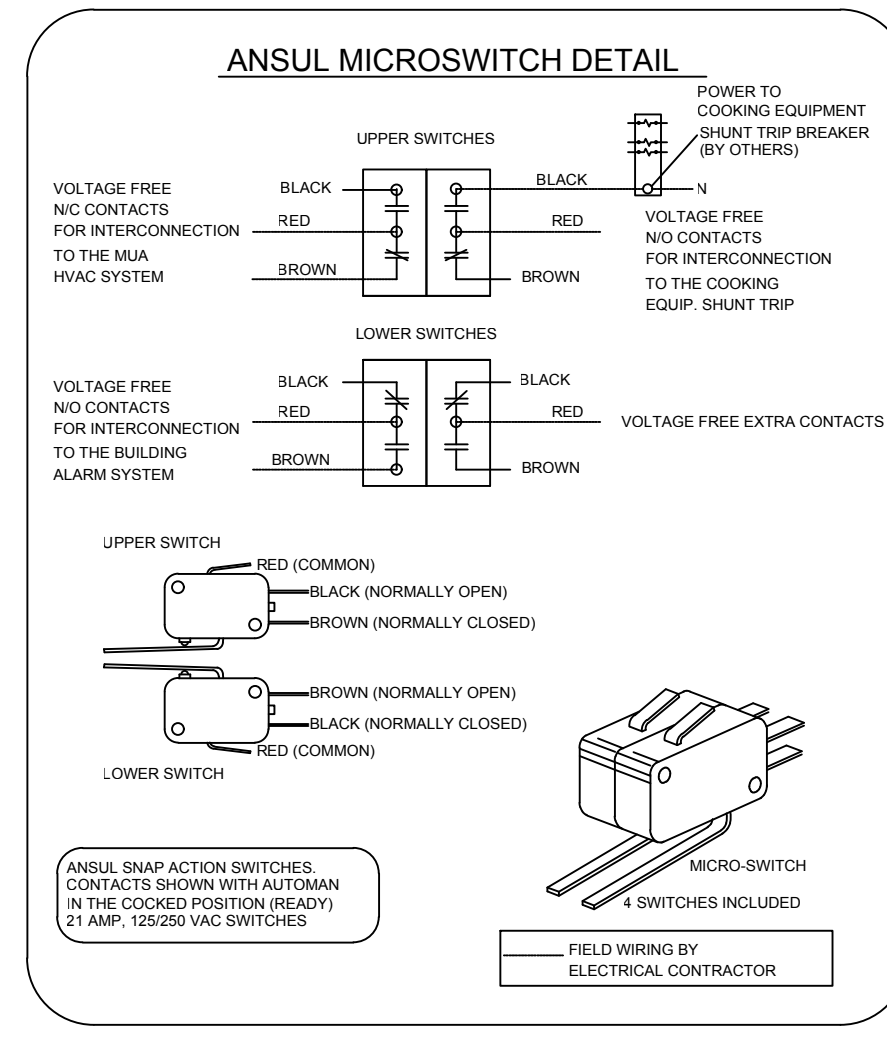

**NOTE:**  
ALL PIPING FOR LOW PROXIMITY APPLIANCE PROTECTION SHALL BE PROVIDED & INSTALLED BY THE INSTALLING ANSUL DISTRIBUTOR & NOT BY HALTON.

**NOTE:**  
HAND HELD EXTINGUISHERS, IF REQUIRED, ARE TO BE PROVIDED BY OTHERS.

THIS DRAWING MUST BE CHECKED, SIGNED AND RETURNED TO THE APPROPRIATE FACTORY. PLEASE VERIFY THE FOLLOWING:

- ALL DIMENSIONAL INFORMATION, MOUNTING POSITIONS
- THE LOCATION AND TYPE OF COOKING EQUIPMENT.

**NOTE TO APPROVER:**  
REVISIONS TO THIS DRAWING SHALL BE MADE BY THE APPROPRIATE FACTORY REPRESENTATIVE. ANY CHANGES TO THE DRAWING SHALL BE MADE BY THE APPROPRIATE FACTORY REPRESENTATIVE. ANY CHANGES TO THE DRAWING SHALL BE MADE BY THE APPROPRIATE FACTORY REPRESENTATIVE. ANY CHANGES TO THE DRAWING SHALL BE MADE BY THE APPROPRIATE FACTORY REPRESENTATIVE.

APPROVED FOR FABRICATION:  WITH CHANGES AS NOTED  
WITH NO CHANGES:

DATE: \_\_\_\_\_

---

WEBSITE: www.halton.com

HALTON CO. (USA)  
1270 237-5600  
SCOTTSDALE, AZ 85260

BY: SKM DATE: 11.09.21

HALTON CO. (CANADA)  
1-800-524-0301  
MISSISSAUGA, ON L4X 1R7

NO CHANGE

MAIL APPROVED DRAWINGS TO APPROPRIATE FACTORY BELOW:

PROJECT: SHAKE SHACK 1414 CHAPEL HILL  
LOCATION: CHAPEL HILL, NC  
DRAWN BY: SKM DATE: 10.22.21  
SCALE: NOT TO SCALE  
CONSULTANT:

DRAWING TITLE: HOOD DETAILS  
DRAWING No.: U21-722  
REV. NO.: 1 SHEET NO.: 2 of 6

**SHAKE SHACK**  
NC - 1414 - CHAPEL HILL  
1800 E FRANKLIN STREET,  
UNIT 40  
CHAPEL HILL, NC 27514

**Gensler**  
LIC. NO. AA0002837 TEL 415.433.3700  
45 FREMONT ST. FAX 415.836.4599  
SUITE 1500  
SAN FRANCISCO, CA 94105  
UNITED STATES

SATELLITE OFFICE: TEL 813.204.9000  
400 N ASHLEY DRIVE  
SUITE 0400 FAX 813.223.6948  
TAMPA, FL 33602  
UNITED STATES

**Schnackel**

MEPF ENGINEER  
3035 S 72ND ST  
OMAHA NE 68124  
TEL 402.391.7680

**TriMark**  
Foodservice Equipment, Supplies and Design

FOODSERVICE CONSULTANT  
505 COLLINS ST  
PO BOX 3505  
SOUTH ATTLEBORO  
MA 02703  
TEL 508.399.6000  
FAX 508.761.3620

NORTH CAROLINA  
SEAL  
024849  
DATE: 07/22/22  
CMA # C-3262

Issue / Signature

**ISSUE FOR CONSTRUCTION**

Project Name  
CHAPEL HILL

Project Number  
69.6562.000

Description  
HALTON DRAWINGS

Scale  
1/4" = 1'-0"

**M702**

© 2021 Gensler

