

HOOD NO.	MARK	MODEL	HOOD DIMENSIONS (IN.)			HOOD CONSTR.	COOKING LOAD / DUTY RATING	TOTAL CFM	EXHAUST COLLAR(S)					SUPPLY		TOTAL WEIGHT LBS.	SECTION LOCATION
			LENGTH	WIDTH	HEIGHT				WIDTH	LENGTH	DIA.	CFM	S.P.	MUA CFM	AC CFM		
1	GRIDDLE HOOD	XGEP-64-S	64				1500	12	12		1500	1.918			136.8	SINGLE	

HOOD NO.	MARK	LIGHTING DETAILS				GREASE FILTRATION DETAILS				UTILITY CABINET(S)				
		FIXTURE TYPE BULB / LAMP INFO		QTY	FOOT CANDLES	TYPE / MODEL MATERIAL	QTY	SIZE (IN.)		LOCATION	FIRE SYSTEM		CONTROLS	
								L	H		TYPE	SIZE	MODEL	INTERFACE
1	GRIDDLE HOOD					GREASE GRABBER STAINLESS STEEL	4	16	16					

HOOD OPTIONS	SPECIAL DESIGN REQUESTS
UL 710 LISTED W/ OUT EXHAUST FIRE DAMPER - UL #R25625 BACK NON-INTEGRAL AIR SPACE - 3 IN WIDE LEFT NON-INTEGRAL AIR SPACE - 1 IN THICK - ZERO CLEARANCE 30 IN HIGH CEILING ENCLOSURES - FRONT LEFT RIGHT - FIELD INSTALLED FACTORY MOUNTED EXHAUST COLLAR(S) PERFORMANCE ENHANCING LIP (PEL) TECHNOLOGY STANDING SEAM CONSTRUCTION FOR SUPERIOR STRENGTH	SDR #K1100145 - FLUE BYPASS HOOD SDR #K1800144 - CULVERS 4VAT 2FIRE PROCESS - GRIDDLE HOOD

Belt Drive Upblast Centrifugal Roof Exhaust Fan

MARK INFORMATION		FAN INFORMATION					MOTOR INFORMATION						
QTY	MARK	MODEL	VOLUME (CFM)	TOTAL EXTERNAL SP (IN WG)	FAN RPM	OPERATING POWER (HP)	WEIGHT (LB.)	SIZE (HP)	V/C/P	ENCLOSURE	MOTOR RPM	WINDINGS	NEC FLA*
1	PRV-2 Griddle Fan	XCUBE-160XP-15	1,500	2.3	2,396	1.29	108	1.5	208/60/3	OP	1725	1	6.6

*NEC FLA - Based on table 430.250 or 430.248 of National Electrical Code 2020. Actual motor FLA may vary for sizing thermal overload, consult factory"

PRV-2 Griddle Fan : SELECTED OPTIONS AND ACCESSORIES

- One piece fully welded windband
- Tapered bushing wheel hub
- Breather tube outlet area min. 4.4 sq. in. (sizes 99-480)
- Min. windband material thickness: 0.051" aluminum (060-240), 0.064" aluminum (240HP, 240XP), 0.080" aluminum (sizes 300-480)
- Larger Curb Cap Size - 26 Square
- UL/cUL 762 Listed - "Power Ventilators for Rest. Exh. Appliances"
- Switch, NEMA-3R, Toggle, Shipped with Unit
- Hinge, Factory Installed
- High Temp Curb Seal Rated for Continuous Duty at 1500 F (Factory Attached)
- Grease Trap (PN 475538)
- Heat Baffle (Attached)
- Bearings with Grease Fittings, L10 life of 100,000 hrs (L50 avg. life 500,000 hrs)

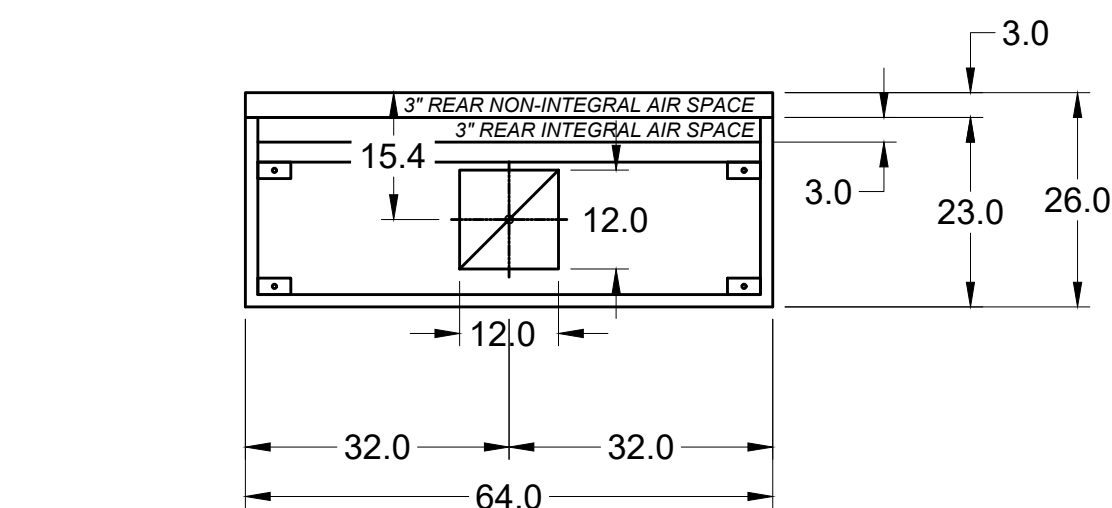

MARK: Griddle Hood - SECTION 1 PLAN VIEW

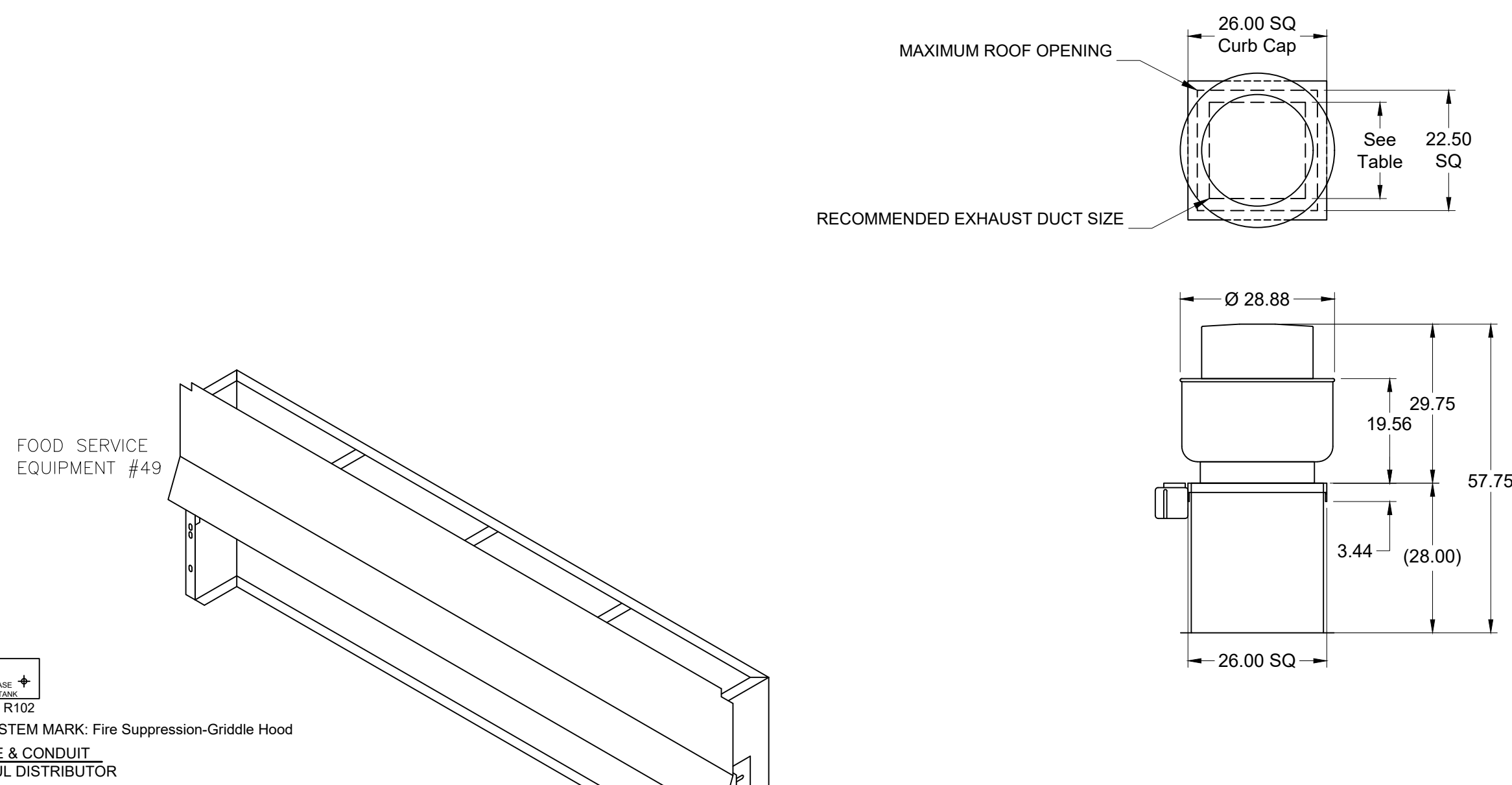

FOOD SERVICE EQUIPMENT #49
 FIRE SYSTEM MARK: Fire Suppression-Griddle Hood
 PIPE & CONDUIT BY ANSUL DISTRIBUTOR

MUST USE WITH MAGIKITCH'N MODEL MKG-C-60
 VERIFY MAGIKITCHEN OR ANETS GRILL
 60" MAGIKITCH'N GRIDDLE FLUE ADAPTER

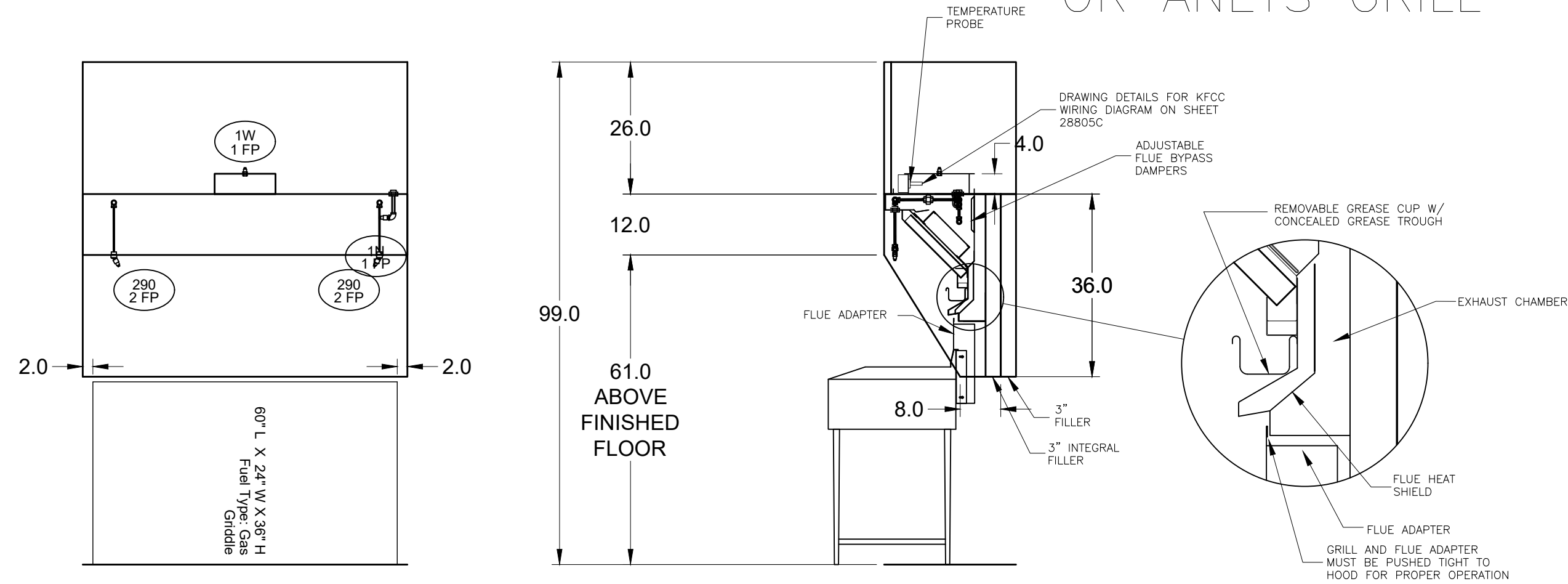

SECTION 1 ELEVATION VIEW

MARK: Griddle Hood SECTION VIEW

MARK	MODEL	LOCATION	FLOW POINTS		SUPPLY LINE	DETECTION	MARK(S) PROTECTED BY FIRE SYSTEM
			HOODS	PCU			
FIRE SUPPRESSION-GRIDDLE HOOD	ANSUL R-102 WET CHEMICAL	REMOTE MOUNTED	6 UTILIZED 11 AVAILABLE		CONTINUOUS	FUSIBLE LINK	GRIDDLE HOOD SECTION 1

FIRE SYSTEM OPTIONS AND ACCESSORIES
 FULL INSTALLATION (INCLUDES PRE-PIPED HOOD(S) WITH DETECTION AND FACTORY COORDINATED INSTALL)
 CHROME SLEEVES FOR FACTORY PROVIDED APPLIANCES DROPS - INCLUDED
 METAL BLOW-OFF CAPS - INCLUDED
 HOOD SUPPRESSION AGENT - INCLUDED - 3 GAL. - [(1) 3.0 TANK(S)]
 REMOTE PULL STATION - STANDARD - INSTALLATION AT SINGLE POINT OF EGRESS

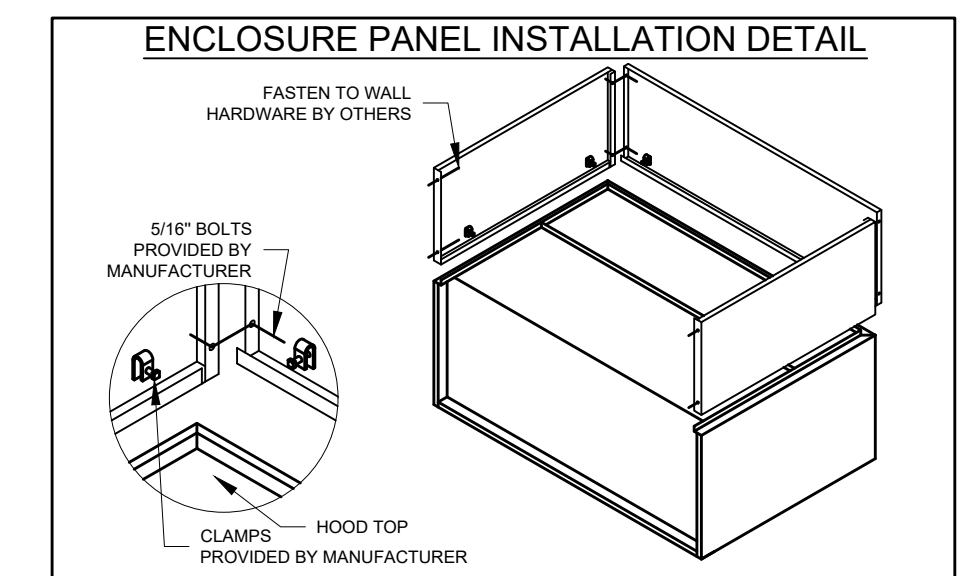
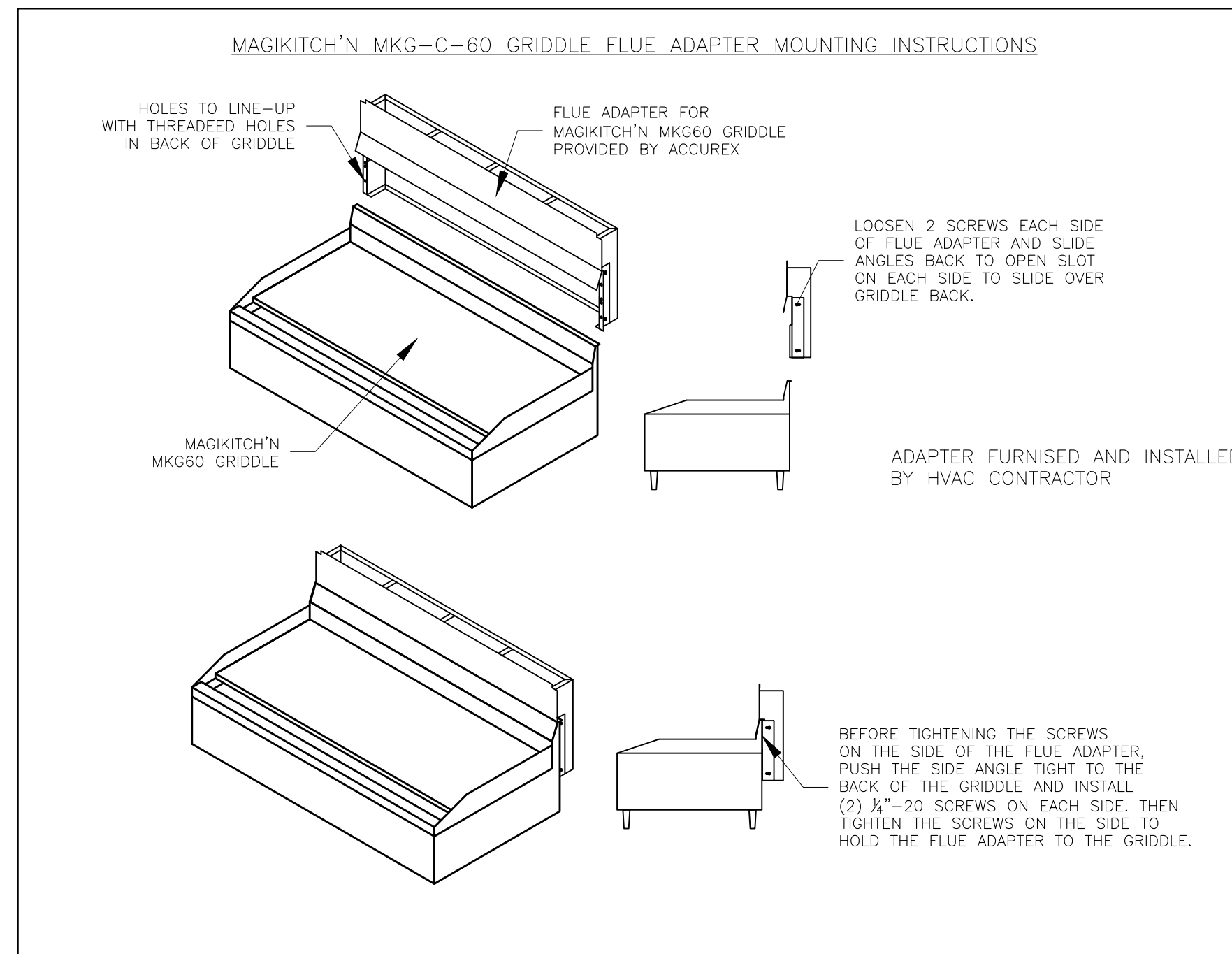
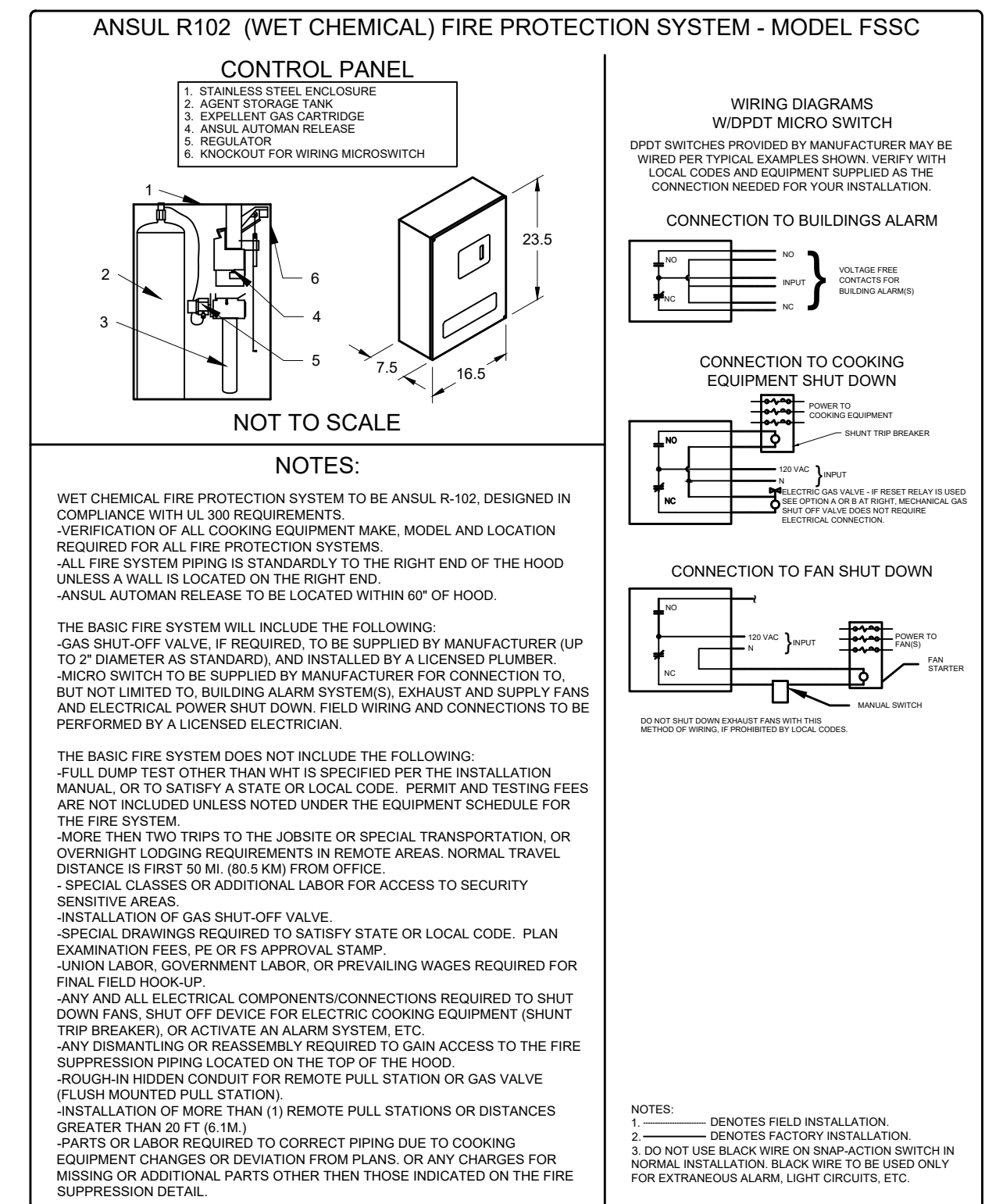

HOOD HANGING HEIGHT FOR FIRE SYSTEMS
 VERIFICATION OF HOOD HANGING HEIGHT ABOVE FINISHED FLOOR (A.F.F.) IS REQUIRED FOR CORRECT PLACEMENT OF FIRE SYSTEM NOZZLES.

- RECOMMENDED HANGING HEIGHT = 61" FROM FINISHED FLOOR TO LOWER FRONT EDGE OF HOOD.
- OTHER HANGING HEIGHT = " FROM FINISHED FLOOR TO LOWER EDGE OF HOOD.

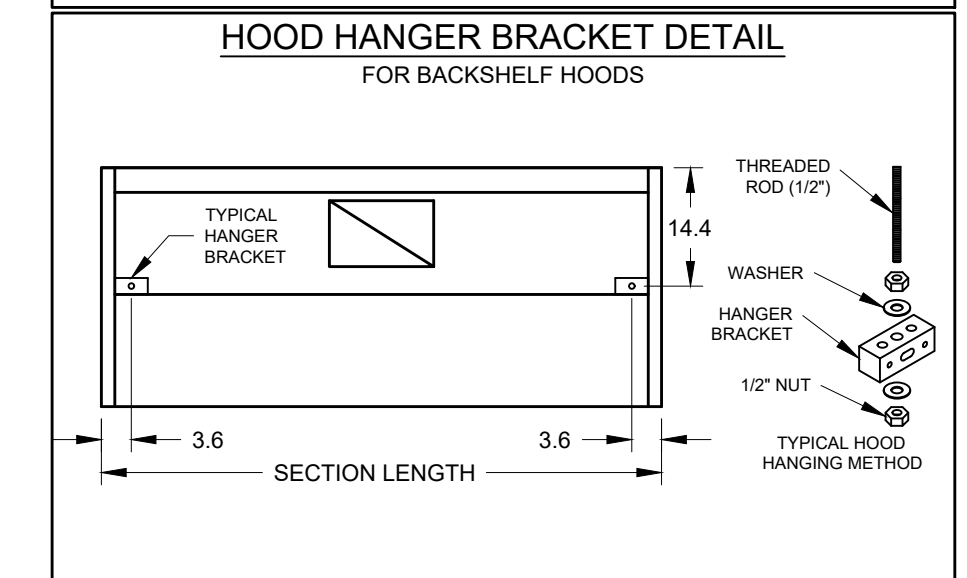

PROJECT 12/4/2019
 PHILLIP KRAFT
 ACCUREX - WI, IA
 PHILLIP KRAFT
 PHILLIP.KRAFT@ACCUREX.COM
 262-227-7865
 UL LISTED
 CULVERS - SIOUX CENTER, IA (REMODEL)
 GRIDDLE HOOD
 PRV-2 GRIDDLE FAN
 FIRE SUPPRESSION-GRIDDLE HOOD
 ACCUREX

HOOD NO.	MARK	MODEL	HOOD DIMENSIONS (IN.)			HOOD CONSTR.	COOKING LOAD / DUTY RATING	EXHAUST					SUPPLY		TOTAL WEIGHT LBS.	SECTION LOCATION
			LENGTH	WIDTH	HEIGHT			COLLAR(S)					MUA CFM	AC CFM		
								WIDTH	LENGTH	DIA.	CFM	S.P.				
1	FRYER HOOD	XXEP-83-S	83	TOP 23 BOT 3	FRT 12 BACK 36	430 SS WHERE EXPOSED	MEDIUM	1500	12	12		1500	0.518		169.1	SINGLE

HOOD NO.	MARK	LIGHTING DETAILS			GREASE FILTRATION DETAILS			UTILITY CABINET(S)								
		FIXTURE TYPE BULB / LAMP INFO	QTY	FOOT CANDLES	TYPE / MODEL MATERIAL	QTY	SIZE (IN.) L H	LOCATION	FIRE SYSTEM		CONTROLS					
1	FRYER HOOD				X-TRACTOR STAINLESS STEEL	5	16	16								
						0	20									

HOOD OPTIONS		SPECIAL DESIGN REQUESTS	
UL 710 LISTED W/ OUT EXHAUST FIRE DAMPER - UL #R25625	BACK NON-INTEGRAL AIR SPACE - 3 IN WIDE	SDR #K1100559 - NEW PITCO 4L FRYER FLUE BYPASS SYSTEM	
RIGHT NON-INTEGRAL AIR SPACE - 1 IN THICK - ZERO CLEARANCE	30 IN HIGH CEILING ENCLOSURES - FRONT LEFT RIGHT - FIELD INSTALLED	SDR #K1700974 - CULVERS 4VAT 2FIRE PROCESS - FRYER HOOD	
FACTORY MOUNTED EXHAUST COLLAR(S)	PERFORMANCE ENHANCING LIP (PEL) TECHNOLOGY		
STANDING SEAM CONSTRUCTION FOR SUPERIOR STRENGTH			

Belt Drive Upblast Centrifugal Roof Exhaust Fan

MARK INFORMATION		FAN INFORMATION					MOTOR INFORMATION						
QTY	MARK	MODEL	VOLUME (CFM)	TOTAL EXTERNAL SP (IN WG)	FAN RPM	OPERATING POWER (HP)	WEIGHT (LB.)	SIZE (HP)	V/C/P	ENCLOSURE	MOTOR RPM	WINDINGS	NEC FLA*
1	PRV-3 Fryer Fan	XCUBE-140-7	1,500	1	1,368	0.5	97	0.75	208/60/3	OP	1725	1	3.5

*NEC FLA - Based on table 430.250 or 430.248 of National Electrical Code 2020. Actual motor FLA may vary for sizing thermal overload, consult factory"

PRV-3 Fryer Fan : SELECTED OPTIONS AND ACCESSORIES	
One piece fully welded windband	
Tapered bushing wheel hub	
Breather tube outlet area min. 4.4 sq. in. (sizes 99-480)	
Min. windband material thickness: 0.051" aluminum (060-240), 0.064" aluminum (240HP, 240XP), 0.080" aluminum (sizes 300-480)	
Larger Curb Cap Size - 26 Square	
UL/cUL 762 Listed - "Power Ventilators for Rest. Exh. Appliances"	
Switch, NEMA-3R, Toggle, Shipped with Unit	
Hinge, Factory Installed	
High Temp Curb Seal Rated for Continuous Duty at 1500 F (Factory Attached)	
Grease Trap (PN 475538)	
Heat Baffle (Attached)	

FOOD SERVICE EQUIPMENT #59

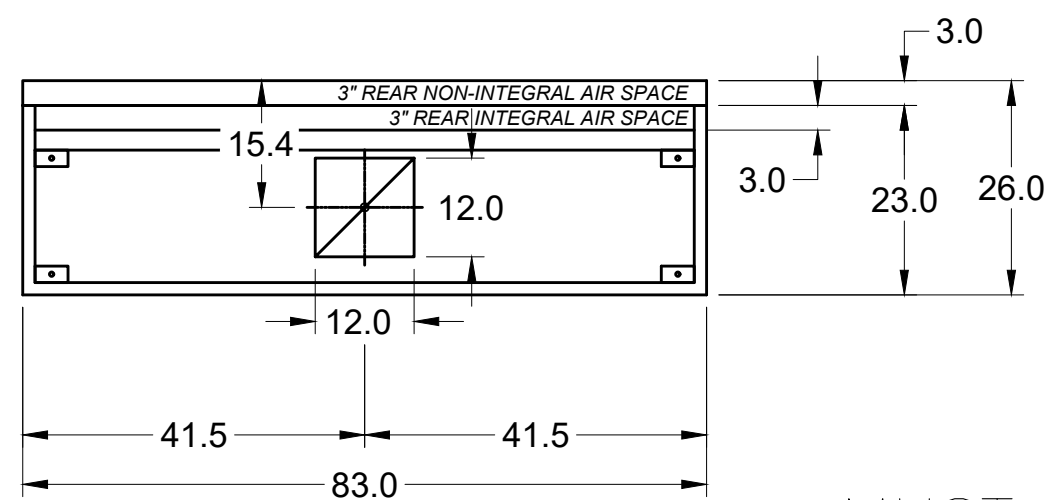

MARK: Fryer Hood PLAN VIEW

FIRE SYSTEM MARK: Fire Suppression-Fryer Hood
PIPE & CONDUIT BY ANSUL DISTRIBUTOR
** INSTALL ALL TANKS ** IN AN ENCLOSURE

MUST USE WITH PITCO MODEL CU-SSH60W

PITCO FRYER 4-VAT FLUE ADAPTER

VERIFY 4-VAT OR 5-VAT FRYER BATTERY

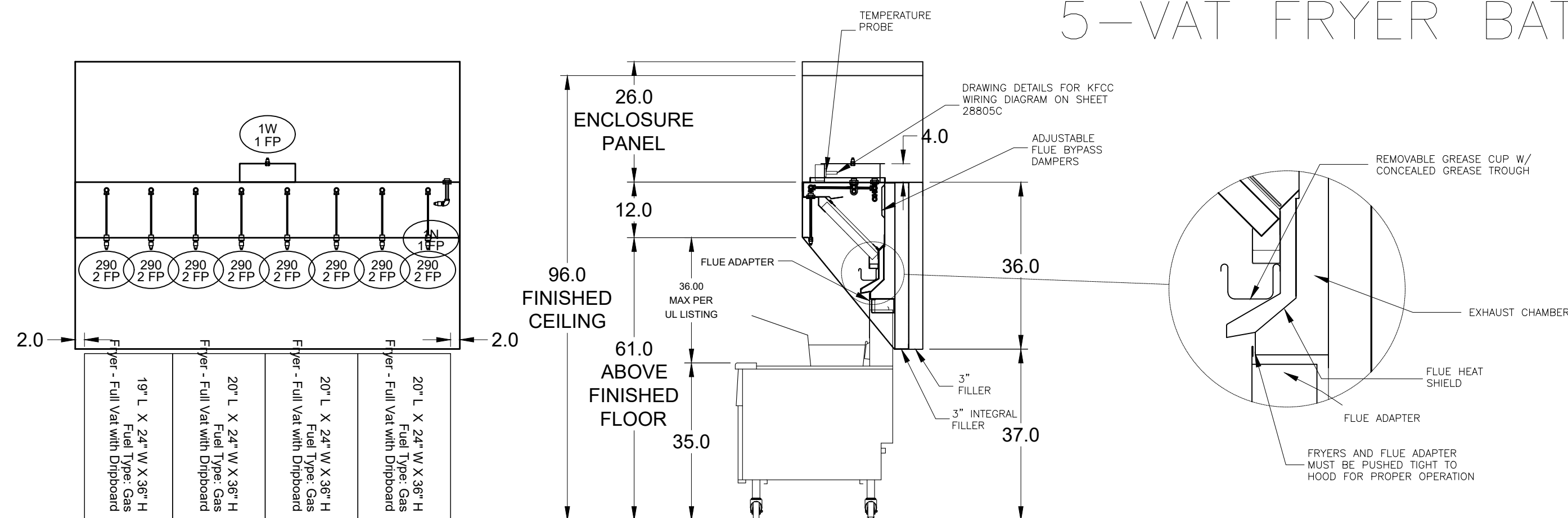

SECTION 1 ELEVATION VIEW

MARK: ITEM #59 SECTION VIEW

MARK	MODEL	LOCATION	FLOW POINTS		SUPPLY LINE	DETECTION	MARK(S) PROTECTED BY FIRE SYSTEM
			HOODS	PCU			
FIRE SUPPRESSION-FRYER HOOD	ANSUL R-102 WET CHEMICAL	REMOTE MOUNTED	18 UTILIZED	22 AVAILABLE	CONTINUOUS	FUSIBLE LINK	FRYER HOOD SECTION 1

FIRE SYSTEM OPTIONS AND ACCESSORIES

FULL INSTALLATION (INCLUDES PRE-PIPED HOOD(S) WITH DETECTION AND FACTORY COORDINATED INSTALL)
CHROME SLEEVES FOR FACTORY PROVIDED APPLIANCES DROPS - INCLUDED
METAL BLOW-OFF CAPS - INCLUDED
PRE-TEST - INCLUDED

HOOD SUPPRESSION AGENT - INCLUDED - 6 GAL. - [(2) 3.0 TANK(S)]
REMOTE PULL STATION - STANDARD - INSTALLATION AT SINGLE POINT OF EGRESS

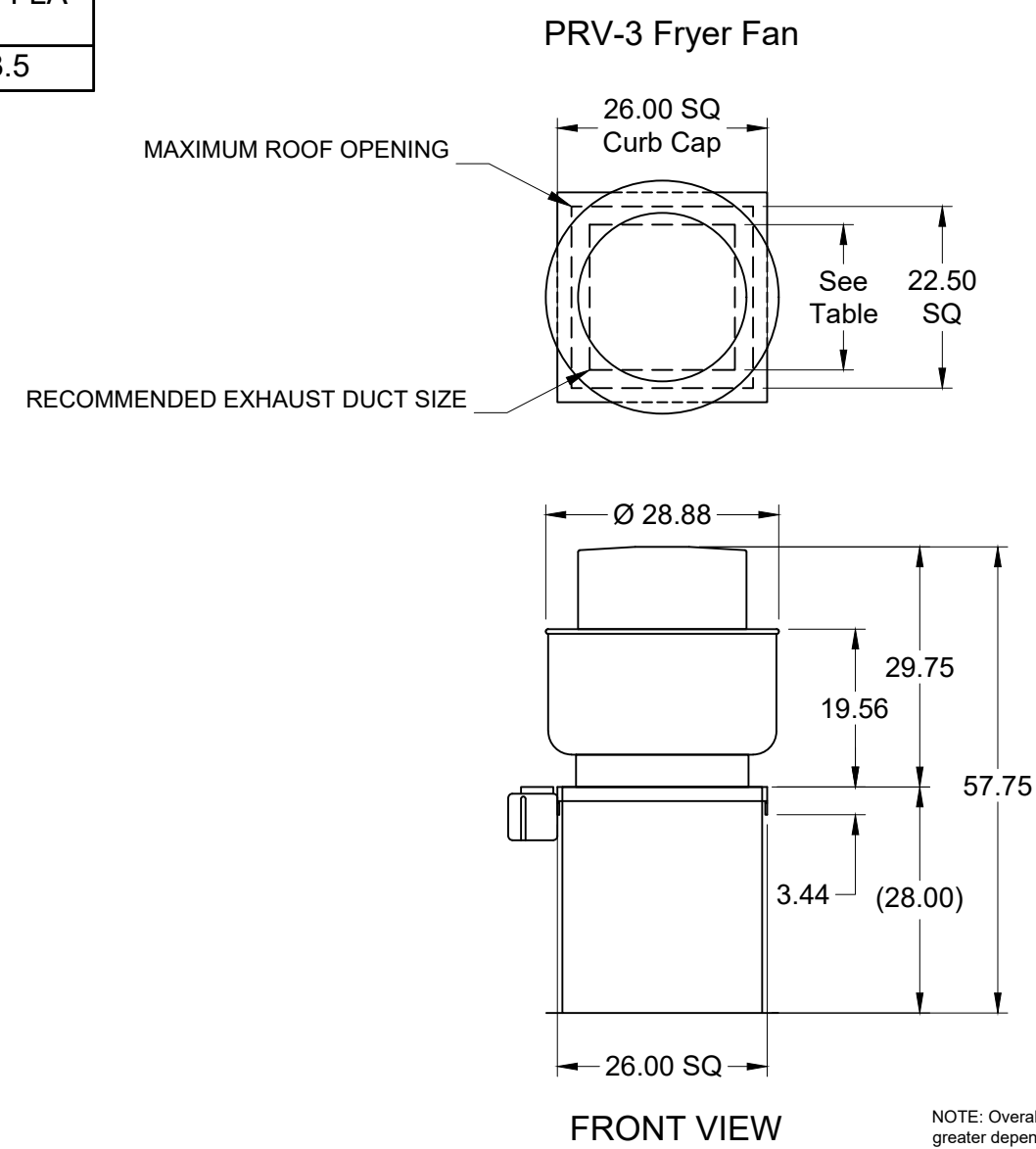

FRONT VIEW

NOTE: Overall height may be greater depending on motor

ANSUL R102 (WET CHEMICAL) FIRE PROTECTION SYSTEM - MODEL FSSC

CONTROL PANEL

1. STAINLESS STEEL ENCLOSURE
2. AGENT STORAGE TANK
3. EXTINGUISHING GAS CARTRIDGE
4. ANSUL AUTOMAN RELEASE REGULATOR
5. KNOCKOUT FOR WIRING MICROSWITCH

WIRING DIAGRAMS
WIDPOT MICRO SWITCH
DRPT SWITCHES PROVIDED BY MANUFACTURER MAY BE WIRED PER TYPICAL EXAMPLES SHOWN. VERIFY WITH LOCAL CODES AND EQUIPMENT SUPPLIED AS THE CONNECTION NEEDED FOR YOUR INSTALLATION.

CONNECTION TO BUILDINGS ALARM
VOLTAGE FREE CONTACTS FOR BUILDING ALARMS

CONNECTION TO COOKING EQUIPMENT SHUT DOWN
POWER TO COOKING EQUIPMENT
SHUT OFF VALVE

CONNECTION TO FAN SHUT DOWN
POWER TO FAN
SHUT OFF VALVE

NOTES:

WET CHEMICAL FIRE PROTECTION SYSTEM TO BE ANSUL R-102, DESIGNED IN COMPLIANCE WITH UL 300 REQUIREMENTS
-VERIFICATION OF ALL COOKING EQUIPMENT MAKE, MODEL AND LOCATION REQUIRED FOR ALL FIRE PROTECTION SYSTEMS
-ALL FIRE SYSTEM PIPING IS STANDARD TO THE RIGHT END OF THE HOOD UNLESS A WALL IS LOCATED ON THE RIGHT END.
-ANSUL AUTOMAN RELEASE TO BE LOCATED WITHIN 60" OF HOOD.

THE BASIC FIRE SYSTEM WILL INCLUDE THE FOLLOWING:
-GAS SHUT-OFF VALVE, IF REQUIRED, TO BE SUPPLIED BY MANUFACTURER (UP TO 2" DIAMETER AS STANDARD), AND INSTALLED BY A LICENSED PLUMBER.
-MICRO SWITCH TO BE SUPPLIED BY MANUFACTURER FOR CONNECTION TO, BUT NOT LIMITED TO, BUILDING ALARM SYSTEMS, EXHAUST AND SUPPLY FANS AND ELECTRICAL POWER SHUT DOWN. FIELD WIRING AND CONNECTIONS TO BE PERFORMED BY A LICENSED ELECTRICIAN.

THE BASIC FIRE SYSTEM DOES NOT INCLUDE THE FOLLOWING:
-FULL DUMP TEST OTHER THAN WHAT IS SPECIFIED FOR THE INSTALLATION MANUAL, OR TO SATISFY A STATE OR LOCAL CODE. PERMIT AND TESTING FEES ARE NOT INCLUDED UNLESS NOTED UNDER THE EQUIPMENT SCHEDULE FOR THE FIRE SYSTEM.
-MORE THAN TWO TRIPS TO THE JOBSITE OR SPECIAL TRANSPORTATION, OR OVERNIGHT LOGGING REQUIREMENTS IN REMOTE AREAS. NORMAL TRAVEL DISTANCE IS FIRST 50 MI. (80.5 KM) FROM OFFICE.
-SPECIAL CLASSES OR ADDITIONAL LABOR FOR ACCESS TO SECURITY SENSITIVE AREAS.
-INSTALLATION OF GAS SHUT-OFF VALVE.
-SPECIAL DRAWINGS REQUIRED TO SATISFY STATE OR LOCAL CODE. PLAN EXAMINATION FEES, PE OR FS APPROVAL STAMP.
-UNION LABOR, GOVERNMENT LABOR, OR PREVAILING WAGES REQUIRED FOR FINAL FIELD HOOD-UP.
-ANY AND ALL ELECTRICAL COMPONENTS/CONNECTIONS REQUIRED TO SHUT DOWN FANS, SHUT OFF DEVICE FOR ELECTRIC COOKING EQUIPMENT (SHUNT TRIP BREAKER), OR ACTIVATE AN ALARM SYSTEM, ETC.
-ANY DISMANTLING OR REASSEMBLY REQUIRED TO GAIN ACCESS TO THE FIRE SUPPRESSION PIPING LOCATED ON THE TOP OF THE HOOD.
-ROUGH-IN HIDDEN CONDUIT FOR REMOTE PULL STATION OR GAS VALVE (FLUSH MOUNTED PULL STATION).
-INSTALLATION OF MORE THAN (1) REMOTE PULL STATIONS OR DISTANCES GREATER THAN 20 FT (6.1M).
-PARTS OR LABOR REQUIRED TO CORRECT PIPING DUE TO COOKING EQUIPMENT CHANGES OR DEVIATION FROM PLANS, OR ANY CHARGES FOR MISSING OR ADDITIONAL PARTS OTHER THAN THOSE INDICATED ON THE FIRE SUPPRESSION DETAIL.

NOTES:
1. _____ DENOTES FIELD INSTALLATION.
2. _____ DENOTES FACTORY INSTALLATION.
3. DO NOT USE BLACK WIRE ON SNAP-ACTION SWITCH IN NORMAL INSTALLATION. BLACK WIRE TO BE USED ONLY FOR EXTRANEOUS ALARM, LIGHT CIRCUITS, ETC.

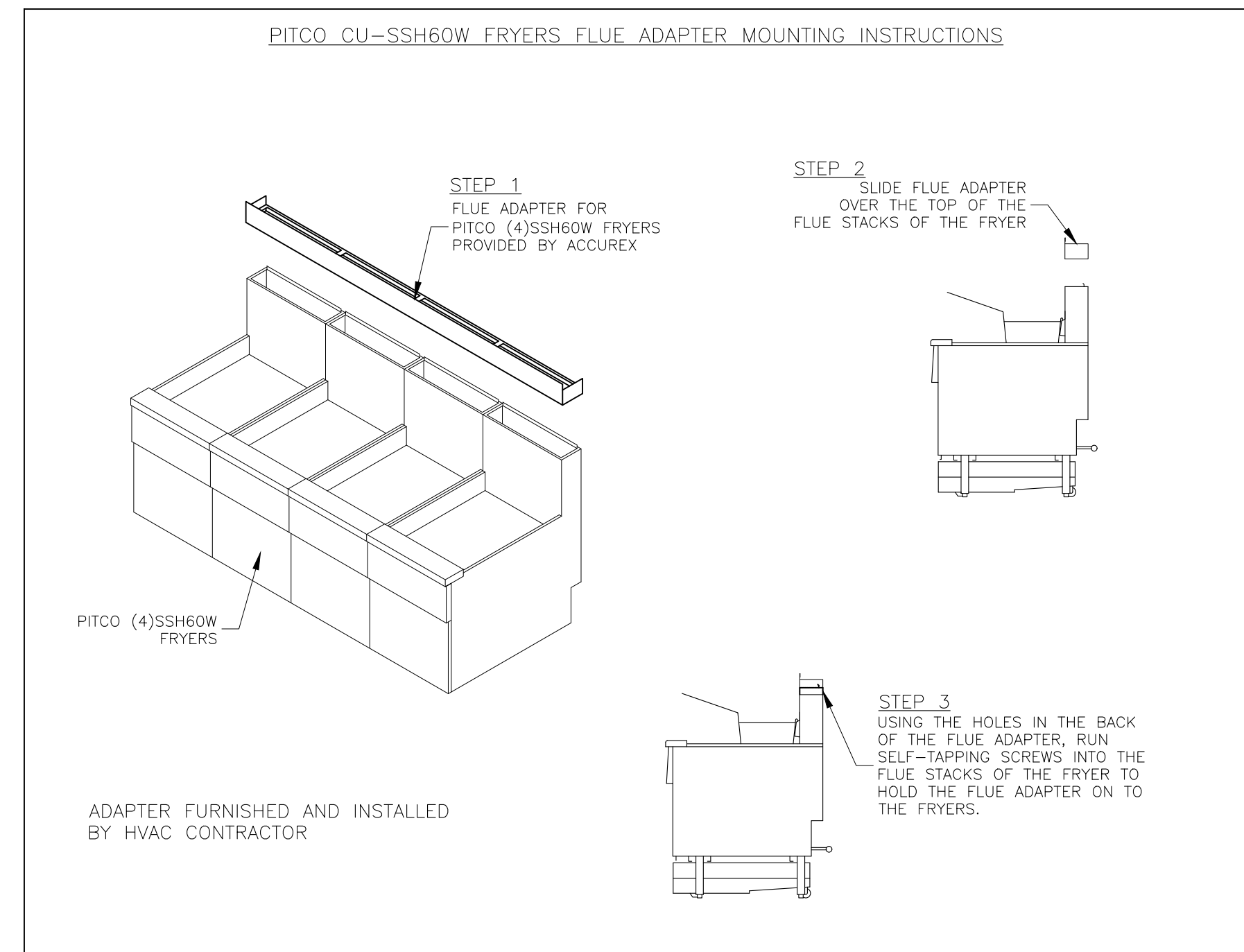

ADAPTER FURNISHED AND INSTALLED BY HVAC CONTRACTOR

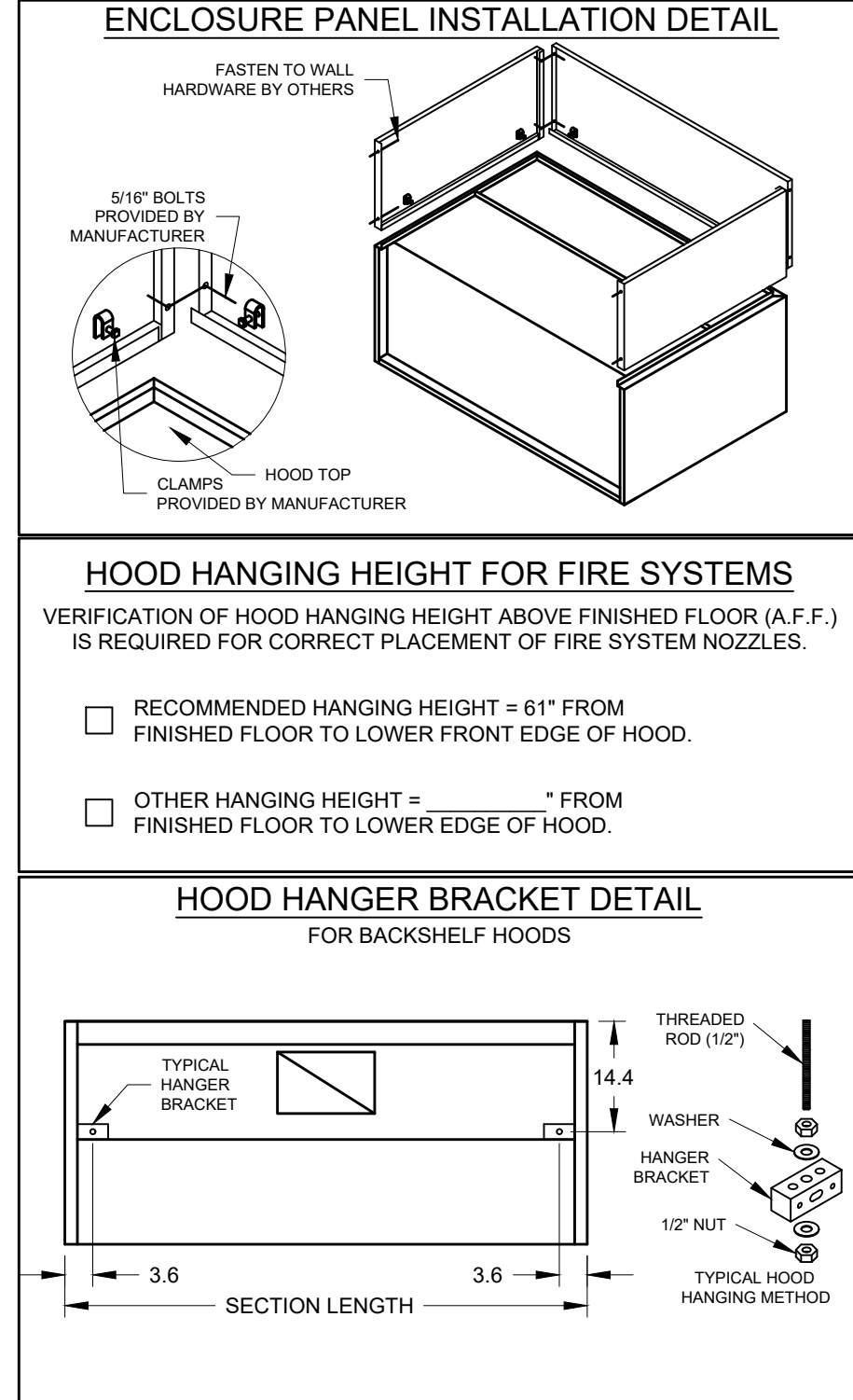

TYPICAL HOOD HANGING METHOD

ACCUREX

PROJECT 12/4/2019
MARK
ACCUREX - W.I.A
PHILLIP KRAFT
PHILLIP.KRAFT@ACCUREX.COM
262-227-7865

CULVERS - MASTER
FRYER HOOD
PRV-3 FRYER FAN
FIRE SUPPRESSION-FRYER HOOD

CONTROL INFORMATION

MARK	ELECTRICAL CONTROL PACKAGE		USER INTERFACE		FANS CONTROLLED											
	MODEL	LOCATION	TYPE	LOCATION	FAN #	TYPE	FAN	FAN MARK	ZONE	CFM	MOTOR HP	MOTOR VOLT	CYCLE	MOTOR PHASE	MOTOR STARTER IN PANEL	VFD IN PANEL
CONTROLS	XKC-CV-S-22-2-1-0	SHIP LOOSE ENCLOSURE	FULL COLOR TOUCHSCREEN	SHIP LOOSE	1	SUPPLY	S1	RTU-1	1	1500	1	208	60	3	NO	NO
					2	SUPPLY	S2	RTU-2	2	1500	1	208	60	3	NO	NO
					3	EXHAUST	E1	PRV-3 FRYER FAN	1	1500	0.75	208	60	3	YES	NO
					4	EXHAUST	E2	PRV-2 GRIDDLE FAN	2	1500	1.5	208	60	3	YES	NO

CONTROL FEATURES

TEMP SENSORS (FACTORY INSTALLED) - QTY. 2
 DRY FIRE CONTACTS - QTY. 2
 EXHAUST MAX DURING FIRE
 SUPPLY OFF DURING FIRE

SPECIAL DESIGN REQUESTS

SDR #K2000462 - CULVERS CONTROL PANEL - EXTRA SET OF FIRE CONTACTS - REVISE WIRING DIAGRAMS

HOOD HANGER BRACKET DETAIL

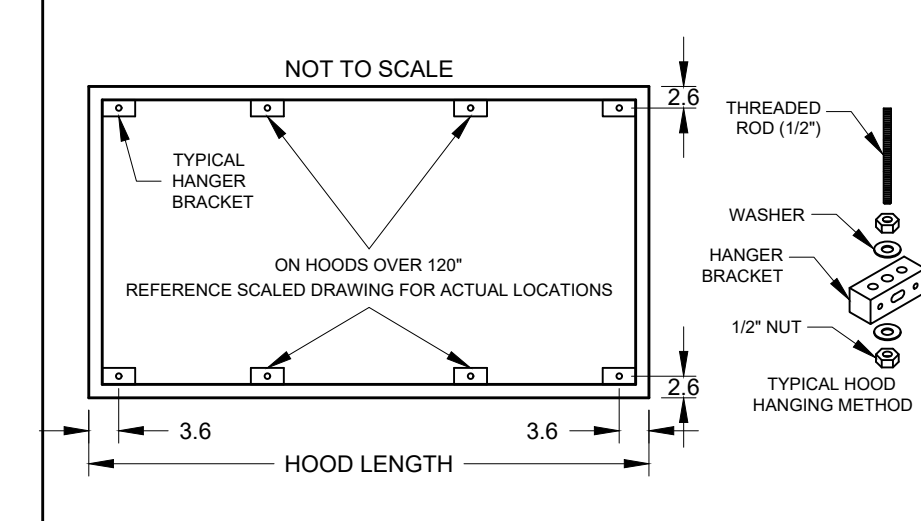

CONDENSATE HOOD BAFFLE INSTALLATION DETAIL

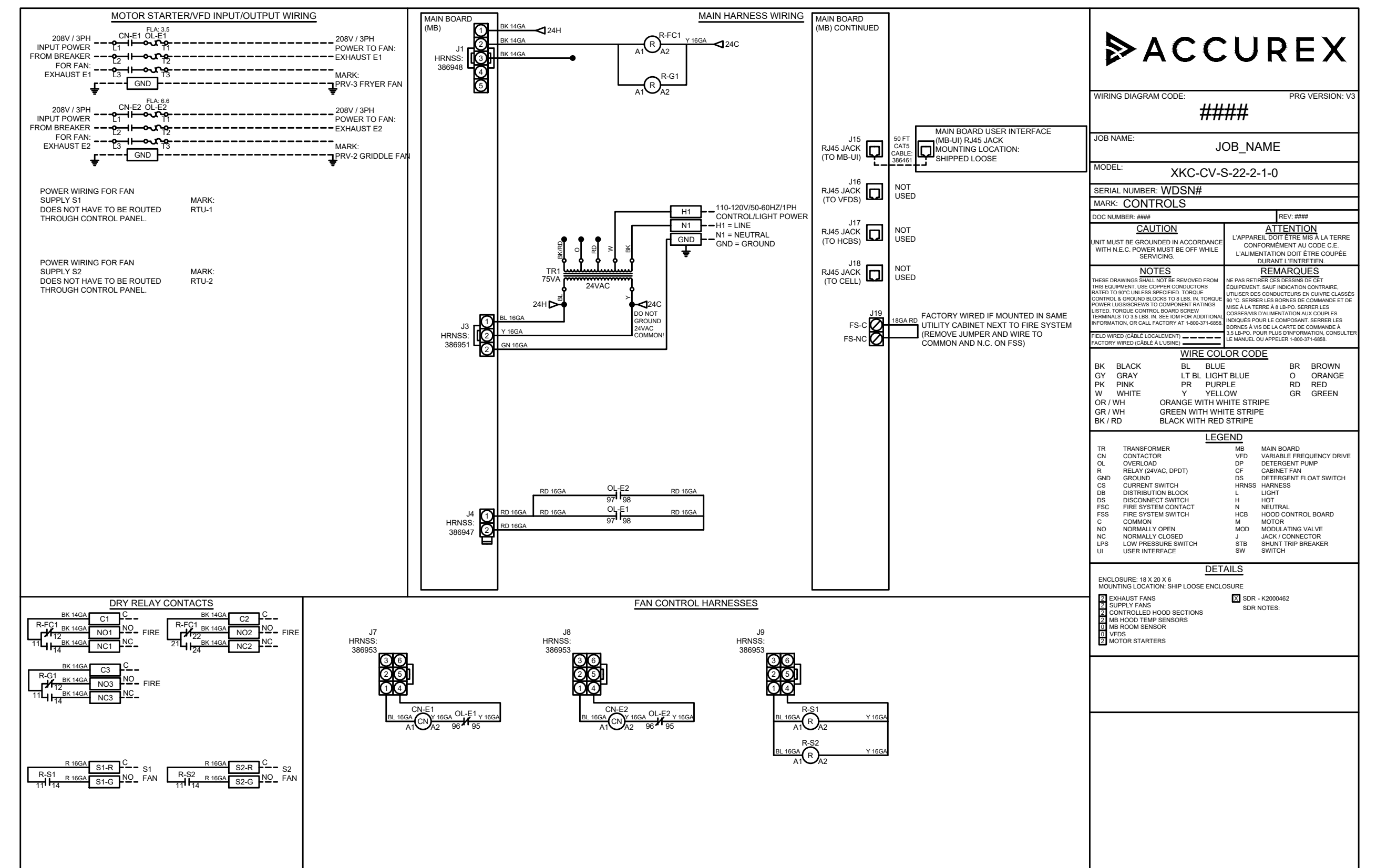
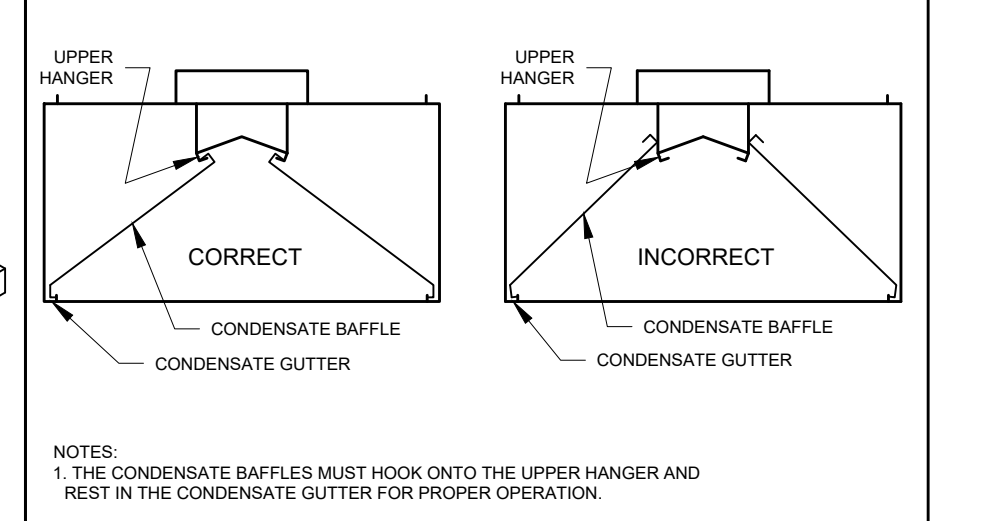

PROJECT: 12/4/2019
 CULVERS - MASTER
 ITEM 25 CONDENSATE HOOD PRV-1 RESTROOM LEF-1A
 CONTROLS

ACCUREX
 WIRING DIAGRAM CODE: #####
 JOB NAME: XKC-CV-S-22-2-1-0
 MODEL: XKC-CV-S-22-2-1-0
 MARK: CONTROLS
 SERIAL NUMBER: WDSN#
 WIRE COLOR CODE:
 BK BLACK, GRAY, PK PINK, W WHITE, OR/W ORANGE WITH WHITE STRIPE, GR/W GREEN WITH WHITE STRIPE, BK/R BLACK WITH RED STRIPE, BL BLUE, LT/LT LIGHT BLUE, O ORANGE, PR PURPLE, RD RED, Y YELLOW, CR GREEN.

ACCUREX
 PHILLIP KRAFT
 PHILLIP.KRAFT@ACCUREX.COM
 262-227-7865