

DUCTWORK #1 PARTS - JOB#5263694 DR4-EXIST

TAG	PART #	CFM	GPM	ZONE	COVEREDBY	SP	WEIGHT	VELOCITY	QTY	DESCRIPTION
P1	DW14FRISER						5.35		1	SINGLE WALL DUCT RISER WITH RETAINING RINGS, 14" DUCT, USED ON FIELD INSTALLATIONS. INCLUDES 1/4"-20 HARDWARE (8) NUTS (8) BOLTS - (1) SINGLE BOTTOM RING (2) TOP RINGS 2 PIECES PER ASSEMBLY.
P2	DW1445ASY						7.22		1	SINGLE WALL DUCT 45 DEGREE ELBOW, 14" DUCT, ASSEMBLY.
P3	DW1415ASY						6.00		1	SINGLE WALL DUCT 15 DEGREE ELBOW, 14" DUCT, ASSEMBLY.
P4	DW1411LT						5.46		1	SINGLE WALL DUCT 14" DIAMETER, 11' LONG, FLANGE AT BOTH ENDS. STAINLESS STEEL.
P5	DW1404LT						2.25		1	SINGLE WALL DUCT 14" DIAMETER, 4' LONG, FLANGE AT BOTH ENDS. STAINLESS STEEL.
P6	DW1418AJDKIT						11.56		1	SINGLE WALL DUCT ADJUSTABLE, 14" DIAMETER, 17.5' LONG, FLANGE AT ONE END WITH A 14" ADJUSTABLE COLLAR - STAINLESS STEEL.
P7	DW14SUBRASY						2.96		1	DUCT SUPPORT BRACKET KIT, 14" DUCT, USED FOR HANGING DUCT. 12 GA STEEL, CLEAR ZINC COATING - 2 RINGS, 4 BRACKETS, & HARDWARE BAG 2.
P8	DW1415ASY						6.00		1	SINGLE WALL DUCT 15 DEGREE ELBOW, 14" DUCT, ASSEMBLY.
P9	DW1445ASY						7.22		1	SINGLE WALL DUCT 45 DEGREE ELBOW, 14" DUCT, ASSEMBLY.
P10	DW1417LT						8.22		1	SINGLE WALL DUCT 14" DIAMETER, 17' LONG, FLANGE AT BOTH ENDS. STAINLESS STEEL.
P11 ASSEMBLED W/P12	DW1424AJDKIT						14.56		1	SINGLE WALL DUCT ADJUSTABLE, 14" DIAMETER, 23.5' LONG, FLANGE AT ONE END WITH A 14" ADJUSTABLE COLLAR - STAINLESS STEEL.
P12 ASSEMBLED W/P11	DW2614TPDBEX						12.50		1	DUCT TO CURB TRANSITION 3/4" DOWN TURN, 26-1/2" CURB TO 14" DUCT, 16 GA ALUMINIZED. FOR USE WITH EXHAUST FANS.
	3M-2000PLUS						0.80		3	DUCT - 3M FIRE BARRIER 2000 PLUS SILICONE - USED AS SEALANT TO SEAL DUCT JOINTS.
	DW14CLASY						1.06		10	DUCT "V" CLAMP WITH NEW DESIGN 14 GA BRACKETS, 14" DUCT, ASSEMBLY.
TOTAL WEIGHT							102.30			

DUCTWORK #1 FRONT VIEW
DR4-EXIST

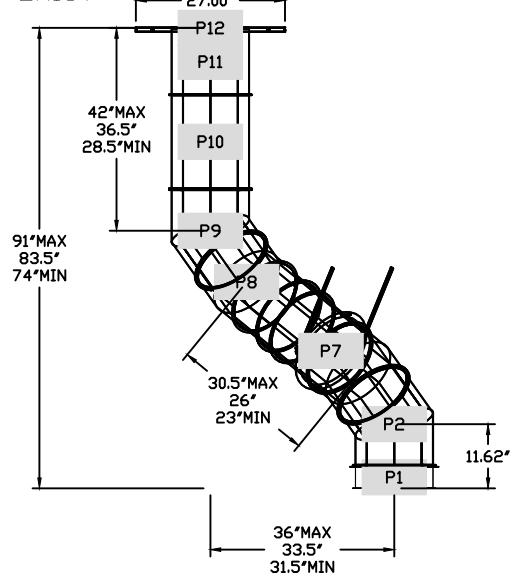

DUCTWORK #1 SE VIEW
DR4-EXIST

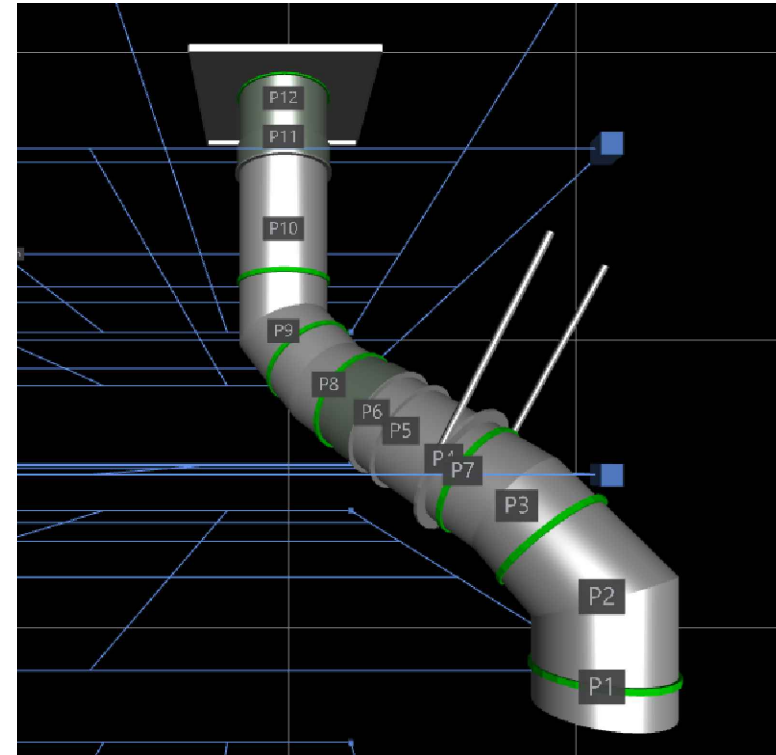
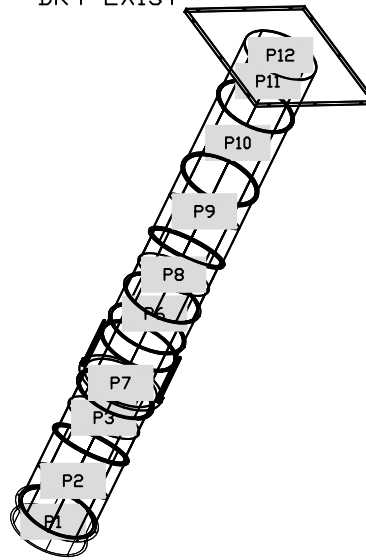

CAPTIVEAIRE

JOB West Social FoodHall Duct	
LOCATION Dayton, OH, 45402	
DATE 2/23/2022	JOB # 5263694
DWG # 1	DRAWN BY jcirilli
REV.	SCALE 3/8" = 1'-0"

DUCTWORK #2 PARTS - JOB#5263694 DR5-EXIST

TAG	PART #	CFM	GPM	ZONE	COVEREDBY	SP	WEIGHT	VELOCITY	QTY	DESCRIPTION
P1	DW14FRISER						5.35		1	SINGLE WALL DUCT RISER WITH RETAINING RINGS, 14" DUCT, USED ON FIELD INSTALLATIONS. INCLUDES 1/4"-20 HARDWARE (8) NUTS (8) BOLTS - (1) SINGLE BOTTOM RING (2) TOP RINGS 2 PIECES PER ASSEMBLY.
P2	DW1490ASY						10.62		1	SINGLE WALL DUCT 90 DEGREE ELBOW, 14" DUCT, ASSEMBLY.
P3	DW1417LT						8.22		1	SINGLE WALL DUCT 14" DIAMETER, 17" LONG, FLANGE AT BOTH ENDS. STAINLESS STEEL.
P4	DW1424AJDKIT						14.56		1	SINGLE WALL DUCT ADJUSTABLE, 14" DIAMETER, 23.5" LONG, FLANGE AT ONE END WITH A 14" ADJUSTABLE COLLAR - STAINLESS STEEL.
P5 ASSEMBLED W/P6	DW14TEASY			1			15.95		1	SINGLE WALL DUCT TEE, 14" DUCT, ASSEMBLY.
P6 ASSEMBLED W/P5 O=S	DW1415ADKIT						3.72		1	DUCT ACCESS DOOR WITH HANDLE & GREASE DAM, FOR 14" DUCT USE 15" DOOR. STAINLESS STEEL.
P7	DW1407LT						3.63		1	SINGLE WALL DUCT 14" DIAMETER, 7" LONG, FLANGE AT BOTH ENDS. STAINLESS STEEL.
P8	DW1429LT						13.62		1	SINGLE WALL DUCT 14" DIAMETER, 29" LONG, FLANGE AT BOTH ENDS. STAINLESS STEEL.
P9 ASSEMBLED W/P10	DW1448AJDKIT						26.62		1	SINGLE WALL DUCT ADJUSTABLE, 14" DIAMETER, 47.5" LONG, FLANGE AT ONE END WITH A 14" ADJUSTABLE COLLAR - STAINLESS STEEL.
P10 ASSEMBLED W/P9	DW2614TPDBEX						12.50		1	DUCT TO CURB TRANSITION 3/4" DOWN TURN, 26-1/2" CURB TO 14" DUCT, 16 GA ALUMINIZED. FOR USE WITH EXHAUST FANS.
P11	DW14SUBRASY						2.96		1	DUCT SUPPORT BRACKET KIT, 14" DUCT, USED FOR HANGING DUCT. 12 GA STEEL, CLEAR ZINC COATING. - 2 RINGS, 4 BRACKETS, & HARDWARE BAG 2.
	3M-2000PLUS						0.80		3	DUCT - 3M FIRE BARRIER 2000 PLUS SILICONE - USED AS SEALANT TO SEAL DUCT JOINTS.
	DW14CLASY						1.06		9	DUCT "V" CLAMP WITH NEW DESIGN 14 GA BRACKETS, 14" DUCT, ASSEMBLY.
TOTAL WEIGHT							129.69			

DUCTWORK #2 SE VIEW
DR5-EXIST

DUCTWORK #2 SIDE VIEW
DR5-EXIST

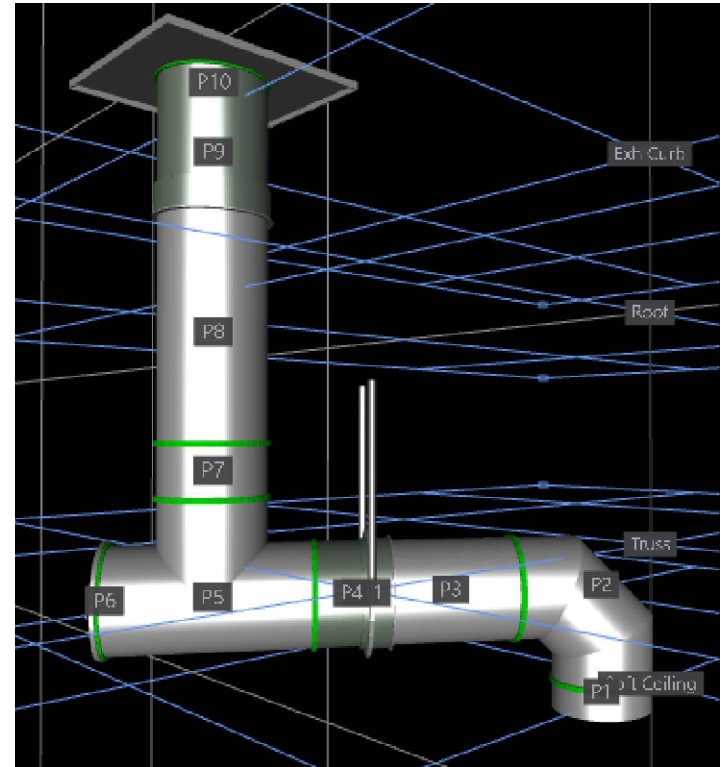
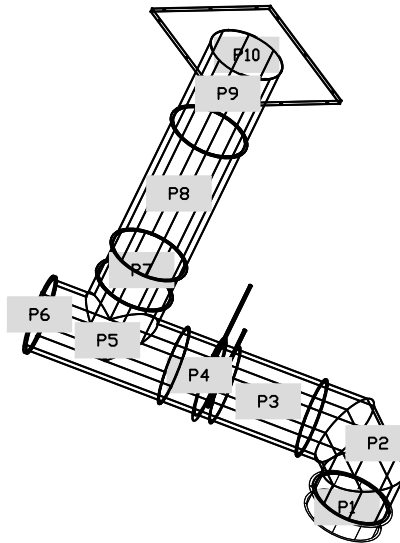
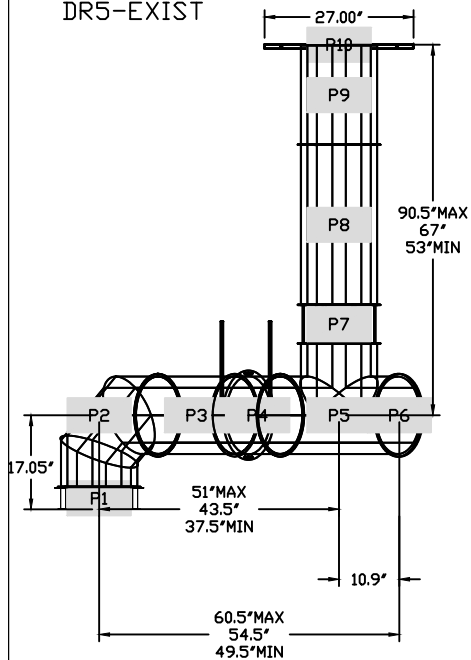

CAPTIVEAIRE

JOB West Social FoodHall Duct	
LOCATION Dayton, OH, 45402	
DATE 2/23/2022	JOB # 5263694
DWG # 2	DRAWN BY jcirilli
REV.	SCALE 3/8" = 1'-0"

DUCTWORK #3 PARTS - JOB#5263694 MISC

TAG	PART #	CFM	GPM	ZONE	COVEREDBY	SP	WEIGHT	VELOCITY	QTY	DESCRIPTION
P1	DW1415ASY						6.00		1	SINGLE WALL DUCT 15 DEGREE ELBOW, 14" DUCT, ASSEMBLY.
P2	DW1415ASY						6.00		1	SINGLE WALL DUCT 15 DEGREE ELBOW, 14" DUCT, ASSEMBLY.
P3	DW1417LT						8.22		1	SINGLE WALL DUCT 14" DIAMETER, 17" LONG, FLANGE AT BOTH ENDS. STAINLESS STEEL.
P4	DW1430AJDKIT						17.56		1	SINGLE WALL DUCT ADJUSTABLE, 14" DIAMETER, 29.5" LONG, FLANGE AT ONE END WITH A 14" ADJUSTABLE COLLAR - STAINLESS STEEL.
P5	DW1490ASY						10.62		1	SINGLE WALL DUCT 90 DEGREE ELBOW, 14" DUCT, ASSEMBLY.
P6 ASSEMBLED W/P7	DW14TEASY			1			15.95		1	SINGLE WALL DUCT TEE, 14" DUCT, ASSEMBLY.
P7 ASSEMBLED W/P6 D=T	DW1415ADKIT						3.72		1	DUCT ACCESS DOOR WITH HANDLE & GREASE DAM, FOR 14" DUCT USE 15" DOOR. STAINLESS STEEL.
	3M-2000PLUS						0.80		3	DUCT - 3M FIRE BARRIER 2000 PLUS SILICONE - USED AS SEALANT TO SEAL DUCT JOINTS.
	DW14CLASY						1.06		8	DUCT "V" CLAMP WITH NEW DESIGN 14 GA BRACKETS, 14" DUCT, ASSEMBLY.
TOTAL WEIGHT							78.95			

DUCTWORK #3 SE VIEW
MISC

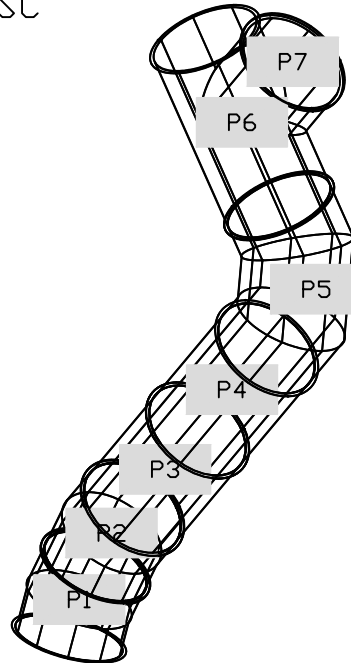

DUCTWORK #3 FRONT VIEW
MISC

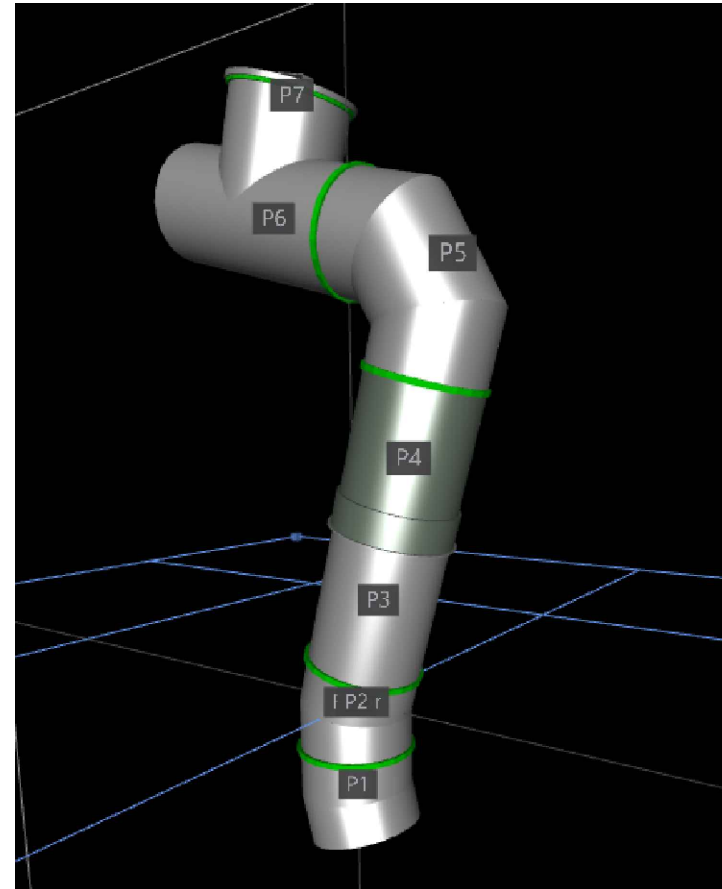
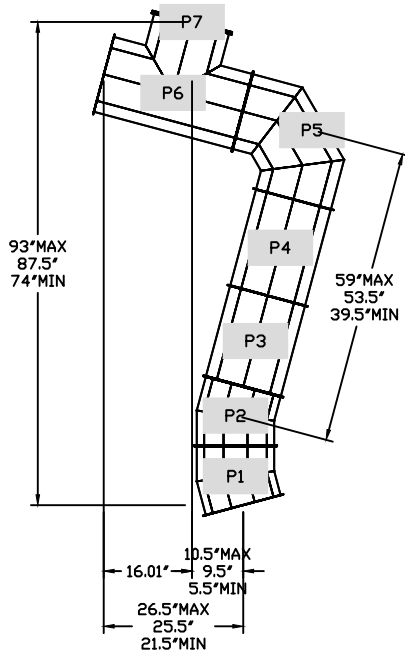

CAPTIVEAIRE

JOB West Social FoodHall Duct	
LOCATION Dayton, OH, 45402	
DATE 2/23/2022	JOB # 5263694
DWG # 3	DRAWN BY jcirilli
REV.	SCALE 3/8" = 1'-0"

DUCTWORK #1 PARTS - JOB#4604989 DOUBLE WALL OVEN-SR1

TAG	PART #	CFM	GPM	ZONE	COVEREDBY	SP	WEIGHT	VELOCITY	QTY	DESCRIPTION
P1	DW0827DWAJD-2R-S						33.86		1	DOUBLE WALL ADJUSTABLE DUCT - 8" INNER DUCT - 2 LAYERS REDUCED CLEARANCE - 12" STAINLESS STEEL OUTER SHELL. MIN LENGTH = 11' / MAX LENGTH = 26.5' / ADJUSTMENT = 15.5' / ADJUSTABLE SECTION MAY NEED TO BE CUT. INCLUDES SINGLE AND DOUBLE WALL "V" CLAMPS.
P2	DW0845DWASY-2R-S						10.66		1	DOUBLE WALL DUCT - 8" INNER 45 DUCT - 2 LAYERS REDUCED CLEARANCE - 12" STAINLESS STEEL OUTER SHELL.
P3	DW0847DWAJD-2R-S						63.04		1	DOUBLE WALL ADJUSTABLE DUCT - 8" INNER DUCT - 2 LAYERS REDUCED CLEARANCE - 12" STAINLESS STEEL OUTER SHELL. MIN LENGTH = 11' / MAX LENGTH = 50.5' / ADJUSTMENT = 32.5' / ADJUSTABLE SECTION MAY NEED TO BE CUT. INCLUDES SINGLE AND DOUBLE WALL "V" CLAMPS.
P4	DW1216SADKIT						5.14		1	DUCT - HORIZONTAL SADDLE SUPPORT KIT, USED WITH 12" OD - INCLUDES UNI-STRUT CUT TO LENGTH, DW1216SAD, & HARDWARE BAG 4.
P5	DW0845DWASY-2R-S						10.66		1	DOUBLE WALL DUCT - 8" INNER 45 DUCT - 2 LAYERS REDUCED CLEARANCE - 12" STAINLESS STEEL OUTER SHELL.
P6 ASSEMBLED W/P7	DW0847DWAJDP-2R-S						63.17		1	DOUBLE WALL ADJUSTABLE DUCT TRANSITION PLATE - 8" INNER DUCT - 2 LAYERS REDUCED CLEARANCE - 12" STAINLESS STEEL OUTER SHELL. MIN LENGTH = 11' / MAX LENGTH = 50.5' / ADJUSTMENT = 32.5' / ADJUSTABLE SECTION MAY NEED TO BE CUT. INCLUDES SINGLE AND DOUBLE WALL "V" CLAMPS.
P7 ASSEMBLED W/P6	DW1908TPDB						11.82		1	DUCT TO CURB TRANSITION DOWN TURN, 19 1/2" CURB TO 8" DUCT, 16 GA ALUMINIZED STEEL. NON-STANDARD PART. NOT FOR USE WITH EXHAUST FANS.
	3M-2000PLUS						0.80		1	DUCT - 3M FIRE BARRIER 2000 PLUS SILICONE - USED AS SEALANT TO SEAL DUCT JOINTS.
TOTAL WEIGHT							199.15			

DUCTWORK #1 FRONT VIEW
OVEN-SR1

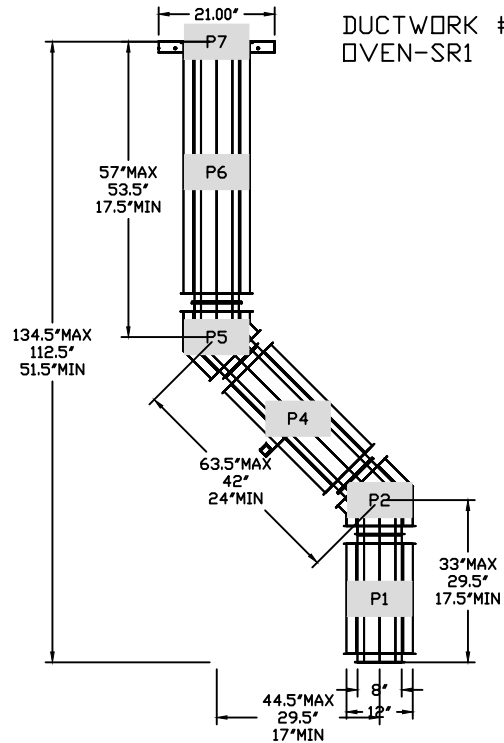

DUCTWORK #1 SE VIEW
OVEN-SR1

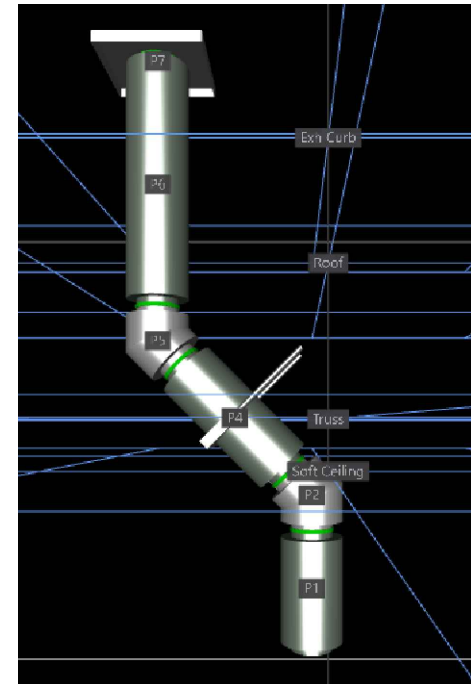
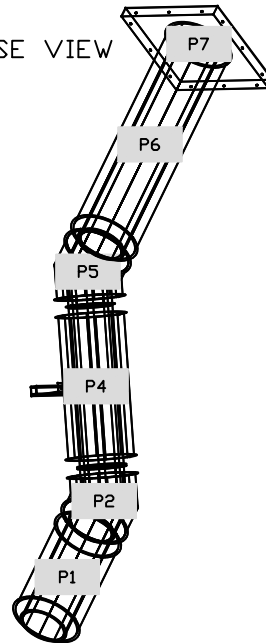

CAPTIVEAIRE

JOB West Social FoodHall (Dayton)	
LOCATION Dayton, OH, 45402	
DATE 2/17/2022	JOB # 4604989
DWG # 9	DRAWN BY jclairilli
REV.	SCALE 3/8" = 1'-0"

DUCTWORK #3 PARTS - JOB#4604989 DR-5 GREASE

TAG	PART #	CFM	GPM	ZONE	COVEREDBY	SP	WEIGHT	VELOCITY	QTY	DESCRIPTION
P1	DW1445ASY	1600				-0.0368	7.22	1496.71	1	SINGLE WALL DUCT 45 DEGREE ELBOW, 14" DUCT, ASSEMBLY.
P2	DW1411LT	1600				-0.0039	5.46	1496.71	1	SINGLE WALL DUCT 14" DIAMETER, 11' LONG, FLANGE AT BOTH ENDS. STAINLESS STEEL.
P3	DW1418AJDKIT	1600				-0.0021	11.56	1496.71	1	SINGLE WALL DUCT ADJUSTABLE, 14" DIAMETER, 17.5' LONG, FLANGE AT ONE END WITH A 14" ADJUSTABLE COLLAR - STAINLESS STEEL.
P4	DW14SUBRASY						2.96		1	DUCT SUPPORT BRACKET KIT, 14" DUCT, USED FOR HANGING DUCT. 12 GA STEEL, CLEAR ZINC COATING. - 2 RINGS, 4 BRACKETS, & HARDWARE BAG 2
P5	DW1445ASY	1600				-0.0525	7.22	1496.71	1	SINGLE WALL DUCT 45 DEGREE ELBOW, 14" DUCT, ASSEMBLY.
P6	DW1435LT	1600				-0.0119	16.34	1496.71	1	SINGLE WALL DUCT 14" DIAMETER, 35' LONG, FLANGE AT BOTH ENDS. STAINLESS STEEL.
P7 ASSEMBLED W/P8	DW1430AJDKIT	1600				-0.0041	17.56	1496.71	1	SINGLE WALL DUCT ADJUSTABLE, 14" DIAMETER, 29.5' LONG, FLANGE AT ONE END WITH A 14" ADJUSTABLE COLLAR - STAINLESS STEEL.
P8 ASSEMBLED W/P7	DW2314TPDBEX	1600					8.00	1496.71	1	DUCT TO CURB TRANSITION 3/4" DOWN TURN, 23" CURB TO 14" DUCT, 16 GA ALUMINIZED. USED ON NCA14FA & NCA14HPFA. TRANSITION PLATE DD IS 23.5" DESIGNED FOR USE WITH EXHAUST FAN. NON-STANDARD PART.
SYSTEM AT P8						-0.4523	0.00			
	3M-2000PLUS						0.80		2	DUCT - 3M FIRE BARRIER 2000 PLUS SILICONE - USED AS SEALANT TO SEAL DUCT JOINTS.
	DW14CLASY						1.06		6	DUCT "V" CLAMP WITH NEW DESIGN 14 GA BRACKETS, 14" DUCT, ASSEMBLY.
TOTAL WEIGHT							84.28			

DUCTWORK #3 FRONT VIEW
DR-5 GREASE

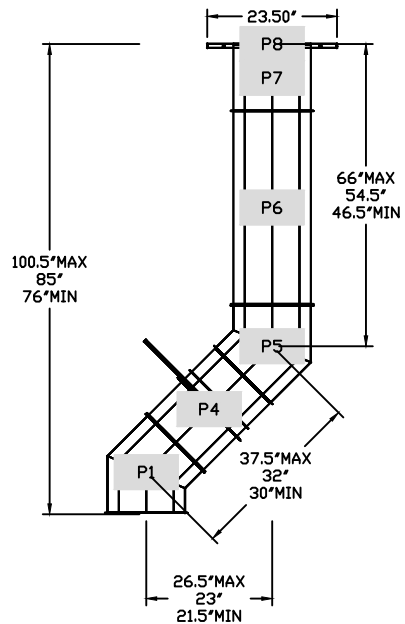

DUCTWORK #3 SE VIEW
DR-5 GREASE

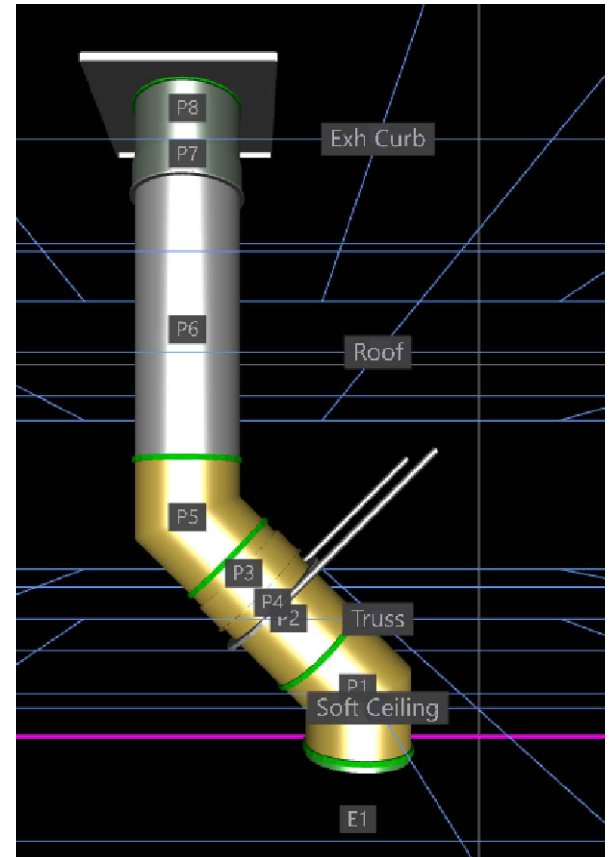
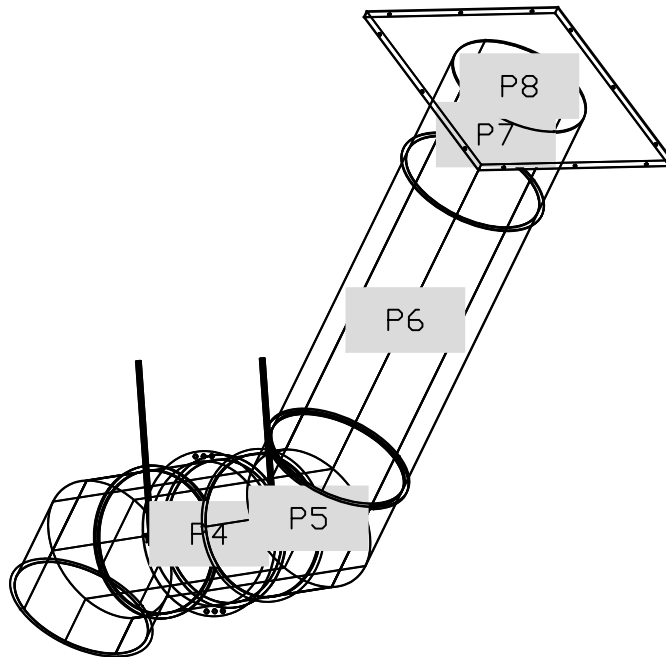

CAPTIVEAIRE

JOB West Social FoodHall (Dayton)	
LOCATION Dayton, OH, 45402	
DATE 2/17/2022	JOB # 4604989
DWG # 17	DRAWN BY jcirilli
REV.	SCALE 3/8" = 1'-0"

DUCTWORK #2 PARTS - JOB#4604989 DR-2 GREASE

TAG	PART #	CFM	GPM	ZONE	COVEREDBY	SP	WEIGHT	VELOCITY	QTY	DESCRIPTION
P1	DW1445ASY	1600				-0.0368	7.22	1496.71	1	SINGLE WALL DUCT 45 DEGREE ELBOW, 14" DUCT, ASSEMBLY.
P2	DW1411LT	1600				-0.0039	5.46	1496.71	1	SINGLE WALL DUCT 14" DIAMETER, 11' LONG, FLANGE AT BOTH ENDS. STAINLESS STEEL.
P3	DW1418AJDKIT	1600				-0.0021	11.56	1496.71	1	SINGLE WALL DUCT ADJUSTABLE, 14" DIAMETER, 17.5' LONG, FLANGE AT ONE END WITH A 14" ADJUSTABLE COLLAR - STAINLESS STEEL.
P4	DW14SUBRASY						2.96		1	DUCT SUPPORT BRACKET KIT, 14" DUCT, USED FOR HANGING DUCT. 12 GA STEEL, CLEAR ZINC COATING. - 2 RINGS, 4 BRACKETS, & HARDWARE BAG 2
P5	DW1445ASY	1600				-0.0525	7.22	1496.71	1	SINGLE WALL DUCT 45 DEGREE ELBOW, 14" DUCT, ASSEMBLY.
P6	DW1435LT	1600				-0.0119	16.34	1496.71	1	SINGLE WALL DUCT 14" DIAMETER, 35' LONG, FLANGE AT BOTH ENDS. STAINLESS STEEL.
P7 ASSEMBLED W/P8	DW1430AJDKIT	1600				-0.0041	17.56	1496.71	1	SINGLE WALL DUCT ADJUSTABLE, 14" DIAMETER, 29.5' LONG, FLANGE AT ONE END WITH A 14" ADJUSTABLE COLLAR - STAINLESS STEEL.
P8 ASSEMBLED W/P7	DW2314TPDBEX	1600					8.00	1496.71	1	DUCT TO CURB TRANSITION 3/4" DOWN TURN, 23" CURB TO 14" DUCT, 16 GA ALUMINIZED. USED ON NCA14FA & NCA14HPFA. TRANSITION PLATE DD IS 23.5" DESIGNED FOR USE WITH EXHAUST FAN. NON-STANDARD PART.
SYSTEM AT P8						-0.4523	0.00			
	3M-2000PLUS						0.80		2	DUCT - 3M FIRE BARRIER 2000 PLUS SILICONE - USED AS SEALANT TO SEAL DUCT JOINTS.
	DW14CLASY						1.06		6	DUCT "V" CLAMP WITH NEW DESIGN 14 GA BRACKETS, 14" DUCT, ASSEMBLY.
TOTAL WEIGHT							84.28			

DUCTWORK #2 FRONT VIEW
DR-2 GREASE

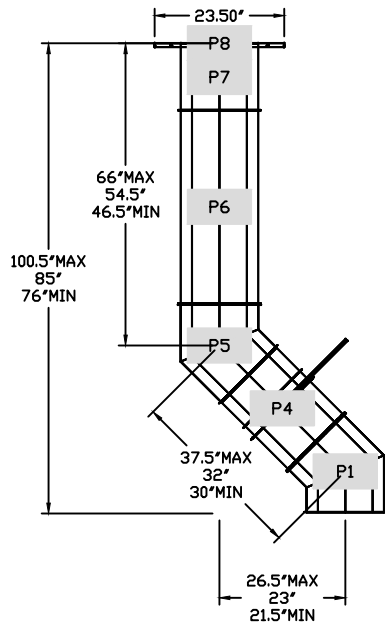

DUCTWORK #3 SIDE VIEW
DR-5 GREASE

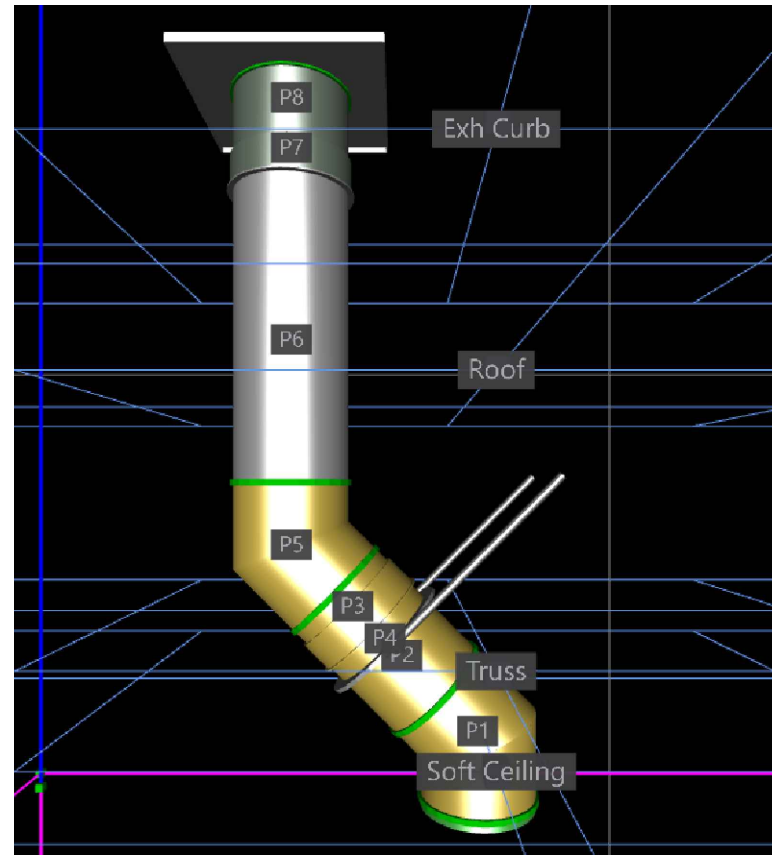
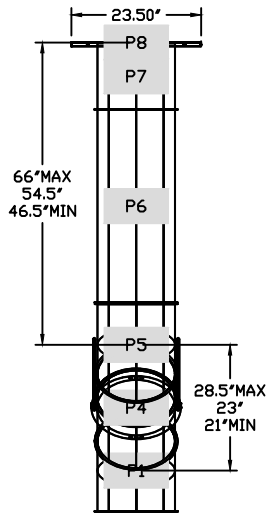

CAPTIVEAIRE

JOB West Social FoodHall (Dayton)	
LOCATION Dayton, OH, 45402	
DATE 2/17/2022	JOB # 4604989
DWG # 28	DRAWN BY jcirilli
REV.	SCALE 3/8" = 1'-0"