

HOOD INFORMATION

HOOD NO.	MARK	MODEL	HOOD DIMENSIONS (IN.)			HOOD CONSTR.	COOKING LOAD / DUTY RATING	TOTAL CFM	EXHAUST COLLAR(S)					SUPPLY		TOTAL WEIGHT LBS.	SECTION LOCATION			
			LENGTH	WIDTH	HEIGHT				WIDTH	LENGTH	DIA.	CFM	S.P.	MUA CFM	AC CFM					
1	KH-2 (ITEM 26)	XBEW-180-S	180	75	24	300 SERIES SS WHERE EXPOSED	HEAVY	3300	9	16	1650	0.452	9	16	1650	0.452	2970		506.11	SINGLE

HOOD INFORMATION

HOOD NO.	MARK	LIGHTING DETAILS			GREASE FILTRATION DETAILS			UTILITY CABINET(S)				
		FIXTURE TYPE BULB / LAMP INFO	QTY	FOOT CANDLES	TYPE / MODEL MATERIAL	QTY	SIZE (IN.) L H	LOCATION	FIRE SYSTEM		CONTROLS	
1	KH-2 (ITEM 26)	ROUND LED	4	74.29	BAFFLE STAINLESS STEEL	5	16 20	WALL				

SUPPLY PLENUM INFORMATION

HOOD NO.	MARK	POS.	TYPE	SIZE (IN.)			INSULATED	DAMPER(S)	LED LIGHT(S)		TOTAL CFM	COLLARS								
				L	W	H			SUPPLIED	QTY		TYPE	MOUNTING	QTY	W	L	DIA.	CFM	S.P.	VEL.
1	KH-2 (ITEM 26)	FRONT	ASP	180	14	10	NO	YES	NO		2970	MUA	LOOSE	4	10	28		743	0.18	382

HOOD OPTIONS

UL 710 LISTED W/ OUT EXHAUST FIRE DAMPER - UL #R25625
 BACK INTEGRAL AIR SPACE - 3 IN WIDE
 18 IN HIGH CEILING ENCLOSURES - FRONT LEFT RIGHT - FIELD INSTALLED
 SHIPPED LOOSE EXHAUST COLLAR(S)
 WALL UTILITY CABINET 24 IN HIGH 36 IN LONG 12 IN WIDE
 FILTER REMOVAL TOOL INCLUDED - QTY 1
 BACKSPLASH 80.00 IN HIGH 180.00 IN LONG
 PERFORMANCE ENHANCING LIP (PEL) TECHNOLOGY
 STANDING SEAM CONSTRUCTION FOR SUPERIOR STRENGTH

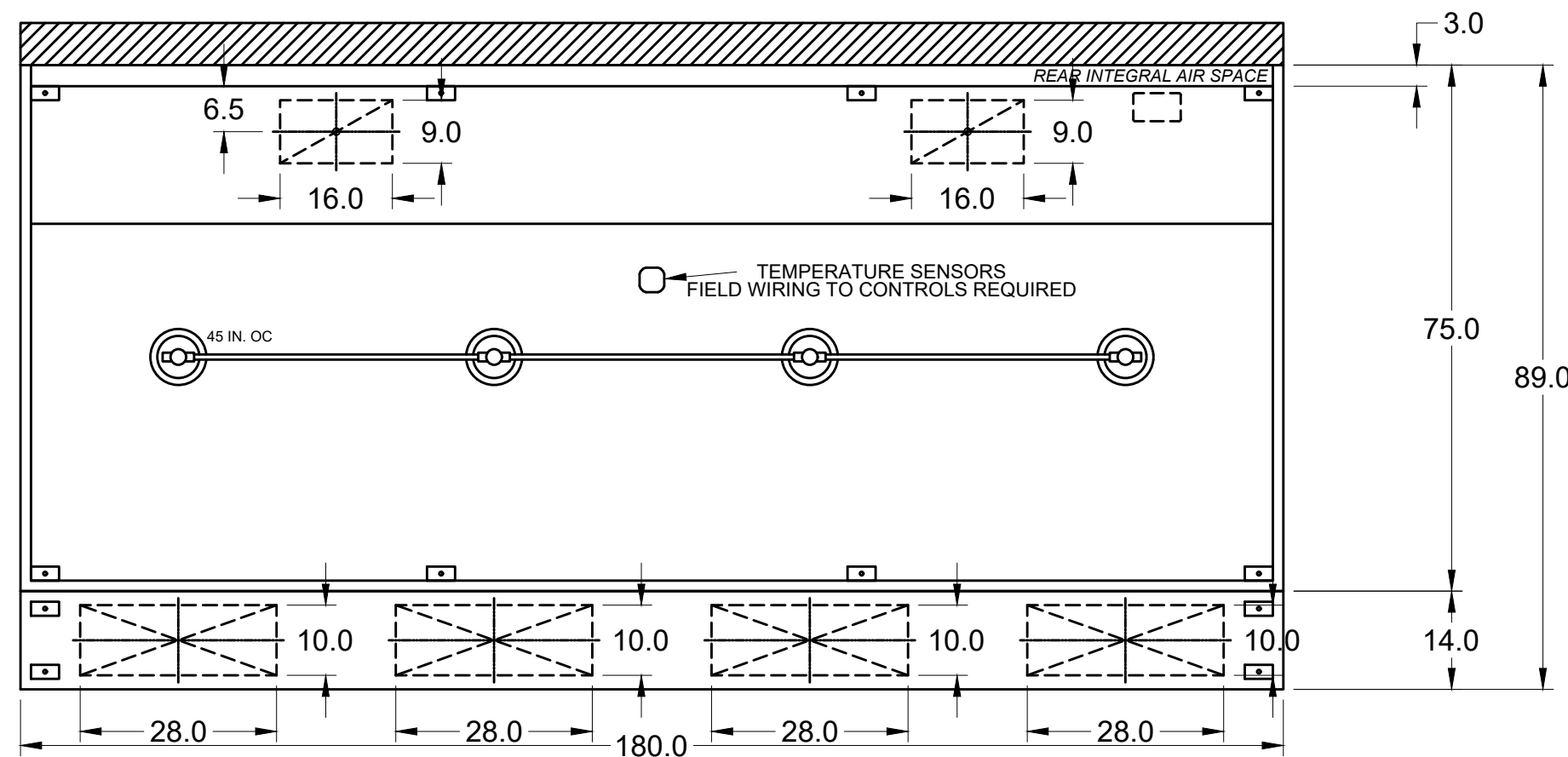

MARK: KH-2 (Item 26) - SECTION 1
PLAN VIEW

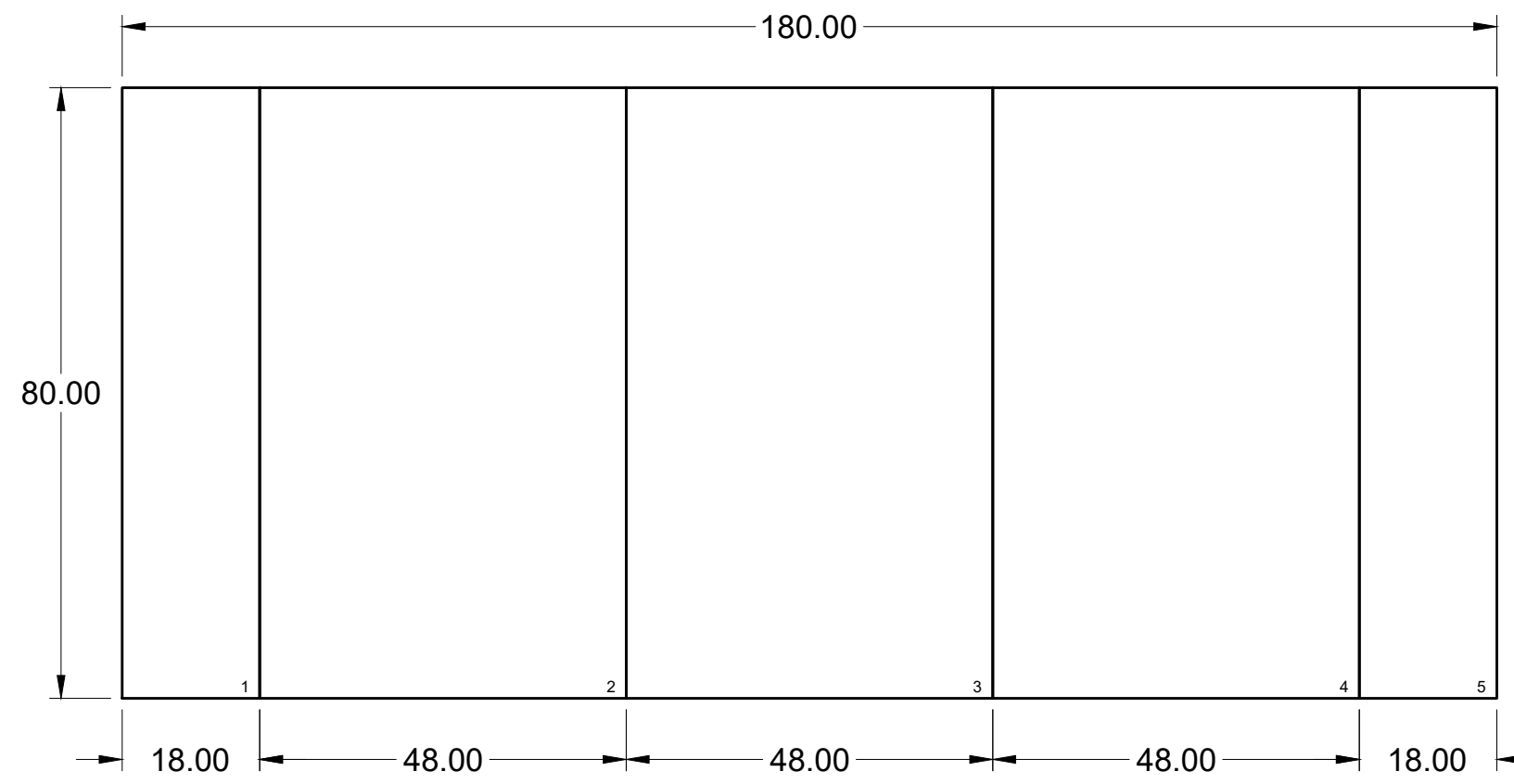

BACK SPLASH

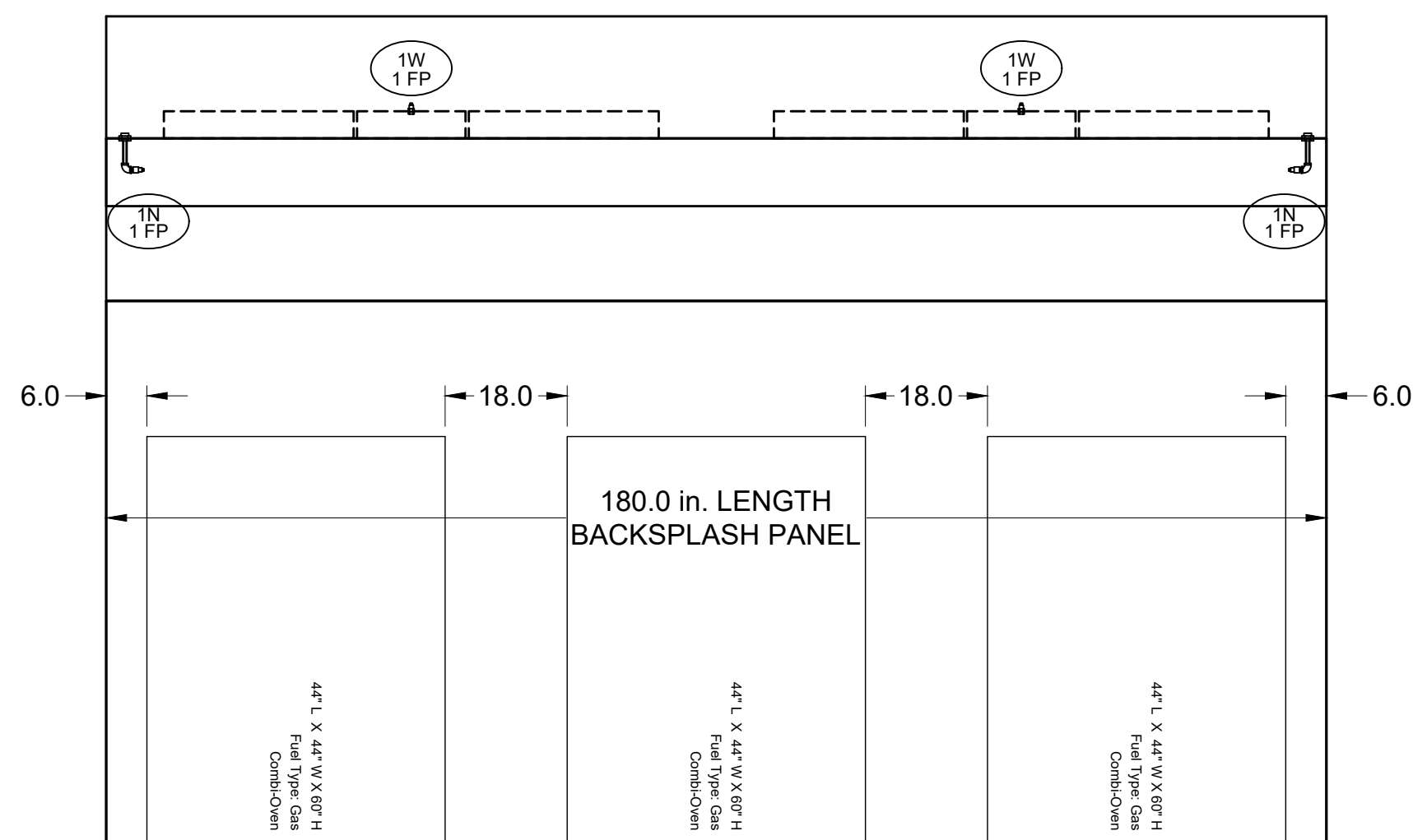

MARK: KH-2 (Item 26) - SECTION 1
ELEVATION VIEW

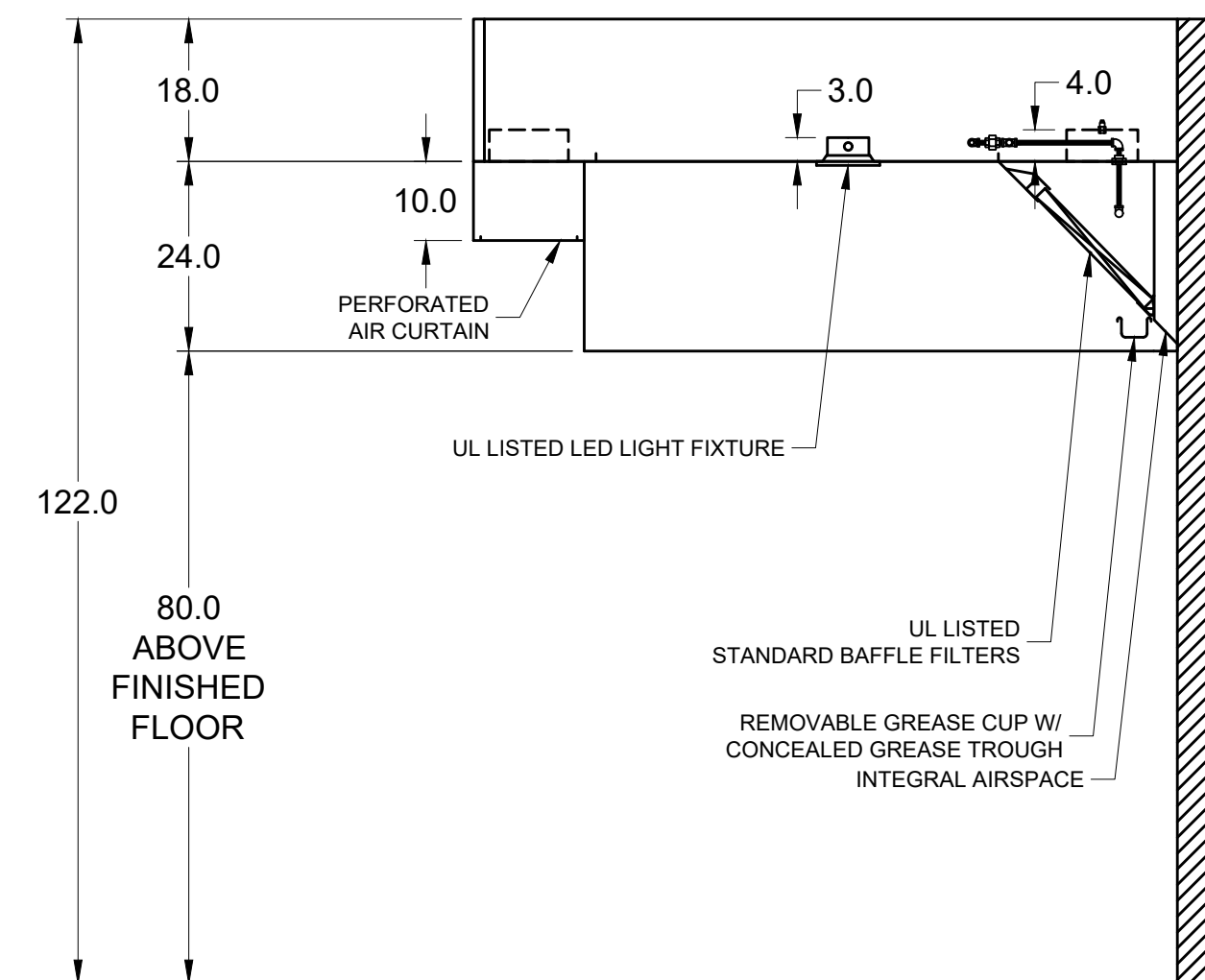

MARK: KH-2 (Item 26)
SECTION VIEW

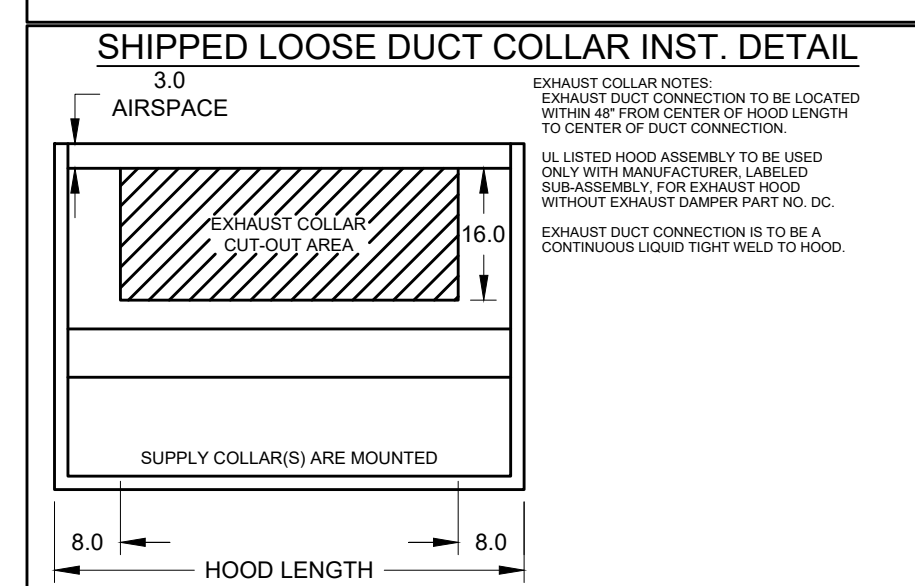
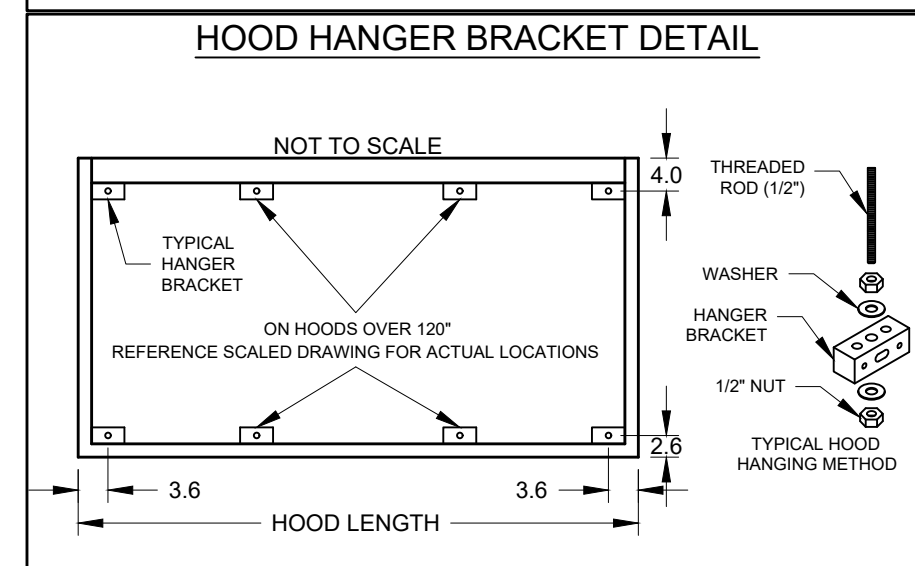
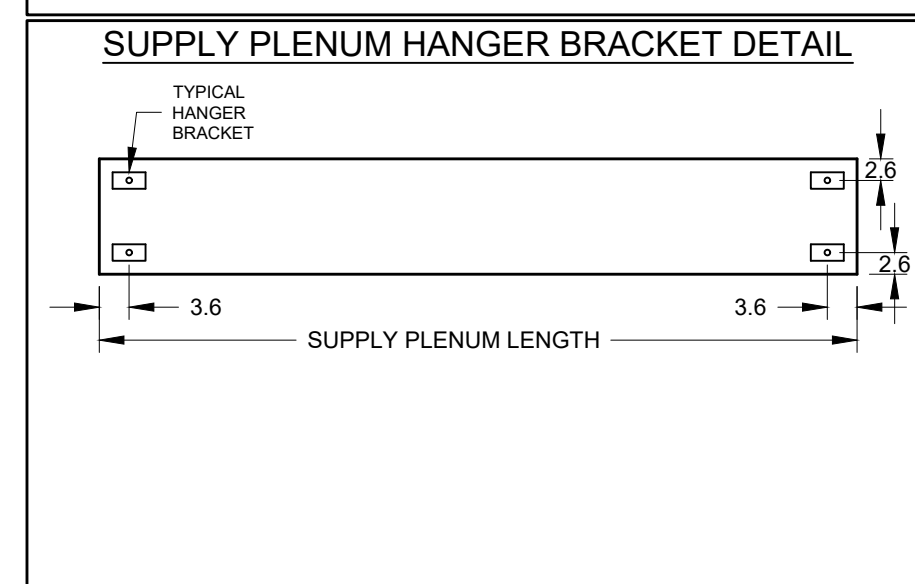
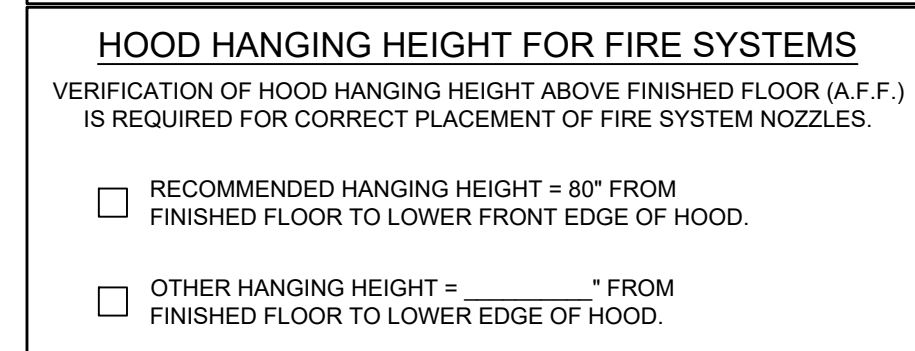
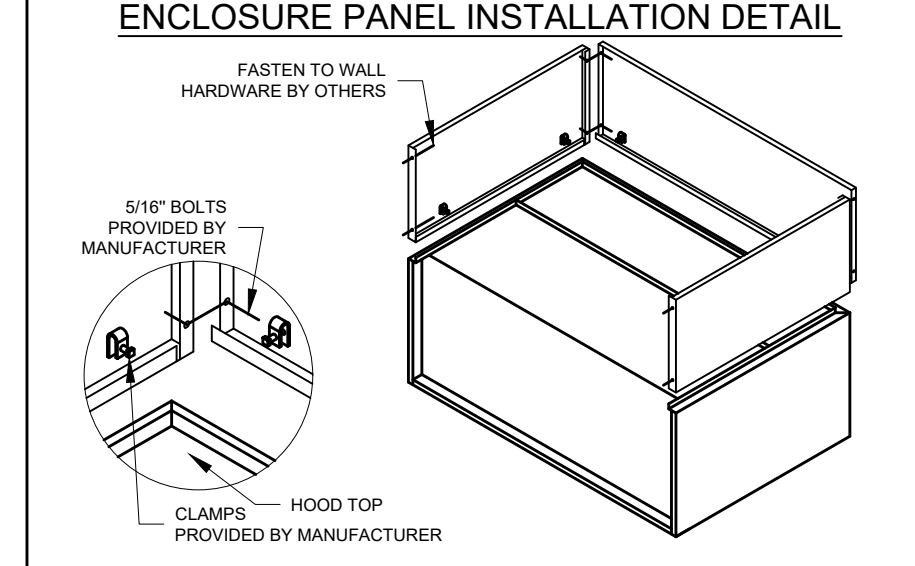
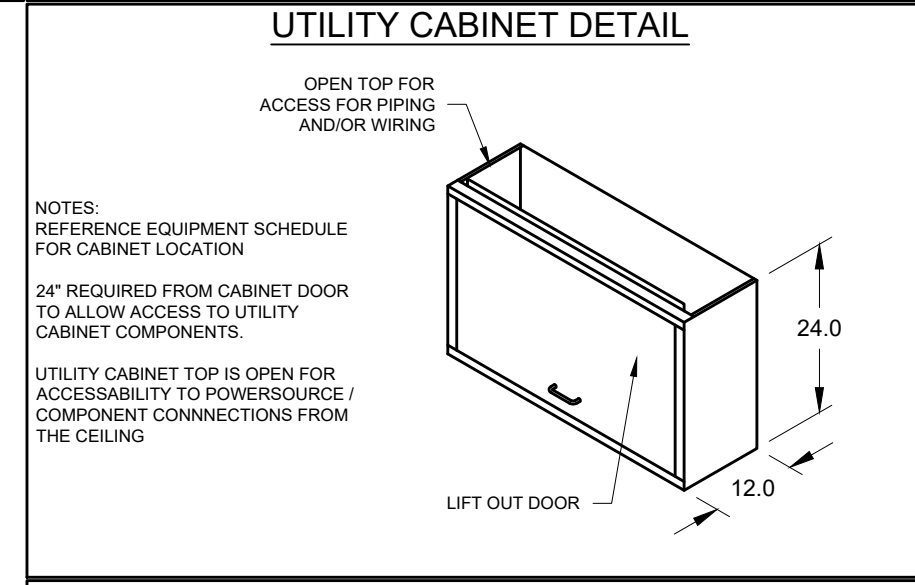
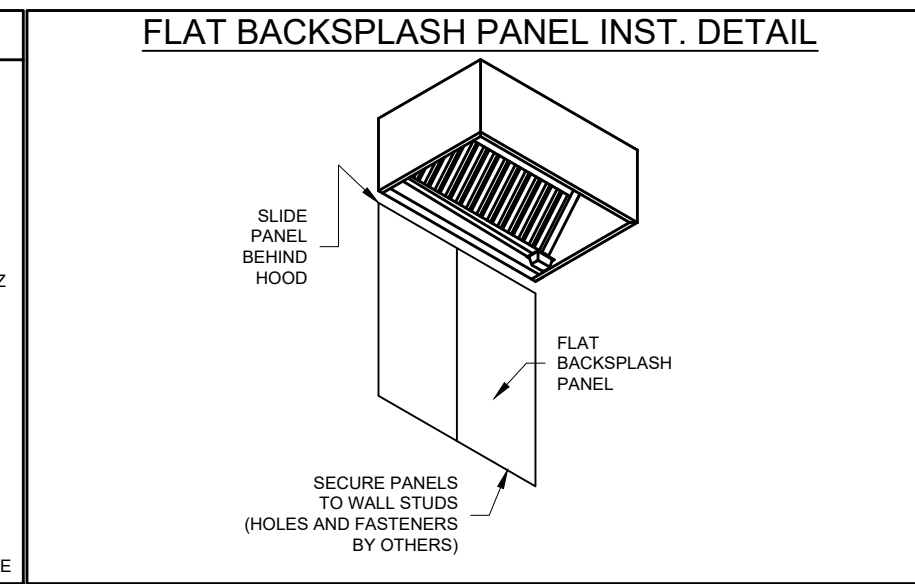
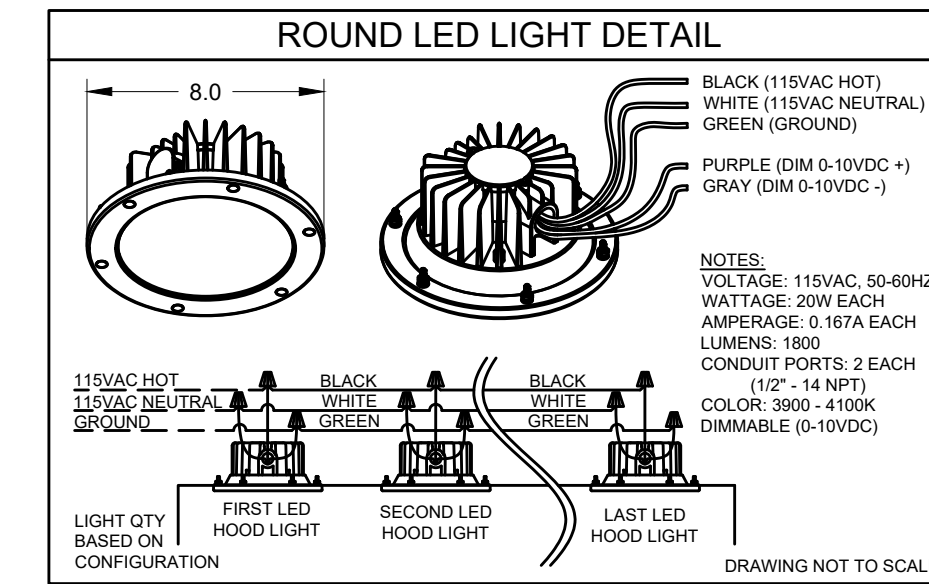

ACCESSORY INFORMATION

MARK	MODEL	TYPE	DIMENSIONS (IN.)			CONSTR.	LOCATION
			TOP	BOTTOM	HEIGHT		
END PANELS (ITEM 14A)	ENDSKIRT	MINI	48	18	42	430 S.S.	LEFT
	ENDSKIRT	MINI	48	18	42	430 S.S.	RIGHT

SPECIAL DESIGN REQUESTS

SDR #K2100435 - CUSTOM MINI END SKIRT

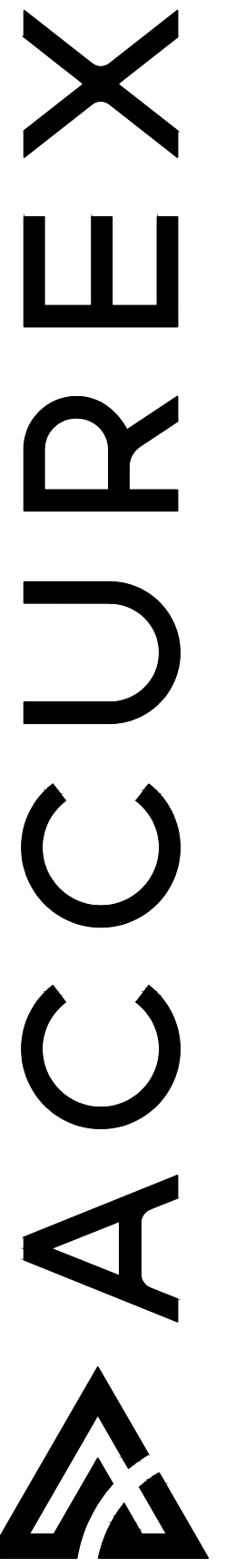
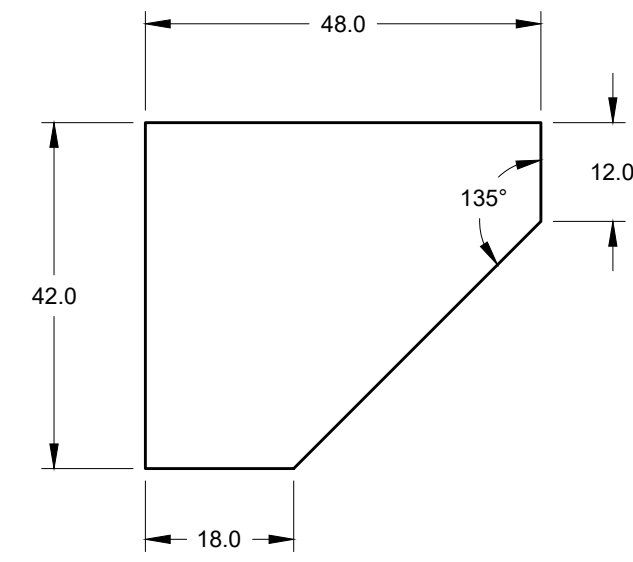
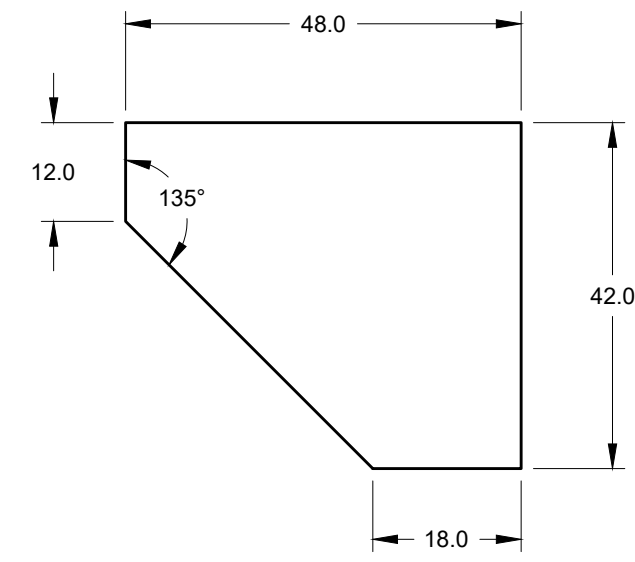

ACCUREX W/IA
 PHILLIP KRAFT
 PHILLIP.KRAFT@ACCUREX.COM
 (262)227-7865

PROJECT
 11/30/2021

MARK

OSHKOSH CORRECTIONAL

END PANELS (ITEM 14A)



ACCESSORY INFORMATION

MARK	MODEL	TYPE	DIMENSIONS (IN.)			CONSTR.	LOCATION
			TOP	BOTTOM	HEIGHT		
END PANELS (ITEM 14B)	ENDSKIRT	MINI	48	18	42	430 S.S.	LEFT
	ENDSKIRT	MINI	48	18	42	430 S.S.	RIGHT

SPECIAL DESIGN REQUESTS

SDR #K2100435 - CUSTOM MINI END SKIRT

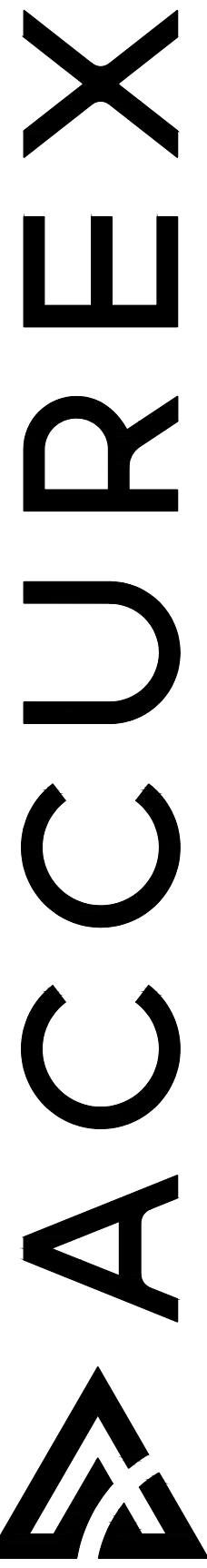
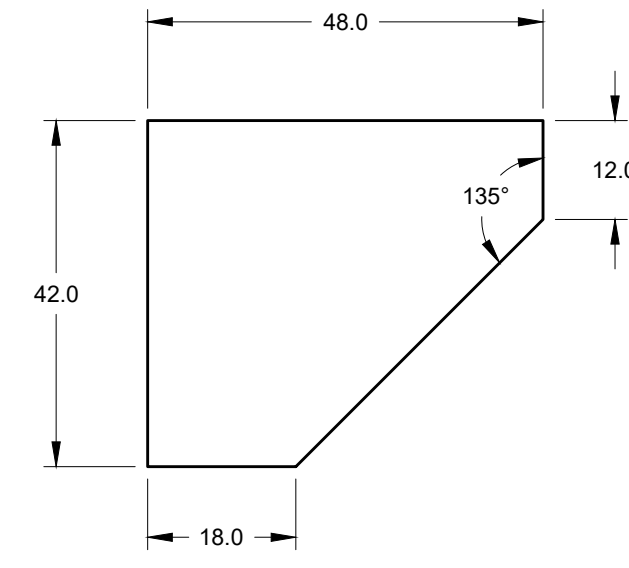
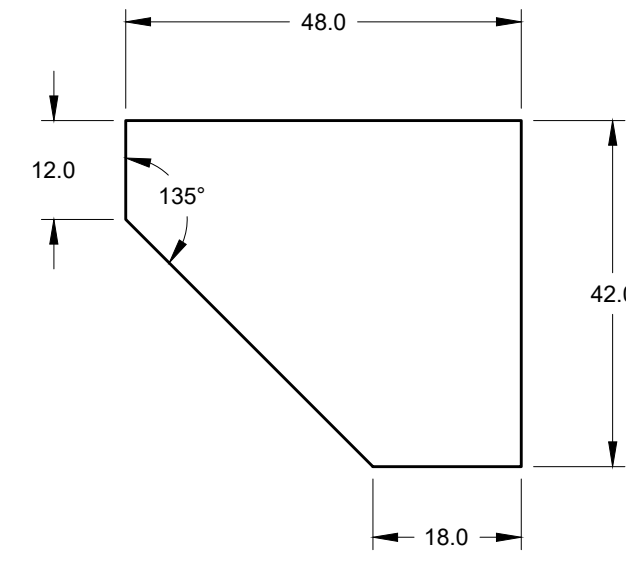

ACCUREX W/IA
 PHILLIP KRAFT
 PHILLIP.KRAFT@ACCUREX.COM
 (262)227-7865

PROJECT
 11/30/2021

MARK

OSHKOSH CORRECTIONAL

END PANELS (ITEM 14B)



SUPPLY PLENUM INFORMATION

QTY	MARK	POS.	TYPE	SIZE (IN.)			INSULATED	DAMPER(S)	LED LIGHT(S)		TOTAL CFM	COLLARS								
				L	W	H			SUPPLIED	QTY		TYPE	MOUNTING	QTY	W	L	DIA.	CFM	S.P.	VEL.
4	SP-1 (ITEM 15 A AND B)	FRONT	ASP	147	14	10	NO	YES	NO		2156	MUA	LOOSE	3	10	28		719	0.14	370

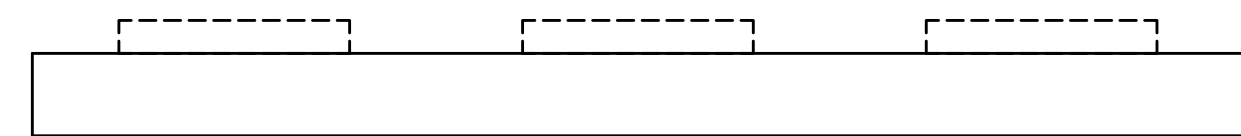
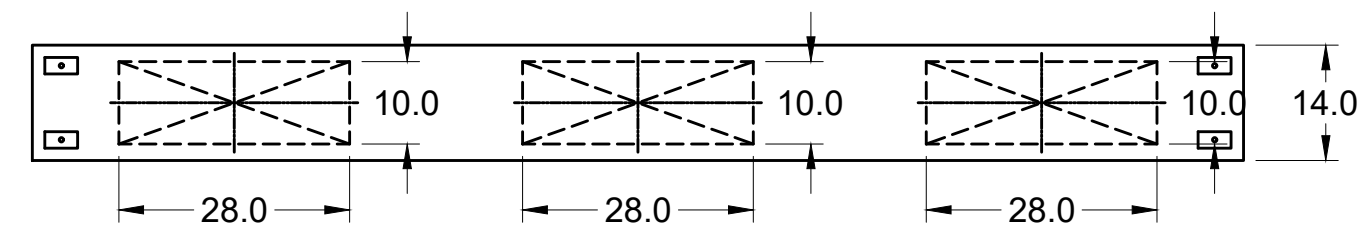
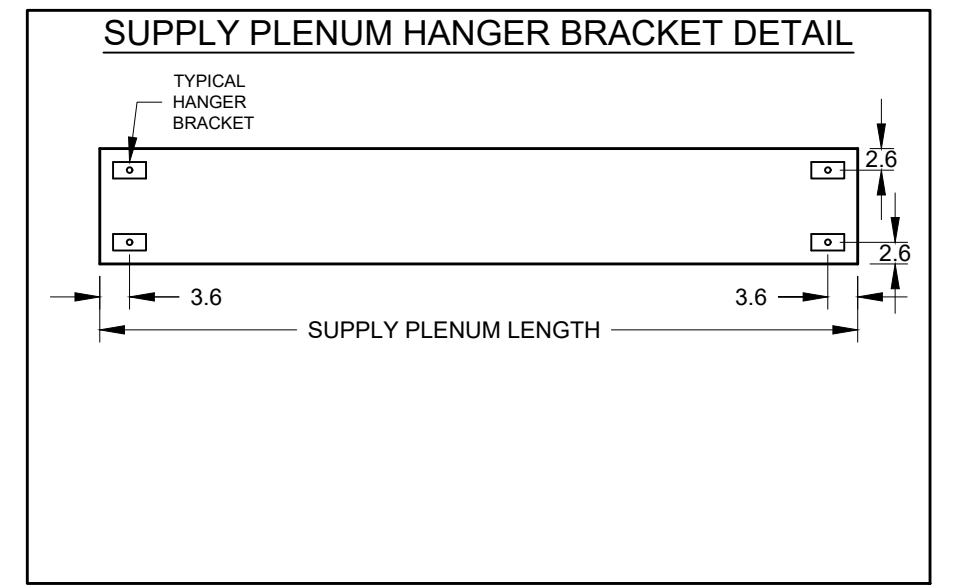

MARK: SP-1 (Item 15 A and B)

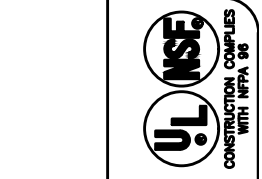
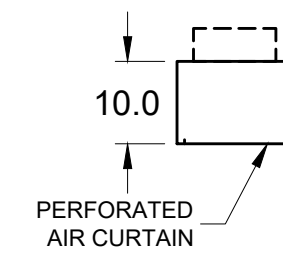

OSHKOSH CORRECTIONAL

PROJECT
11/30/2021

MARK

SP-1 (ITEM 15 A AND B)

ACCUREX W/IA
PHILLIP KRAFT
PHILLIP.KRAFT@ACCUREX.COM
(262)227-7865

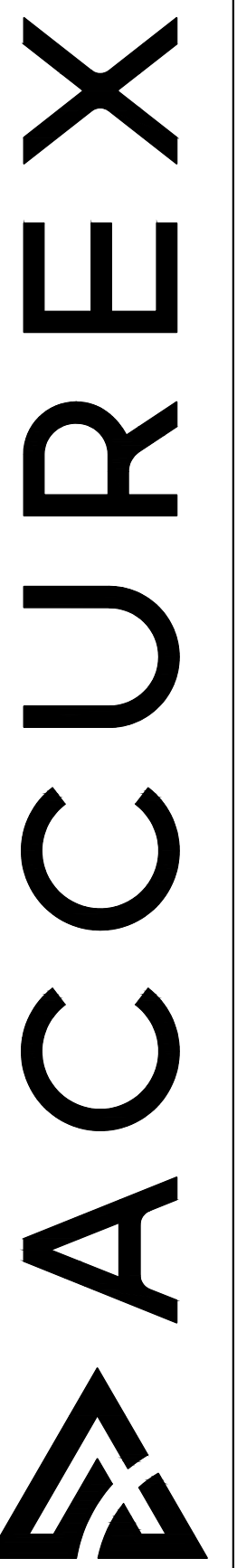

SUPPLY PLENUM INFORMATION

QTY	MARK	POS.	TYPE	SIZE (IN.)			INSULATED	DAMPER(S)	LED LIGHT(S)		TOTAL CFM	COLLARS								
				L	W	H			SUPPLIED	QTY		TYPE	MOUNTING	QTY	W	L	DIA.	CFM	S.P.	VEL.
1	SP-2 LEFT (ITEM 7)	FRONT	ASP	120	14	10	NO	YES	NO		1980	MUA	LOOSE	3	10	26		660	0.18	366

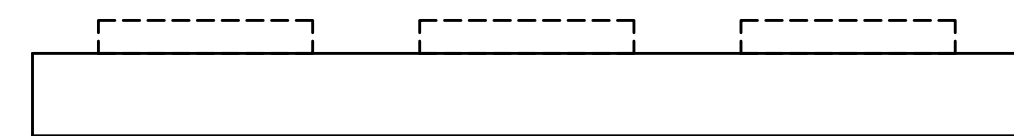
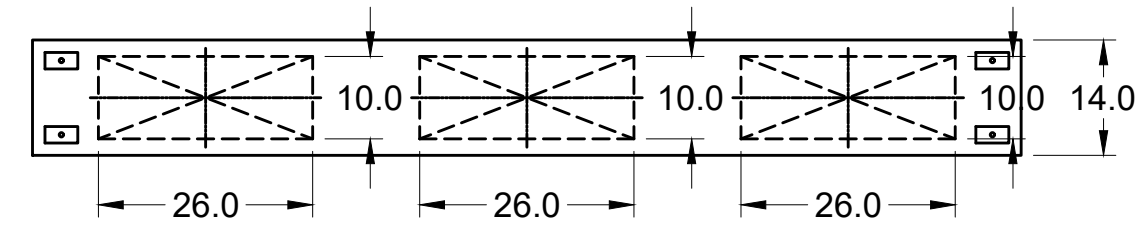
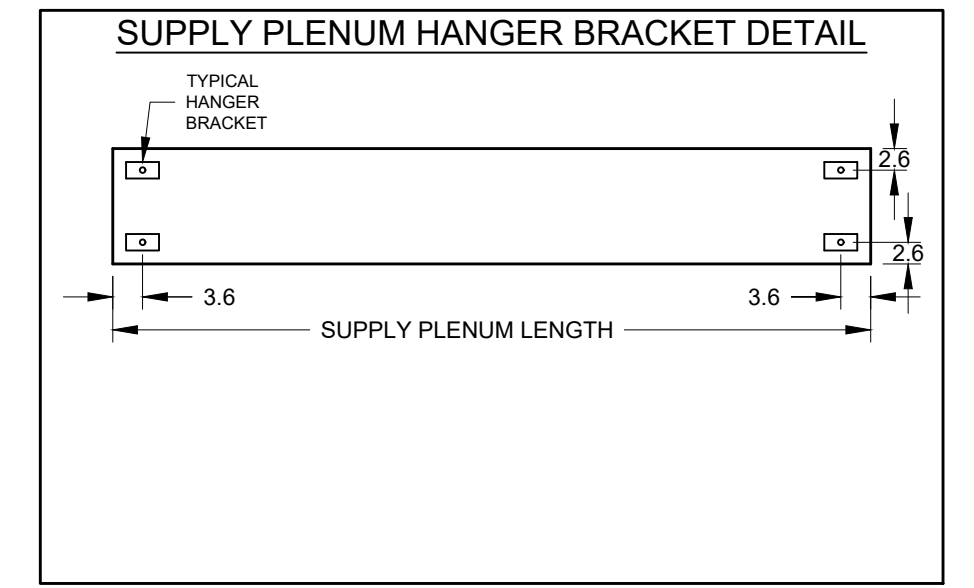

MARK: SP-2 Left (Item 7)

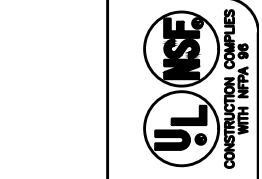
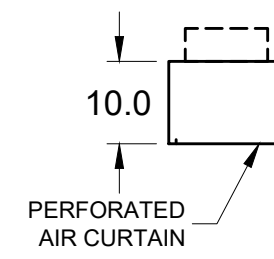

OSHKOSH CORRECTIONAL

SP-2 LEFT (ITEM 7)

PROJECT
11/30/2021

MARK

ACCUREX W/IA
PHILLIP KRAFT
PHILLIP.KRAFT@ACCUREX.COM
(262)227-7865

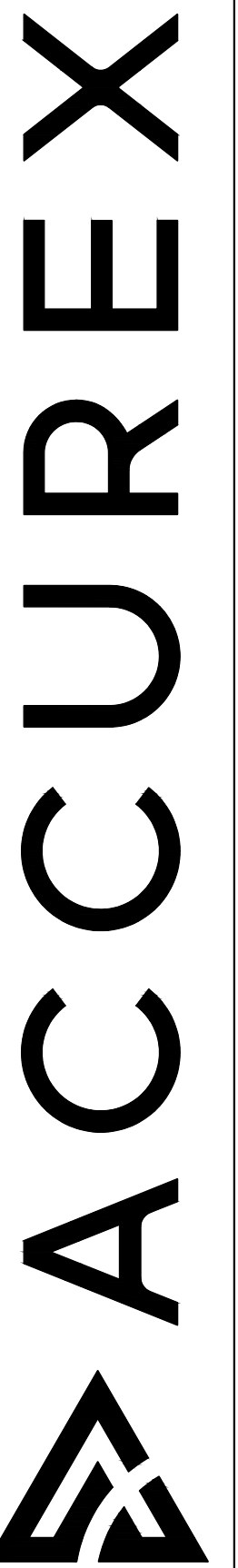

SUPPLY PLENUM INFORMATION

QTY	MARK	POS.	TYPE	SIZE (IN.)			INSULATED	DAMPER(S)	LED LIGHT(S)		TOTAL CFM	COLLARS								
				L	W	H			SUPPLIED	QTY		TYPE	MOUNTING	QTY	W	L	DIA.	CFM	S.P.	VEL.
1	SP-2 RIGHT (ITEM 7)	FRONT	ASP	120	14	10	NO	YES	NO		1980	MUA	LOOSE	3	10	26		660	0.18	366

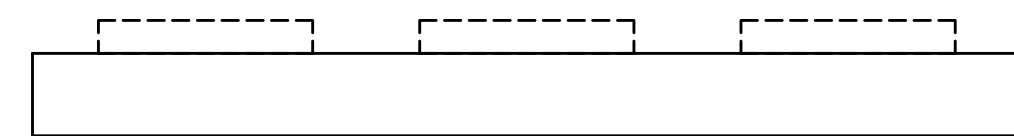
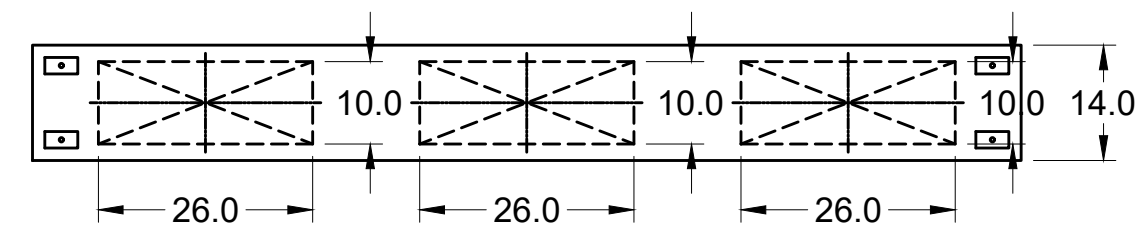
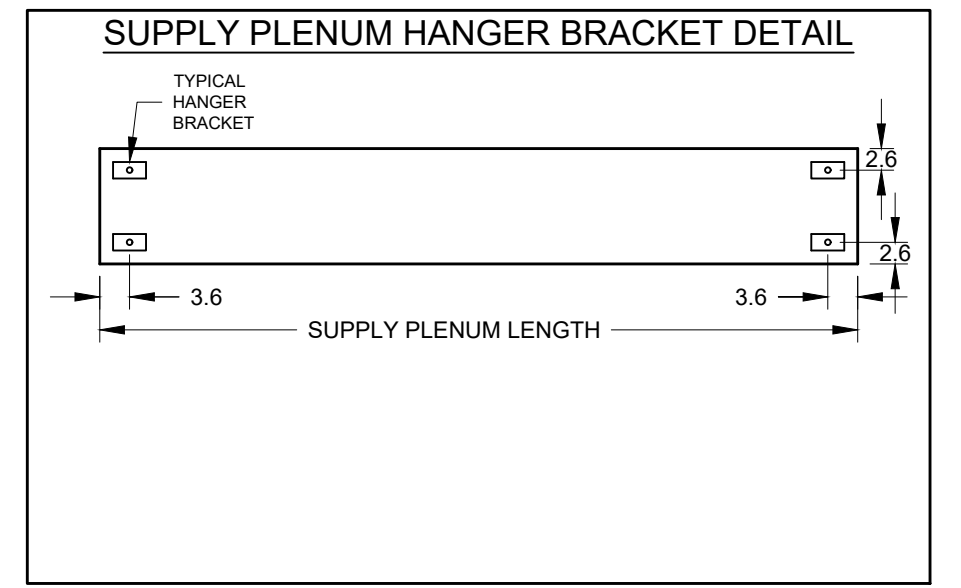

MARK: SP-2 Right (Item 7)

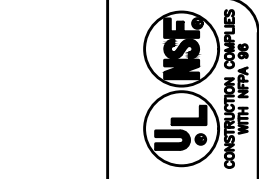
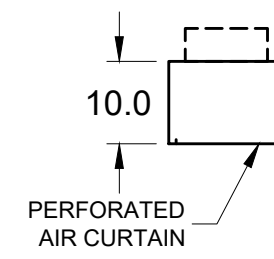

OSHKOSH CORRECTIONAL

PROJECT
11/30/2021

MARK

SP-2 RIGHT (ITEM 7)

ACCUREX W/IA
PHILLIP KRAFT
PHILLIP.KRAFT@ACCUREX.COM
(262)227-7865

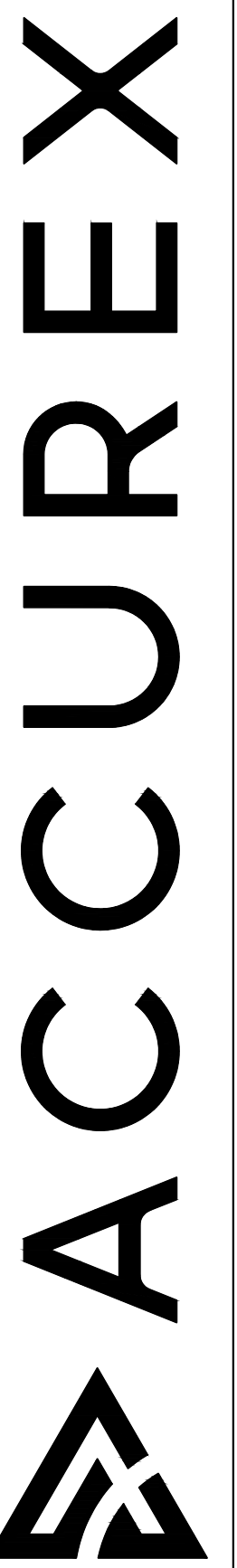

CONTROL INFORMATION

MARK	ELECTRICAL CONTROL PACKAGE		USER INTERFACE		FANS CONTROLLED											
	MODEL	LOCATION	TYPE	LOCATION	FAN #	TYPE	FAN	FAN MARK	ZONE	CFM	MOTOR HP	MOTOR VOLT	CYCLE	MOTOR PHASE	MOTOR STARTER IN PANEL	VFD IN PANEL
CTRLS-2 (ITEM 26)	XKC-CV-S-11-1-1-0	SHIP LOOSE ENCLOSURE	FULL COLOR TOUCHSCREEN	SHIP LOOSE	1	EXHAUST	E1	EF	1	3300	2	208	60	3	NO	NO
					2	SUPPLY	S1	MAU	1	3300	3	208	60	3	NO	NO

CONTROL FEATURES
 HOOD LIGHT CONTROL
 TEMP SENSORS (FACTORY INSTALLED) - QTY. 1
 DRY FIRE CONTACTS - QTY. 1
 LIGHTS OFF DURING FIRE
 EXHAUST MAX DURING FIRE
 SUPPLY OFF DURING FIRE



DOC NUMBER: #### REV: ####

CAUTION
UNIT MUST BE GROUNDED IN ACCORDANCE WITH N.E.C. POWER MUST BE OFF WHILE SERVICING.

ATTENTION
L'APPAREIL DOIT ÊTRE MIS À LA TERRE CONFORMÉMENT AU CODE C.E. L'ALIMENTATION DOIT ÊTRE COUPÉE DURANT L'ENTRETIEN.

COMMERCIAL APPLIANCE OUTLET CENTER
 ELECTRICAL RATINGS: 110-240V, 1PHASE, 50-60HZ, 15A
 BASE FILE #E200616, ML FILE #E313951

THESE DRAWINGS SHALL NOT BE REMOVED FROM THIS EQUIPMENT. USE COPPER CONDUCTORS RATED TO 90°C UNLESS SPECIFIED. TORQUE CONTROL & GROUND BLOCKS TO 8 LBS. IN. TORQUE POWER LUGS/SCREWS TO COMPONENT RATINGS LISTED. TORQUE CONTROL BOARD SCREW TERMINALS TO 3.5 LBS. IN. FIELD CONTROL WIRING RESISTANCE SHOULD NOT EXCEED 0.75 OHM. SEE IOM FOR ADDITIONAL INFORMATION, OR CALL FACTORY AT 1-800-371-6858.

NE PAS RETIRER CES DESSINS DE CET ÉQUIPEMENT. SAUF INDICATION CONTRAIRE, UTILISER DES CONDUCTEURS EN CUIVRE CLASSÉS 90 °C. SERRER LES BORNES DE COMMANDE ET DE MISE À LA TERRE À 8 LB-PO. SERRER LES COSSÉS/VIS D'ALIMENTATION AUX COUPLES INDICQUÉS POUR LE COMPOSANT. SERRER LES BORNES À VIS DE LA CARTE DE COMMANDE À 3,5 LB-PO. LA RÉSISTANCE DU CÂBLAGE DE COMMANDE LOCAL NE DOIT PAS DÉPASSER 0,75 OHM. POUR PLUS D'INFORMATION, CONSULTER LE MANUEL OU APPELER 1-800-371-6858.

WIRING DIAGRAM CODE: ####
 JOB NAME: OSHKOSH CORRECTIONAL
 MODEL: XKC-CV-S-11-1-1-0
 SERIAL NUMBER: WDSN#
 MARK: CTRLS-2 (ITEM 26)

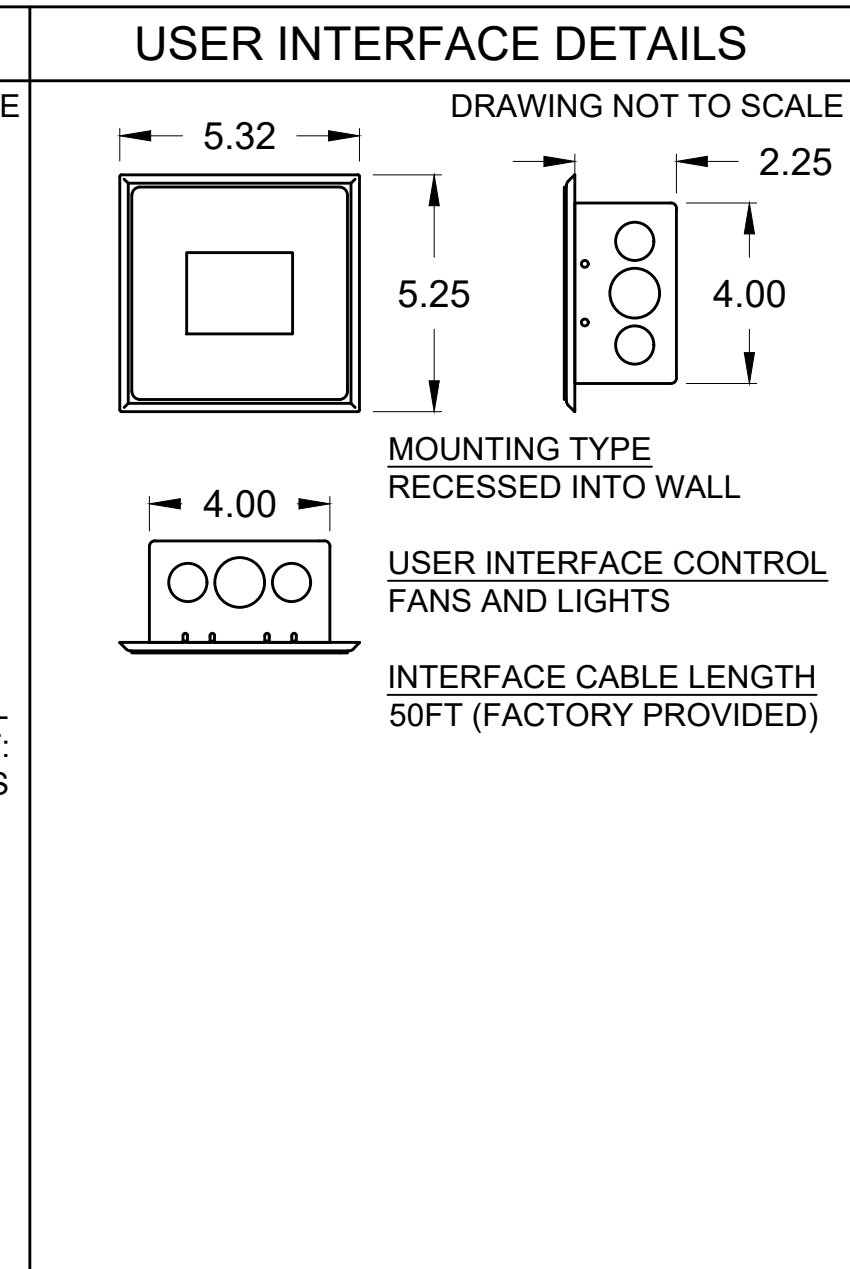
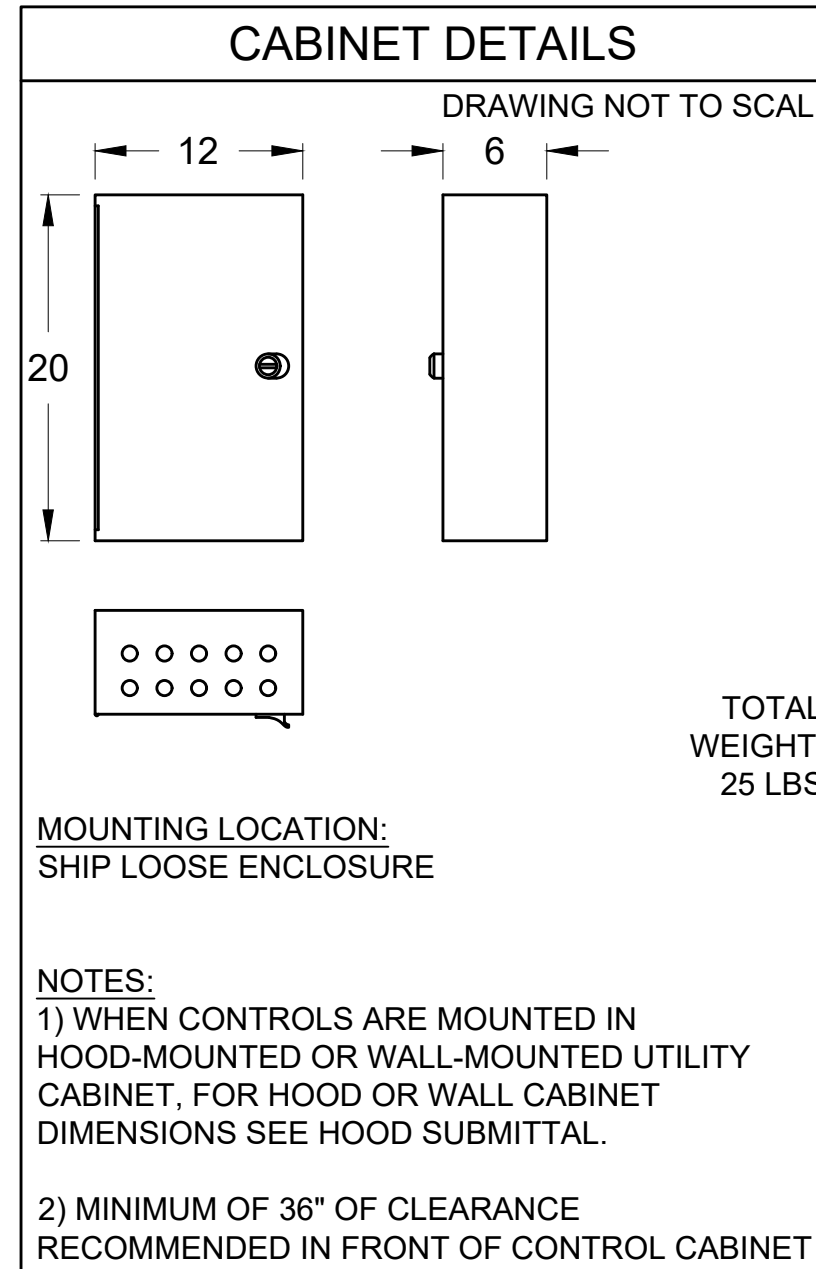
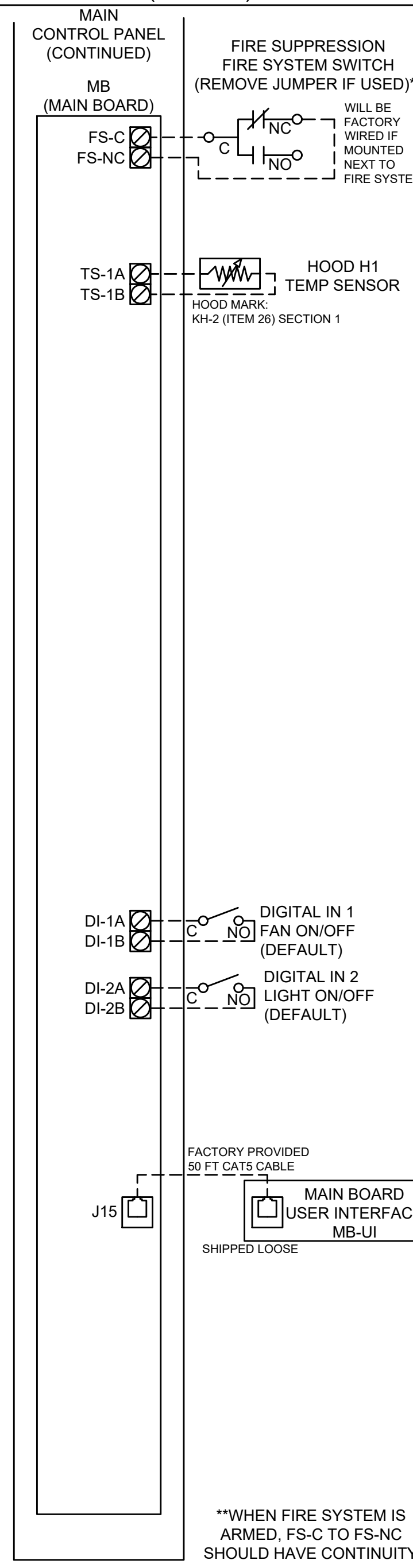
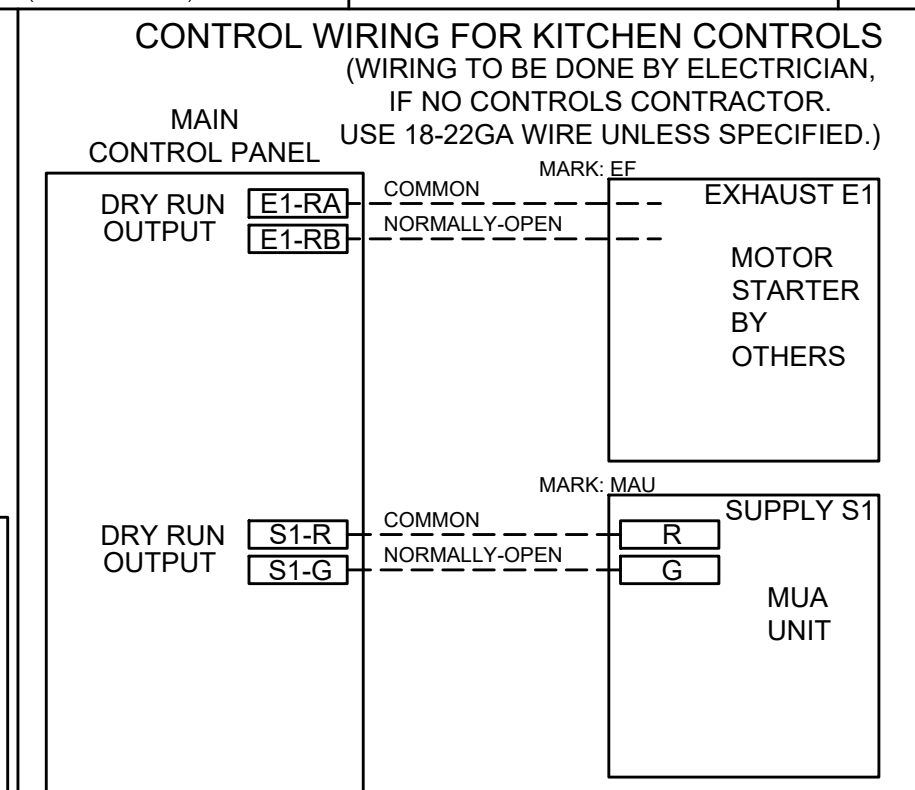
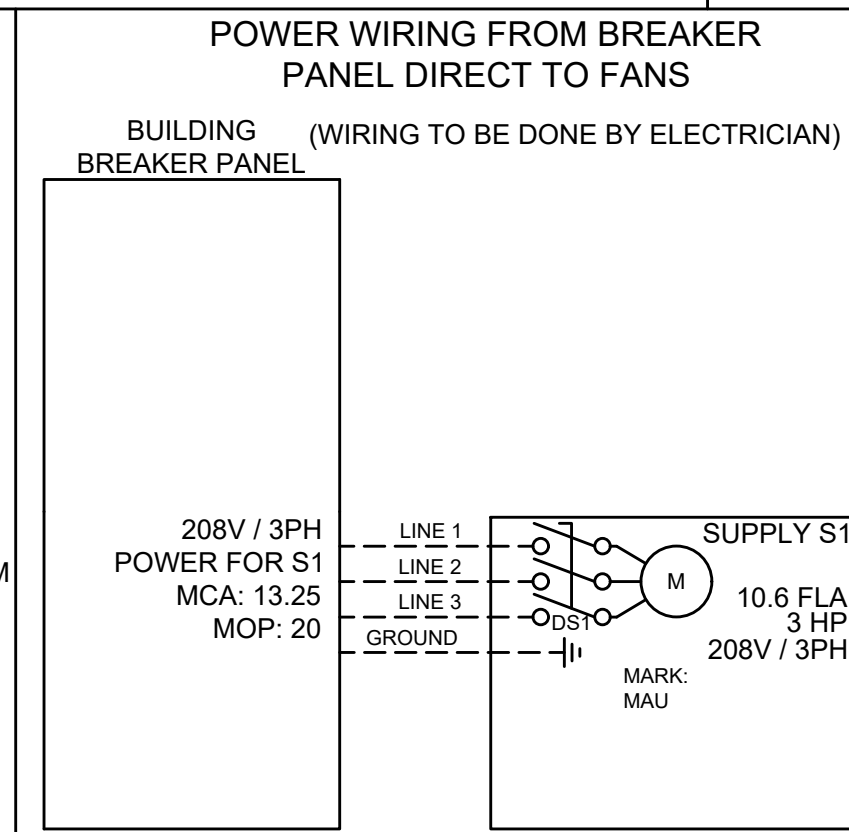
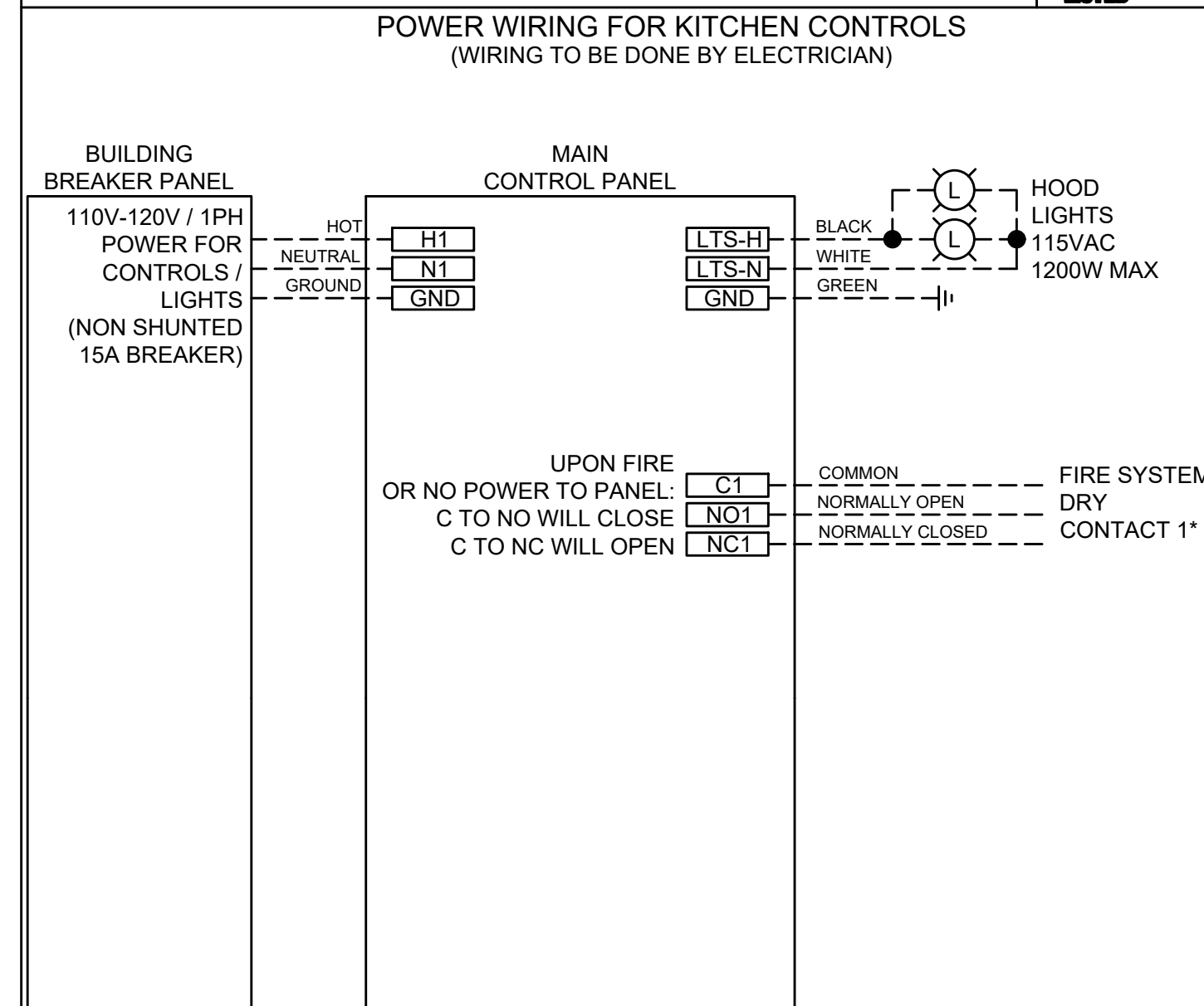

ZONE CONFIGURATION							WIRING DIAGRAM CODE: ####									
ZONE #	ZONE	ROOM TEMP					JOB NAME: OSHKOSH CORRECTIONAL									
1	Z1	PRESET					MODEL: XKC-CV-S-11-1-1-0									
							SERIAL NUMBER: WDSN#									
							MARK: CTRLS-2 (ITEM 26)									
							DOC NUMBER: #### REV: ####									
HOOD CONFIGURATION																
HOOD #	HOOD	HOOD MARK	ZONE	EXHAUST	SUPPLY	MB-TEMP SENSORS	HC	FACTORY SETTINGS / PARAMÈTRES PAR DÉFAUT								
1	H1	KH-2 (ITEM 26) SECTION 1	Z1	E1	S1	TS1	NO	TYPE: CV CONFIGURATION: STANDARD ZONES: 1 HOODS: 1 SUMPS: 0 EXHAUST FANS: 1 SUPPLY FANS: 1 MB ROOM SENSOR: NO MB TEMP SENSORS: 1 HIGH TEMP FAULT: NO FREEZE PROTECTION: YES GAS RESET: NO FAN PROVING: NO BMS: NONE ZONE SETTINGS SEE ZONE CONFIGURATION IN TABLE ON LEFT HOOD SETTINGS SEE HOOD CONFIGURATION IN TABLE ON LEFT EXHAUST FAN SETTINGS SEE FAN CONFIGURATION IN TABLE ON LEFT SUPPLY FAN SETTINGS SEE FAN CONFIGURATION IN TABLE ON LEFT SENSOR SETTINGS SEE HOOD CONFIGURATION IN TABLE ON LEFT USER INTERFACE SETTINGS (MB) FAN & LIGHT BUTTONS: SHOW BOTH (SEPERATE) USER INTERFACE SETTINGS (HCB) NA GENERAL SETTINGS TIME ZONE: CENTRAL DAYLIGHT (DEFAULT) FIRE/FAULT SETTINGS EXHAUST DURING FIRE: MAX SUPPLY DURING FIRE: OFF LIGHTS DURING FIRE: OFF BMS SETTINGS NA								
FAN CONFIGURATION																
FAN #	TYPE	FAN	FAN MARK	ZONE	MIN CFM	MAX CFM	MODBUS VFD	VFD ADDRESS	MIN FREQ.	MAX FREQ.	MIN VDC	MAX VDC				
1	EXHAUST	E1	EF	Z1	-	3300	NO	-	-	-	-	10.0				
2	SUPPLY	S1	MAU	Z1	-	3300	NO	-	-	-	-	10.0				

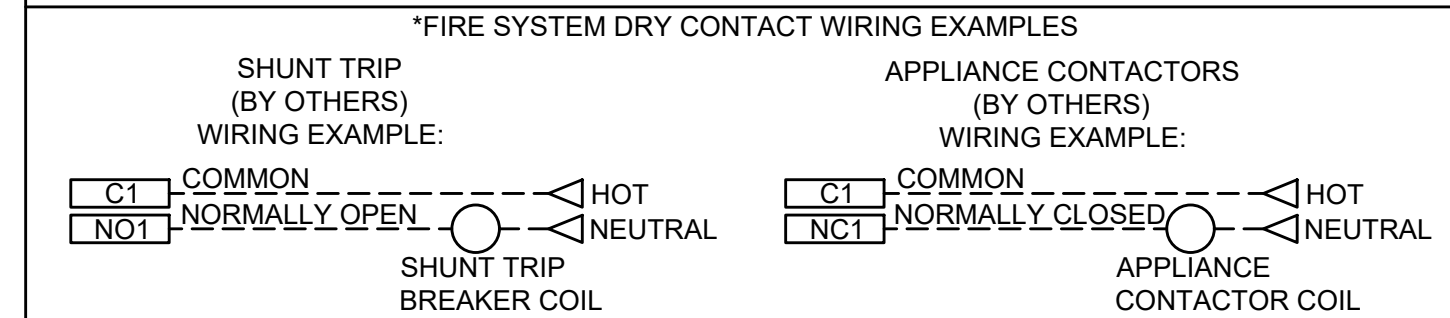

OSHKOSH CORRECTIONAL
 CTRLS-2 (ITEM 26)

PROJECT: 11/30/2021
 MARK: ACCUREX W I A
 PHILLIP KRAFT
 PHILLIP.KRAFT@ACCUREX.COM
 (262)227-7865

ACCUREX

FIRE SYSTEM INFORMATION

MARK	MODEL	LOCATION	FLOW POINTS		SUPPLY LINE	DETECTION	MARK(S) PROTECTED BY FIRE SYSTEM
			HOODS	PCU			
FSS-2 (ITEM 26)	ANSUL R-102 WET CHEMICAL	RIGHT END PRE-PIPE ONLY	4 UTILIZED 11 AVAILABLE		CONTINUOUS	FUSIBLE LINK	KH-2 (ITEM 26) SECTION 1

FIRE SYSTEM OPTIONS AND ACCESSORIES

PRE-PIPE ONLY (INCLUDES PRE-PIPED HOOD(S) WITH DETECTION ONLY)
 CHROME SLEEVES FOR FACTORY PROVIDED APPLIANCES DROPS - INCLUDED
 METAL BLOW-OFF CAPS - INCLUDED

ANSUL R102 (WET CHEMICAL) FIRE PROTECTION SYSTEM - MODEL FSSC

CONTROL PANEL

1. STAINLESS STEEL ENCLOSURE
2. AGENT STORAGE TANK
3. EXPELLENT GAS CARTRIDGE
4. ANSUL AUTOMAN RELEASE
5. RESISTOR
6. KNOCKOUT FOR WIRING MICROSWITCH

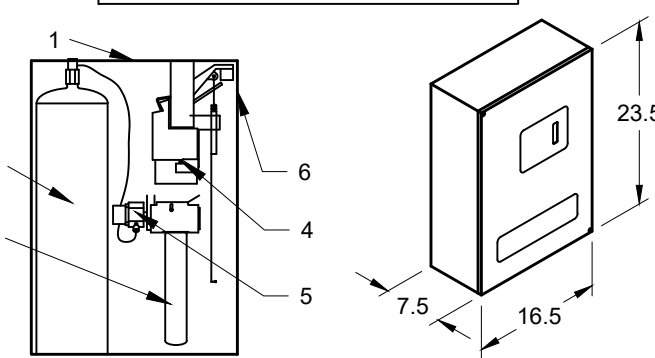

NOT TO SCALE

NOTES:

WET CHEMICAL FIRE PROTECTION SYSTEM TO BE ANSUL R-102, DESIGNED IN COMPLIANCE WITH UL 300 REQUIREMENTS.
 -VERIFICATION OF ALL COOKING EQUIPMENT MAKE, MODEL AND LOCATION REQUIRED FOR ALL FIRE PROTECTION SYSTEMS.
 -ALL FIRE SYSTEM PIPING IS STANDARDLY TO THE RIGHT END OF THE HOOD UNLESS A WALL IS LOCATED ON THE RIGHT END.
 -ANSUL AUTOMAN RELEASE TO BE LOCATED WITHIN 60" OF HOOD.

THE BASIC FIRE SYSTEM WILL INCLUDE THE FOLLOWING:
 -GAS SHUT-OFF VALVE, IF REQUIRED, TO BE SUPPLIED BY MANUFACTURER (UP TO 2" DIAMETER AS STANDARD), AND INSTALLED BY A LICENSED PLUMBER.
 -MICRO SWITCH TO BE SUPPLIED BY MANUFACTURER FOR CONNECTION TO, BUT NOT LIMITED TO, BUILDING ALARM SYSTEM(S), EXHAUST AND SUPPLY FANS AND ELECTRICAL POWER SHUT DOWN. FIELD WIRING AND CONNECTIONS TO BE PERFORMED BY A LICENSED ELECTRICIAN.

THE BASIC FIRE SYSTEM DOES NOT INCLUDE THE FOLLOWING:
 -FULL DUMP TEST OTHER THAN WHAT IS SPECIFIED PER THE INSTALLATION MANUAL, OR TO SATISFY A STATE OR LOCAL CODE. PERMIT AND TESTING FEES ARE NOT INCLUDED UNLESS NOTED UNDER THE EQUIPMENT SCHEDULE FOR THE FIRE SYSTEM.

-MORE THAN TWO TRIPS TO THE JOBSITE OR SPECIAL TRANSPORTATION, OR OVERNIGHT LODGING REQUIREMENTS IN REMOTE AREAS. NORMAL TRAVEL DISTANCE IS FIRST 50 MI. (80.5 KM) FROM OFFICE.

-SPECIAL CLASSES OR ADDITIONAL LABOR FOR ACCESS TO SECURITY SENSITIVE AREAS.

-INSTALLATION OF GAS SHUT-OFF VALVE.

-SPECIAL DRAWINGS REQUIRED TO SATISFY STATE OR LOCAL CODE. PLAN EXAMINATION FEES, PE OR FS APPROVAL STAMP.

-UNION LABOR, GOVERNMENT LABOR, OR PREVAILING WAGES REQUIRED FOR FINAL FIELD HOOK-UP.

-ANY AND ALL ELECTRICAL COMPONENTS/CONNECTIONS REQUIRED TO SHUT DOWN FANS, SHUT OFF DEVICE FOR ELECTRIC COOKING EQUIPMENT (SHUNT TRIP BREAKER), OR ACTIVATE AN ALARM SYSTEM, ETC.

-ANY DISMANTLING OR REASSEMBLY REQUIRED TO GAIN ACCESS TO THE FIRE SUPPRESSION PIPING LOCATED ON THE TOP OF THE HOOD.

-ROUGH-IN HIDDEN CONDUIT FOR REMOTE PULL STATION OR GAS VALVE (FLUSH MOUNTED PULL STATION).

-INSTALLATION OF MORE THAN (1) REMOTE PULL STATIONS OR DISTANCES GREATER THAN 20 FT (6.1M.)

-PARTS OR LABOR REQUIRED TO CORRECT PIPING DUE TO COOKING EQUIPMENT CHANGES OR DEVIATION FROM PLANS, OR ANY CHARGES FOR MISSING OR ADDITIONAL PARTS OTHER THEN THOSE INDICATED ON THE FIRE SUPPRESSION DETAIL.

WIRING DIAGRAMS W/DPDT MICRO SWITCH

DPDT SWITCHES PROVIDED BY MANUFACTURER MAY BE WIRED PER TYPICAL EXAMPLES SHOWN. VERIFY WITH LOCAL CODES AND EQUIPMENT SUPPLIED AS THE CONNECTION NEEDED FOR YOUR INSTALLATION.

CONNECTION TO BUILDINGS ALARM

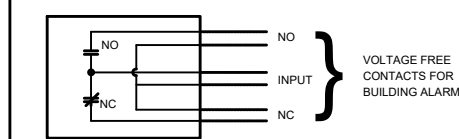

CONNECTION TO COOKING EQUIPMENT SHUT DOWN

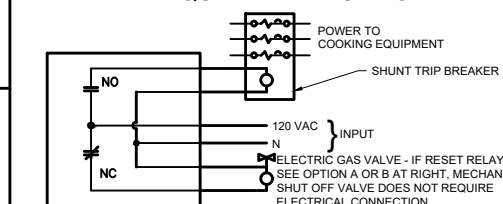

CONNECTION TO FAN SHUT DOWN

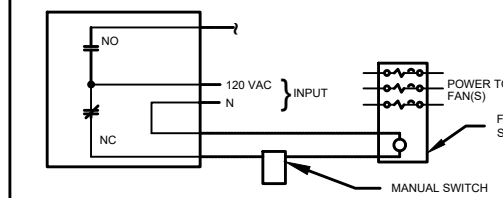

NOTES:

1. DENOTES FIELD INSTALLATION.
2. DENOTES FACTORY INSTALLATION.
3. DO NOT USE BLACK WIRE ON SNAP-ACTION SWITCH IN NORMAL INSTALLATION. BLACK WIRE TO BE USED ONLY FOR EXTRANEOUS ALARM, LIGHT CIRCUITS, ETC.

PROJECT

11/30/2021

MARK

ACCUREX W/IA
 PHILLIP KRAFT
 PHILLIP.KRAFT@ACCUREX.COM
 (262)227-7865

ACCUREX

OSHKOSH CORRECTIONAL

FSS-2 (ITEM 26)

