

Z:\Project Directories\7700-7799\7785-Avri-11 E Court St & 915-917 Vme\Construction Documents\REF - Avri & Bleh\7785-M1-0-MECHANICAL-FLOOR-PLAN.dwg - BS: Plot Date/Time: May 19, 2021 - 3:42pm - By: brandon.olson  
 THESE DRAWINGS AND SPECIFICATIONS ARE NOT AUTHORIZED TO BE USED AS CONTRACT DOCUMENTS. THESE DRAWINGS HAVE BEEN PREPARED TO DEMONSTRATE COMPLIANCE WITH APPLICABLE CODES, AND ARE INTENDED TO PROVIDE THE AUTHORITIES HAVING JURISDICTION WITH INFORMATION TO DETERMINE CODE COMPLIANCE. THE INSTALLING CONTRACTOR IS RESPONSIBLE TO ENSURE THAT MEANS, METHODS, AND MATERIALS USED IN CONSTRUCTION ARE INSTALLED IN ACCORDANCE WITH ANY CONTRACTUAL AGREEMENT THAT MAY EXIST WITH AN OWNER, CONSTRUCTION MANAGER, GENERAL CONTRACTOR, ETC.

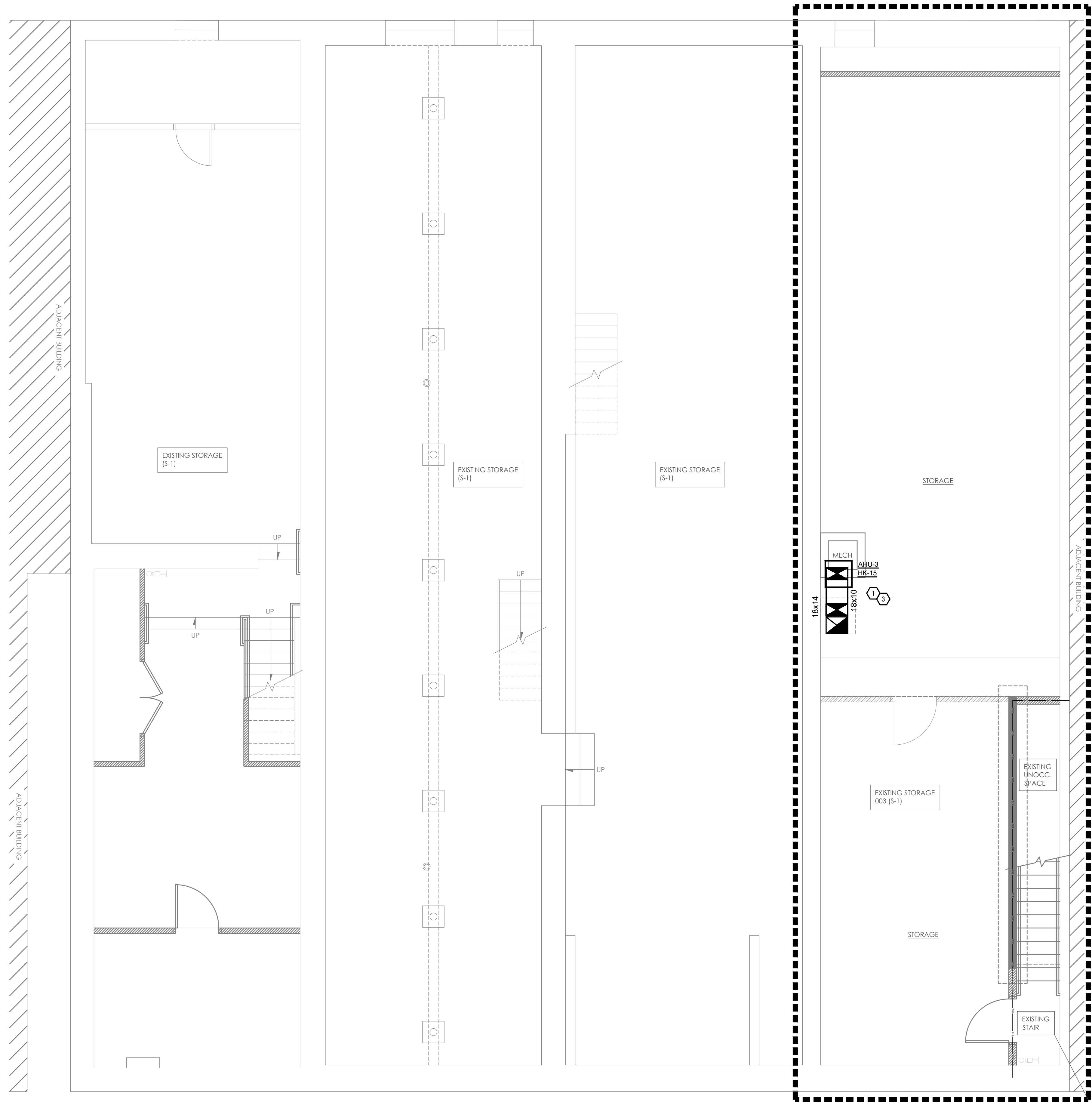

### # KEYED SHEET NOTES

- PROVIDE CONDENSATE PUMP HARDWIRED TO UNIT. PUMP CONDENSATE TO MOP SINK LOCATED IN ACCESSIBLE RESTROOM.
- ROUTE EXHAUST TO EXTERIOR WALL. INSTALL A HOODED VENT EQUAL TO FAMCO MODEL SDWVP. SEE ARCHITECT BEFORE PENETRATION FOR EXACT LOCATION AND COLOR COORDINATION. ALL EXHAUST SHALL MEET THE FOLLOWING REQUIREMENTS.
  - 3' FROM PROPERTY LINE.
  - 3' FROM OPERABLE OPENINGS INTO BUILDING.
  - 10' FROM MECHANICAL AIR INTAKE
- ROUTE LINE SET FROM OUTDOOR UNIT TO INDOOR AIR HANDLER. ALL PIPING SHALL BE CONCEALED IN FINISHED AREA. SIZE PER MANUFACTURER'S RECOMMENDATIONS.
- CURRENT EXISTING HEAT PUMP UNIT TO BE REPLACED WITH NEW HEAT PUMP UNIT.
- ALL EXPOSED DUCTWORK TO BE SPIRAL DUCT, DOUBLE WALL INSULATED MINIMUM R-3.5. HUNG TIGHT TO STRUCTURE ABOVE. MOUNT SPIRAL DUCT DIFFUSER AT A 45 DEGREE ANGLE DOWN TOWARDS THE FLOOR.
- 10"Ø FRESH AIR INTAKE THRU WALL TO WALL CAP, INSTALL A HOODED VENT EQUAL TO FAMCO MODEL SWVP.
- PROVIDE 1" INTERNALLY LINED RETURN DUCT FOR SOUND REDUCTION.
- CONNECT TO EXISTING RETURN DUCT MAIN.
- CONNECT TO EXISTING SUPPLY DUCT MAIN.
- EXISTING HVAC EQUIPMENT TO REMAIN. BALANCE TO NEW AIRFLOWS LISTED IN SCHEDULE.
- KITCHEN HOOD EXHAUST AND MAKE UP AIR DUCTWORK DONE BY OTHERS, UNDER SEPERATE PERMIT.
- KITCHEN HOOD EQUIPMENT SHOWN FOR REFERENCE ONLY.
- FIRE DAMPER NOT REQUIRED PER OBC 713.11
  - EXCEPTION 1. THE FIRE-RESISTANCE-RATED ROOM SEPARATION IS NOT REQUIRED, PROVIDED THERE ARE NO OPENINGS IN OR PENETRATIONS OF THE SHAFT ENCLOSURE TO THE INTERIOR OF THE BUILDING EXCEPT AT THE BOTTOM. THE BOTTOM OF THE SHAFT SHALL BE CLOSED OFF AROUND THE PENETRATING ITEMS WITH MATERIALS PERMITTED BY SECTION 718.3.1 FOR DRAFTSTOPPING, OR THE ROOM SHALL BE PROVIDED WITH AN APPROVED AUTOMATIC SPRINKLER SYSTEM.
  - EXCEPTION 3. THE FIRE-RESISTANCE-RATED ROOM SEPARATION AND THE PROTECTION AT THE BOTTOM OF THE SHAFT ARE NOT REQUIRED PROVIDED THERE ARE NO COMBUSTIBLES IN THE SHAFT AND THERE ARE NO OPENINGS OR OTHER PENETRATIONS THROUGH THE SHAFT ENCLOSURE TO THE INTERIOR OF THE BUILDING.
- UNDERCUT DOOR 1" FOR RETURN AIR.

AREA OF WORK. NO WORK PROPOSED AT OTHER AREAS SHOWN.

### MECHANICAL SCOPE OF WORK

PROVIDE HVAC ALTERATIONS FOR RENOVATION AND EXPANSION OF EXISTING COMMERCIAL SPACE.

### CODES REFERENCED

- 2017 OHIO MECHANICAL CODE
- 2017 OHIO BUILDING CODE
- ASHRAE 90.1-2010

### HVAC DESIGN CONDITIONS

COOLING OUTDOOR: 93 DB / 75 WB INDOOR: 72	HEATING OUTDOOR: 0 DB INDOOR: 70
---	--

### GENERAL NOTES

- FOR FULL SCHEDULES, SPECIFICATIONS, AND COMPLETE LISTING SEE DETAIL SHEETS.
- COORDINATE ROUTING OF ALL WORK WITH OTHER TRADES.
- COORDINATE WITH ELECTRICAL CONTRACTOR FOR POWER CONNECTIONS TO ALL MECHANICAL EQUIPMENT.
- INSTALL ALL EQUIPMENT PER MANUFACTURER'S REQUIREMENTS. MAINTAIN ALL CODE RECOMMENDED CLEARANCES FOR ACCESS AND MAINTENANCE.
- REFER TO ARCHITECTURAL PLANS FOR DIMENSIONS, AND FINAL CEILING DIFFUSER LOCATIONS.
- MAINTAIN ALL CODE REQUIRED SERVICE CLEARANCES. FOLLOW CLEARANCE TO COMBUSTIBLE DISTANCE PER MANUFACTURER'S INSTRUCTIONS.
- PROVIDE BACKDRAFT DAMPERS FOR ALL EXHAUST SYSTEMS AND EITHER LOUVER, BRICK VENT, OR CAPS AT ALL EXTERIOR BUILDING PENETRATIONS.
- ANY EQUIPMENT THAT IS SUBSTITUTED SHALL FIT IN THE SPACE PROVIDED WITH ADEQUATE ROOM FOR SERVICING, INCLUDING SUBSTITUTE EQUIPMENT NAMED IN THE SPECIFICATIONS. SUBMIT A 1/4" SCALE DRAWING OF ALL EQUIPMENT SUBSTITUTED FOR APPROVAL PRIOR TO INSTALLATION, INCLUDING, BUT NOT LIMITED TO, STRUCTURAL AND ARCHITECTURAL IMPACT, CLEARANCE REQUIREMENTS AND UTILITY REQUIREMENTS. IT IS THE RESPONSIBILITY OF THE MECHANICAL CONTRACTOR TO COORDINATE ALL NEW ELECTRICAL AND PLUMBING REQUIREMENTS WITH THE ELECTRICAL AND PLUMBING CONTRACTORS.
- PROVIDE ALL NECESSARY MODIFICATIONS TO CONTROL WIRING, ETC. TO RELOCATE EXISTING MECHANICAL EQUIPMENT TO NEW LOCATIONS SHOWN.
- HOOD AND FANS ARE SUPPLIED AND INSTALLED BY FOOD SERVICE CONTRACTOR, PERMITTED SEPARATELY. ALL HOOD AND HOOD MAKE UP AIR DRAWINGS ARE FOR REFERENCE AND REQUIREMENTS FOR OTHER TRADES.
- MAINTAIN CODE REQUIRED CLEARANCE TO COMBUSTIBLES FOR ALL GAS-FIRED EQUIPMENT.

### SYMBOLS LEGEND - HVAC

⊕	THERMOSTAT
⊗	CEILING DIFFUSER
→	SIDE WALL GRILL
←	RETURN WALL GRILL
↔	AIR FLOW DIRECTION
14x10	DUCTWORK
⊗	TYPICAL SUPPLY DUCT DN
⊗	TYPICAL RETURN DUCT DN
⊗	TYPICAL EXHAUST DUCT
⊗	TURNING VANES
⊗	FLEXIBLE DUCT, 8'-0" LONG MAX.
⊗	TYPICAL ROUND DUCT DN
⊗	ROUND DUCT UP
⊗	MVD MANUAL VOLUME DAMPER
⊗	DROPPED CEILING/SOFFIT
⊕	CONNECTION POINT



**CITYSTUDIOS**  
ARCHITECTURE  
1148 Main Street  
Cincinnati, OH 45202  
ph. 513.421.0750  
citystudiosarch.com

**Structural Consultants**  
**ADVANTAGE GROUP**  
ENGINEERS, INC.

1527 Madison Road  
Cincinnati, OH 45206  
p: 513.396.8900

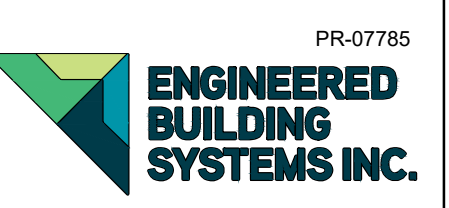

PR-07785  
**ENGINEERED BUILDING SYSTEMS INC.**  
TEAMWORK • COLLABORATION  
SHARED SUCCESS  
515 Monmouth Street, Suite 204  
Newport, KY 41071 (859) 251-0585  
MEP Consulting Services, Inc. in OH  
Copyright © 2015

THIS DOCUMENT IS THE PRODUCT AND EXCLUSIVE PROPERTY OF ENGINEERED BUILDING SYSTEMS, INC. NEITHER THE DOCUMENT NOR THE INFORMATION IT CONTAINS MAY BE USED FOR OTHER THAN THE SPECIFIC PURPOSE FOR WHICH IT WAS PREPARED WITHOUT WRITTEN CONSENT OF ENGINEERED BUILDING SYSTEMS, INC.

Avril-Bleh Meat Market  
Expansion / Renovation  
35-37 E. Court St  
Cincinnati, OH 45202



DATE: PERMIT / BID SET  
02.26.21  
PERMIT REVISIONS  
05.21.21

MECHANICAL BASEMENT PLAN

M1.0