

HOOD INFORMATION																	
HOOD NO.	MARK	MODEL	HOOD DIMENSIONS (IN.)			HOOD CONSTR.	COOKING LOAD / DUTY RATING	EXHAUST					SUPPLY		TOTAL WEIGHT LBS.	SECTION LOCATION	
			LENGTH	WIDTH	HEIGHT			TOTAL CFM	COLLAR(S)			MUA CFM	AC CFM				
								WIDTH	LENGTH	DIA.	CFM	S.P.					
1	HOOD 1	XXEW-120-S	120	66	24	300 SS 100%	HEAVY	2250	9	22		2250	0.585	2025		350.863	SINGLE

HOOD INFORMATION														
HOOD NO.	MARK	LIGHTING DETAILS				GREASE FILTRATION DETAILS				UTILITY CABINET(S)				
		FIXTURE TYPE BULB / LAMP INFO	QTY	FOOT CANDLES		TYPE / MODEL MATERIAL	QTY	SIZE (IN.) L H	LOCATION	FIRE SYSTEM		CONTROLS		
										TYPE	SIZE	MODEL	INTERFACE	
1	HOOD 1	ROUND LED	2	61.06		X-TRACTOR STAINLESS STEEL	0	16 20	20	RIGHT	ANSUL R102	3	XKC	TOUCHSCREEN

SUPPLY PLENUM INFORMATION																				
HOOD NO.	MARK	POS.	TYPE	SIZE (IN.)			INSULATED	DAMPER(S)	LED LIGHT(S)		TOTAL CFM	COLLARS								
				L	W	H			SUPPLIED	QTY		TYPE	MOUNTING	QTY	W	L	DIA.	CFM	S.P.	VEL.
1	HOOD 1	FRONT	ASP	132	18	4	YES	YES	NO		2025	MUA	FACTORY	3	16	30		675	0.01	203

**HOOD OPTIONS**

- UL 710 LISTED W/ OUT EXHAUST FIRE DAMPER - UL #R25625
- BACK INTEGRAL AIR SPACE - 3 IN WIDE
- 18 IN HIGH CEILING ENCLOSURES - FRONT LEFT RIGHT - FIELD INSTALLED
- FACTORY MOUNTED EXHAUST COLLAR(S)
- BACKSPLASH 80.00 IN HIGH 132.00 IN LONG
- LEFT SIDESPLASH 120.00 IN HIGH 18.00 IN LONG
- RIGHT SIDESPLASH 120.00 IN HIGH 18.00 IN LONG
- PERFORMANCE ENHANCING LIP (PEL) TECHNOLOGY
- STANDING SEAM CONSTRUCTION FOR SUPERIOR STRENGTH

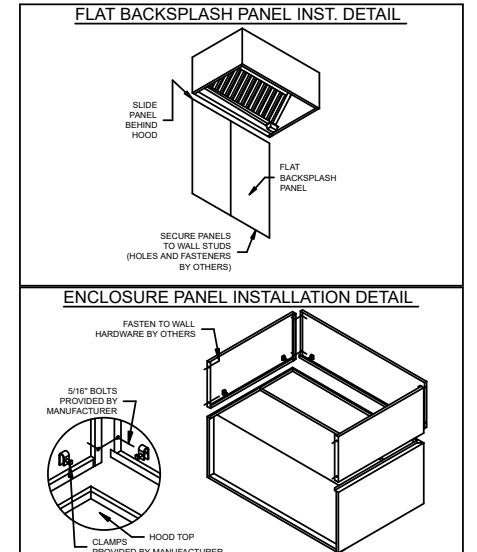
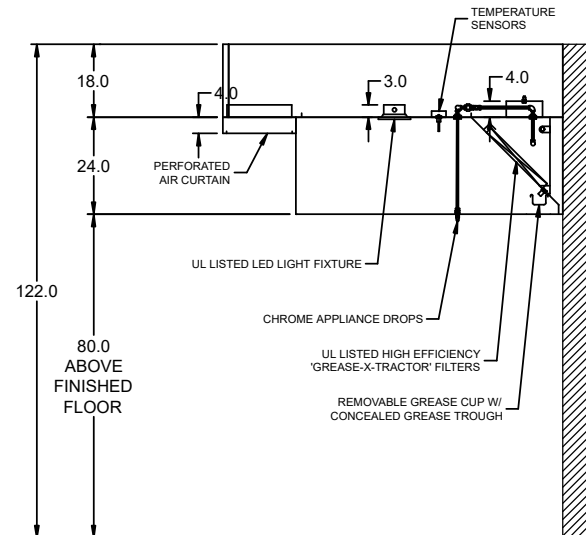
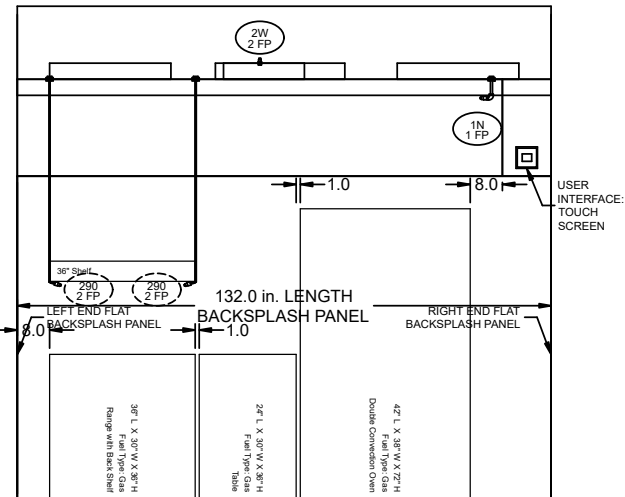
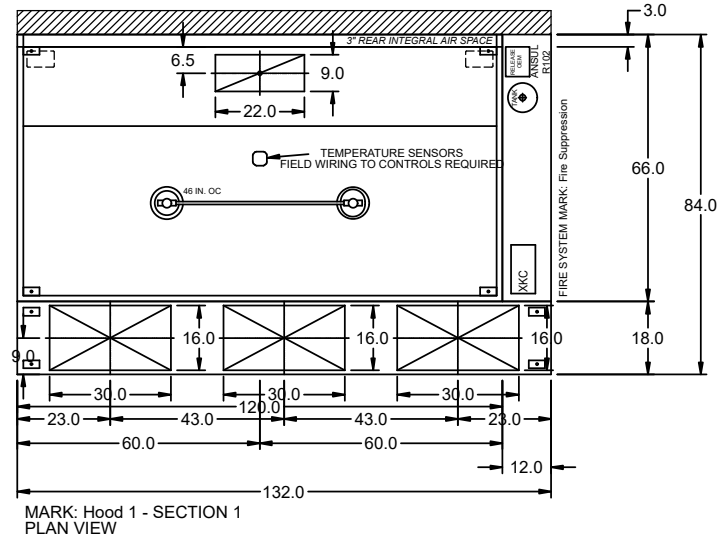

**HOOD HANGING HEIGHT FOR FIRE SYSTEMS**  
 VERIFICATION OF HOOD HANGING HEIGHT ABOVE FINISHED FLOOR (A.F.F.) IS REQUIRED FOR CORRECT PLACEMENT OF FIRE SYSTEM NOZZLES.

- RECOMMENDED HANGING HEIGHT = 80" FROM FINISHED FLOOR TO LOWER FRONT EDGE OF HOOD.
- OTHER HANGING HEIGHT = \_\_\_\_\_" FROM FINISHED FLOOR TO LOWER EDGE OF HOOD.

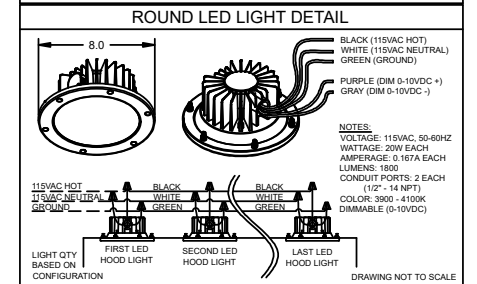
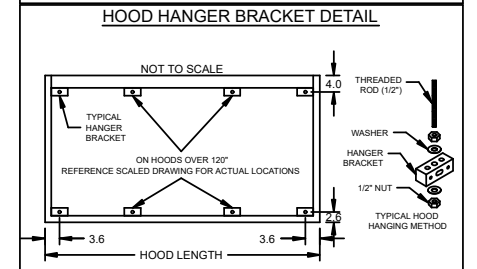
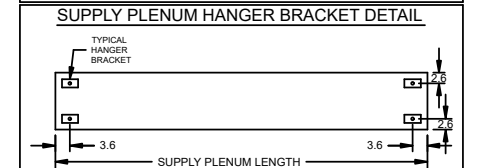

HOOD INFORMATION																	
HOOD NO.	MARK	MODEL	HOOD DIMENSIONS (IN.)			HOOD CONSTR.	COOKING LOAD / DUTY RATING	EXHAUST					SUPPLY		TOTAL WEIGHT LBS.	SECTION LOCATION	
			LENGTH	WIDTH	HEIGHT			TOTAL CFM	COLLAR(S)			MUA CFM	AC CFM				
								WIDTH	LENGTH	DIA.	CFM	S.P.					
1	HOOD 1	XXEW-120-S	120	66	24	300 SS 100%	HEAVY	2250	9	22		2250	0.585			350.863	SINGLE

HOOD INFORMATION													
HOOD NO.	MARK	LIGHTING DETAILS			GREASE FILTRATION DETAILS			UTILITY CABINET(S)					
		FIXTURE TYPE BULB / LAMP INFO	QTY	FOOT CANDLES	TYPE / MODEL MATERIAL	QTY	SIZE (IN.) L H	LOCATION	FIRE SYSTEM		CONTROLS		
									TYPE	SIZE	MODEL	INTERFACE	
1	HOOD 1	ROUND LED	2	61.06	X-TRACTOR STAINLESS STEEL	0 6	16 20	20	RIGHT	ANSUL R102	3	XKC	TOUCHSCREEN

**HOOD OPTIONS**

- UL 710 LISTED W/ OUT EXHAUST FIRE DAMPER - UL #R25625
- BACK INTEGRAL AIR SPACE - 3 IN WIDE
- 18 IN HIGH CEILING ENCLOSURES - FRONT LEFT RIGHT - FIELD INSTALLED
- FACTORY MOUNTED EXHAUST COLLAR(S)
- BACKSPLASH 80.00 IN HIGH 132.00 IN LONG
- LEFT SIDESPLASH 120.00 IN HIGH 18.00 IN LONG
- RIGHT SIDESPLASH 120.00 IN HIGH 18.00 IN LONG
- PERFORMANCE ENHANCING LIP (PEL) TECHNOLOGY
- STANDING SEAM CONSTRUCTION FOR SUPERIOR STRENGTH

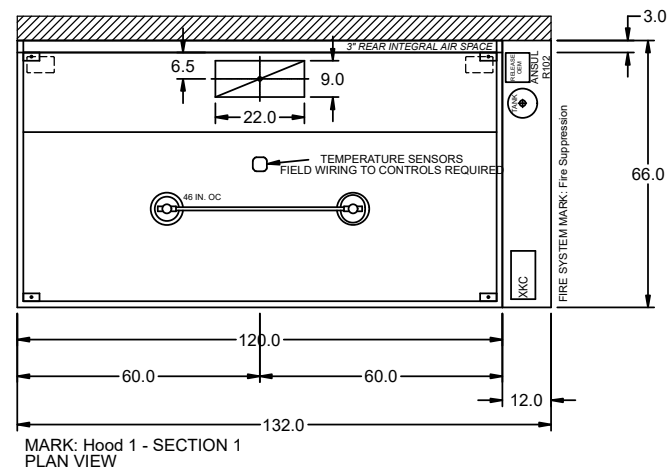

MARK: Hood 1 - SECTION 1 PLAN VIEW

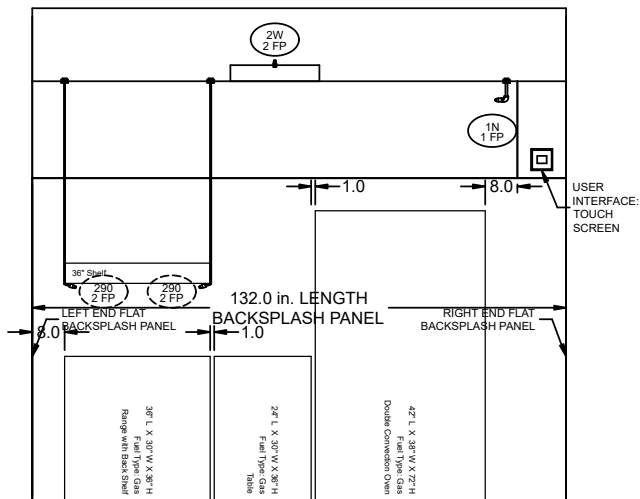

MARK: Hood 1 - SECTION 1 ELEVATION VIEW

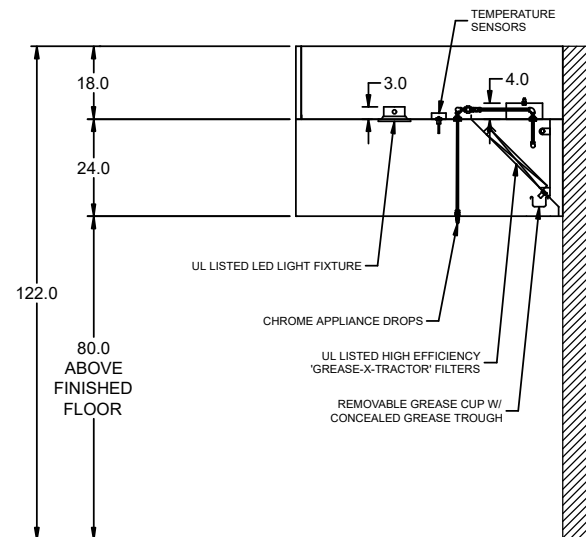

MARK: Hood 1 SECTION VIEW

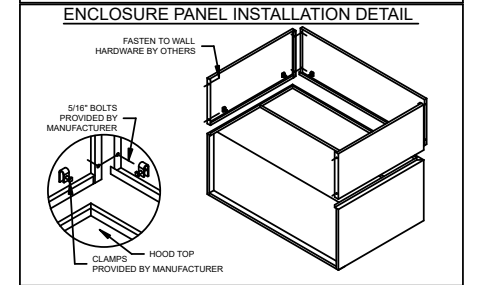
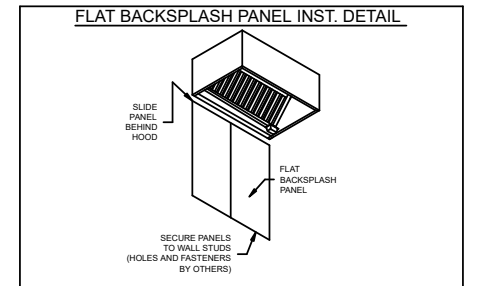

**HOOD HANGING HEIGHT FOR FIRE SYSTEMS**  
 VERIFICATION OF HOOD HANGING HEIGHT ABOVE FINISHED FLOOR (A.F.F.) IS REQUIRED FOR CORRECT PLACEMENT OF FIRE SYSTEM NOZZLES.

- RECOMMENDED HANGING HEIGHT = 80" FROM FINISHED FLOOR TO LOWER FRONT EDGE OF HOOD.
- OTHER HANGING HEIGHT = \_\_\_\_\_" FROM FINISHED FLOOR TO LOWER EDGE OF HOOD.

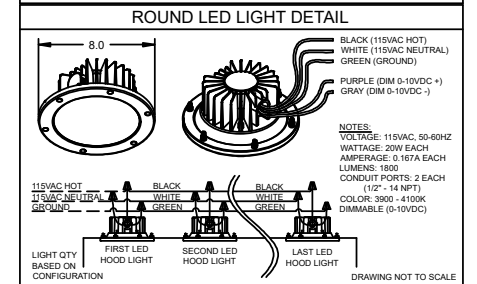
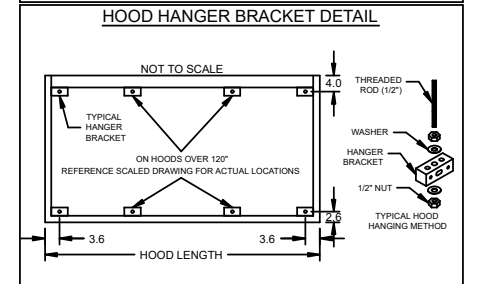

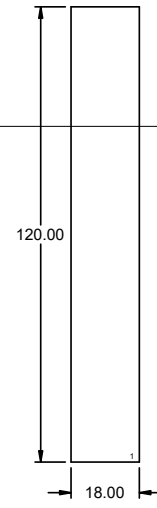

LEFT SIDE SPLASH

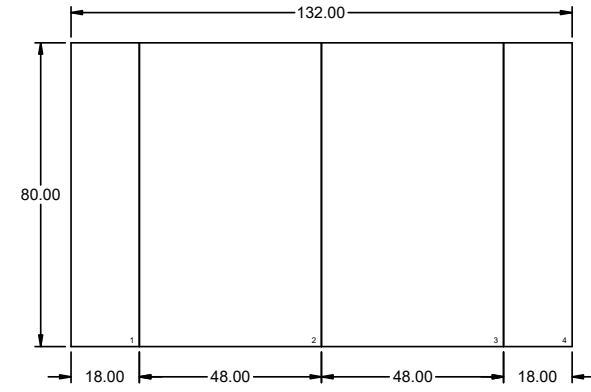

BACK SPLASH

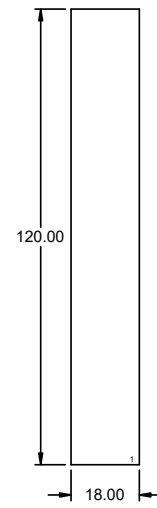

RIGHT SIDE SPLASH

Boys and Girls Club, Ripon, WI

Hood 1 - SPLASH PANEL LAYOUT



PROJECT  
2/17/2023

MARK

ACCUREX WIA  
Brad Borchardt  
brad.borchardt@accurex.com  
(262)227-7865

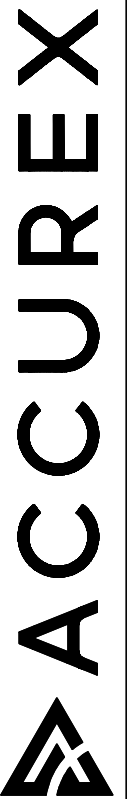

HOOD INFORMATION																
HOOD NO.	MARK	MODEL	HOOD DIMENSIONS (IN.)			HOOD CONSTR.	COOKING LOAD / DUTY RATING	EXHAUST COLLAR(S)					SUPPLY		TOTAL WEIGHT LBS.	SECTION LOCATION
			LENGTH	WIDTH	HEIGHT			TOTAL CFM	WIDTH	LENGTH	DIA.	CFM	S.P.	MUA CFM		
1	HOOD 2 (CONDENSATE)	XD1-48-S	48.0	48	24	300 SS 100%	600	9	9		600	0.137			97	SINGLE

HOOD INFORMATION																	
HOOD NO.	MARK	LIGHTING DETAILS			BAFFLE FILTRATION DETAILS			UTILITY CABINET(S)									
		FIXTURE TYPE BULB / LAMP INFO	QTY	FOOT CANDLES	TYPE / MODEL MATERIAL	QTY	SIZE (IN.) L H	LOCATION	FIRE SYSTEM		CONTROLS						
									TYPE	SIZE	MODEL	INTERFACE					
1	HOOD 2 (CONDENSATE)																

HOOD OPTIONS  
 18 IN HIGH CEILING ENCLOSURES - FRONT LEFT RIGHT - FIELD INSTALLED  
 FACTORY MOUNTED EXHAUST COLLAR(S)

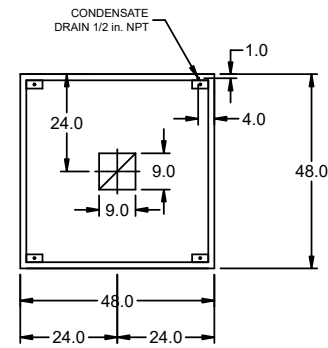
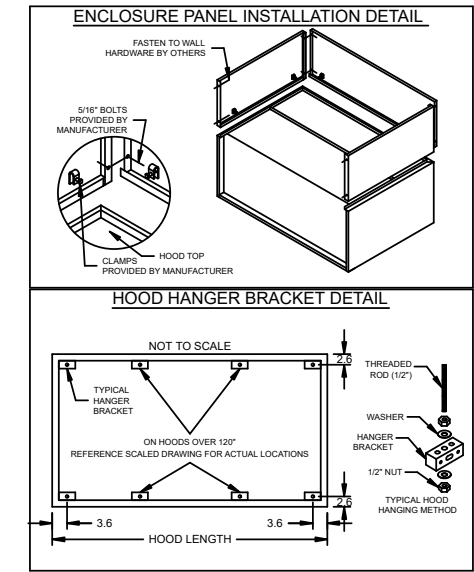

MARK: Hood 2 (Condensate) - SECTION 1  
 PLAN VIEW

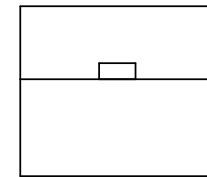

MARK: Hood 2 (Condensate) - SECTION 1  
 ELEVATION VIEW

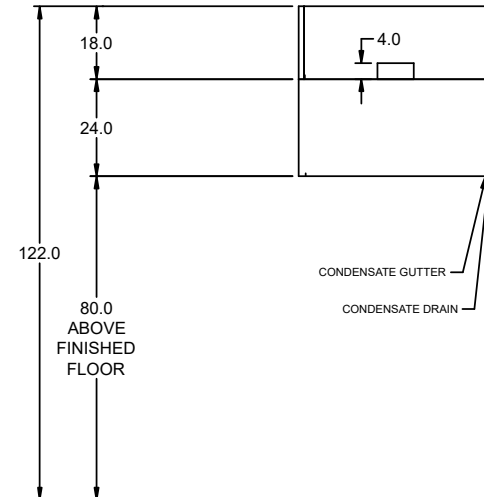

MARK: Hood 2 (Condensate)  
 SECTION VIEW

PROJECT: 2/17/2023  
 MARK: HOOD 2 (CONDENSATE)  
 BOYS AND GIRLS CLUB, RIPON, WI

ACCUREX WI/IA  
 BRAD BORCHARDT  
 BRAD.BORCHARDT@ACCUREX.COM  
 (262)227-7865



Direct Drive Upblast Centrifugal Roof Exhaust Fan

MARK INFORMATION		FAN INFORMATION						MOTOR INFORMATION					
QTY	MARK	MODEL	VOLUME (CFM)	TOTAL EXTERNAL SP (IN WG)	FAN RPM	OPERATING POWER (HP)	WEIGHT (LB.)	SIZE (HP)	V/C/P	ENCLOSURE	MOTOR RPM	WINDINGS	NEC FLA*
1	Exhaust Fan 1	XCUE-140-VG	2,250	1	1,615	0.79	92	1	115/60/1	OP	1725	1	16

\*NEC FLA - Based on table 430.250 or 430.248 of National Electrical Code 2020. Actual motor FLA may vary for sizing thermal overload, consult factory"

Exhaust Fan 1 : SELECTED OPTIONS AND ACCESSORIES

One piece fully welded windband  
 Tapered bushing wheel hub  
 Breather tube outlet area min. 4.4 sq. in. (sizes 99-480), 2.0 sq. in. (sizes 60-95)  
 Min. windband material thickness: 0.051" aluminum (060-240), 0.064" aluminum (240HP, 240XP), 0.080" aluminum (sizes 300-480)  
 Larger Curb Cap Size - 26 Square  
 UL/cUL 762 Listed - "Power Ventilators for Rest. Exh. Appliances"  
 Switch, NEMA-3R, Toggle, Shipped with Unit  
 Hinge, Factory Installed  
 High Temp Curb Seal Rated for Continuous Duty at 1500 F (Factory Attached)  
 Grease Trap (PN 475538)

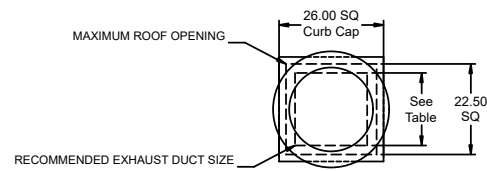

DUCT TYPE	SIZE
STANDARD	18 SQ
FIRE-WRAPPED	12 SQ

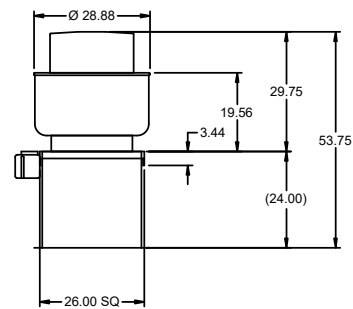
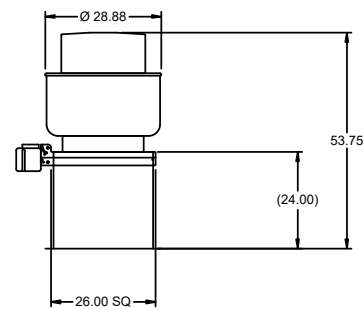

DUCT DIMENSIONS ARE LARGEST POSSIBLE DUCT TO FIT THROUGH CURB.  
 CONSULT SYSTEM DESIGN ENGINEER FOR RECOMMENDED DUCT SIZE.

OVERALL HEIGHT MAY BE GREATER DEPENDING ON  
 MOTOR, ADAPTER, AND/OR HINGE BASE.

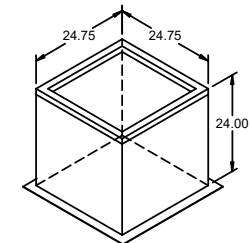

ACCUREX W11A  
 BRAD BORCHARDT  
 BRAD.BORCHARDT@ACCUREX.COM  
 (262)227-7865



PROJECT 2/17/2023 BOYS AND GIRLS CLUB, RIPON, WI

MARK EXHAUST FAN 1



Direct Drive Upblast Centrifugal Roof Exhaust Fan

MARK INFORMATION		FAN INFORMATION						MOTOR INFORMATION					
QTY	MARK	MODEL	VOLUME (CFM)	TOTAL EXTERNAL SP (IN WG)	FAN RPM	OPERATING POWER (HP)	WEIGHT (LB.)	SIZE (HP)	V/C/P	ENCLOSURE	MOTOR RPM	WINDINGS	NEC FLA*
1	Exhaust Fan 2 (Condensate)	XCUE-095-VG	600	0.5	1,551	0.12	47	0.167	115/60/1	TN	1725	1	4.4

\*NEC FLA - Based on table 430.250 or 430.248 of National Electrical Code 2020. Actual motor FLA may vary for sizing thermal overload, consult factory"

Exhaust Fan 2 (Condensate) : SELECTED OPTIONS AND ACCESSORIES

One piece fully welded windband  
 Tapered bushing wheel hub  
 Breather tube outlet area min. 4.4 sq. in. (sizes 99-480), 2.0 sq. in. (sizes 60-95)  
 Min. windband material thickness: 0.051" aluminum (060-240), 0.064" aluminum (240HP, 240XP), 0.080" aluminum (sizes 300-480)  
 Standard Curb Cap Size - 19 Square  
 UL/cUL 705 Listed - "Power Ventilators"  
 Switch, NEMA-1, Toggle, Shipped with Unit  
 Hinge, Factory Installed  
 Foam Curb Seal (Factory Applied)  
 Damper Shipped Loose, BD-100-PB-10X10, Gravity Operated, Not Coated  
 Composite Wheel Material

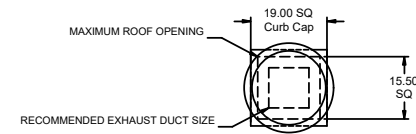

DUCT TYPE	SIZE
STANDARD	10 SQ

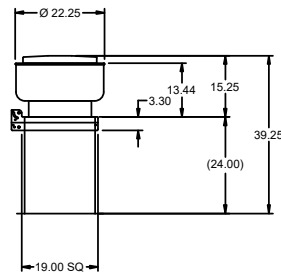

DUCT DIMENSIONS ARE LARGEST POSSIBLE DUCT TO FIT THROUGH CURB. CONSULT SYSTEM DESIGN ENGINEER FOR RECOMMENDED DUCT SIZE.

OVERALL HEIGHT MAY BE GREATER DEPENDING ON MOTOR, ADAPTER, AND/OR HINGE BASE.

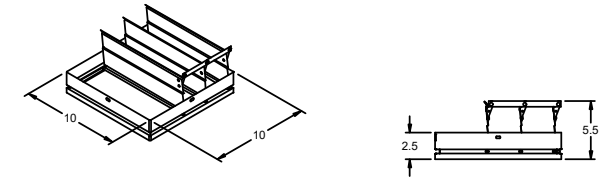

DAMPER

TYP. SECTION VIEW

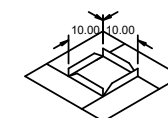
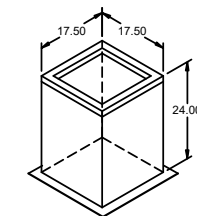

PROJECT 2/17/2023  
 BOYS AND GIRLS CLUB, RIPON, WI  
 MARK EXHAUST FAN 2 (CONDENSATE)

ACCUREX W I A  
 BRAD BORCHARDT  
 BRAD.BORCHARDT@ACCUREX.COM  
 (262)227-7865



FIRE SYSTEM INFORMATION

MARK	MODEL	LOCATION	FLOW POINTS		SUPPLY LINE	DETECTION	MARK(S) PROTECTED BY FIRE SYSTEM
			HOODS	PCU			
FIRE SUPPRESSION	ANSUL R-102 WET CHEMICAL	CABINET – RIGHT END OF HOOD 1	7 UTILIZED 11 AVAILABLE		CONTINUOUS	FUSIBLE LINK	HOOD 1 SECTION 1

FIRE SYSTEM OPTIONS AND ACCESSORIES

FULL INSTALLATION (INCLUDES PRE-PIPED HOOD(S) WITH DETECTION AND FACTORY COORDINATED INSTALL)  
 CHROME SLEEVES FOR FACTORY PROVIDED APPLIANCES DROPS - INCLUDED  
 METAL BLOW-OFF CAPS - INCLUDED  
 GAS VALVE - INCLUDED - MECHANICAL SHUTOFF VALVE, 1.5", (ANSUL) - PART# ANSULMECHSHUTOFFVALVE150  
 HOOD SUPPRESSION TANK - INCLUDED - 3 GAL. - [(1) 3.0 TANK(S)]  
 REMOTE PULL STATION - STANDARD - FIELD INSTALLATION AT SINGLE POINT OF EGRESS

ANSUL R102 (WET CHEMICAL) FIRE PROTECTION SYSTEM - MODEL FS5C

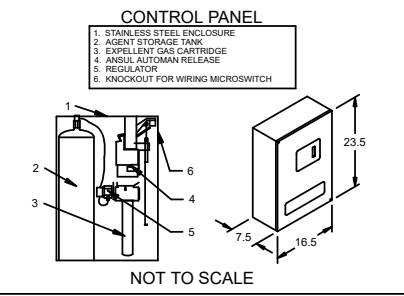

NOT TO SCALE

NOTES:

WET CHEMICAL FIRE PROTECTION SYSTEM TO BE ANSUL R-102, DESIGNED IN COMPLIANCE WITH UL 300 REQUIREMENTS.  
 -VERIFICATION OF ALL COOKING EQUIPMENT MAKE, MODEL AND LOCATION REQUIRED FOR ALL FIRE PROTECTION SYSTEMS.  
 -ALL FIRE SYSTEM PIPING IS STANDARDLY TO THE RIGHT END OF THE HOOD UNLESS A WALL IS LOCATED ON THE RIGHT END.  
 -ANSUL AUTOMAN RELEASE TO BE LOCATED WITHIN 60" OF HOOD.

THE BASIC FIRE SYSTEM WILL INCLUDE THE FOLLOWING:  
 -GAS SHUT-OFF VALVE, IF REQUIRED, TO BE SUPPLIED BY MANUFACTURER (UP TO 2" DIAMETER AS STANDARD), AND INSTALLED BY A LICENSED PLUMBER.  
 -MICRO SWITCH TO BE SUPPLIED BY MANUFACTURER FOR CONNECTION TO, BUT NOT LIMITED TO, BUILDING ALARM SYSTEM(S), EXHAUST AND SUPPLY FANS AND ELECTRICAL POWER SHUT DOWN. FIELD WIRING AND CONNECTIONS TO BE PERFORMED BY A LICENSED ELECTRICIAN.

THE BASIC FIRE SYSTEM DOES NOT INCLUDE THE FOLLOWING:  
 -FULL DUMP TEST OTHER THAN WHAT IS SPECIFIED PER THE INSTALLATION MANUAL, OR TO SATISFY A STATE OR LOCAL CODE. PERMIT AND TESTING FEES ARE NOT INCLUDED UNLESS NOTED UNDER THE EQUIPMENT SCHEDULE FOR THE FIRE SYSTEM.  
 -MORE THAN TWO TRIPS TO THE JOBSITE OR SPECIAL TRANSPORTATION, OR OVERNIGHT LODGING REQUIREMENTS IN REMOTE AREAS. NORMAL TRAVEL DISTANCE IS FIRST 50 MI. (80.5 KM) FROM OFFICE.  
 -SPECIAL CLASSES OR ADDITIONAL LABOR FOR ACCESS TO SECURITY SENSITIVE AREAS  
 -INSTALLATION OF GAS SHUT-OFF VALVE.  
 -SPECIAL DRAWINGS REQUIRED TO SATISFY STATE OR LOCAL CODE. PLAN EXAMINATION FEES, PE OR PS APPROVAL STAMP.  
 -UNION LABOR, GOVERNMENT LABOR, OR PREVAILING WAGES REQUIRED FOR FINAL FIELD HOOK-UP.  
 -ANY AND ALL ELECTRICAL COMPONENTS/CONNECTIONS REQUIRED TO SHUT DOWN FANS, SHUT OFF DEVICE FOR ELECTRIC COOKING EQUIPMENT (SHUNT TRIP BREAKER), OR ACTIVATE AN ALARM SYSTEM, ETC.  
 -ANY DISMANTLING OR REASSEMBLY REQUIRED TO GAIN ACCESS TO THE FIRE SUPPRESSION PIPING LOCATED ON THE TOP OF THE HOOD.  
 -ROUGH-IN HIDDEN CONDUIT FOR REMOTE PULL STATION OR GAS VALVE (FLUSH MOUNTED PULL STATION).  
 -INSTALLATION OF MORE THAN (1) REMOTE PULL STATIONS OR DISTANCES GREATER THAN 20 FT (6.1M).  
 -PARTS OR LABOR REQUIRED TO CORRECT PIPING DUE TO COOKING EQUIPMENT CHANGES OR DEVIATION FROM PLANS, OR ANY CHARGES FOR MISSING OR ADDITIONAL PARTS OTHER THAN THOSE INDICATED ON THE FIRE SUPPRESSION DETAIL.

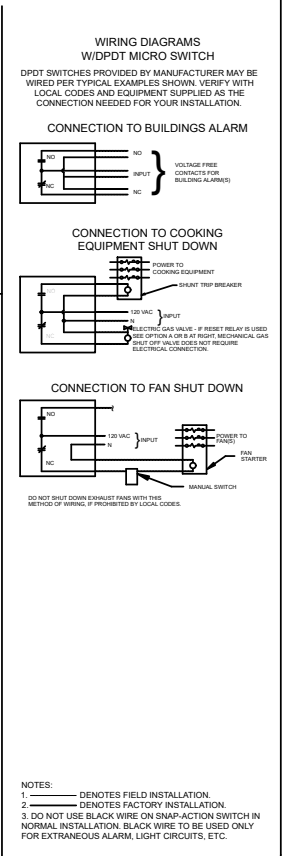

NOTES:  
 1. \_\_\_\_\_ DENOTES FIELD INSTALLATION.  
 2. \_\_\_\_\_ DENOTES FACTORY INSTALLATION.  
 3. DO NOT USE BLACK WIRE OR SNAP-ACTION SWITCH IN NORMAL INSTALLATION. BLACK WIRE TO BE USED ONLY FOR EXTRANEOUS ALARM, LIGHT CIRCUITS, ETC.

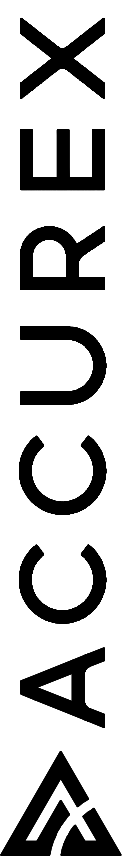

ACCUREX W/IA  
 BRAD BORCHARDT  
 BRAD.BORCHARDT@ACCUREX.COM  
 (262)227-7865

PROJECT  
 2/17/2023

MARK

BOYS AND GIRLS CLUB, RIPON,  
 WI

FIRE SUPPRESSION



LISTED  
 UL  
 COMPONENTS

CONTROL INFORMATION

MARK	ELECTRICAL CONTROL PACKAGE		USER INTERFACE		FANS CONTROLLED											
	MODEL	LOCATION	TYPE	LOCATION	FAN #	TYPE	FAN	FAN MARK	ZONE	CFM	MOTOR HP	MOTOR VOLT	CYCLE	MOTOR PHASE	MOTOR STARTER IN PANEL	VFD IN PANEL
CONTROLS 1	XKC-CV-S-11-1-1-0	RIGHT CABINET ON HOOD 1	FULL COLOR TOUCHSCREEN	CABINET - RIGHT CABINET ON HOOD 1	1	EXHAUST	E1	EXHAUST FAN 1	1	2250	1	115	60	1	NO	NO
					2	SUPPLY	S1	MAU BY OTHERS	1	2250	1.5	208	60	3	NO	NO

**CONTROL FEATURES**  
 HOOD LIGHT CONTROL  
 TEMP SENSORS (FACTORY INSTALLED) - QTY. 1  
 DRY FIRE CONTACTS - QTY. 1  
 LIGHTS OFF DURING FIRE  
 EXHAUST MAX DURING FIRE  
 SUPPLY OFF DURING FIRE

CABINET DETAILS	USER INTERFACE DETAILS
<p>DRAWING NOT TO SCALE</p> <p>KITCHEN HOOD</p> <p>CONTROLS</p>	<p><b>MOUNTING TYPE</b> FACTORY MOUNTED: UTILITY CABINET - RIGHT END OF HOOD</p> <p><b>USER INTERFACE CONTROL</b> FANS AND LIGHTS</p> <p><b>INTERFACE CABLE LENGTH</b> 7FT (FACTORY PROVIDED)</p>
<p><b>MOUNTING LOCATION:</b> UTILITY CABINET ON HOOD (INNER CONTROL BOX: 12 X 20 X 6)</p> <p><b>NOTES:</b> 1) WHEN CONTROLS ARE MOUNTED IN HOOD-MOUNTED OR WALL-MOUNTED UTILITY CABINET, FOR HOOD OR WALL CABINET DIMENSIONS SEE HOOD SUBMITTAL. 2) MINIMUM OF 36" OF CLEARANCE RECOMMENDED IN FRONT OF CONTROL CABINET</p>	

DOC NUMBER: --- REV: ---

**CAUTION**  
UNIT MUST BE GROUNDED IN ACCORDANCE WITH N.E.C. POWER MUST BE OFF WHILE SERVICING.

**ATTENTION**  
L'APPAREIL DOIT ÊTRE MIS À LA TERRE CONFORMÉMENT AU CODE C.E. L'ALIMENTATION DOIT ÊTRE COUPÉE DURANT L'ENTRETIEN.

COMMERCIAL APPLIANCE OUTLET CENTER  
ELECTRICAL RATINGS: 110-240V, 1PHASE, 50-60HZ, 15A  
BASE FILE #E200616, ML FILE #E313951

NE PAS RETIRER CES DESSINS DE CET ÉQUIPEMENT SAUF INDICATION CONTRAIRE. UTILISER DES CONDUCTEURS EN CUIVRE CLASSÉS 90 °C. SERRER LES BORNES DE COMMANDE ET DE MISE À LA TERRE À 8 LB-PO. SERRER LES COSSÉS/VIS D'ALIMENTATION AUX COUPLES INDICUÉS POUR LE COMPOSANT. SERRER LES BORNES À VIS DE LA CARTE DE COMMANDE À 3.5 LB-PO. LA RÉSISTANCE DU CÂBLAGE DE COMMANDE LOCAL NE DOIT PAS DÉPASSER 0.75 OHM. POUR PLUS D'INFORMATION, CONSULTER LE MANUEL OU APPELER 1-800-371-8858.

PRG VERSION: V4  
FIELD WIRED (CÂBLÉ À L'USINE)  
FACTORY WIRED (CÂBLÉ À L'USINE)

**WIRING DIAGRAM CODE: WDC#**  
 JOB NAME: BOYS AND GIRLS CLUB, RIPON, WI  
 MODEL: XKC-CV-S-11-1-1-0  
 SERIAL NUMBER: WDSN#  
 MARK: CONTROLS 1

**POWER WIRING FOR KITCHEN CONTROLS**  
(WIRING TO BE DONE BY ELECTRICIAN)

**POWER WIRING FROM BREAKER PANEL DIRECT TO FANS**  
(WIRING TO BE DONE BY ELECTRICIAN)

**CONTROL WIRING FOR KITCHEN CONTROLS**  
(WIRING TO BE DONE BY ELECTRICIAN, IF NO CONTROLS CONTRACTOR. USE 18-22GA WIRE UNLESS SPECIFIED.)

**MAIN CONTROL PANEL**

**\*FIRE SYSTEM DRY CONTACT WIRING EXAMPLES**

SHUNT TRIP (BY OTHERS) WIRING EXAMPLE: [Diagram showing shunt trip wiring]

APPLIANCE CONTACTORS (BY OTHERS) WIRING EXAMPLE: [Diagram showing appliance contactor wiring]

**FAN CONFIGURATION**

FAN #	TYPE	FAN	FAN MARK	ZONE	MIN CFM	MAX CFM	MODBUS VFD	VFD ADDRESS	MIN FREQ.	MAX FREQ.	MIN VDC	MAX VDC
1	EXHAUST	E1	EXHAUST FAN 1	Z1	-	2250	NO	-	-	-	-	10.0
2	SUPPLY	S1	MAU BY OTHERS	Z1	-	2250	NO	-	-	-	-	10.0

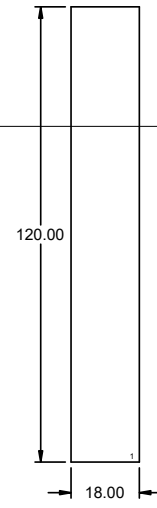

LEFT SIDE SPLASH

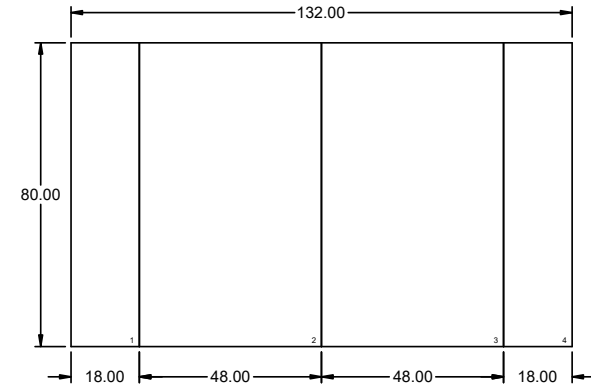

BACK SPLASH

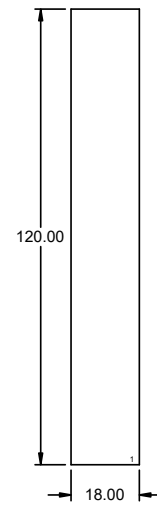

RIGHT SIDE SPLASH

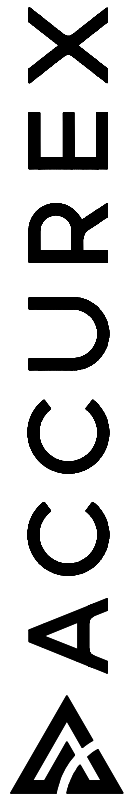

ACCUREX WIA  
 Brad Borchardt  
 brad.borchardt@accurex.com  
 (262)227-7865

PROJECT  
 2/24/2023

MARK

Boys and Girls Club, Ripon, WI R1

Hood 1 - SPLASH PANEL LAYOUT



HOOD INFORMATION																
HOOD NO.	MARK	MODEL	HOOD DIMENSIONS (IN.)			HOOD CONSTR.	COOKING LOAD / DUTY RATING	EXHAUST COLLAR(S)					SUPPLY		TOTAL WEIGHT LBS.	SECTION LOCATION
			LENGTH	WIDTH	HEIGHT			TOTAL CFM	WIDTH	LENGTH	DIA.	CFM	S.P.	MUA CFM		
1	HOOD 2 (CONDENSATE)	XD1-48-S	48.0	48	24	300 SS 100%	600	9	9		600	0.137			97	SINGLE

HOOD INFORMATION																
HOOD NO.	MARK	LIGHTING DETAILS			BAFFLE FILTRATION DETAILS			UTILITY CABINET(S)								
		FIXTURE TYPE BULB / LAMP INFO	QTY	FOOT CANDLES	TYPE / MODEL MATERIAL	QTY	SIZE (IN.) L H	LOCATION	FIRE SYSTEM		CONTROLS					
1	HOOD 2 (CONDENSATE)								TYPE	SIZE	MODEL	INTERFACE				

HOOD OPTIONS  
 18 IN HIGH CEILING ENCLOSURES - FRONT LEFT RIGHT - FIELD INSTALLED  
 FACTORY MOUNTED EXHAUST COLLAR(S)

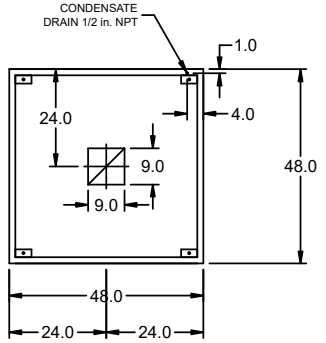
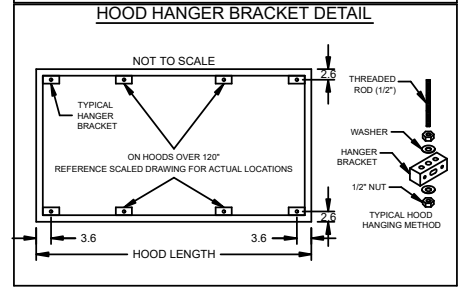
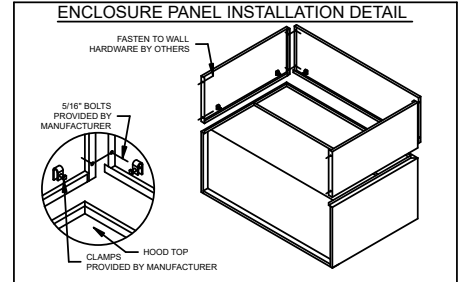

MARK: Hood 2 (Condensate) - SECTION 1  
 PLAN VIEW

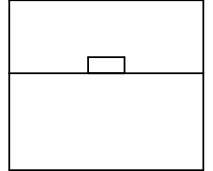

MARK: Hood 2 (Condensate) - SECTION 1  
 ELEVATION VIEW

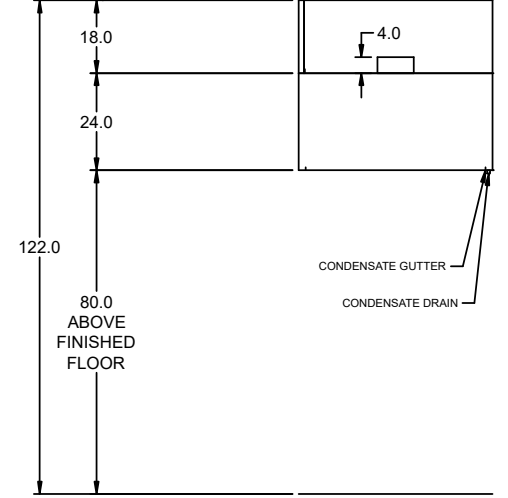

MARK: Hood 2 (Condensate)  
 SECTION VIEW

PROJECT: 2/24/2023  
 MARK: BOYS AND GIRLS CLUB, R1PON, WI R1  
 HOOD 2 (CONDENSATE)

ACCUREX WI/IA  
 BRAD BORCHARDT  
 BRAD.BORCHARDT@ACCUREX.COM  
 (262)227-7865

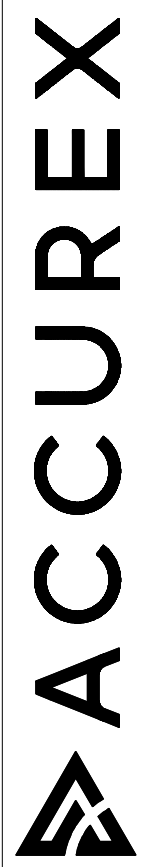

Direct Drive Upblast Centrifugal Roof Exhaust Fan

MARK INFORMATION		FAN INFORMATION						MOTOR INFORMATION					
QTY	MARK	MODEL	VOLUME (CFM)	TOTAL EXTERNAL SP (IN WG)	FAN RPM	OPERATING POWER (HP)	WEIGHT (LB.)	SIZE (HP)	V/C/P	ENCLOSURE	MOTOR RPM	WINDINGS	NEC FLA*
1	Exhaust Fan 1	XCUE-140-VG	2,250	1	1,615	0.79	92	1	115/60/1	OP	1725	1	16

\*NEC FLA - Based on table 430.250 or 430.248 of National Electrical Code 2020. Actual motor FLA may vary for sizing thermal overload, consult factory"

Exhaust Fan 1 : SELECTED OPTIONS AND ACCESSORIES

One piece fully welded windband  
 Tapered bushing wheel hub  
 Breather tube outlet area min. 4.4 sq. in. (sizes 99-480), 2.0 sq. in. (sizes 60-95)  
 Min. windband material thickness: 0.051" aluminum (060-240), 0.064" aluminum (240HP, 240XP), 0.080" aluminum (sizes 300-480)  
 Larger Curb Cap Size - 26 Square  
 UL/cUL 762 Listed - "Power Ventilators for Rest. Exh. Appliances"  
 Switch, NEMA-3R, Toggle, Shipped with Unit  
 Hinge, Factory Installed  
 High Temp Curb Seal Rated for Continuous Duty at 1500 F (Factory Attached)  
 Grease Trap (PN 475538)

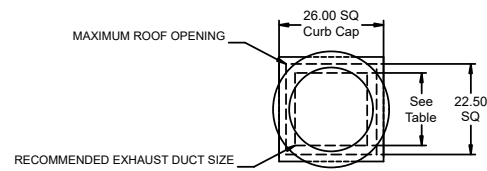

DUCT TYPE	SIZE
STANDARD	18 SQ
FIRE-WRAPPED	12 SQ

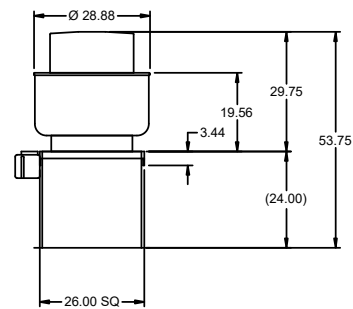
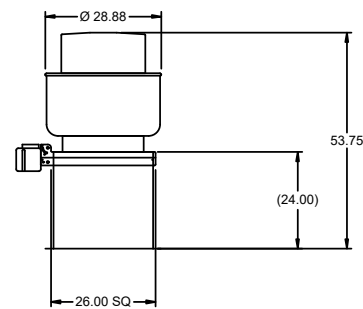

DUCT DIMENSIONS ARE LARGEST POSSIBLE DUCT TO FIT THROUGH CURB.  
 CONSULT SYSTEM DESIGN ENGINEER FOR RECOMMENDED DUCT SIZE.

OVERALL HEIGHT MAY BE GREATER DEPENDING ON  
 MOTOR, ADAPTER, AND/OR HINGE BASE.

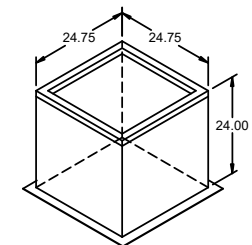

ACCUREX W I A  
 BRAD BORCHARDT  
 BRAD.BORCHARDT@ACCUREX.COM  
 (262)227-7865

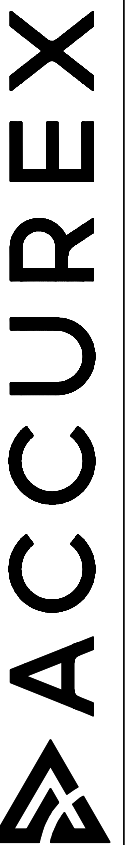

PROJECT 2/24/2023 BOYS AND GIRLS CLUB, RIPON, WI R1

MARK EXHAUST FAN 1



COMMERCIAL ROOF EXHAUST

Direct Drive Upblast Centrifugal Roof Exhaust Fan

MARK INFORMATION		FAN INFORMATION						MOTOR INFORMATION					
QTY	MARK	MODEL	VOLUME (CFM)	TOTAL EXTERNAL SP (IN WG)	FAN RPM	OPERATING POWER (HP)	WEIGHT (LB.)	SIZE (HP)	V/C/P	ENCLOSURE	MOTOR RPM	WINDINGS	NEC FLA*
1	Exhaust Fan 2 (Condensate)	XCUE-095-VG	600	0.5	1,551	0.12	47	0.167	115/60/1	TN	1725	1	4.4

\*NEC FLA - Based on table 430.250 or 430.248 of National Electrical Code 2020. Actual motor FLA may vary for sizing thermal overload, consult factory"

Exhaust Fan 2 (Condensate) : SELECTED OPTIONS AND ACCESSORIES

One piece fully welded windband  
 Tapered bushing wheel hub  
 Breather tube outlet area min. 4.4 sq. in. (sizes 99-480), 2.0 sq. in. (sizes 60-95)  
 Min. windband material thickness: 0.051" aluminum (060-240), 0.064" aluminum (240HP, 240XP), 0.080" aluminum (sizes 300-480)  
 Standard Curb Cap Size - 19 Square  
 UL/cUL 705 Listed - "Power Ventilators"  
 Switch, NEMA-1, Toggle, Shipped with Unit  
 Hinge, Factory Installed  
 Foam Curb Seal (Factory Applied)  
 Damper Shipped Loose, BD-100-PB-10X10, Gravity Operated, Not Coated  
 Composite Wheel Material

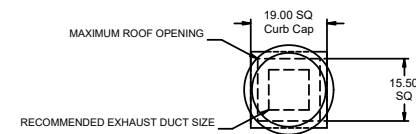

DUCT TYPE	SIZE
STANDARD	10 SQ

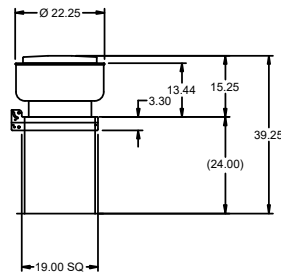

DUCT DIMENSIONS ARE LARGEST POSSIBLE DUCT TO FIT THROUGH CURB. CONSULT SYSTEM DESIGN ENGINEER FOR RECOMMENDED DUCT SIZE.

OVERALL HEIGHT MAY BE GREATER DEPENDING ON MOTOR, ADAPTER, AND/OR HINGE BASE.

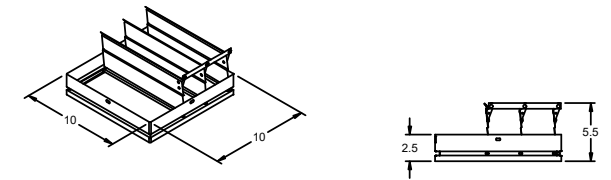

DAMPER

TYP. SECTION VIEW

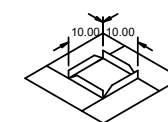
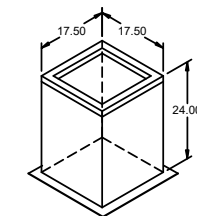

PROJECT 2/24/2023  
 BOYS AND GIRLS CLUB, RIPON, WI R1  
 MARK EXHAUST FAN 2 (CONDENSATE)

ACCUREX W I A  
 BRAD BORCHARDT  
 BRAD.BORCHARDT@ACCUREX.COM  
 (262)227-7865



FIRE SYSTEM INFORMATION

MARK	MODEL	LOCATION	FLOW POINTS		SUPPLY LINE	DETECTION	MARK(S) PROTECTED BY FIRE SYSTEM
			HOODS	PCU			
FIRE SUPPRESSION	ANSUL R-102 WET CHEMICAL	CABINET – RIGHT END OF HOOD 1	7 UTILIZED 11 AVAILABLE		CONTINUOUS	FUSIBLE LINK	HOOD 1 SECTION 1

FIRE SYSTEM OPTIONS AND ACCESSORIES

FULL INSTALLATION (INCLUDES PRE-PIPED HOOD(S) WITH DETECTION AND FACTORY COORDINATED INSTALL)  
 CHROME SLEEVES FOR FACTORY PROVIDED APPLIANCES DROPS - INCLUDED  
 METAL BLOW-OFF CAPS - INCLUDED  
 GAS VALVE - INCLUDED - MECHANICAL SHUTOFF VALVE, 1.5", (ANSUL) - PART# ANSULMECHSHUTOFFVALVE150  
 HOOD SUPPRESSION TANK - INCLUDED - 3 GAL. - [(1) 3.0 TANK(S)]  
 REMOTE PULL STATION - STANDARD - FIELD INSTALLATION AT SINGLE POINT OF EGRESS

ANSUL R102 (WET CHEMICAL) FIRE PROTECTION SYSTEM - MODEL FS5C

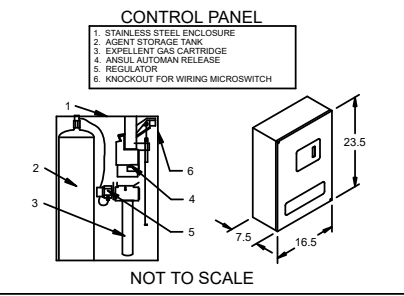

NOT TO SCALE

NOTES:

WET CHEMICAL FIRE PROTECTION SYSTEM TO BE ANSUL R-102, DESIGNED IN COMPLIANCE WITH UL 300 REQUIREMENTS.  
 -VERIFICATION OF ALL COOKING EQUIPMENT MAKE, MODEL AND LOCATION REQUIRED FOR ALL FIRE PROTECTION SYSTEMS.  
 -ALL FIRE SYSTEM PIPING IS STANDARDLY TO THE RIGHT END OF THE HOOD UNLESS A WALL IS LOCATED ON THE RIGHT END.  
 -ANSUL AUTOMAN RELEASE TO BE LOCATED WITHIN 60" OF HOOD.

THE BASIC FIRE SYSTEM WILL INCLUDE THE FOLLOWING:  
 -GAS SHUT-OFF VALVE, IF REQUIRED, TO BE SUPPLIED BY MANUFACTURER (UP TO 2" DIAMETER AS STANDARD), AND INSTALLED BY A LICENSED PLUMBER.  
 -MICRO SWITCH TO BE SUPPLIED BY MANUFACTURER FOR CONNECTION TO, BUT NOT LIMITED TO, BUILDING ALARM SYSTEM(S), EXHAUST AND SUPPLY FANS AND ELECTRICAL POWER SHUT DOWN. FIELD WIRING AND CONNECTIONS TO BE PERFORMED BY A LICENSED ELECTRICIAN.

THE BASIC FIRE SYSTEM DOES NOT INCLUDE THE FOLLOWING:  
 -FULL DUMP TEST OTHER THAN WHAT IS SPECIFIED PER THE INSTALLATION MANUAL, OR TO SATISFY A STATE OR LOCAL CODE. PERMIT AND TESTING FEES ARE NOT INCLUDED UNLESS NOTED UNDER THE EQUIPMENT SCHEDULE FOR THE FIRE SYSTEM.  
 -MORE THAN TWO TRIPS TO THE JOBSITE OR SPECIAL TRANSPORTATION, OR OVERNIGHT LODGING REQUIREMENTS IN REMOTE AREAS. NORMAL TRAVEL DISTANCE IS FIRST 50 MI. (80.5 KM) FROM OFFICE.  
 -SPECIAL CLASSES OR ADDITIONAL LABOR FOR ACCESS TO SECURITY SENSITIVE AREAS  
 -INSTALLATION OF GAS SHUT-OFF VALVE.  
 -SPECIAL DRAWINGS REQUIRED TO SATISFY STATE OR LOCAL CODE. PLAN EXAMINATION FEES, PE OR PS APPROVAL STAMP.  
 -UNION LABOR, GOVERNMENT LABOR, OR PREVAILING WAGES REQUIRED FOR FINAL FIELD HOOK-UP.  
 -ANY AND ALL ELECTRICAL COMPONENTS/CONNECTIONS REQUIRED TO SHUT DOWN FANS, SHUT OFF DEVICE FOR ELECTRIC COOKING EQUIPMENT (SHUNT TRIP BREAKER), OR ACTIVATE AN ALARM SYSTEM, ETC.  
 -ANY DISMANTLING OR REASSEMBLY REQUIRED TO GAIN ACCESS TO THE FIRE SUPPRESSION PIPING LOCATED ON THE TOP OF THE HOOD.  
 -ROUGH-IN HIDDEN CONDUIT FOR REMOTE PULL STATION OR GAS VALVE (FLUSH MOUNTED PULL STATION).  
 -INSTALLATION OF MORE THAN (1) REMOTE PULL STATIONS OR DISTANCES GREATER THAN 20 FT (6.1M).  
 -PARTS OR LABOR REQUIRED TO CORRECT PIPING DUE TO COOKING EQUIPMENT CHANGES OR DEVIATION FROM PLANS, OR ANY CHARGES FOR MISSING OR ADDITIONAL PARTS OTHER THAN THOSE INDICATED ON THE FIRE SUPPRESSION DETAIL.

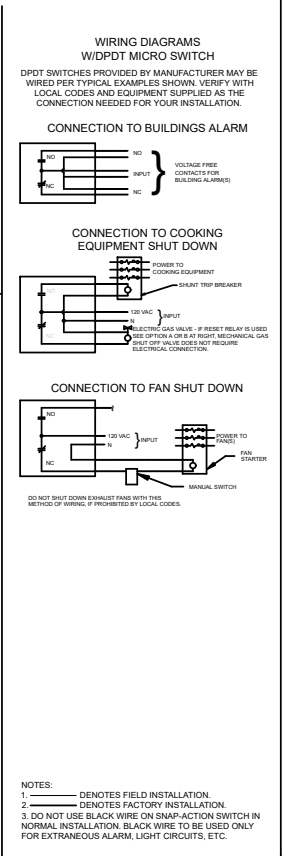

ACCUREX W/IA  
 BRAD BORCHARDT  
 BRAD.BORCHARDT@ACCUREX.COM  
 (262)227-7865

PROJECT  
 2/24/2023

MARK

BOYS AND GIRLS CLUB, RIPON,  
 WIR1

FIRE SUPPRESSION



LISTED  
 UL 300

CONTROL INFORMATION

MARK	ELECTRICAL CONTROL PACKAGE		USER INTERFACE		FANS CONTROLLED											
	MODEL	LOCATION	TYPE	LOCATION	FAN #	TYPE	FAN	FAN MARK	ZONE	CFM	MOTOR HP	MOTOR VOLT	CYCLE	MOTOR PHASE	MOTOR STARTER IN PANEL	VFD IN PANEL
CONTROLS 1	XKC-CV-S-11-1-1-0	RIGHT CABINET ON HOOD 1	FULL COLOR TOUCHSCREEN	CABINET - RIGHT CABINET ON HOOD 1	1	EXHAUST	E1	EXHAUST FAN 1	1	2250	1	115	60	1	NO	NO
					2	SUPPLY	S1	MAU BY OTHERS	1	2250	1.5	208	60	3	NO	NO

**CONTROL FEATURES**  
 HOOD LIGHT CONTROL  
 TEMP SENSORS (FACTORY INSTALLED) - QTY. 1  
 DRY FIRE CONTACTS - QTY. 1  
 LIGHTS OFF DURING FIRE  
 EXHAUST MAX DURING FIRE  
 SUPPLY OFF DURING FIRE



DOC NUMBER: --- REV: ---

**CAUTION**  
 UNIT MUST BE GROUNDED IN ACCORDANCE WITH N.E.C. POWER MUST BE OFF WHILE SERVICING.

**ATTENTION**  
 L'APPAREIL DOIT ÊTRE MIS À LA TERRE CONFORMÉMENT AU CODE C.E. L'ALIMENTATION DOIT ÊTRE COUPÉE DURANT L'ENTRETIEN.

COMMERCIAL APPLIANCE OUTLET CENTER  
 ELECTRICAL RATINGS: 110-240V, 1PHASE, 50-60HZ, 15A  
 BASE FILE #E200616, ML FILE #E313951

PRG VERSION: V4  
 FIELD WIRED (CÂBLÉ À L'USINE)  
 FACTORY WIRED (CÂBLÉ À L'USINE)

NE PAS RETIRER CES DESSINS DE CET ÉQUIPEMENT SAUF INDICATION CONTRAIRE. UTILISER DES CONDUCTEURS EN CUIVRE CLASSÉS 90 °C. SERRER LES BORNES DE COMMANDE ET DE MISE À LA TERRE À 8 LB-PO. SERRER LES COSSÉS/VIS D'ALIMENTATION AUX COUPLES INDICUÉS POUR LE COMPOSANT. SERRER LES BORNES À VIS DE LA CARTE DE COMMANDE À 3.5 LB-PO. LA RÉSISTANCE DU CÂBLAGE DE COMMANDE LOCAL NE DOIT PAS DÉPASSER 0.75 OHM. POUR PLUS D'INFORMATION, CONSULTER LE MANUEL OU APPELER 1-800-371-8858.

WIRING DIAGRAM CODE: WDC#  
 JOB NAME: BOYS AND GIRLS CLUB, RIPON, WI R1  
 MODEL: XKC-CV-S-11-1-1-0  
 SERIAL NUMBER: WDSN#  
 MARK: CONTROLS 1

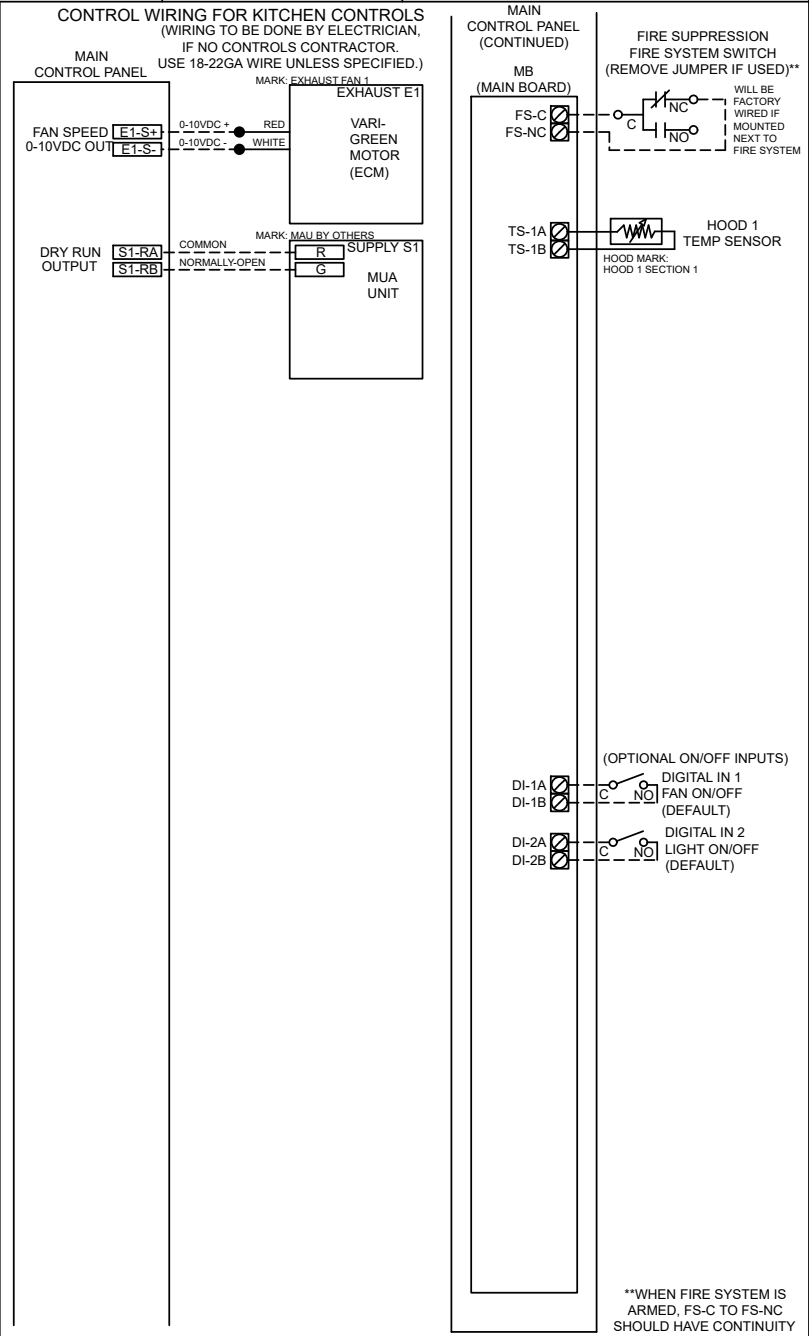
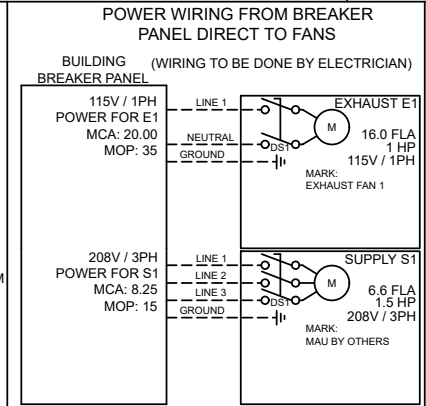
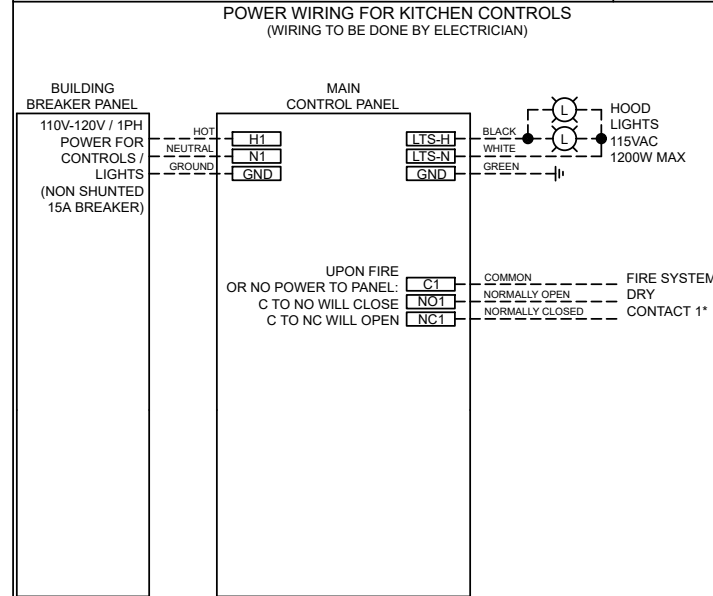

**CABINET DETAILS**  
 DRAWING NOT TO SCALE

**USER INTERFACE DETAILS**

**MOUNTING TYPE**  
 FACTORY MOUNTED:  
 UTILITY CABINET - RIGHT END OF HOOD

**USER INTERFACE CONTROL**  
 FANS AND LIGHTS

**INTERFACE CABLE LENGTH**  
 7FT (FACTORY PROVIDED)

**MOUNTING LOCATION:**  
 UTILITY CABINET ON HOOD  
 (INNER CONTROL BOX: 12 X 20 X 6)

**NOTES:**  
 1) WHEN CONTROLS ARE MOUNTED IN HOOD-MOUNTED OR WALL-MOUNTED UTILITY CABINET, FOR HOOD OR WALL CABINET DIMENSIONS SEE HOOD SUBMITTAL.  
 2) MINIMUM OF 36" OF CLEARANCE RECOMMENDED IN FRONT OF CONTROL CABINET

WIRING DIAGRAM CODE: WDC#  
 JOB NAME: BOYS AND GIRLS CLUB, RIPON, WI R1  
 MODEL: XKC-CV-S-11-1-1-0  
 SERIAL NUMBER: WDSN#  
 MARK: CONTROLS 1  
 DOC NUMBER: --- REV: ---

**DEFAULT SETTINGS / PARAMÈTRES PAR DÉFAUT**

**FACTORY SETTINGS**  
 TYPE: CV  
 CONFIGURATION: STANDARD  
 ZONES: 1  
 HOODS: 1  
 SUMPS: 0  
 EXHAUST FANS: 1  
 SUPPLY FANS: 1  
 MB ROOM SENSOR: NO  
 MB TEMP SENSORS: 1  
 HIGH TEMP FAULT: NO  
 FREEZE PROTECTION: YES  
 GAS RESET: NO  
 FAN PROVING: NO  
 BMS: NONE

**ZONE SETTINGS**  
 SEE ZONE CONFIGURATION IN TABLE ON LEFT

**HOOD SETTINGS**  
 SEE HOOD CONFIGURATION IN TABLE ON LEFT

**EXHAUST FAN SETTINGS**  
 SEE FAN CONFIGURATION IN TABLE ON LEFT

**SUPPLY FAN SETTINGS**  
 SEE FAN CONFIGURATION IN TABLE ON LEFT

**SENSOR SETTINGS**  
 SEE HOOD CONFIGURATION IN TABLE ON LEFT

**USER INTERFACE SETTINGS (MB)**  
 FAN & LIGHT BUTTONS: SHOW BOTH (SEPERATE)

**USER INTERFACE SETTINGS (HCB)**  
 NA

**GENERAL SETTINGS**  
 TIME ZONE: CENTRAL DAYLIGHT (DEFAULT)

**FIRE/FAULT SETTINGS**  
 EXHAUST DURING FIRE: MAX  
 SUPPLY DURING FIRE: OFF  
 LIGHTS DURING FIRE: OFF

**BMS SETTINGS**  
 NA

PRG VERSION: V4

FAN CONFIGURATION												
FAN #	TYPE	FAN	FAN MARK	ZONE	MIN CFM	MAX CFM	MODBUS VFD	VFD ADDRESS	MIN FREQ.	MAX FREQ.	MIN VDC	MAX VDC
1	EXHAUST	E1	EXHAUST FAN 1	Z1	-	2250	NO	-	-	-	-	10.0
2	SUPPLY	S1	MAU BY OTHERS	Z1	-	2250	NO	-	-	-	-	10.0

EQUIPMENT SCHEDULE									
Tempered Make-Up Air Unit									
Qty	Accurex Model	Volume	External SP	Total SP	MCA	MOP	Weight	SCCR	Mark: MAU 1
1	XDGX-P109-H12-MF-4	2,025 CFM	0.5 in. wg	1,316 in. wg	27	40	1,663 lb	5kA	
Motor Information									
Size	VICP	Enclosure	Motor with Shaft Grounding	Motor RPM	Operating Power				
1 1/2 hp	208/60/3	ODP	No	3600	0.95 hp				
Heating									
Type	Gas Type	Temperature	Energy	Connection	Building	Control	Gas Pressure		
Direct Gas	Natural	Winter DB Max Δ, Max LAT	Input, Output, Efficiency	Gas (IN)	Gas Pressure	Access	Min, Max		
		-3.9 F, 73.9 F, 70.0 F	175.7 MBH, 161.6 MBH, 92%	3/4"	1/2 PSI	Right Hand	7 in. wg, 0.5 PSI		
Cooling									
Cooling Type	Coil Model	Rows Deep	Fins Per Inch	Face Velocity	Total Energy	Sensible Energy	Leaving Dry Bulb	Leaving Wet Bulb	
Packaged DX	DX38S01S10-30x30	1	10	324 ft/min	51.5 MBH	26.0 MBH	76.8 F	70.4 F	
Coil SP	Refrigerant	Suction Temp	Liquid Temp	Super Heat	Code 18/19	Suction Conn Qty / Size	Liquid Conn Qty / Size		
NA	R-410a	41.7 F	110 F	8 F	0	NA	NA		
Outlet Sound Power By Octave Band									
62.5	125	250	500	1000	2000	4000	8000	LwA	dBA
84.1	71.3	71.6	75.3	78.6	80.9	80.6	73.9	86.1	75.1
<small>* LwA - A weighted sound pressure level based on ANSI S1.4  <small>* dBA - A weighted sound pressure level based on ANSI S1.4  <small>* Noise Criteria (NC) based on an average with a maximum of 15.0 dB per octave band at 0.5 ft.</small> </small> </small>									

**OPTIONS AND ACCESSORIES**

Air Flow Arrangement: Outdoor Air Only  
 Weatherhood: Aluminum Mesh, 16x20x2 - (4)  
 Damper: Inlet  
 Outdoor Air Intake Position: End  
 Discharge Position: Bottom  
 Coating: Galvanized  
 Cooling Coil Coating - None  
 Insulation: Double Wall - Tempering On  
 Supply Fan Control: VFD  
 VFD Control: Constant Volume  
 Access Side: Right-Hand  
 Control Center:  
 Heat Inlet Air Sensor  
 Cool Inlet Air Sensor  
 Unit Controls: Terminal Strip  
 Temperature Control: Discharge  
 Direct Gas Options/Accessories  
 Approvals: ETL  
 FM Compliant  
 Flame Sensing: Flame Rod  
 Ignition Control: Pilot

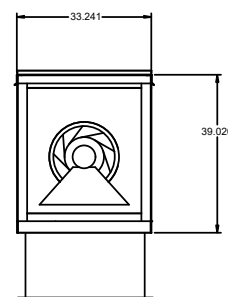
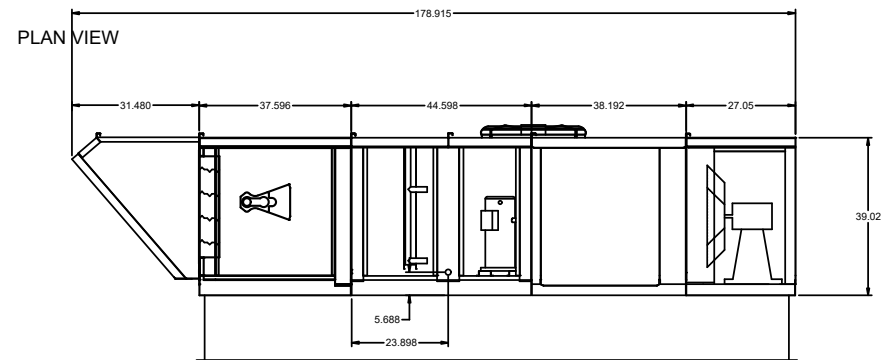
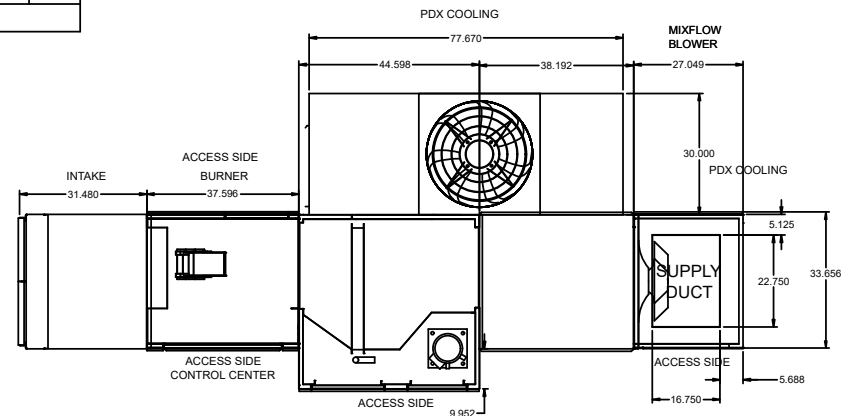

ELEVATION VIEW

END VIEW

NOTE: Roof Opening Requirements:

Minimum Roof Opening: The minimum roof opening size is the illustrated duct diameter plus 0.25 in. on all sides.  
 For example: If the duct size is 14 x 14 in. square, the minimum roof opening size is 14.5 x 14.5 in. square.

Maximum Roof Opening: There must be a minimum perimeter of 1.75 in. between the roof opening and the roof curb.  
 For example: If the roof curb is 75 x 30 in. square, the maximum roof opening is 71.5 x 26.5 in. inches square.

NOTE: The weatherhood and filter sections of the make-up air unit are not supported by the curb.  
 This is by design, in order to help alleviate water infiltration issues.

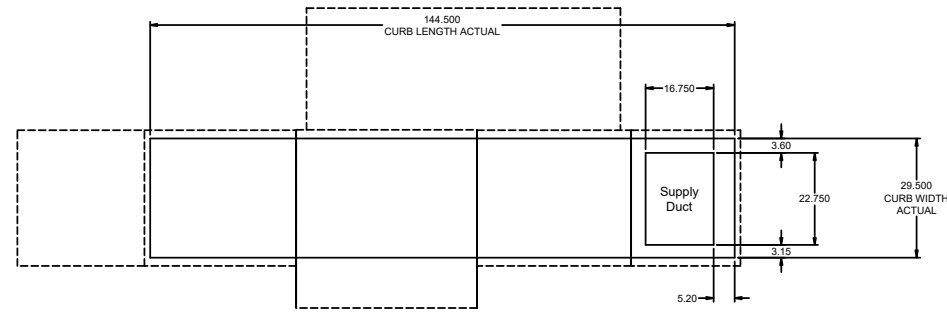

FOOTPRINT

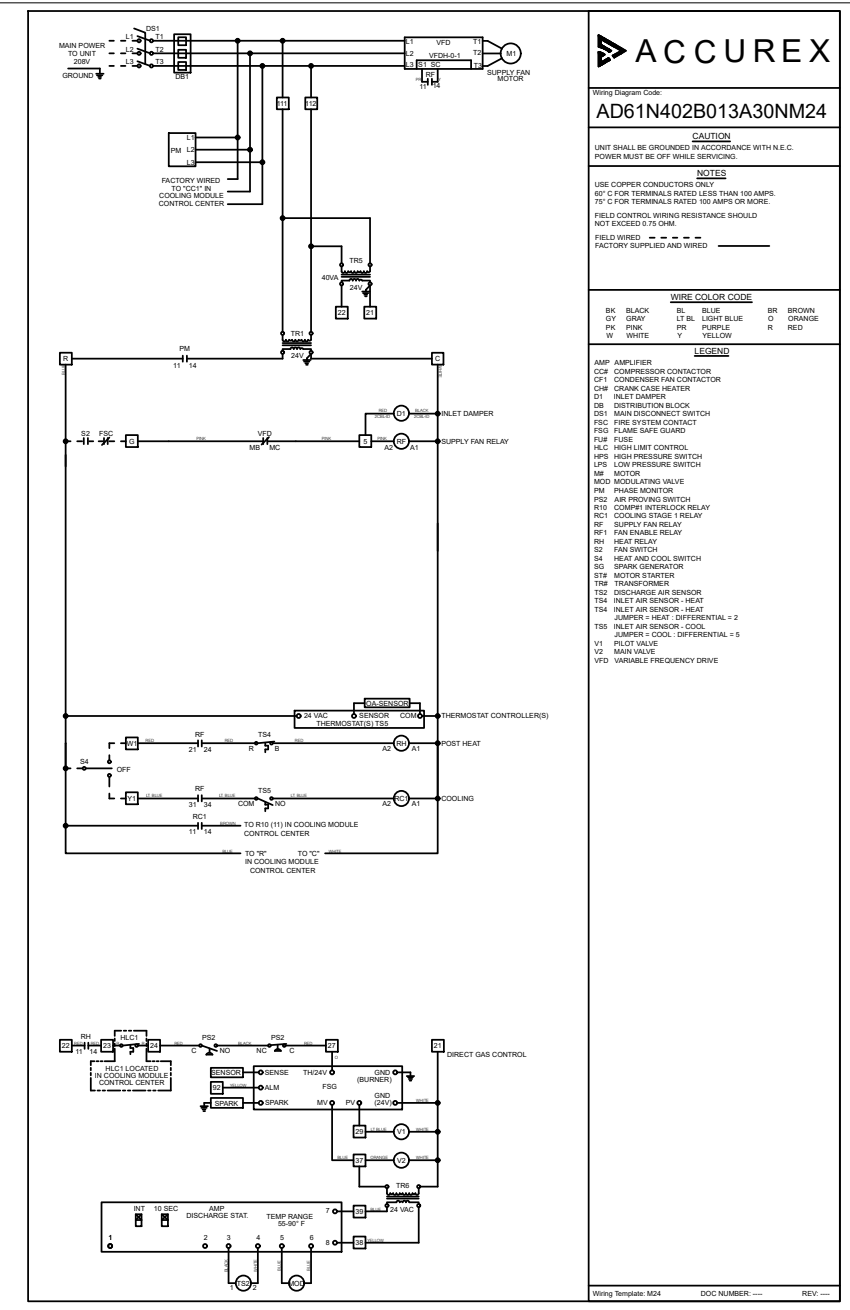

PROJECT: 2/24/2023 BOYS AND GIRLS CLUB, RIPON, WI R1

MARK: MAU 1

ACCUREX W1/A  
 BRAD BORCHARDT  
 BRAD.BORCHARDT@ACCUREX.COM  
 (262)227-7865

**ACCUREX**