

HOOD INFORMATION

HOOD NO.	MARK	MODEL	HOOD DIMENSIONS (IN.)			HOOD CONSTR.	COOKING LOAD / DUTY RATING	EXHAUST COLLAR(S)					SUPPLY		TOTAL WEIGHT LBS.	SECTION LOCATION	
			LENGTH	WIDTH	HEIGHT			TOTAL CFM	WIDTH	LENGTH	DIA.	CFM	S.P.	MUA CFM			AC CFM
1	KH-1	XXEW-126-S	126	63	24	430 SS WHERE EXPOSED	HEAVY	2363	9	23		2363	0.597			375.337	SINGLE

HOOD INFORMATION

HOOD NO.	MARK	LIGHTING DETAILS			GREASE FILTRATION DETAILS			UTILITY CABINET(S)					
		FIXTURE TYPE BULB / LAMP INFO	QTY	FOOT CANDLES	TYPE / MODEL MATERIAL	QTY	SIZE (IN.) L H	LOCATION	FIRE SYSTEM TYPE	SIZE	MODEL	INTERFACE	
1	KH-1	ROUND LED	3	73.33	X-TRACTOR STAINLESS STEEL	4	16 20	20	LEFT	ANSUL R102	3	XKC	TOUCHSCREEN

HOOD OPTIONS

UL 710 LISTED W/ OUT EXHAUST FIRE DAMPER - UL #R25625
 BACK INTEGRAL AIR SPACE - 3 IN WIDE
 18 IN HIGH CEILING ENCLOSURES - FRONT LEFT RIGHT - FIELD INSTALLED
 FACTORY MOUNTED EXHAUST COLLAR(S)
 BACKSPLASH 80.00 IN HIGH 138.00 IN LONG
 PERFORMANCE ENHANCING LIP (PEL) TECHNOLOGY
 STANDING SEAM CONSTRUCTION FOR SUPERIOR STRENGTH

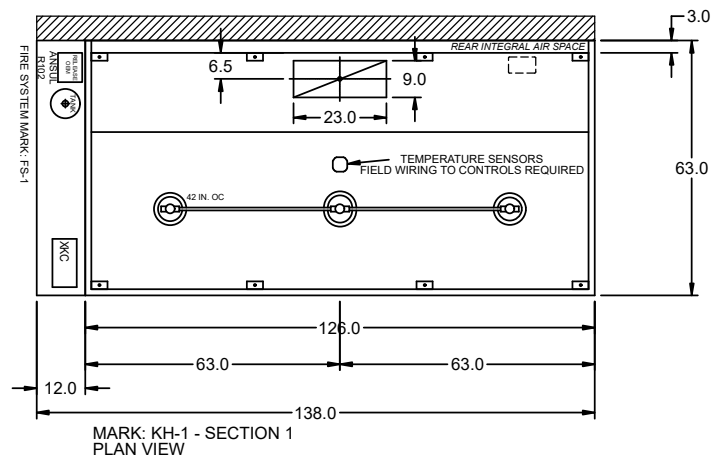

MARK: KH-1 - SECTION 1 PLAN VIEW

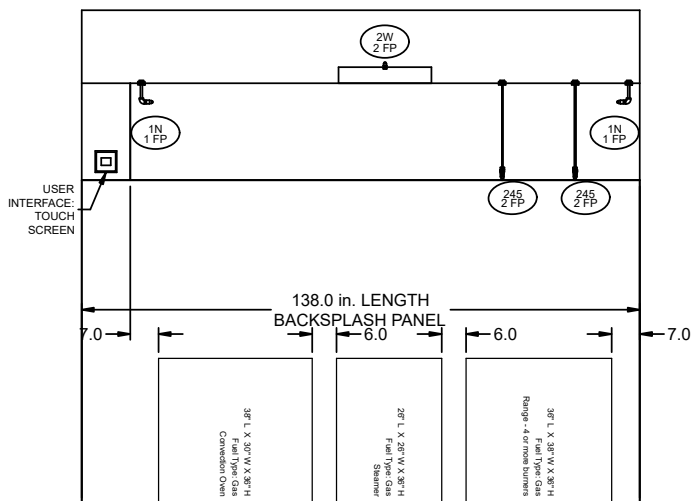

MARK: KH-1 - SECTION 1 ELEVATION VIEW

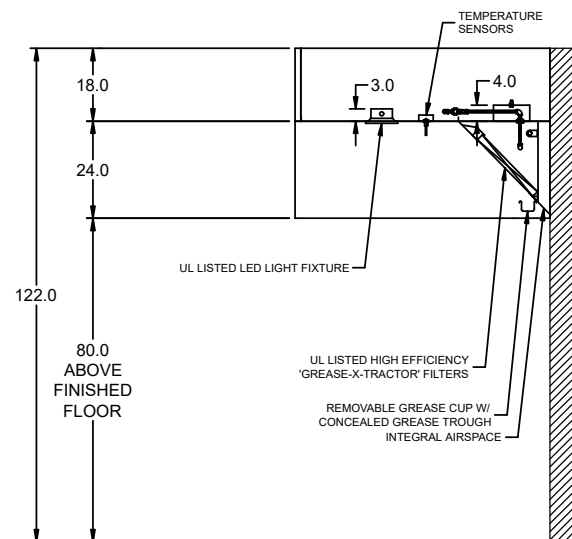

MARK: KH-1 SECTION VIEW

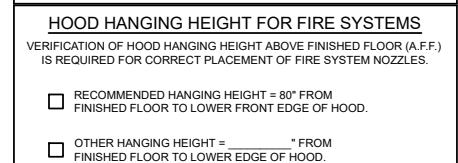
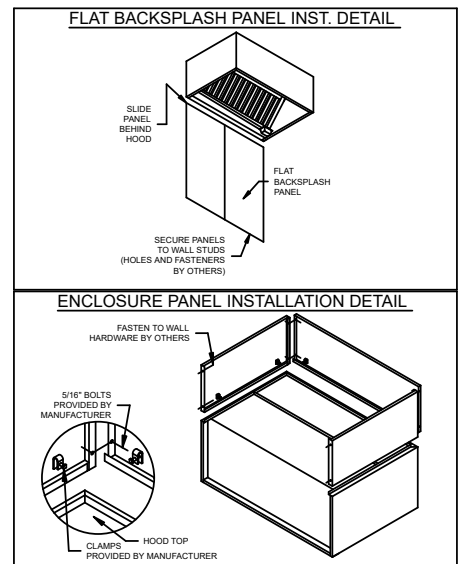

HOOD HANGING HEIGHT FOR FIRE SYSTEMS

VERIFICATION OF HOOD HANGING HEIGHT ABOVE FINISHED FLOOR (A.F.F.) IS REQUIRED FOR CORRECT PLACEMENT OF FIRE SYSTEM NOZZLES.

- RECOMMENDED HANGING HEIGHT = 80" FROM FINISHED FLOOR TO LOWER FRONT EDGE OF HOOD.
- OTHER HANGING HEIGHT = _____" FROM FINISHED FLOOR TO LOWER EDGE OF HOOD.

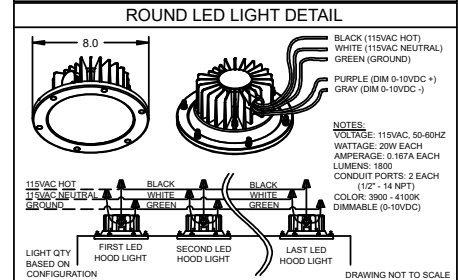
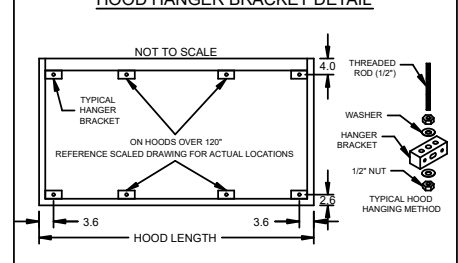

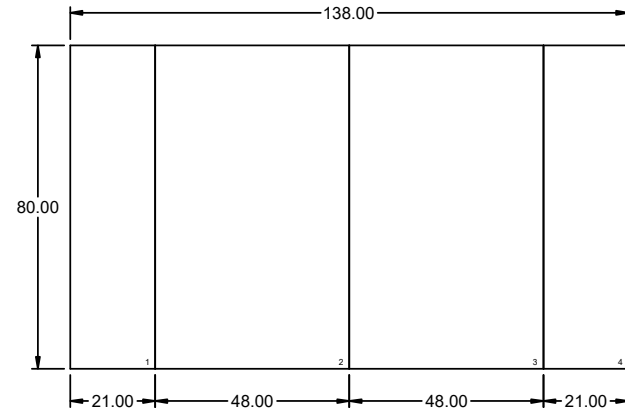

BACK SPLASH

FIRE SYSTEM INFORMATION

MARK	MODEL	LOCATION	FLOW POINTS		SUPPLY LINE	DETECTION	MARK(S) PROTECTED BY FIRE SYSTEM
			HOODS	PCU			
FS-1	ANSUL R-102 WET CHEMICAL	CABINET – LEFT END OF KH-1	8 UTILIZED 11 AVAILABLE		CONTINUOUS	FUSIBLE LINK	KH-1 SECTION 1

FIRE SYSTEM OPTIONS AND ACCESSORIES

FULL INSTALLATION (INCLUDES PRE-PIPED HOOD(S) WITH DETECTION AND FACTORY COORDINATED INSTALL)
 CHROME SLEEVES FOR FACTORY PROVIDED APPLIANCES DROPS - INCLUDED
 METAL BLOW-OFF CAPS - INCLUDED
 GAS VALVE - INCLUDED - MECHANICAL SHUTOFF VALVE, 2", (ANSUL) - PART# ANSULMECHSHUTOFFVALVE200
 HOOD SUPPRESSION TANK - INCLUDED - 3 GAL. - [(1) 3.0 TANK(S)]
 REMOTE PULL STATION - STANDARD - FIELD INSTALLATION AT SINGLE POINT OF EGRESS

ANSUL R102 (WET CHEMICAL) FIRE PROTECTION SYSTEM - MODEL FS5C

CONTROL PANEL

NOT TO SCALE

NOTES:

WET CHEMICAL FIRE PROTECTION SYSTEM TO BE ANSUL R-102, DESIGNED IN COMPLIANCE WITH UL 300 REQUIREMENTS.

- VERIFICATION OF ALL COOKING EQUIPMENT MAKE, MODEL AND LOCATION REQUIRED FOR ALL FIRE PROTECTION SYSTEMS.
- ALL FIRE SYSTEM PIPING IS STANDARDLY TO THE RIGHT END OF THE HOOD UNLESS A WALL IS LOCATED ON THE RIGHT END.
- ANSUL AUTOMAN RELEASE TO BE LOCATED WITHIN 60" OF HOOD.

THE BASIC FIRE SYSTEM WILL INCLUDE THE FOLLOWING:

- GAS SHUT-OFF VALVE, IF REQUIRED, TO BE SUPPLIED BY MANUFACTURER (UP TO 2" DIAMETER AS STANDARD), AND INSTALLED BY A LICENSED PLUMBER.
- MICRO SWITCH TO BE SUPPLIED BY MANUFACTURER FOR CONNECTION TO, BUT NOT LIMITED TO, BUILDING ALARM SYSTEM(S), EXHAUST AND SUPPLY FANS AND ELECTRICAL POWER SHUT DOWN. FIELD WIRING AND CONNECTIONS TO BE PERFORMED BY A LICENSED ELECTRICIAN.

THE BASIC FIRE SYSTEM DOES NOT INCLUDE THE FOLLOWING:

- FULL DUMP TEST OTHER THAN WHAT IS SPECIFIED PER THE INSTALLATION MANUAL, OR TO SATISFY A STATE OR LOCAL CODE. PERMIT AND TESTING FEES ARE NOT INCLUDED UNLESS NOTED UNDER THE EQUIPMENT SCHEDULE FOR THE FIRE SYSTEM.
- MORE THAN TWO TRIPS TO THE JOBSITE OR SPECIAL TRANSPORTATION, OR OVERNIGHT LODGING REQUIREMENTS IN REMOTE AREAS. NORMAL TRAVEL DISTANCE IS FIRST 50 MI. (80.5 KM) FROM OFFICE.
- SPECIAL CLASSES OR ADDITIONAL LABOR FOR ACCESS TO SECURITY SENSITIVE AREAS.
- INSTALLATION OF GAS SHUT-OFF VALVE.
- SPECIAL DRAWINGS REQUIRED TO SATISFY STATE OR LOCAL CODE. PLAN EXAMINATION FEES, PE OR PS APPROVAL STAMP.
- UNION LABOR, GOVERNMENT LABOR, OR PREVAILING WAGES REQUIRED FOR FINAL FIELD HOOK-UP.
- ANY AND ALL ELECTRICAL COMPONENTS/CONNECTIONS REQUIRED TO SHUT DOWN FANS, SHUT OFF DEVICE FOR ELECTRIC COOKING EQUIPMENT (SHUNT TRIP BREAKER), OR ACTIVATE AN ALARM SYSTEM, ETC.
- ANY DISMANTLING OR REASSEMBLY REQUIRED TO GAIN ACCESS TO THE FIRE SUPPRESSION PIPING LOCATED ON THE TOP OF THE HOOD.
- ROUGH-IN HIDDEN CONDUIT FOR REMOTE PULL STATION OR GAS VALVE (FLUSH MOUNTED PULL STATION).
- INSTALLATION OF MORE THAN (1) REMOTE PULL STATIONS OR DISTANCES GREATER THAN 20 FT (6.1M).
- PARTS OR LABOR REQUIRED TO CORRECT PIPING DUE TO COOKING EQUIPMENT CHANGES OR DEVIATION FROM PLANS, OR ANY CHARGES FOR MISSING OR ADDITIONAL PARTS OTHER THAN THOSE INDICATED ON THE FIRE SUPPRESSION DETAIL.

WIRING DIAGRAMS W/DPDT MICRO SWITCH

DPDT SWITCHES PROVIDED BY MANUFACTURER MAY BE WIRED PER TYPICAL EXAMPLES SHOWN, VERIFY WITH LOCAL CODES AND EQUIPMENT SUPPLIED AS THE CONNECTION NEEDED FOR YOUR INSTALLATION.

CONNECTION TO BUILDINGS ALARM

CONNECTION TO COOKING EQUIPMENT SHUT DOWN

CONNECTION TO FAN SHUT DOWN

NOTES:

1. _____ DENOTES FIELD INSTALLATION.
2. _____ DENOTES FACTORY INSTALLATION.
3. DO NOT USE BLACK WIRE OR SNAP-ACTION SWITCH IN NORMAL INSTALLATION. BLACK WIRE TO BE USED ONLY FOR EXTRANEOUS ALARM, LIGHT CIRCUITS, ETC.

CONTROL INFORMATION

MARK	ELECTRICAL CONTROL PACKAGE		USER INTERFACE		FANS CONTROLLED											
	MODEL	LOCATION	TYPE	LOCATION	FAN #	TYPE	FAN	FAN MARK	ZONE	CFM	MOTOR HP	MOTOR VOLT	CYCLE	MOTOR PHASE	MOTOR STARTER IN PANEL	VFD IN PANEL
CONTROLS-1	XKC-CV-S-11-1-1-0	LEFT CABINET ON KH-1	FULL COLOR TOUCHSCREEN	CABINET - LEFT CABINET ON KH-1	1	EXHAUST	E1	EF-1	1	2363	2	208	60	3	NO	NO
					2	SUPPLY	S1	MAU-1	1	2127	2	208	60	3	NO	NO

CONTROL FEATURES
 HOOD LIGHT CONTROL
 TEMP SENSORS (FACTORY INSTALLED) - QTY. 1
 DRY FIRE CONTACTS - QTY. 1
 LIGHTS OFF DURING FIRE
 EXHAUST MAX DURING FIRE
 SUPPLY OFF DURING FIRE

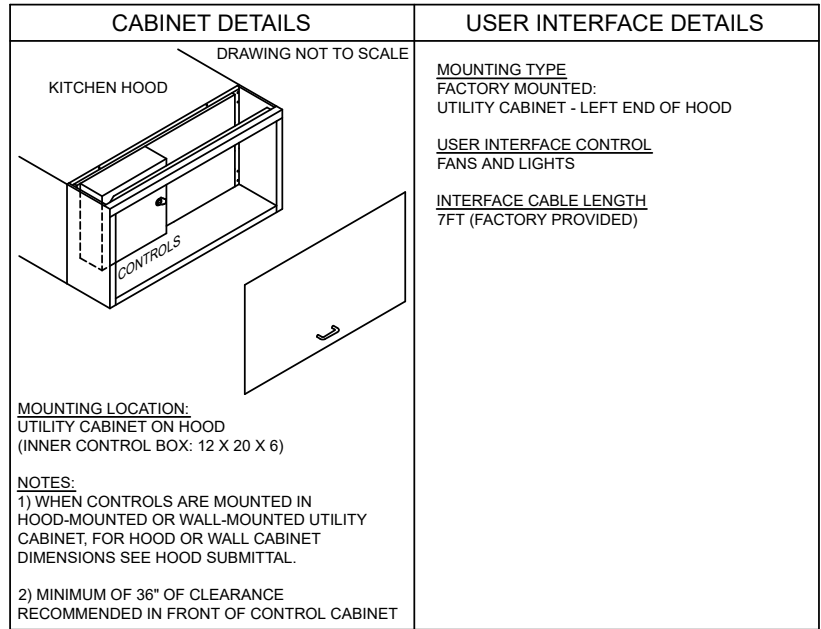
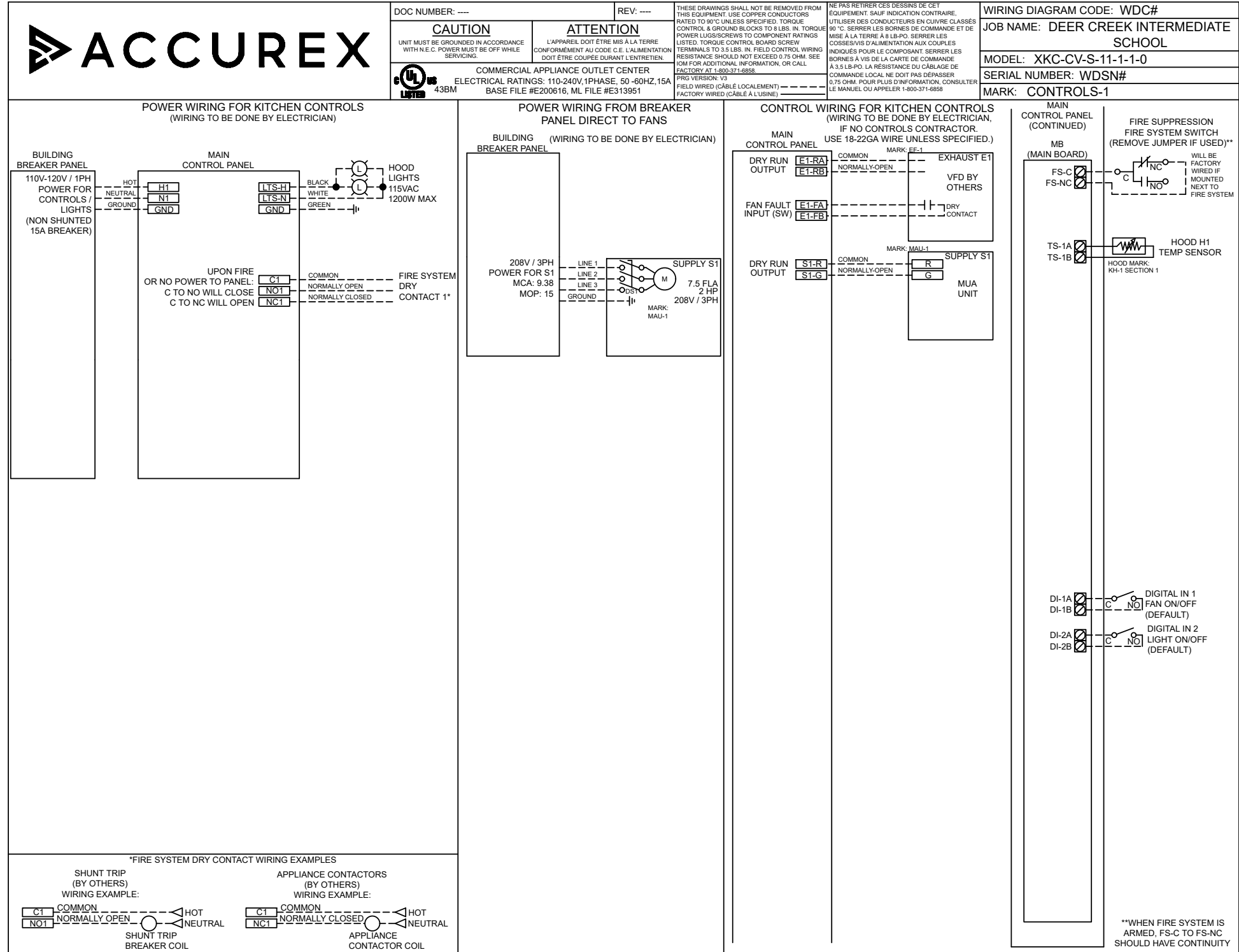

ZONE CONFIGURATION							WIRING DIAGRAM CODE: WDC#									
JOB NAME: DEER CREEK INTERMEDIATE SCHOOL							MODEL: XKC-CV-S-11-1-1-0									
MARK: CONTROLS-1							SERIAL NUMBER: WDSN#									
DOC NUMBER: ---							REV: ---									
HOOD CONFIGURATION							DEFAULT SETTINGS / PARAMÈTRES PAR DÉFAUT									
TYPE: CV							CONFIGURATION: STANDARD									
ZONES: 1							HOODS: 1									
SUMPS: 0							SUPPLY FANS: 1									
EXHAUST FANS: 1							MB ROOM SENSOR: NO									
MB TEMP SENSORS: 1							HIGH TEMP FAULT: NO									
FREEZE PROTECTION: YES							GAS RESET: NO									
FAN PROVING: NO							BMS: NONE									
ZONE SETTINGS							SEE ZONE CONFIGURATION IN TABLE ON LEFT									
HOOD SETTINGS							SEE HOOD CONFIGURATION IN TABLE ON LEFT									
EXHAUST FAN SETTINGS							SEE FAN CONFIGURATION IN TABLE ON LEFT									
SUPPLY FAN SETTINGS							SEE FAN CONFIGURATION IN TABLE ON LEFT									
SENSOR SETTINGS							SEE HOOD CONFIGURATION IN TABLE ON LEFT									
USER INTERFACE SETTINGS (MB)							FAN & LIGHT BUTTONS: SHOW BOTH (SEPERATE)									
USER INTERFACE SETTINGS (HCB)							NA									
GENERAL SETTINGS							TIME ZONE: CENTRAL DAYLIGHT (DEFAULT)									
FIRE FAULT SETTINGS							EXHAUST DURING FIRE: MAX									
							SUPPLY DURING FIRE: OFF									
							LIGHTS DURING FIRE: OFF									
BMS SETTINGS							NA									
							PRG VERSION: V3									
FAN CONFIGURATION																
FAN #	TYPE	FAN	FAN MARK	ZONE	MIN CFM	MAX CFM	MODBUS VFD	VFD ADDRESS	MIN FREQ.	MAX FREQ.	MIN VDC	MAX VDC				
1	EXHAUST	E1	EF-1	Z1	-	2363	NO	-	-	-	-	10.0				
2	SUPPLY	S1	MAU-1	Z1	-	2127	NO	-	-	-	-	10.0				

HOOD INFORMATION																
HOOD NO.	MARK	MODEL	HOOD DIMENSIONS (IN.)			HOOD CONSTR.	COOKING LOAD / DUTY RATING	EXHAUST COLLAR(S)					SUPPLY		TOTAL WEIGHT LBS.	SECTION LOCATION
			LENGTH	WIDTH	HEIGHT			TOTAL CFM	WIDTH	LENGTH	DIA.	CFM	S.P.	MUA CFM		
1	CH-1	XD1-48-S	48.0	48	24	430 SS 100%	600	10	10		600	0.9			97	SINGLE

HOOD INFORMATION																	
HOOD NO.	MARK	LIGHTING DETAILS			BAFFLE FILTRATION DETAILS			UTILITY CABINET(S)									
		FIXTURE TYPE BULB / LAMP INFO	QTY	FOOT CANDLES	TYPE / MODEL MATERIAL	QTY	SIZE (IN.) L H	LOCATION	FIRE SYSTEM		CONTROLS						
									TYPE	SIZE	MODEL	INTERFACE					
1	CH-1																

HOOD OPTIONS
 18 IN HIGH CEILING ENCLOSURES - FRONT LEFT RIGHT - FIELD INSTALLED
 FACTORY MOUNTED EXHAUST COLLAR(S)

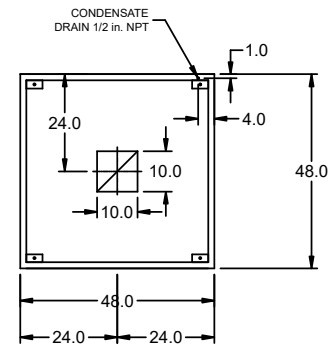
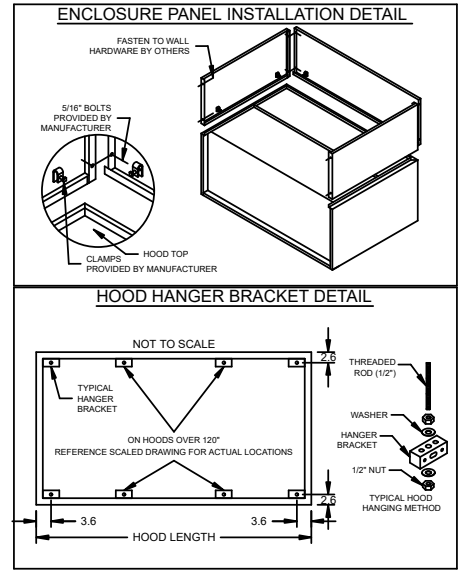

MARK: CH-1 - SECTION 1
 PLAN VIEW

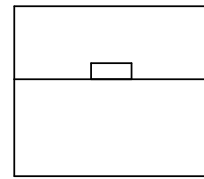

MARK: CH-1 - SECTION 1
 ELEVATION VIEW

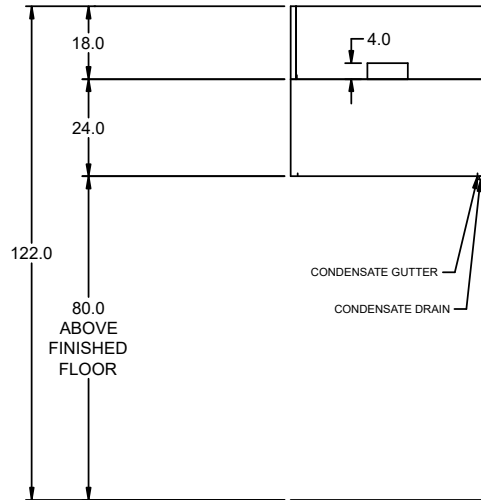

MARK: CH-1
 SECTION VIEW