

E5 HVAC PLAN
 SCALE: 1/4" = 1'-0"

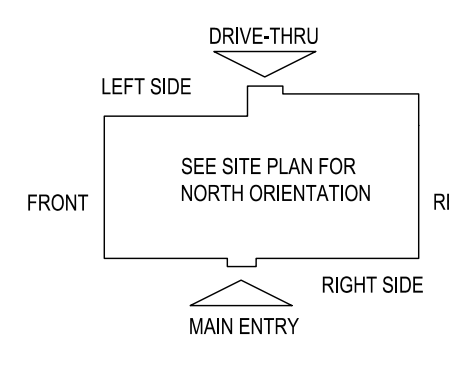

NOTE: ALL DUCTWORK TO BE LOCATED IN TRUSS SPACE WHERE POSSIBLE. SEE FRAMING PLAN.
 HVAC SETPOINTS RECOMMENDED BY CORPORATE OPERATIONAL GUIDELINES:
 1. DINING: HEATING 70 DEGF. COOLING 72 DEGF.
 2. KITCHEN: HEATING 68 DEGF. COOLING 74 DEGF

SUPPLY DUCTWORK SIZING TABLE*

ROUND		RECTANGULAR	
SIZE	CFM RANGE	SIZE	CFM RANGE
8"	115 - 235	8"x8"	205 - 300
10"	240 - 435	10"x8"	305 - 400
12"	440 - 710	10"x10"	405 - 550
14"	715 - 1,070	12"x10"	555 - 700
16"	1,075 - 1,530	12"x12"	705 - 900
18"	1,535 - 2,090	14"x12"	905 - 1,105
20"	2,095 - 2,760	16"x12"	1,110 - 1,315
22"	2,765 - 3,550	18"x12"	1,320 - 1,520
24"	3,555 - 4,470	20"x12"	1,525 - 1,740
*CONTRACTOR MAY SUBSTITUTE RECTANGULAR FOR ROUND DUCTWORK ON MAIN RUNS AT THEIR DISCRETION. BRANCHES TO DIFFUSERS TO REMAIN ROUND.			
		22"x12"	1,745 - 1,950
		24"x12"	1,955 - 2,170
		26"x12"	2,175 - 2,400
		28"x12"	2,405 - 2,610
		30"x12"	2,615 - 2,840
		32"x12"	2,845 - 3,070
		34"x12"	3,075 - 3,290
		36"x12"	3,295 - 3,520
		36"x14"	3,525 - 4,420

DIFFUSER, REGISTER, AND GRILLE SCHEDULE

TAG	SERVICE	TYPE	MATERIAL	THROW	FACE	NECK	MOUNTING	MANUFACTURER/MODEL	Notes
SD-1	SUPPLY	LOUVERED	STEEL	4-WAY	24X24	SEE PLAN	LAY-IN	RAYMON PRO2	2, 4
SD-2 - NOT USED									
SD-3	SUPPLY	LOUVERED	STEEL	3-WAY	12X12	SEE PLAN	SURFACE	RAYMON PRO2/QMF/DAG	2, 4
SD-4	SUPPLY	LOUVERED	STEEL	4-WAY	12X12	SEE PLAN	SURFACE	RAYMON PRO2/QMF	2, 4
SD-5	SUPPLY	PERFORATED	STEEL	PERFORATED	24X24	SEE PLAN	LAY-IN	RAYMON RPR	2, 4
RG-1	RETURN	SQUARE EGGRATE	ALUMINUM	N/A	24X24	22x22	LAY-IN	RAYMON FGEC-TB1	2, 3, 4
EG-1	EXHAUST	LOUVERED GRILLE	ALUMINUM	N/A	12X12	SEE PLAN	SURFACE	RAYMON RA-RVD	1, 2, 4
TG-1	TRANSFER	LOUVERED GRILLE	ALUMINUM	N/A	SEE PLAN	SEE PLAN	SURFACE	RAYMON RA-RH	2, 4
DIFFUSER NOTES:									
1. PROVIDE w/ ADJUSTABLE OPPOSED BLADE DAMPER									
2. VERIFY ALL DIFFUSERS AND RETURN GRILLE COLORS WITH OWNER AND ARCHITECT									
3. PROVIDE w/ 22X22 PLENUM BOX.									
4. ALL DIFFUSERS AND RETURNS LOCATED IN BLACK CEILING SHALL BE FLAT BLACK FINISH.									

HOOD INFORMATION																	
HOOD NO.	MARK	MODEL	HOOD DIMENSIONS (IN.)			HOOD CONSTR.	COOKING LOAD / DUTY RATING	EXHAUST					SUPPLY		HANGING WEIGHT LBS.	SECTION LOCATION	
			LENGTH	WIDTH	HEIGHT			TOTAL CFM	COLLAR(S)			MUA CFM	AC CFM				
1	GRIDDLE HOOD	XXEC-64-S	64	TOP 30 BOT 20	FRT 6 BACK 24	430 SS WHERE EXPOSED	MEDIUM	1500			12	1500	1.092			126	SINGLE

HOOD INFORMATION																	
HOOD NO.	MARK	LIGHTING DETAILS			GREASE FILTRATION DETAILS			UTILITY CABINET(S)									
		FIXTURE TYPE BULB / LAMP INFO	QTY	FOOT CANDLES	TYPE / MODEL MATERIAL	QTY	SIZE (IN.) L H	LOCATION	FIRE SYSTEM		CONTROLS						
1	GRIDDLE HOOD				X-TRACTOR (SPARK ARRESTOR INCL.) STAINLESS STEEL	4	16										
						0	20	16									

HOOD OPTIONS
 UL 710 LISTED W/ OUT EXHAUST FIRE DAMPER - UL #R25625
 BACK INTEGRAL AIR SPACE - 3 IN WIDE
 20 IN HIGH CEILING ENCLOSURES - FRONT LEFT RIGHT - FIELD INSTALLED
 FACTORY MOUNTED EXHAUST COLLAR(S)
 HOOD FRONT IS TAPERED (FOR LOW CEILING APPLICATIONS)
 PERFORMANCE ENHANCING LIP (PEL) TECHNOLOGY
 STANDING SEAM CONSTRUCTION FOR SUPERIOR STRENGTH

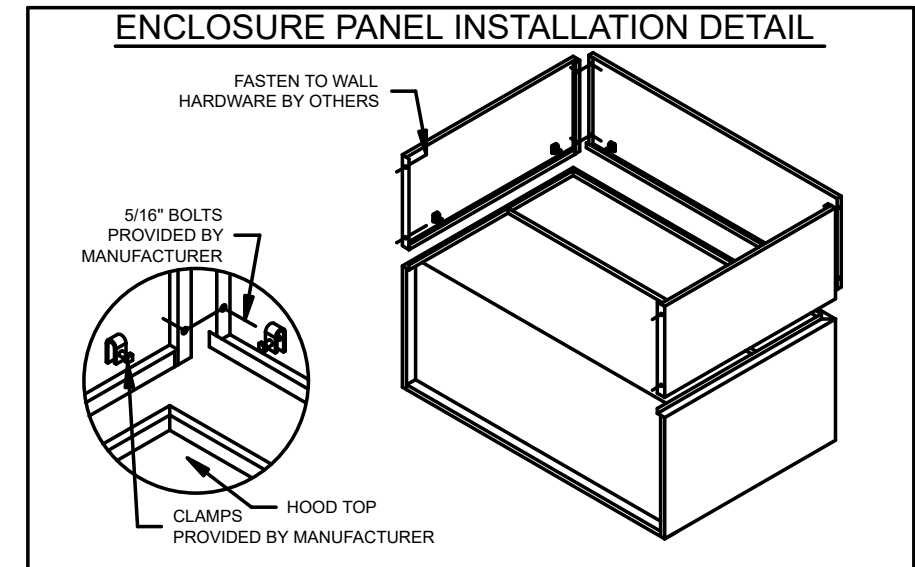

HOOD HANGING HEIGHT FOR FIRE SYSTEMS
 VERIFICATION OF HOOD HANGING HEIGHT ABOVE FINISHED FLOOR (A.F.F.) IS REQUIRED FOR CORRECT PLACEMENT OF FIRE SYSTEM NOZZLES.

RECOMMENDED HANGING HEIGHT = 70" FROM FINISHED FLOOR TO LOWER FRONT EDGE OF HOOD.

OTHER HANGING HEIGHT = _____" FROM FINISHED FLOOR TO LOWER EDGE OF HOOD.

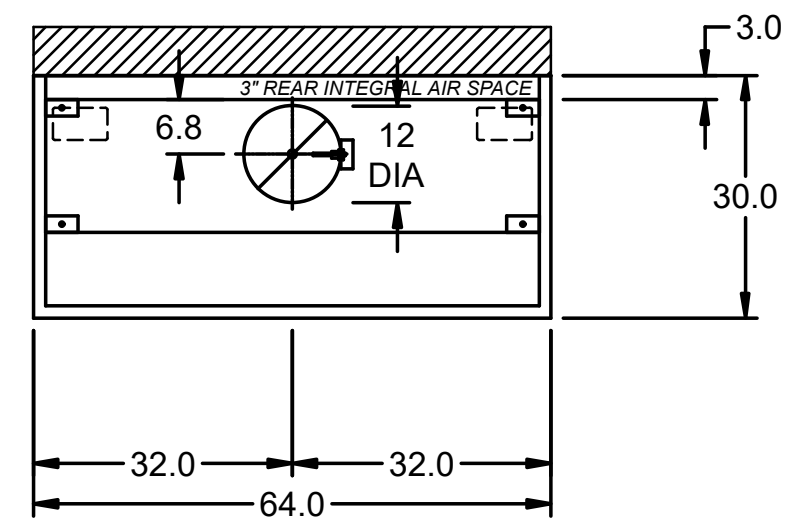
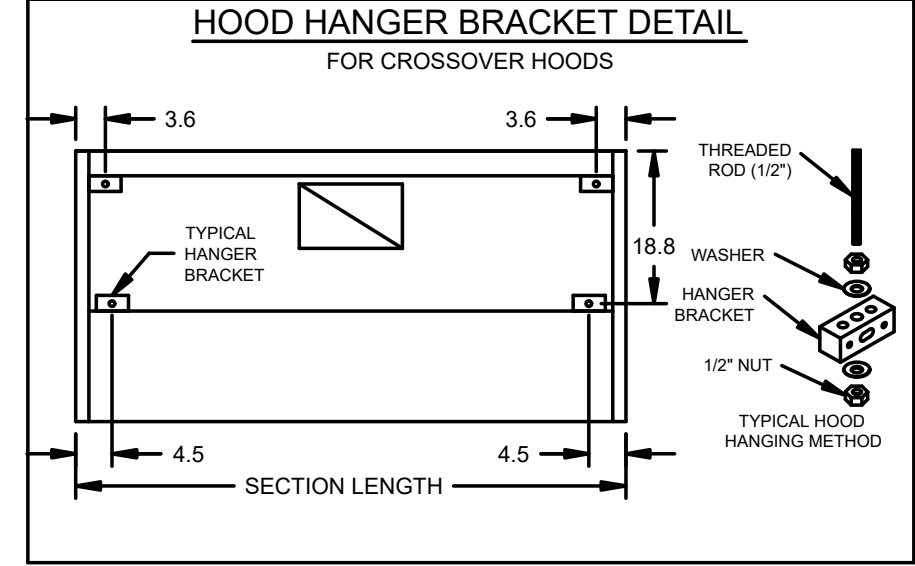

MARK: Griddle Hood - SECTION 1
PLAN VIEW

FIRE (PIPING/DROPS/NOZZLES/ETC.)
 SUBJECT TO CHANGE. AS-BUILT
 DRAWINGS CAN BE PROVIDED AT
 TIME OF ORDER AND INCLUDED
 WITH PRODUCT SHIPMENT

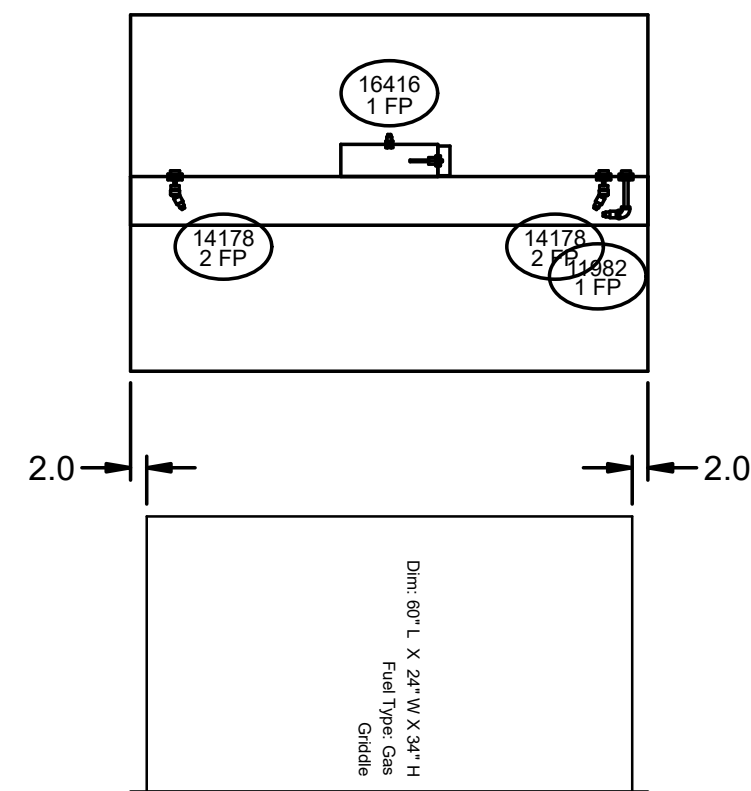

MARK: Griddle Hood - SECTION 1
ELEVATION VIEW

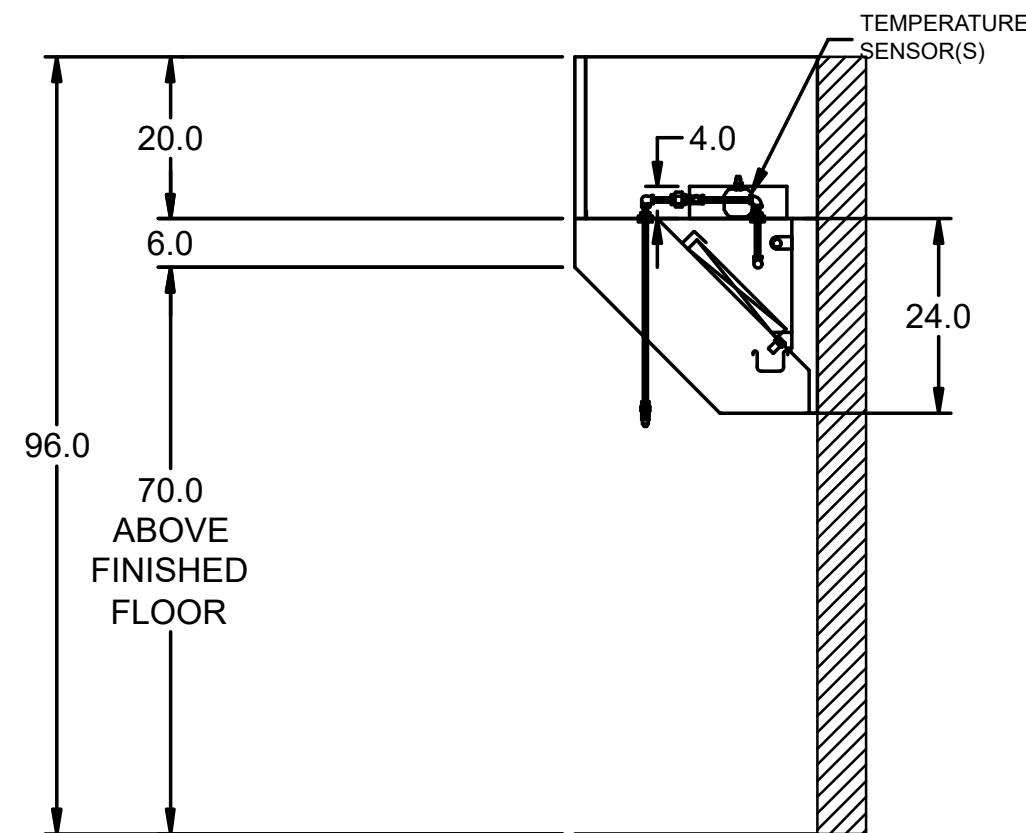

MARK: Griddle Hood
SECTION VIEW

UL NSF
 LISTED
 COMMERCIAL KITCHEN EQUIPMENT

CULVERS METRO L
 CROSSOVER

GRIDDLE HOOD

PROJECT/ 11/12/2025
 MARK

ACCUREX W/IA
 PHILLIP KRAFT
 PHILLIP.KRAFT@ACCUREX.COM
 (262)227-7865

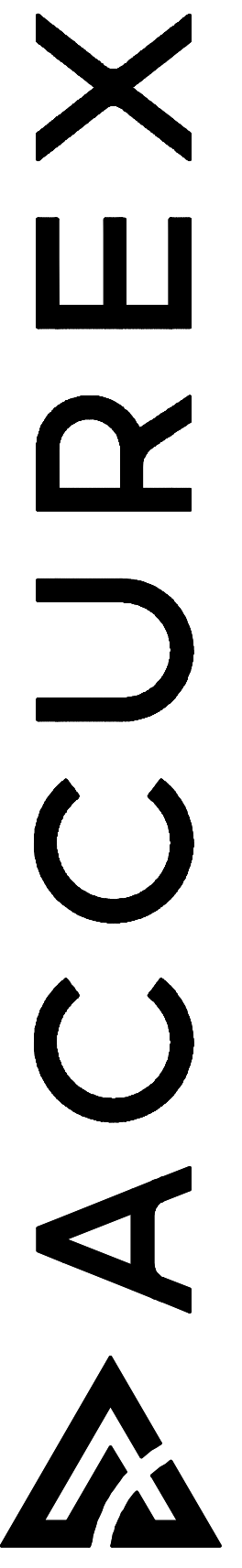

HOOD INFORMATION

HOOD NO.	MARK	MODEL	HOOD DIMENSIONS (IN.)			HOOD CONSTR.	COOKING LOAD / DUTY RATING	TOTAL CFM	EXHAUST COLLAR(S)				SUPPLY		HANGING WEIGHT LBS.	SECTION LOCATION	
			LENGTH	WIDTH	HEIGHT				WIDTH	LENGTH	DIA.	CFM	S.P.	MUA CFM			AC CFM
1	FRYER HOOD	XXEC-83-S	83	TOP 30 BOT 20	FRT 6 BACK 24	430 SS WHERE EXPOSED	MEDIUM	1500			12	1500	0.856			153	SINGLE

HOOD INFORMATION

HOOD NO.	MARK	LIGHTING DETAILS			GREASE FILTRATION DETAILS			UTILITY CABINET(S)					
		FIXTURE TYPE BULB / LAMP INFO	QTY	FOOT CANDLES	TYPE / MODEL MATERIAL	QTY	SIZE (IN.) L H	LOCATION	FIRE SYSTEM		CONTROLS		
1	FRYER HOOD				X-TRACTOR (SPARK ARRESTOR INCL.) STAINLESS STEEL	5 0	16 20	16		TYPE	SIZE	MODEL	INTERFACE

HOOD OPTIONS

UL 710 LISTED W/ OUT EXHAUST FIRE DAMPER - UL #R25625
 BACK INTEGRAL AIR SPACE - 3 IN WIDE
 20 IN HIGH CEILING ENCLOSURES - FRONT LEFT RIGHT - FIELD INSTALLED
 FACTORY MOUNTED EXHAUST COLLAR(S)
 HOOD FRONT IS TAPERED (FOR LOW CEILING APPLICATIONS)
 PERFORMANCE ENHANCING LIP (PEL) TECHNOLOGY
 STANDING SEAM CONSTRUCTION FOR SUPERIOR STRENGTH

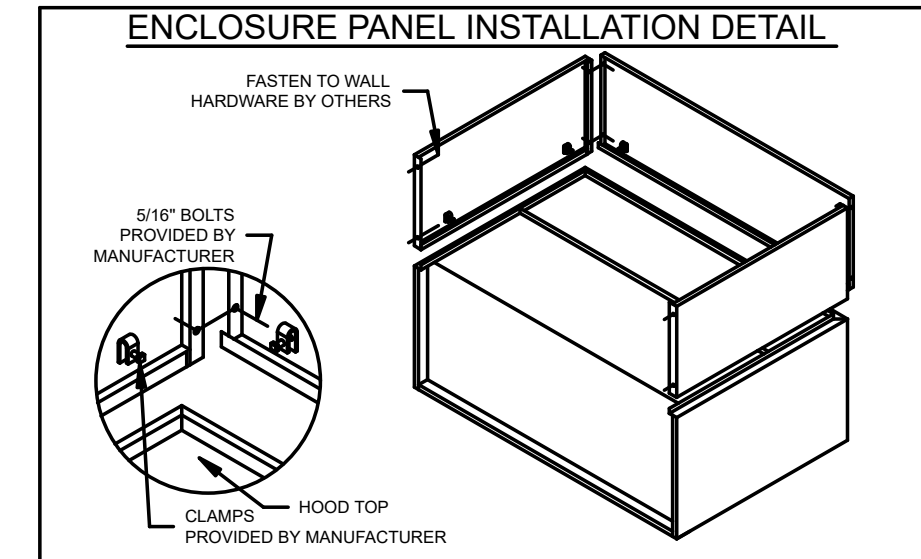

HOOD HANGING HEIGHT FOR FIRE SYSTEMS
 VERIFICATION OF HOOD HANGING HEIGHT ABOVE FINISHED FLOOR (A.F.F.) IS REQUIRED FOR CORRECT PLACEMENT OF FIRE SYSTEM NOZZLES.

RECOMMENDED HANGING HEIGHT = 70" FROM FINISHED FLOOR TO LOWER FRONT EDGE OF HOOD.

OTHER HANGING HEIGHT = _____" FROM FINISHED FLOOR TO LOWER EDGE OF HOOD.

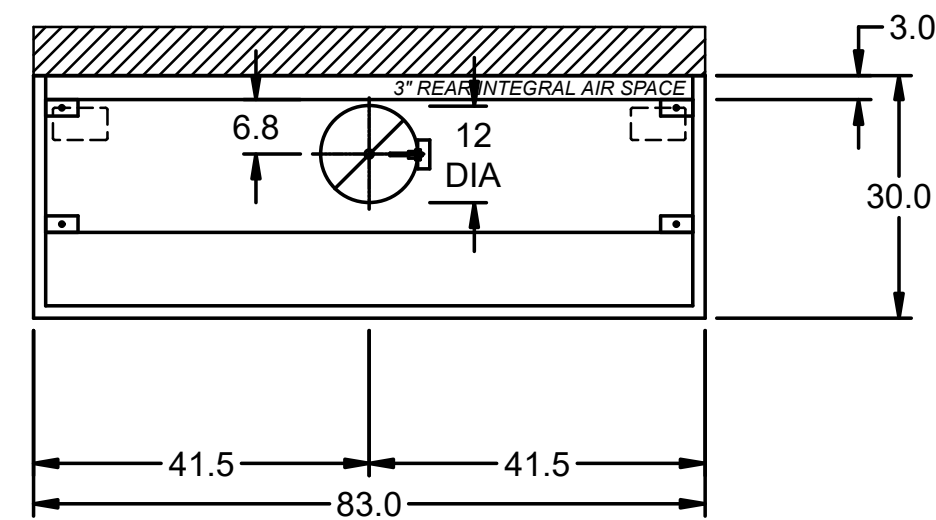
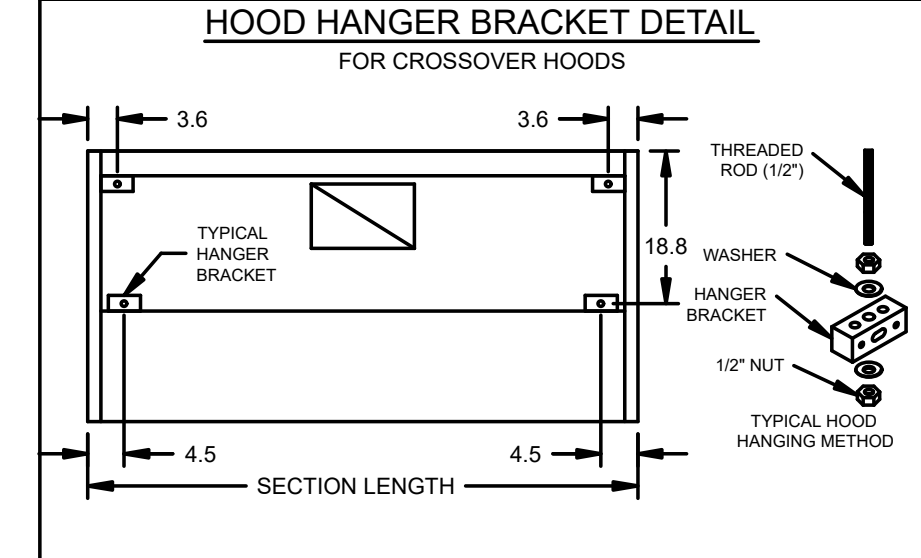

MARK: Fryer Hood - SECTION 1
PLAN VIEW

FIRE (PIPING/DROPS/NOZZLES/ETC.)
 SUBJECT TO CHANGE. AS-BUILT
 DRAWINGS CAN BE PROVIDED AT
 TIME OF ORDER AND INCLUDED
 WITH PRODUCT SHIPMENT

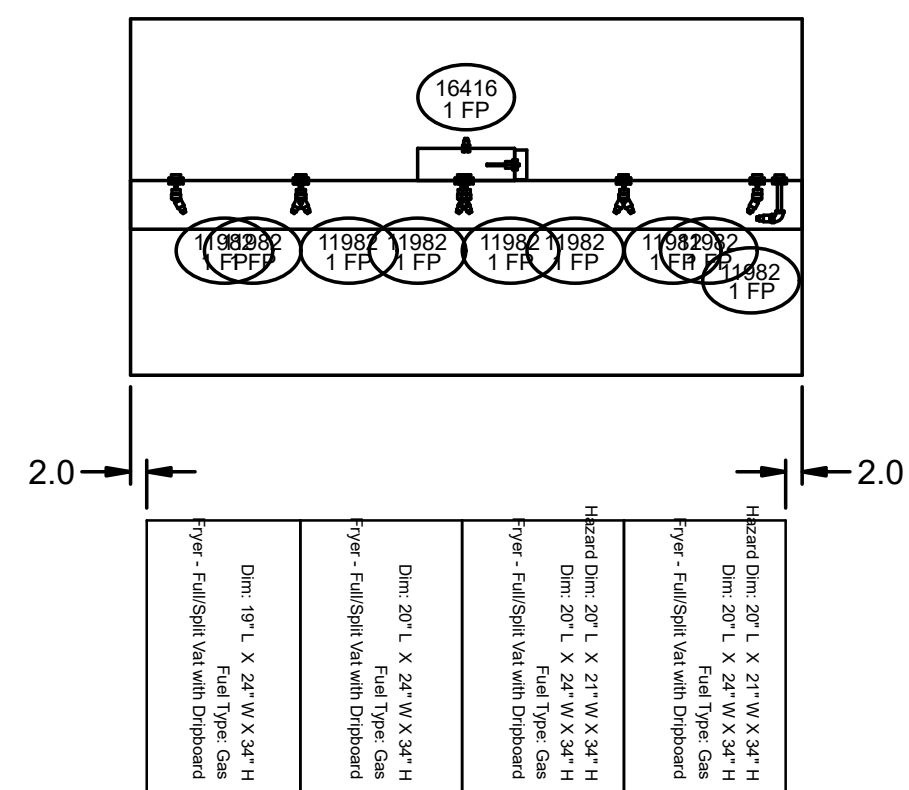

MARK: Fryer Hood - SECTION 1
ELEVATION VIEW

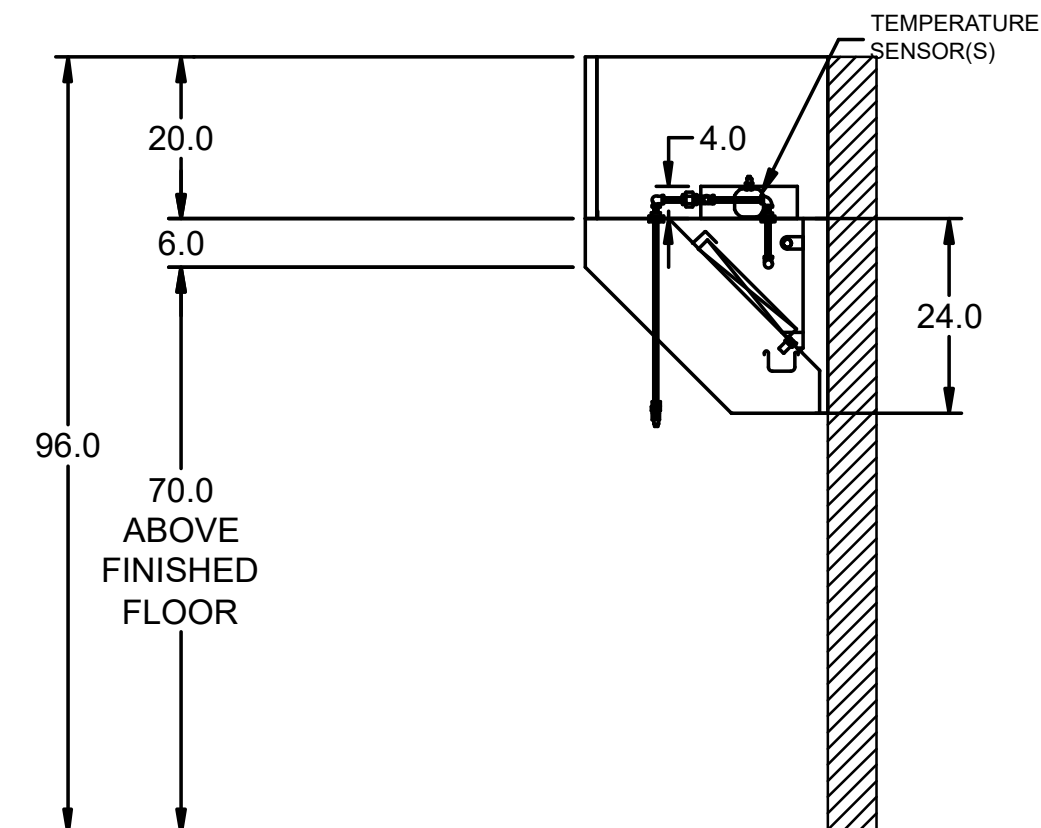

MARK: Fryer Hood
SECTION VIEW

UL NSF
 LISTED
 COMMERCIAL KITCHEN EQUIPMENT

CULVERS METRO L
 CROSSOVER

FRYER HOOD

PROJECT
 11/12/2025

MARK

ACCUREX W/IA
 PHILLIP KRAFT
 PHILLIP.KRAFT@ACCUREX.COM
 (262)227-7865

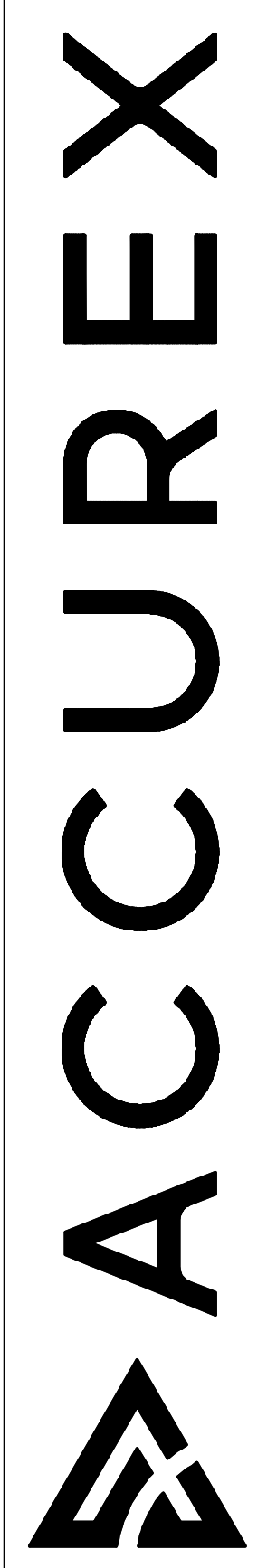

FIRE SYSTEM INFORMATION

MARK	MODEL	LOCATION	FLOW POINTS		SUPPLY LINE	DETECTION	MARK(S) PROTECTED BY FIRE SYSTEM
			HOODS	PCU			
FIRE SUPPRESSION	AMEREX KP WET CHEMICAL	REMOTE MOUNTED	16 UTILIZED 22 AVAILABLE		CONTINUOUS	FUSIBLE LINK	FRYER HOOD SECTION 1 GRIDDLE HOOD SECTION 1

FIRE SYSTEM OPTIONS AND ACCESSORIES

FULL INSTALLATION (INCLUDES PRE-PIPED HOOD(S) WITH DETECTION AND FACTORY COORDINATED INSTALL)
 CHROME SLEEVES FOR FACTORY PROVIDED APPLIANCES DROPS - INCLUDED
 METAL BLOW-OFF CAPS - INCLUDED
 GAS VALVE - INCLUDED - MECHANICAL SHUTOFF VALVE, 1.50" (AMEREX) - PART# 468829
 HOOD SUPPRESSION TANK - INCLUDED - 7.5 GAL. - [(2) 3.75 TANK(S)]
 REMOTE PULL STATION - MULTIPLE - FIELD INSTALLATION AT TWO POINTS OF EGRESS
 SINGLE ENCLOSURE FOR RELEASE & FIRST TANK FOR REMOTE MOUNTING - INCLUDED
 TANK ENCLOSURES (STAINLESS STEEL) FOR REMOTE MOUNTING - INCLUDED

AMEREX KP (WET CHEMICAL) FIRE PROTECTION SYSTEM - MODEL FSSK

CONTROL PANEL

NOTES:

WET CHEMICAL FIRE PROTECTION SYSTEM TO BE AMEREX KP, DESIGNED IN COMPLIANCE WITH UL 300 REQUIREMENTS.
 -VERIFICATION OF ALL COOKING EQUIPMENT MAKE, MODEL AND LOCATION REQUIRED FOR ALL FIRE PROTECTION SYSTEMS.
 -ALL FIRE SYSTEM PIPING IS STANDARDLY TO THE RIGHT END OF THE HOOD UNLESS A WALL IS LOCATED ON THE RIGHT END.
 -AMEREX MRM/PRM TO BE LOCATED WITHIN 60" OF HOOD.

THE BASIC FIRE SYSTEM WILL INCLUDE THE FOLLOWING:
 -GAS SHUT-OFF VALVE, IF REQUIRED, TO BE SUPPLIED BY MANUFACTURER (UP TO 2" DIAMETER AS STANDARD), AND INSTALLED BY A LICENSED PLUMBER
 -MICRO SWITCH TO BE SUPPLIED BY MANUFACTURER FOR CONNECTION TO, BUT NOT LIMITED TO, BUILDING ALARM SYSTEM(S), EXHAUST AND SUPPLY FANS AND ELECTRICAL POWER SHUT DOWN. FIELD WIRING AND CONNECTIONS TO BE PERFORMED BY A LICENSED ELECTRICIAN.
 -THREE TRIPS TO THE JOBSITE
 -ANY STATE OR LOCAL INSTALLATION PERMITS.

THE BASIC FIRE SYSTEM DOES NOT INCLUDE THE FOLLOWING:
 -FULL DUMP TEST OTHER THAN WHAT IS SPECIFIED PER THE INSTALLATION MANUAL OR TO SATISFY A STATE OR LOCAL CODE.
 -MORE THAN THREE TRIPS TO THE JOBSITE OR SPECIAL TRANSPORTATION, OR OVERNIGHT LODGING REQUIREMENTS IN REMOTE AREAS. NORMAL TRAVEL DISTANCE IS FIRST 50 MI. (80.5 KM) FROM OFFICE.
 -SPECIAL CLASSES OR ADDITIONAL LABOR FOR ACCESS TO SECURITY SENSITIVE AREAS.
 -INSTALLATION OF GAS SHUT-OFF VALVE.
 -SPECIAL DRAWINGS REQUIRED TO SATISFY STATE OR LOCAL CODE.
 -UNION LABOR, GOVERNMENT LABOR, OR PREVAILING WAGES REQUIRED FOR FINAL FIELD HOOK-UP
 -ANY AND ALL ELECTRICAL COMPONENTS/CONNECTIONS REQUIRED TO SHUT DOWN FANS, SHUT OFF DEVICE FOR ELECTRIC COOKING EQUIPMENT (SHUNT TRIP BREAKER), OR ACTIVATE AN ALARM SYSTEM, ETC.
 -ANY DISMANTLING OR REASSEMBLY REQUIRED TO GAIN ACCESS TO THE FIRE SUPPRESSION PIPING LOCATED ON THE TOP OF THE HOOD.
 -PLAN EXAMINATION FEES, PE OR FPS APPROVAL STAMP
 -ROUGH-IN CONDUIT FOR REMOTE PULL STATION OR GAS VALVE (FOR FLUSH MOUNTED PULL STATION).
 -INSTALLATION OF MORE THAN (1) REMOTE PULL STATIONS OR DISTANCES GREATER THAN 20 FT. (6.1M).
 -PARTS OR LABOR REQUIRED TO CORRECT PIPING DUE TO COOKING EQUIPMENT CHANGES OR DEVIATION FROM PLANS. OR ANY CHARGES FOR MISSING OR ADDITIONAL PARTS OTHER THEN THOSE INDICATED ON THE FIRE SUPPRESSION DETAIL.

WIRING DIAGRAM FOR MICRO SWITCHES

CONNECTION TO BUILDINGS ALARM

CONNECTION TO KC (PCB) CONTROL PANEL

NOTES:
 1. - - - - - DENOTES FIELD INSTALLATION.
 2. ———— DENOTES FACTORY INSTALLATION.

CONTROL INFORMATION

MARK	MAIN ELECTRICAL CONTROL PACKAGE		MAIN USER INTERFACE		FANS CONTROLLED											
	MODEL	LOCATION	TYPE	LOCATION	FAN #	TYPE	FAN	FAN MARK	ZONE	CFM	MOTOR HP	MOTOR VOLT	CYCLE	MOTOR PHASE	MOTOR STARTER IN PANEL	VFD IN PANEL
CONTROLS	XKC-CV-S-22-2-1-0	SHIP LOOSE ENCLOSURE	FULL COLOR TOUCHSCREEN	SHIP LOOSE	1	EXHAUST	E1	PRV-3 (FRYER FAN)	1	1500	1	150	60	1	NO	NO
					2	EXHAUST	E2	PRV-2 (GRIDDLE FAN)	1	1500	1	115	60	1	NO	NO
					3	SUPPLY	S1	RTU 1 & RTU 2	1	3000	NA	NA	NA	NA	NO	NO

CONTROL FEATURES
 TEMP SENSORS (FACTORY INSTALLED) - QTY. 2
 DRY FIRE CONTACTS - QTY. 3
 EXHAUST MAX DURING FIRE
 SUPPLY OFF DURING FIRE

SPECIAL DESIGN REQUESTS
 SDR #K2000462 - CULVERS CONTROL PANEL - EXTRA SET OF FIRE CONTACTS



DOC NUMBER: ---- REV: ----

CAUTION
 UNIT MUST BE GROUNDED IN ACCORDANCE WITH N.E.C. POWER MUST BE OFF WHILE SERVICING.

ATTENTION
 L'APPAREIL DOIT ÊTRE MIS À LA TERRE CONFORMÉMENT AU CODE C.E. L'ALIMENTATION DOIT ÊTRE COUPÉE DURANT L'ENTRETIEN.

COMMERCIAL APPLIANCE OUTLET CENTER
 ELECTRICAL RATINGS: 110-240V, 1PHASE, 50-60HZ, 15A
 BASE FILE #E200616, ML FILE #E313951

PRG VERSION: V5
 FIELD WIRED (CÂBLÉ À L'USINE)
 FACTORY WIRED (CÂBLÉ À L'USINE)

THESE DRAWINGS SHALL NOT BE REMOVED FROM THIS EQUIPMENT. USE COPPER CONDUCTORS RATED TO 90°C UNLESS SPECIFIED. TORQUE CONTROL & GROUND BLOCKS TO 8 LBS. IN. TORQUE POWER LUGS/SCREWS TO COMPONENT RATINGS LISTED. TORQUE CONTROL BOARD SCREW TERMINALS TO 3.5 LBS. IN. FIELD CONTROL WIRING RESISTANCE SHOULD NOT EXCEED 0.75 OHM. SEE IOM FOR ADDITIONAL INFORMATION, OR CALL FACTORY AT 1-800-371-6858.

NE PAS RETIRER CES DESSINS DE CET ÉQUIPEMENT SAUF INDICATION CONTRAIRE. UTILISER DES CONDUCTEURS EN CUIVRE CLASSÉS 90 °C. SERRER LES BORNES DE COMMANDE ET DE MISE À LA TERRE À 8 LB-PO. SERRER LES COSSÉS/VIS D'ALIMENTATION AUX COUPLES INDICQUÉS POUR LE COMPOSANT. SERRER LES BORNES À VIS DE LA CARTE DE COMMANDE À 3.5 LB-PO. LA RÉSISTANCE DU CÂBLAGE DE COMMANDE LOCAL NE DOIT PAS DÉPASSER 0.75 OHM. POUR PLUS D'INFORMATION, CONSULTER LE MANUEL OU APPELER 1-800-371-6858.

WIRING DIAGRAM CODE: WDC#
 JOB NAME: CULVERS METRO L CROSSOVER
 MODEL: XKC-CV-S-22-2-1-0
 SERIAL NUMBER: WDSN#
 MARK: CONTROLS

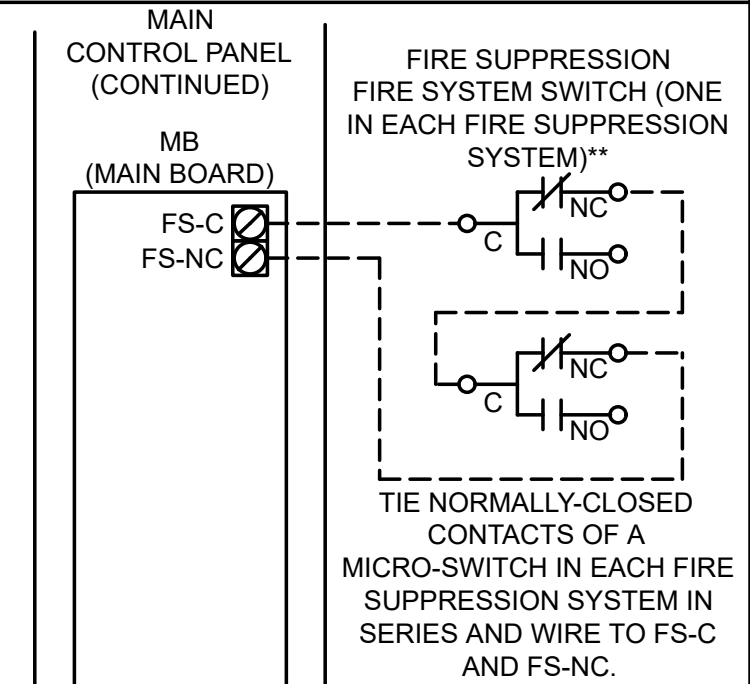
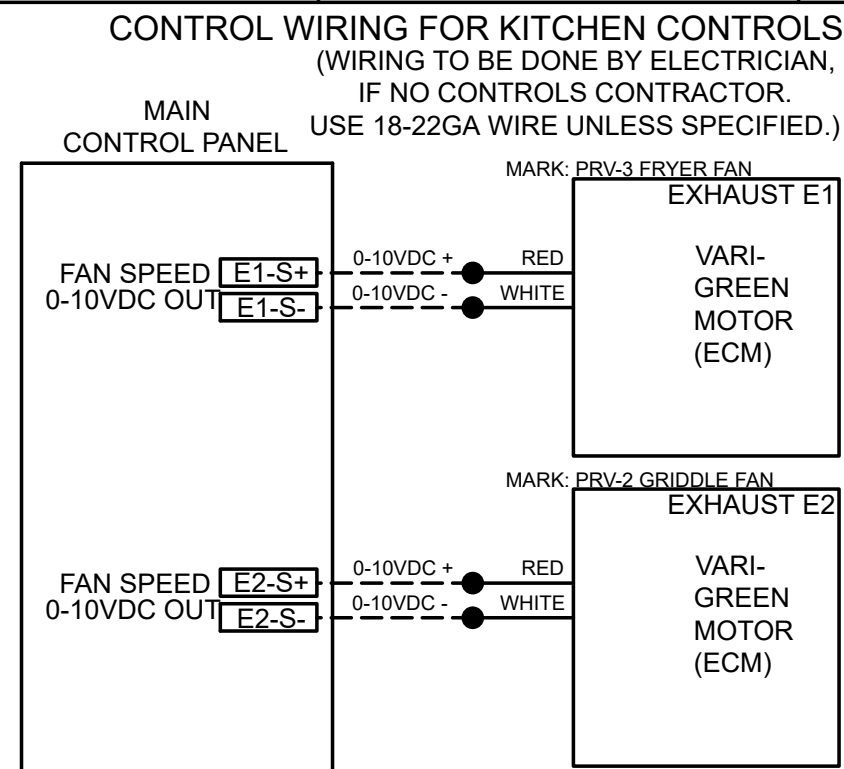
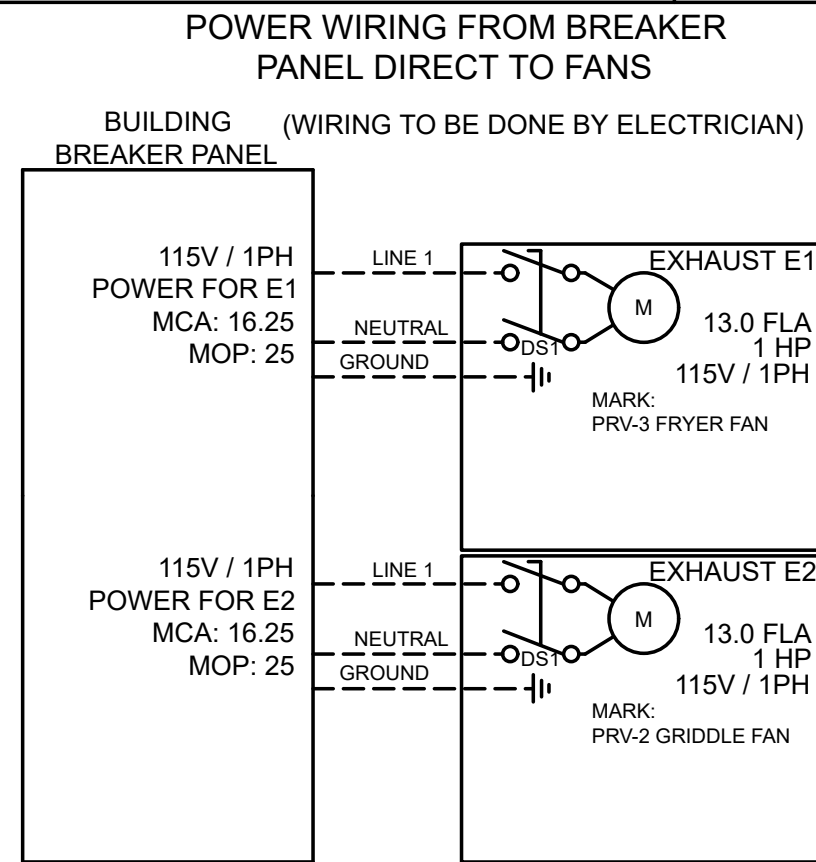
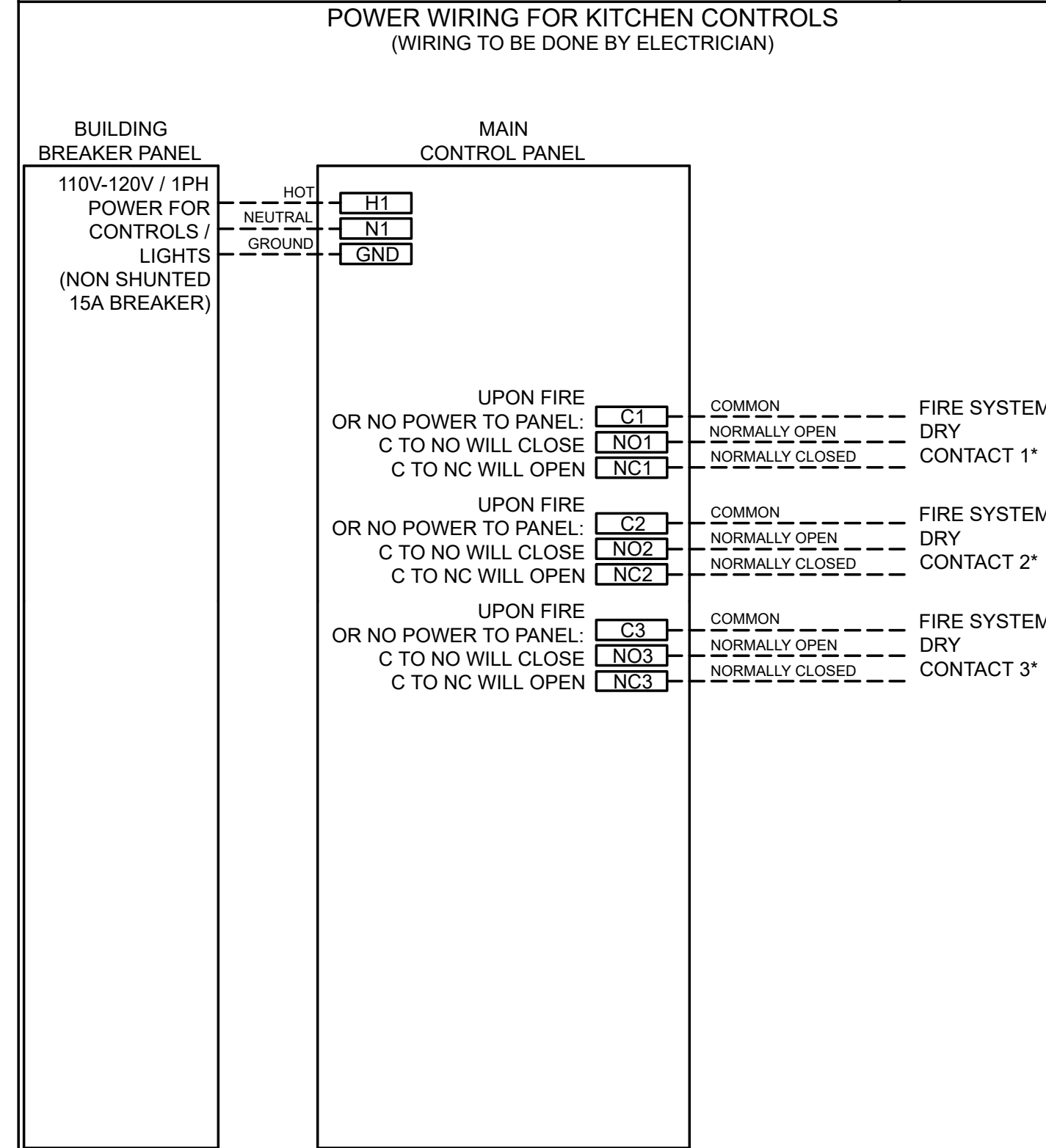

DRY CONTACTS THAT CLOSE WHEN KITCHEN EXHAUST FANS ARE RUNNING. OPTIONAL FOR CONTROLLING RTUS.

WIRE RTU POWER DIRECTLY FROM BUILDING BREAKER PANEL TO RTU DISCONNECTS

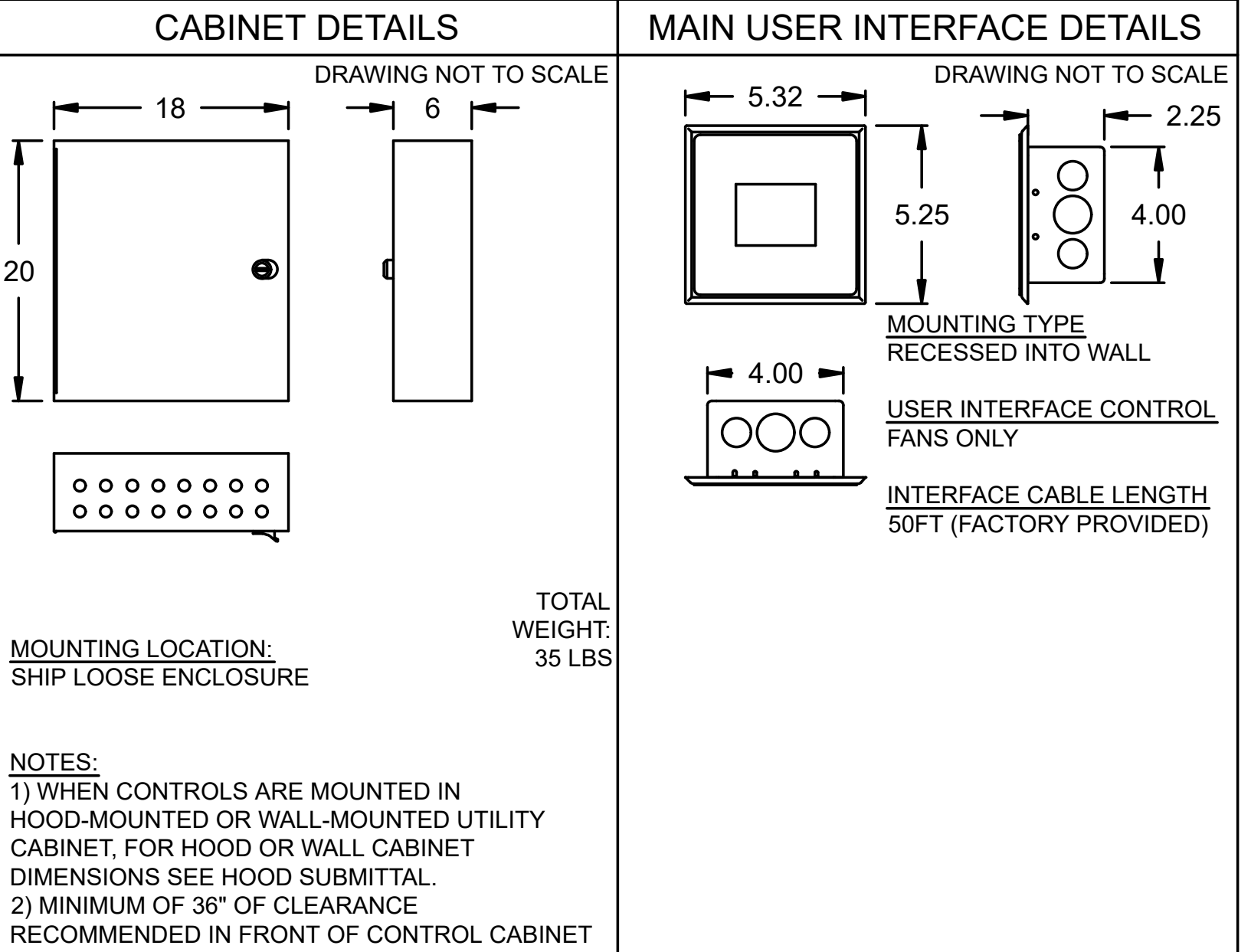
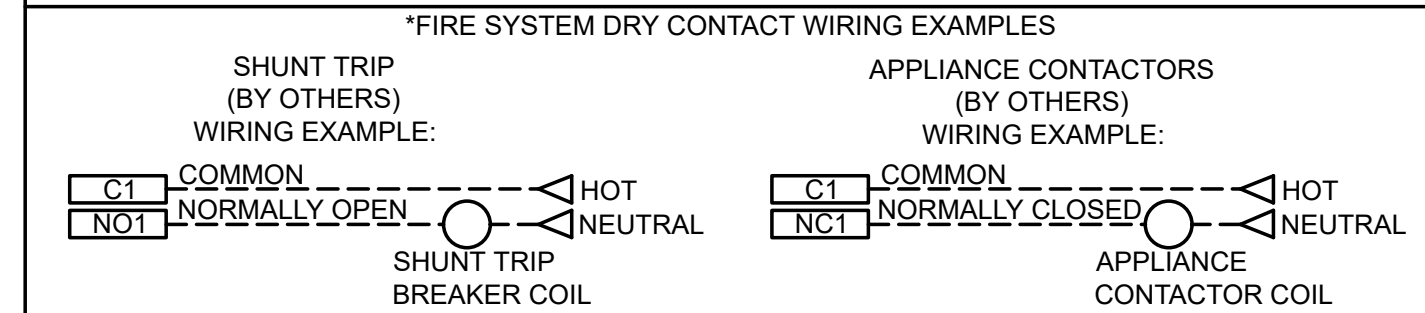

WIRING DIAGRAM CODE: WDC#

JOB NAME: CULVERS METRO L CROSSOVER
 MODEL: XKC-CV-S-22-2-1-0
 SERIAL NUMBER: WDSN#
 MARK: CONTROLS
 DOC NUMBER: ---- REV: ----

ZONE CONFIGURATION

ZONE #	ZONE	ROOM TEMP
1	Z1	PRESET

HOOD CONFIGURATION

HOOD #	HOOD	HOOD MARK	ZONE	EXHAUST	SUPPLY	MB-TEMP SENSORS	HCB
1	H1	FRYER HOOD SECTION 1	Z1	E1	S1	TS1	NO
2	H2	GRIDDLE HOOD SECTION 1	Z1	E2	S1	TS2	NO

DEFAULT SETTINGS / PARAMÈTRES PAR DÉFAUT

FACTORY SETTINGS
 TYPE: CV
 CONFIGURATION: STANDARD
 ZONES: 1
 HOODS: 2
 EXHAUST FANS: 2
 SUPPLY FANS: 1
 MB ROOM SENSOR: NO
 MB TEMP SENSORS: 2
 HIGH TEMP FAULT: NO
 FREEZE PROTECTION: YES
 GAS RESET: NO
 FAN PROVING: NO
 BMS: NONE

ZONE SETTINGS
 SEE ZONE CONFIGURATION IN TABLE ON LEFT

HOOD SETTINGS
 SEE HOOD CONFIGURATION IN TABLE ON LEFT

EXHAUST FAN SETTINGS
 SEE FAN CONFIGURATION IN TABLE ON LEFT

SUPPLY FAN SETTINGS
 SEE FAN CONFIGURATION IN TABLE ON LEFT

SENSOR SETTINGS
 SEE HOOD CONFIGURATION IN TABLE ON LEFT

USER INTERFACE SETTINGS (MB)
 FAN & LIGHT BUTTONS: SHOW FANS ONLY

USER INTERFACE SETTINGS (HCB)
 NA

GENERAL SETTINGS
 TIME ZONE: CENTRAL DAYLIGHT (DEFAULT)

FIRE FAULT SETTINGS
 EXHAUST DURING FIRE: MAX
 SUPPLY DURING FIRE: OFF
 LIGHTS DURING FIRE: OFF

PRG VERSION: V5

FAN CONFIGURATION

FAN #	TYPE	FAN	FAN MARK	ZONE	MIN CFM	MAX CFM	MODBUS VFD	VFD ADDRESS	MIN FREQ	MAX FREQ	MIN VDC	MAX VDC
1	EXHAUST	E1	PRV-3 (FRYER FAN)	Z1	-	1500	NO	-	-	-	-	10.0
2	EXHAUST	E2	PRV-2 (GRIDDLE FAN)	Z1	-	1500	NO	-	-	-	-	10.0
3	SUPPLY	S1	RTU-1 & RTU-2 DRY CONTACTS	Z1	-	3000	NO	-	-	-	-	10.0

Direct Drive Centrifugal Roof Exhaust Fan

MARK INFORMATION		FAN INFORMATION									SOUND INFORMATION				MOTOR INFORMATION									
MARK	QTY	MODEL	DRIVE TYPE	VOLUME (CFM)	EXTERNAL SP (IN. WG)	TOTAL EXTERNAL SP (IN. WG)	FAN SPEED (RPM)	OUTLET VELOCITY (FT/MIN)	FEI	TOTAL WEIGHT (LB)	INLET dBA	INLET SONES	INLET SONES (SPHERICAL)	OUTLET dBA	OUTLET SONES	OPERATING POWER (HP)	MOTOR SIZE (HP)	FEP INPUT POWER (KW)	ENCLOSURE	VOLTAGE	CYCLE	PHASE	EC MOTOR	NEC FLA*
PRV-1 Restroom Fan	1	XRED-090-VG	Direct	375	0.5	0.5	1,448	535.71	0	30.6	52.37	6.69	0	0	0	0.06	0.1	0	TN	115	60	1	VariGreen	NA

*NEC FLA - Based on table 430.250 or 430.248 of National Electrical Code 2020. Actual motor FLA may vary for sizing thermal overload, consult factory"

PRV-1 Restroom Fan : SELECTED OPTIONS AND ACCESSORIES

Curb Cap Size - 17 Square
 UL/cUL 705 Listed - "Power Ventilators"
 Switch, NEMA-1, Toggle,
 Damper Shipped Loose, BD-100-PB-10X10, Gravity Operated, Not Coated, Nominal Size
 Birdscreen: Galvanized, nom. 84% Free Area
 Composite Wheel Material
 Conduit Chase Qty 1

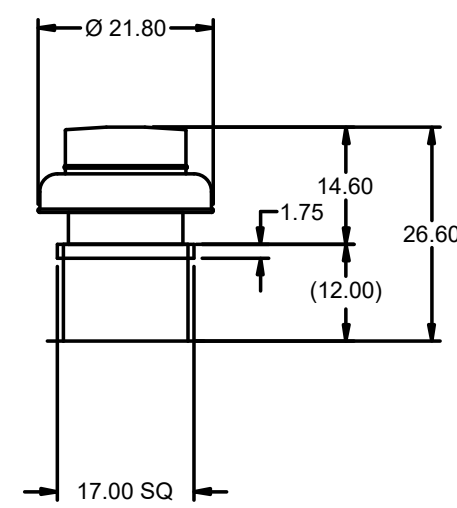
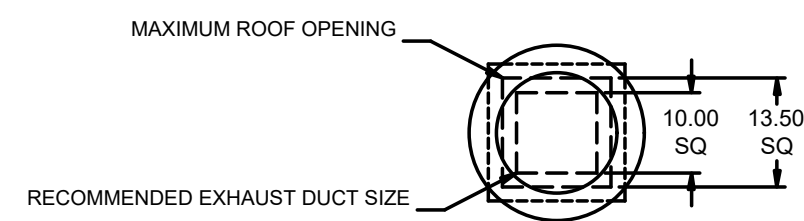

DUCT DIMENSIONS ARE LARGEST POSSIBLE DUCT TO FIT THROUGH CURB.
 CONSULT SYSTEM DESIGN ENGINEER FOR RECOMMENDED DUCT SIZE.

OVERALL HEIGHT MAY BE GREATER DEPENDING ON MOTOR, ADAPTER, AND/OR HINGE BASE.

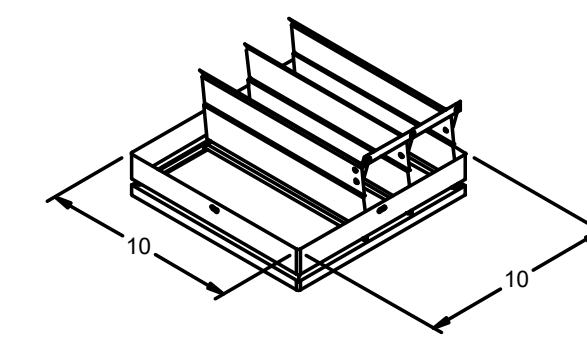

DAMPER

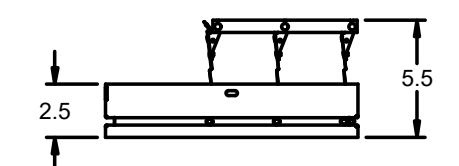

TYP. SECTION VIEW

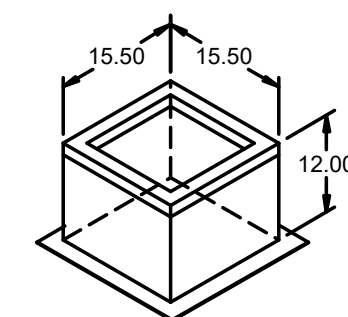

ACCUREX W/IA
 PHILLIP KRAFT
 PHILLIP.KRAFT@ACCUREX.COM
 (262)227-7865

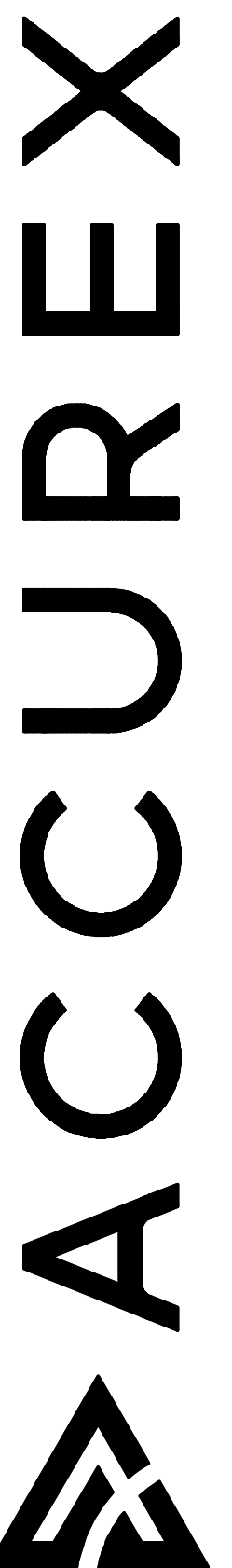

CULVERS METRO L
 CROSSOVER

PRV-1 RESTROOM FAN

PROJECT
 11/12/2025

MARK



Direct Drive Upblast Centrifugal Roof Exhaust Fan

MARK INFORMATION		FAN INFORMATION									SOUND INFORMATION				MOTOR INFORMATION									
MARK	QTY	MODEL	DRIVE TYPE	VOLUME (CFM)	EXTERNAL SP (IN. WG)	TOTAL EXTERNAL SP (IN. WG)	FAN SPEED (RPM)	OUTLET VELOCITY (FT/MIN)	FEI	TOTAL WEIGHT (LB)	INLET dBA	INLET SONES	INLET SONES (SPHERICAL)	OUTLET dBA	OUTLET SONES	OPERATING POWER (HP)	MOTOR SIZE (HP)	FEP INPUT POWER (KW)	ENCLOSURE	VOLTAGE	CYCLE	PHASE	EC MOTOR	NEC FLA*
PRV-2 Griddle Fan	1	XCUE-140-VG	Direct	1,500	1.8	1.8	1,702	872.09	1.34	92	65.45	12.1	0	0	0	0.83	1	0.73	OP	115	60	1	VariGreen	16

*NEC FLA - Based on table 430.250 or 430.248 of National Electrical Code 2020. Actual motor FLA may vary for sizing thermal overload, consult factory"

PRV-2 Griddle Fan : SELECTED OPTIONS AND ACCESSORIES
One piece fully welded windband
Tapered bushing wheel hub
Breather tube outlet area min. 4.4 sq. in. (sizes 99-480), 2.0 sq. in. (sizes 60-95)
Min. windband material thickness: 0.051" aluminum (060-240), 0.064" aluminum (240HP, 240XP), 0.080" aluminum (sizes 300-480)
Curb Cap Size - 26 Square
UL/cUL 705 Listed - Supplement SC - "Power Ventilators for Restaurant Exh. Appliances" (Formerly UL 762)
Switch, NEMA-3R, Toggle,
Hinge, Factory Installed
High Temp Curb Seal Rated for Continuous Duty at 1500 F (Factory Attached)
Grease Trap (PN 475538)
Aluminum Wheel Material

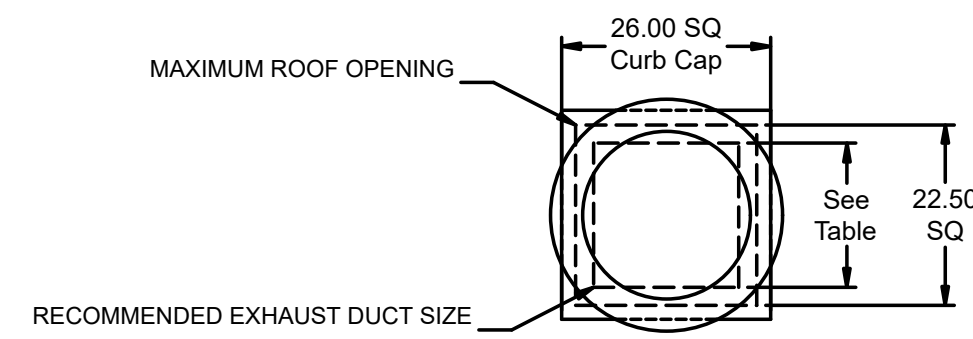

DUCT TYPE	SIZE
STANDARD	18 SQ
FIRE-WRAPPED	12 SQ

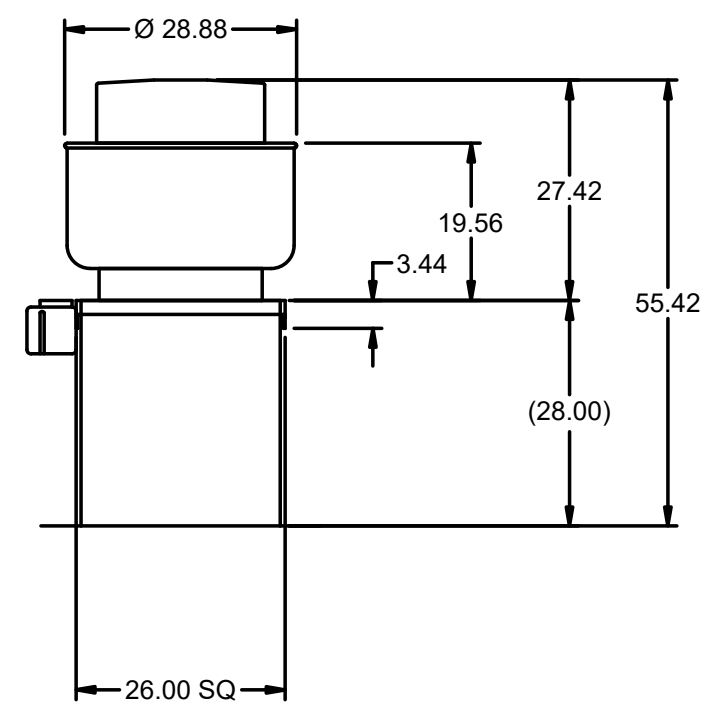
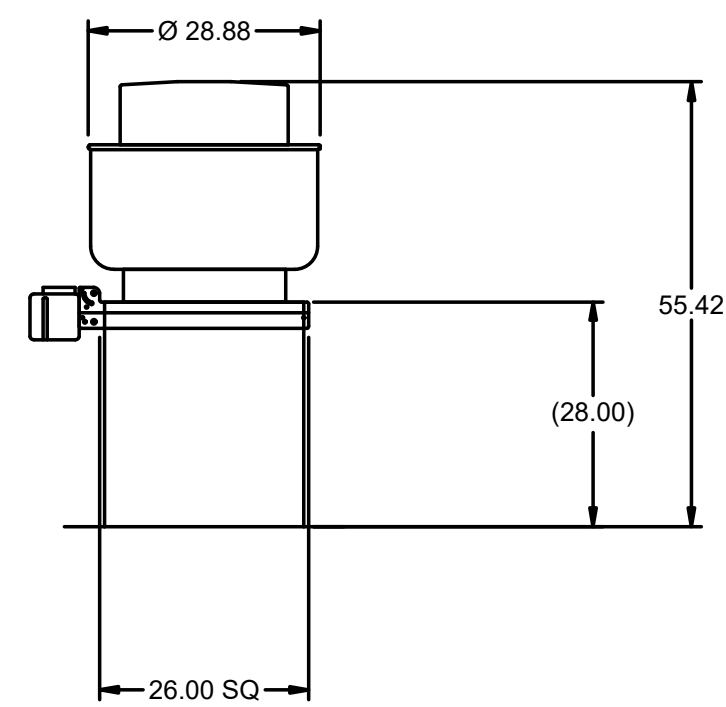

DUCT DIMENSIONS ARE LARGEST POSSIBLE DUCT TO FIT THROUGH CURB. CONSULT SYSTEM DESIGN ENGINEER FOR RECOMMENDED DUCT SIZE.

OVERALL HEIGHT MAY BE GREATER DEPENDING ON MOTOR, ADAPTER, AND/OR HINGE BASE.

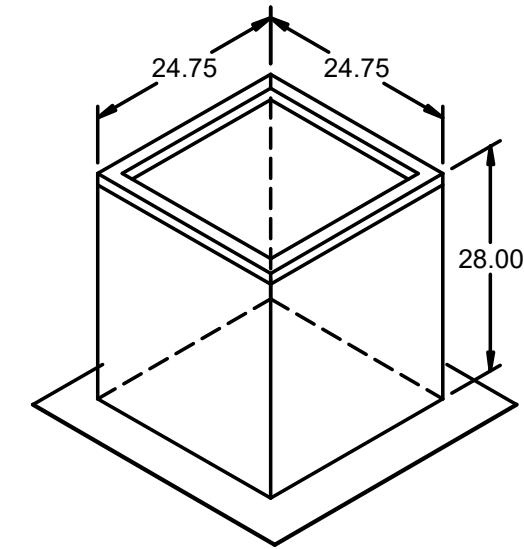

PROJECT
11/12/2025

MARK

CULVERS METRO L CROSSOVER

PRV-2 GRIDDLE FAN

UL NSF
COMMERCIAL ROOF FAN

ACCUREX W/IA
PHILLIP KRAFT
PHILLIP.KRAFT@ACCUREX.COM
(262)227-7865

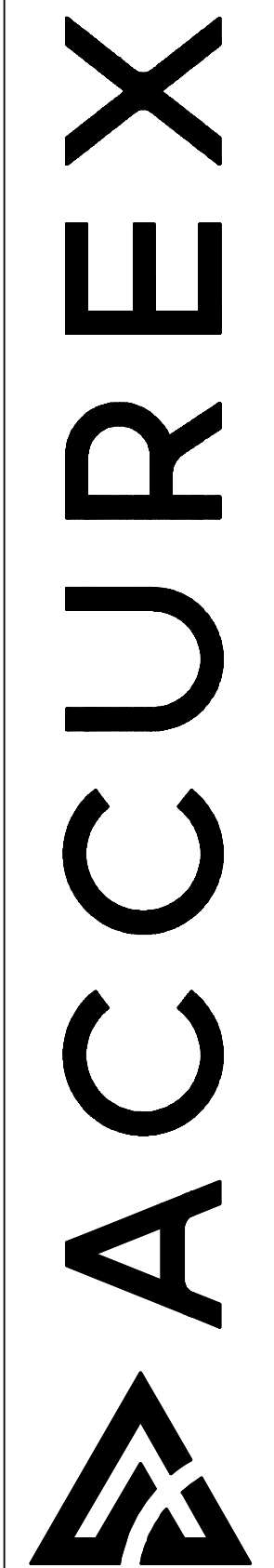

Direct Drive Upblast Centrifugal Roof Exhaust Fan

MARK INFORMATION		FAN INFORMATION									SOUND INFORMATION					MOTOR INFORMATION								
MARK	QTY	MODEL	DRIVE TYPE	VOLUME (CFM)	EXTERNAL SP (IN. WG)	TOTAL EXTERNAL SP (IN. WG)	FAN SPEED (RPM)	OUTLET VELOCITY (FT/MIN)	FEI	TOTAL WEIGHT (LB)	INLET dBA	INLET SONES	INLET SONES (SPHERICAL)	OUTLET dBA	OUTLET SONES	OPERATING POWER (HP)	MOTOR SIZE (HP)	FEP INPUT POWER (KW)	ENCLOSURE	VOLTAGE	CYCLE	PHASE	EC MOTOR	NEC FLA*
PRV-3 Fryer Fan	1	XCUE-140-VG	Direct	1,500	1	1	1,349	872.09	1.62	92	61.1	11.56	0	0	0	0.46	1	0	OP	115	60	1	VariGreen	16

*NEC FLA - Based on table 430.250 or 430.248 of National Electrical Code 2020. Actual motor FLA may vary for sizing thermal overload, consult factory"

PRV-3 Fryer Fan : SELECTED OPTIONS AND ACCESSORIES

One piece fully welded windband
 Tapered bushing wheel hub
 Breather tube outlet area min. 4.4 sq. in. (sizes 99-480), 2.0 sq. in. (sizes 60-95)
 Min. windband material thickness: 0.051" aluminum (060-240), 0.064" aluminum (240HP, 240XP), 0.080" aluminum (sizes 300-480)
 Curb Cap Size - 26 Square
 UL/cUL 705 Listed - Supplement SC - "Power Ventilators for Restaurant Exh. Appliances" (Formerly UL 762)
 Switch, NEMA-3R, Toggle,
 Hinge, Factory Installed
 High Temp Curb Seal Rated for Continuous Duty at 1500 F (Factory Attached)
 Grease Trap (PN 475538)
 Aluminum Wheel Material

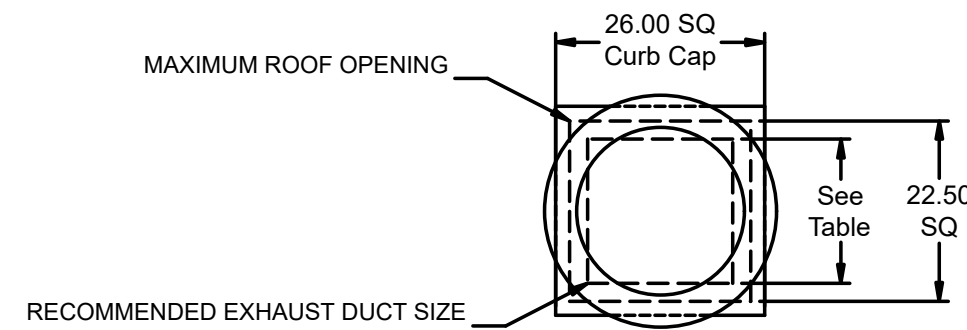

DUCT TYPE	SIZE
STANDARD	18 SQ
FIRE-WRAPPED	12 SQ

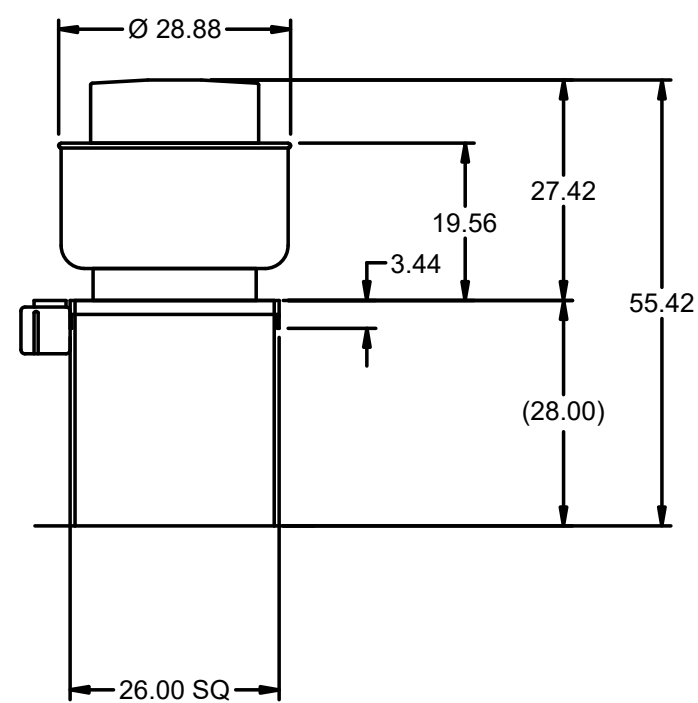
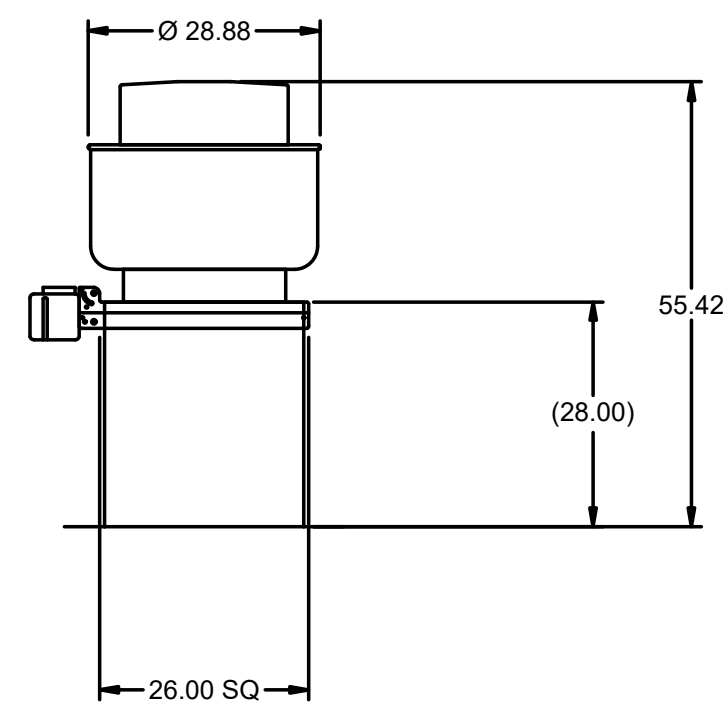

DUCT DIMENSIONS ARE LARGEST POSSIBLE DUCT TO FIT THROUGH CURB. CONSULT SYSTEM DESIGN ENGINEER FOR RECOMMENDED DUCT SIZE.

OVERALL HEIGHT MAY BE GREATER DEPENDING ON MOTOR, ADAPTER, AND/OR HINGE BASE.

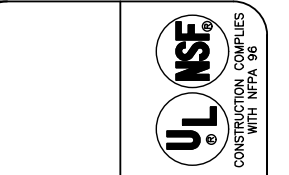
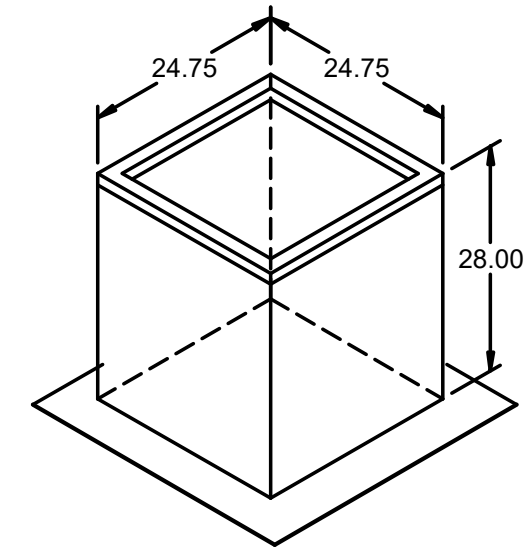

CULVERS METRO L CROSSOVER

PRV-3 FRYER FAN

PROJECT
11/12/2025

MARK

ACCUREX W/IA
 PHILLIP KRAFT
 PHILLIP.KRAFT@ACCUREX.COM
 (262)227-7865

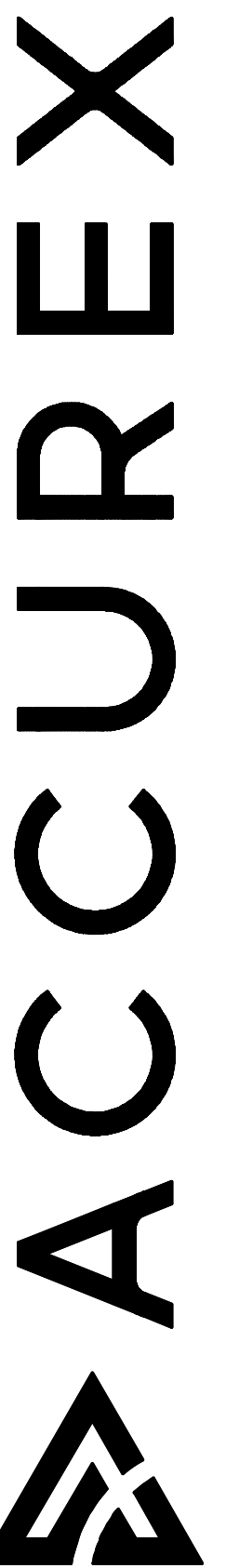

Ceiling Exhaust Fan

MARK INFORMATION		FAN INFORMATION						MOTOR INFORMATION				
QTY	MARK	MODEL	VOLUME (CFM)	TOTAL EXTERNAL SP (IN WG)	FAN RPM	OPERATING POWER (HP)	WEIGHT (LB.)	SIZE (HP)	V/C/P	ENCLOSURE	MOTOR RPM	WINDINGS
2	EF-1A	XCR-B80	75	0.125	881	0.01	10	0	115/60/1	OP	900	1

EF-1A : SELECTED OPTIONS AND ACCESSORIES

UL/cUL 507 Listed - Electric Fan
 Solid State Speed Control, 6 Amp, Mounted and Wired Internally
 Round Hooded Wall Cap, (PN: WC-6) Shipped Loose
 Round Duct Connection
 Adjustable easy installation mounting bracket
 Standard Grille
 Polypropylene Wheel Material
 Can Be Used to Comply with: ASHRAE 62.2 and Washington State Energy Code

EF-1A

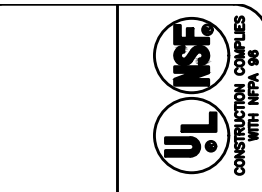
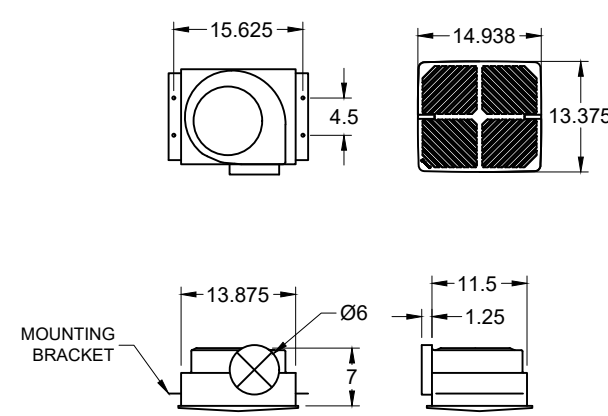

CULVERS METRO L

EF-1A

PROJECT
12/10/2024

MARK

ACCUREX W/IA
 PHILLIP KRAFT
 PHILLIP.KRAFT@ACCUREX.COM
 (262)227-7865

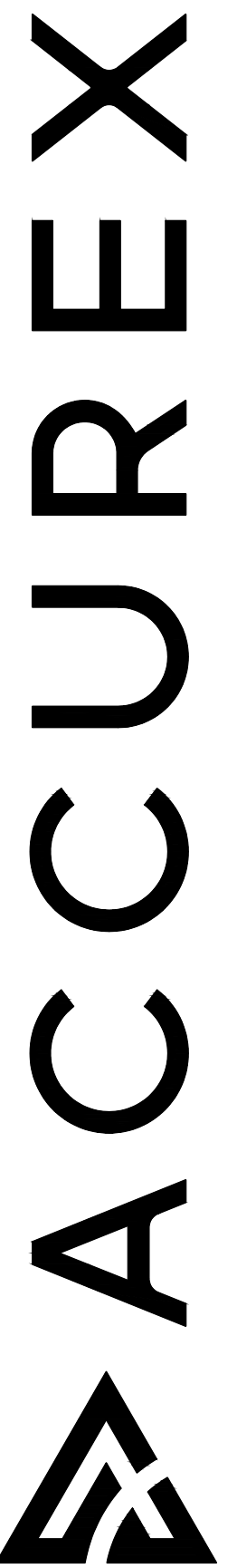

LEGEND

<p> 2 x 2 LAY-IN LIGHT FIXTURE</p> <p> 2 x 4 LAY-IN LIGHT FIXTURE</p> <p> SURFACE MOUNT LIGHT FIXTURE</p> <p> PENDANT FIXTURE</p> <p> RECESSED CAN FIXTURE</p> <p> INTERIOR EMERGENCY EXIT LIGHT AS SHOWN ON LIGHTING PLAN</p> <p> LED STRIP LIGHT</p> <p> ACCENT COVE LIGHTING</p> <p> EXTERIOR LIGHT FIXT. SEE ELEVATIONS FOR MITG HEIGHT</p> <p> EXTERIOR LIGHT FIXT.</p>	<p> EXIT LIGHT</p> <p> WALL SCONCE</p> <p> EXTERIOR CEILING MOUNTED LIGHT</p> <p> EXTERIOR EMERGENCY LIGHT</p> <p> LAY-IN PERFORATED DIFFUSER</p> <p> LAY-IN SUPPLY DIFFUSER</p> <p> LAY-IN RETURN AIR GRILLE OR EXHAUST GRILLE PER MECHANICAL</p> <p> ELECTRIC CEILING HEATER</p> <p> EXTERIOR PATIO PIER LIGHT FIXTURE</p>
--	--

ALL ITEMS MAY NOT BE USED. COORD. w/ MECHANICAL & ELECTRICAL PLANS TO CONFIRM ALL FIXTURES

GENERAL CEILING NOTES:

- DIMENSIONS SHOWN ON THIS PLAN ARE FROM FINISH FACE @ WALLS & BULKHEADS.
- SEE LIGHTING PLAN FOR ELEVATIONS OF PENDANT FIXTURES
- ORANGE PEEL FINISH ON ALL GYP BOARD CEILINGS BULKHEADS THROUGHOUT ALL BACK OF HOUSE TO RECEIVE FRP FINISH ALL SURFACES.
- 9'-6" CEILING IN DINING ROOM MAY NEED TO ALIGN w/ TRUSSES BETWEEN RTU-1 & CUSTOMER SERVICE IN ORDER TO FIT FIXTURES. VERIFY & COORDINATE.

NATIONAL ACCOUNT ITEM PROVIDED & INSTALLED BY GC	
ITEM	SUPPLIER CONTACT INFO
CEILING SYSTEM	USG JOHN FINE'S COMMERCIAL SALES REP. /fines@usg.com 312-401-6579

CEILING FINISH MATERIALS:

CEILING TILE:

TYPE 1 SGS CLG:
 GRID: DOWN DX SYSTEM. COLOR TO MATCH TILE
 TRIM: 4" Compasso, COLOR 002 "Silver Satin"
 TILE: 2 x 2 USG "Frost" "ClimaPlus - SANDSTONE 090, "SLB" Edge

TYPE 2 SGS CLG:
 GRID: DOWN DX SYSTEM. COLOR TO MATCH TILE
 TRIM: 8" Compasso, COLOR 002 "Silver Satin"
 TILE: 2 x 2 USG "Frost" "ClimaPlus - MANILA 246, "SLB" Edge

TYPE 2A SGS CLG:
 GRID: DOWN DX SYSTEM. COLOR TO MATCH TILE
 TILE: 2 x 2 USG "Frost" "ClimaPlus - FLAT BLACK 205, "SLB" Edge

TYPE 3 SGS CLG:
 NOT USED

TYPE 4 SGS CLG:
 GRID: DOWN DXLA SYSTEM - FLAT WHITE
 TILE: 2x4 USG VINYL-FACED GYPSUM #050 WHITE

CEILING PAINT:

Sherwin Williams #7009 "Pearly White"

BULKHEADS

PROVIDE FINISHES AS NOTED ON CEILING & FINISH PLANS.

EXTERIOR SOFFIT PANELS

WHITE

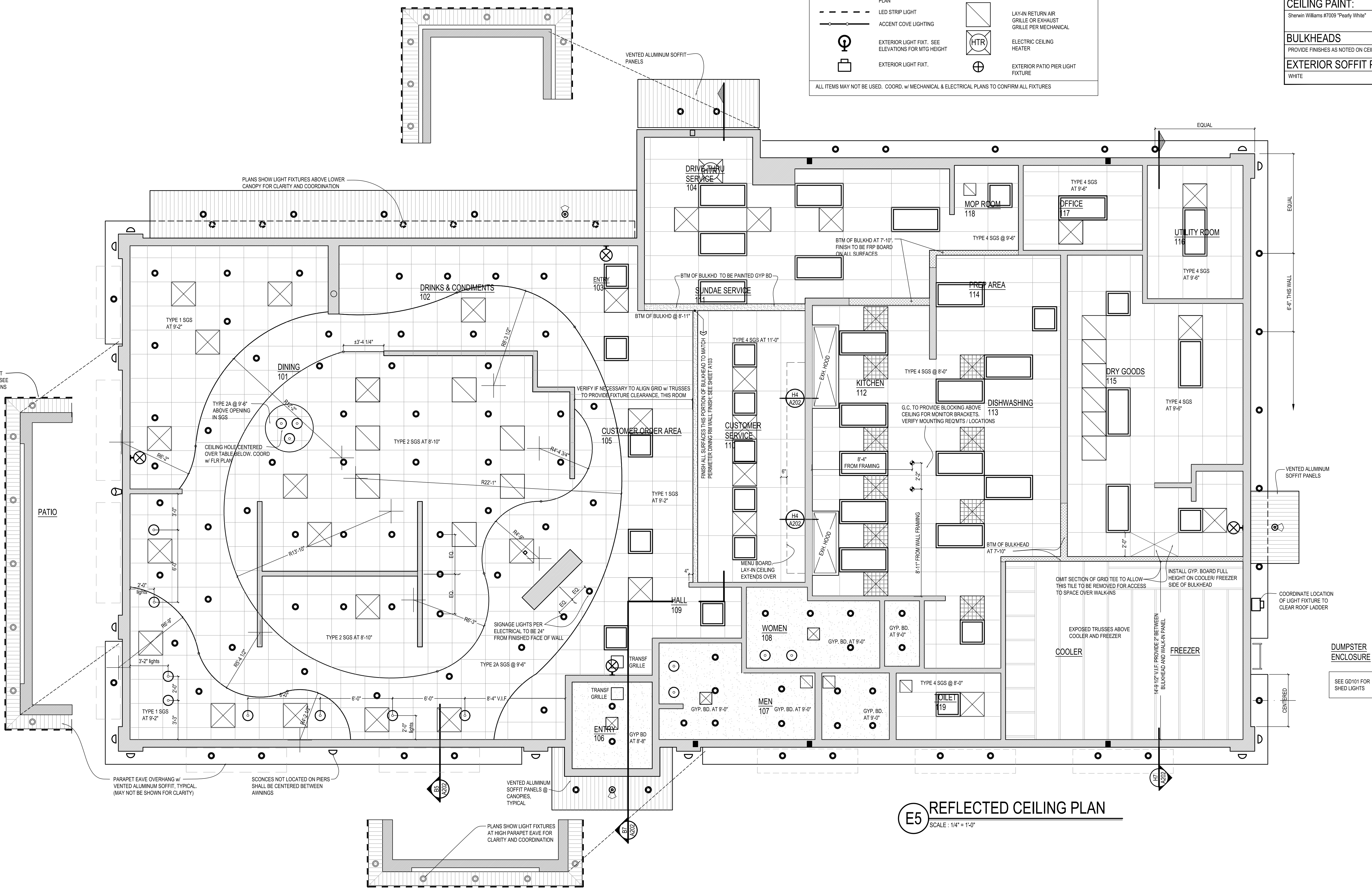

E5 REFLECTED CEILING PLAN
 SCALE: 1/4" = 1'-0"