

GENERAL NOTES:
1. ALL PADS ARE 6" TALL

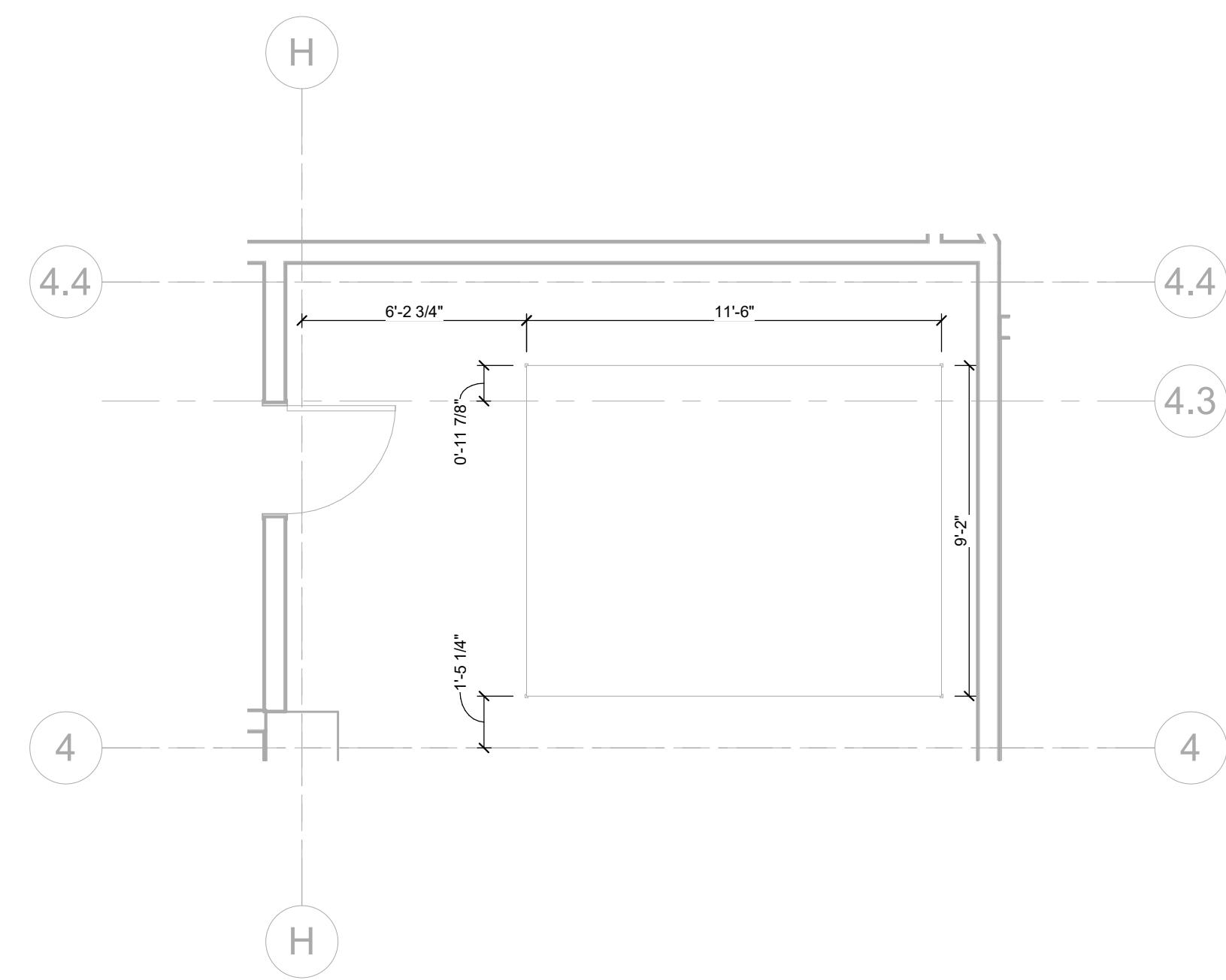

1 Level 1 HVAC PRINT - B1 - EQUIPMENT PAD
1/4" = 1'-0"

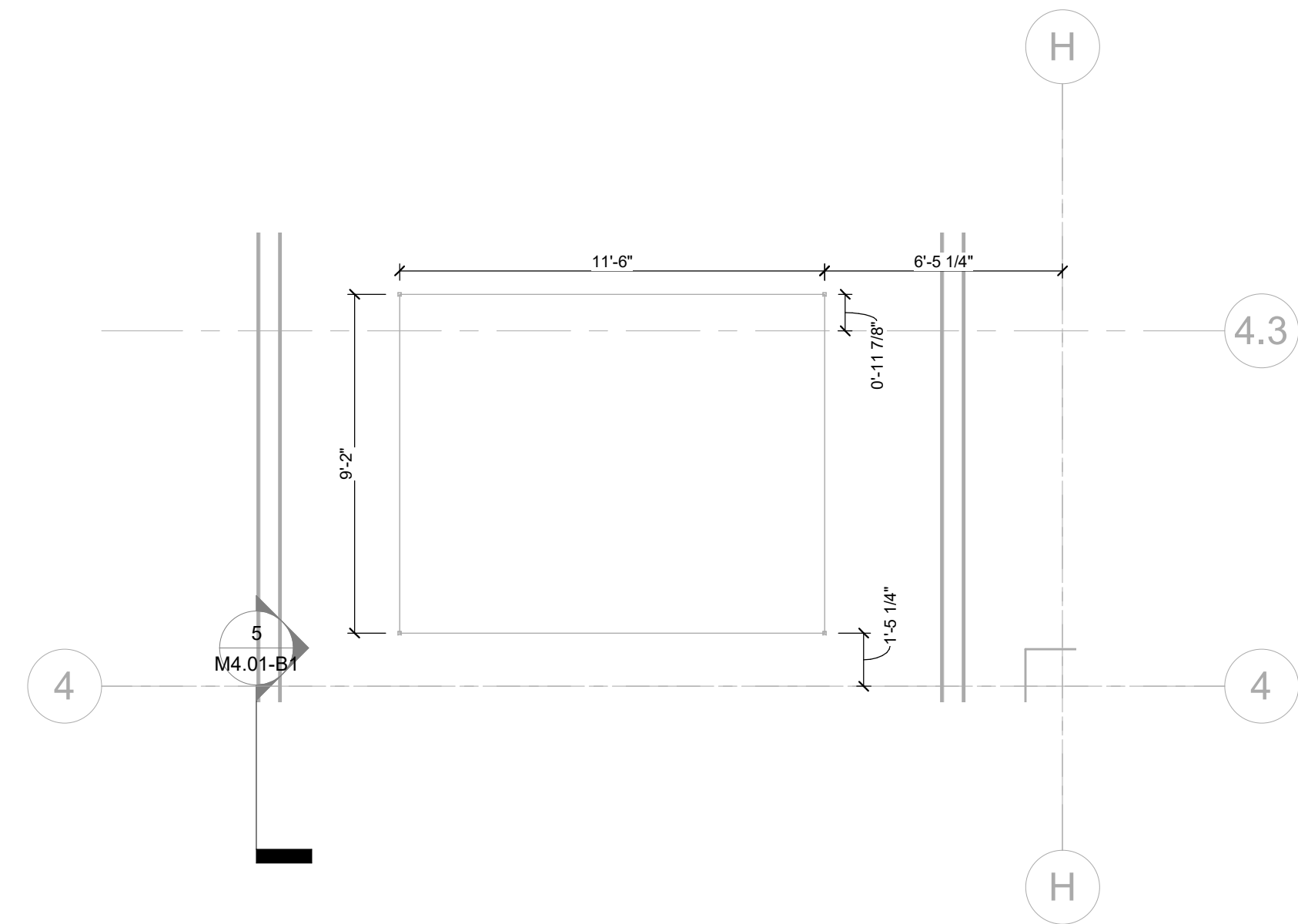

2 Level 2 HVAC PRINT - B1 - EQUIPMENT PAD
1/4" = 1'-0"

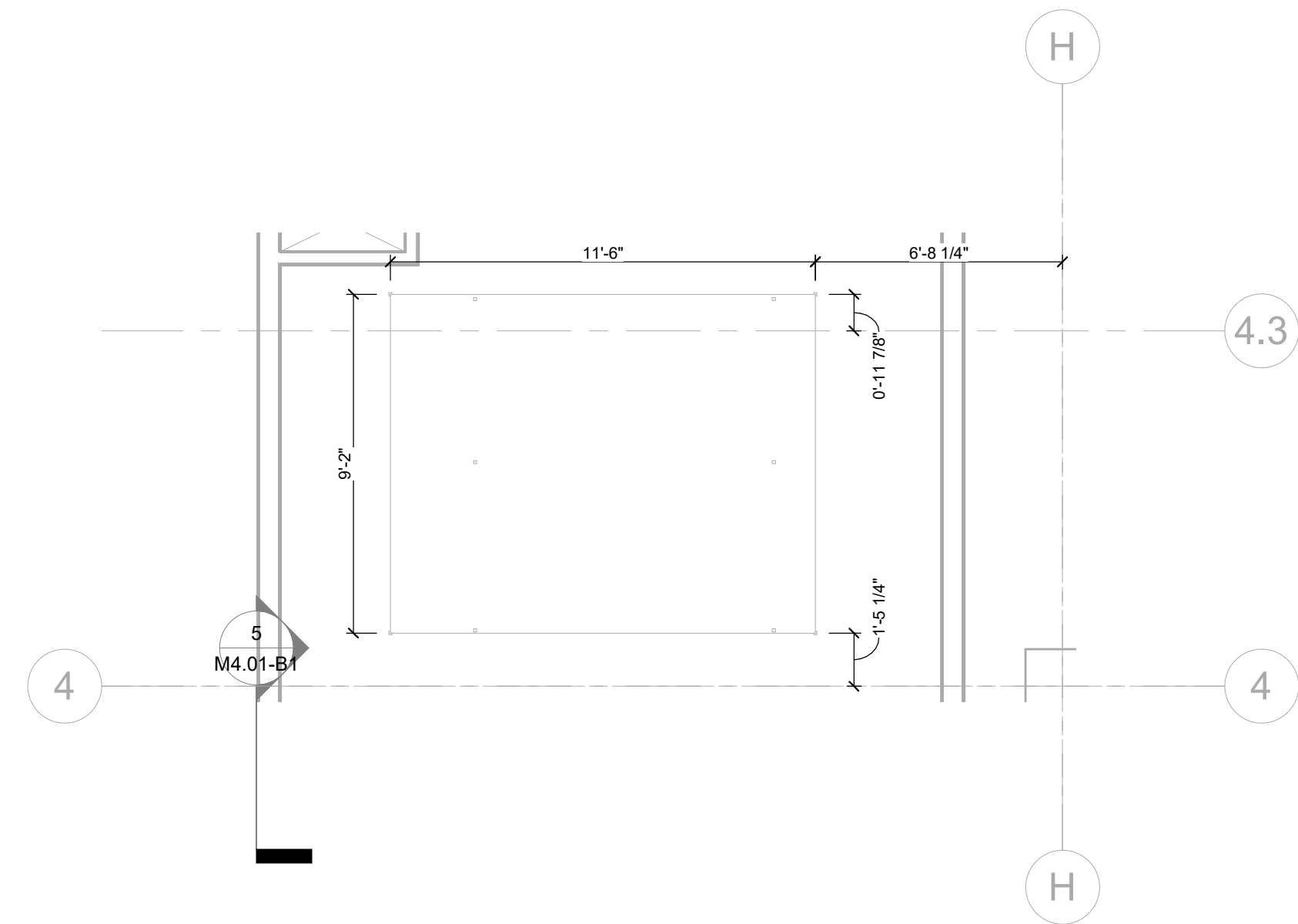

3 LEVEL 3 HVAC PRINT - B1 - EQUIPMENT PAD
1/4" = 1'-0"

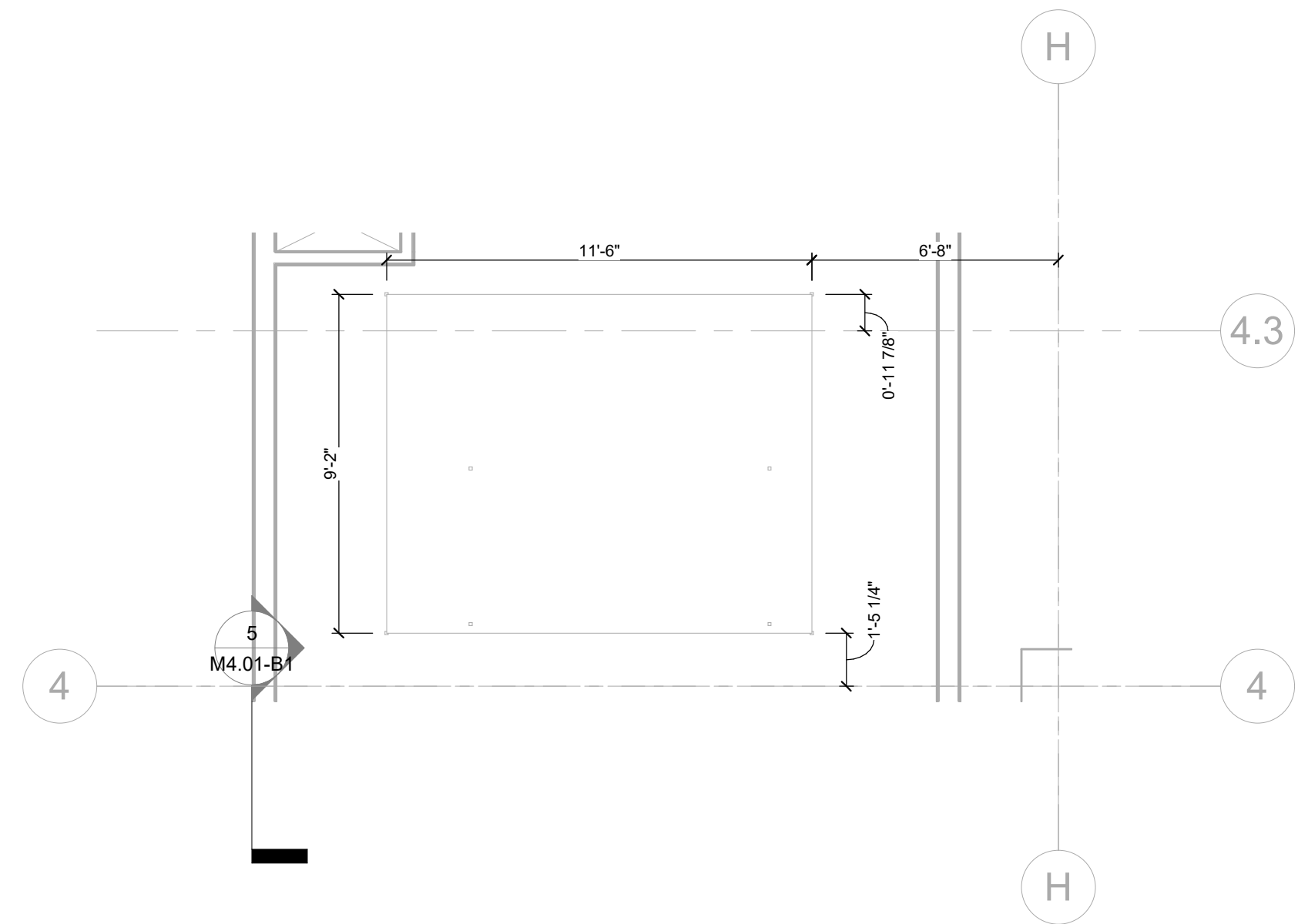

4 LEVEL 4 HVAC PRINT - B1 - EQUIPMENT PAD
1/4" = 1'-0"

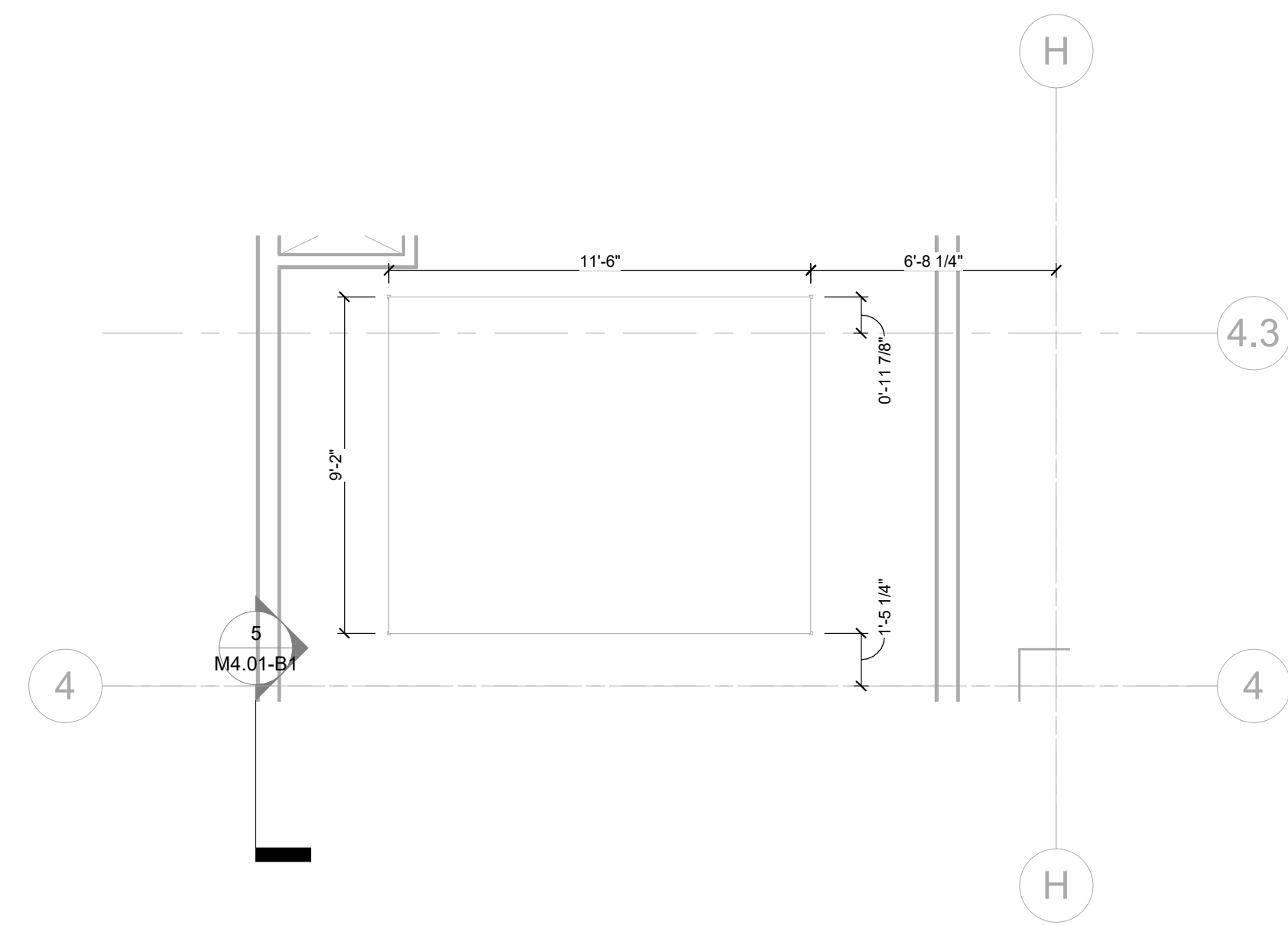

5 LEVEL 5 HVAC PRINT - B1 - EQUIPMENT PAD
1/4" = 1'-0"

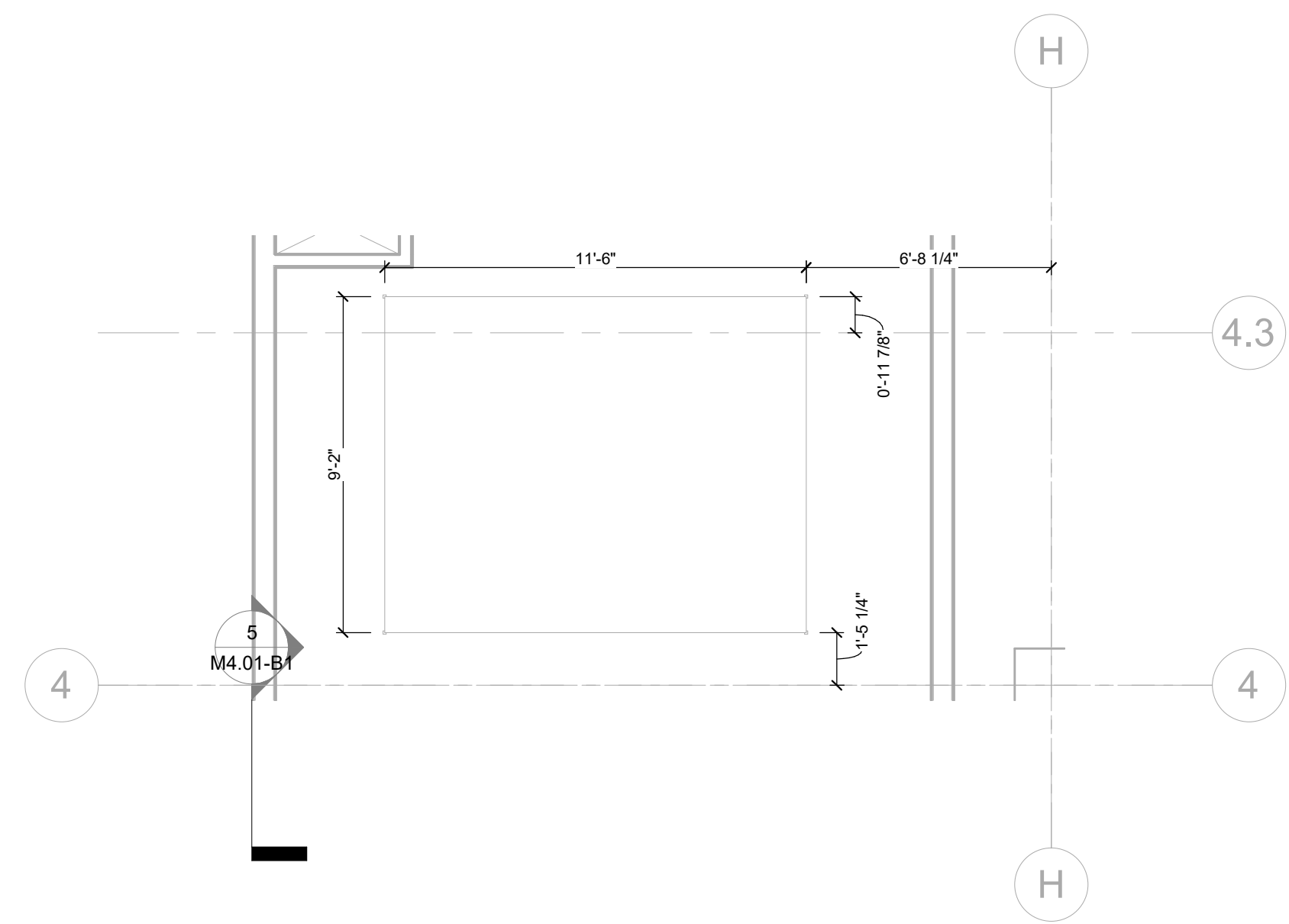

6 LEVEL 6 HVAC PRINT - B1 - EQUIPMENT PAD
1/4" = 1'-0"

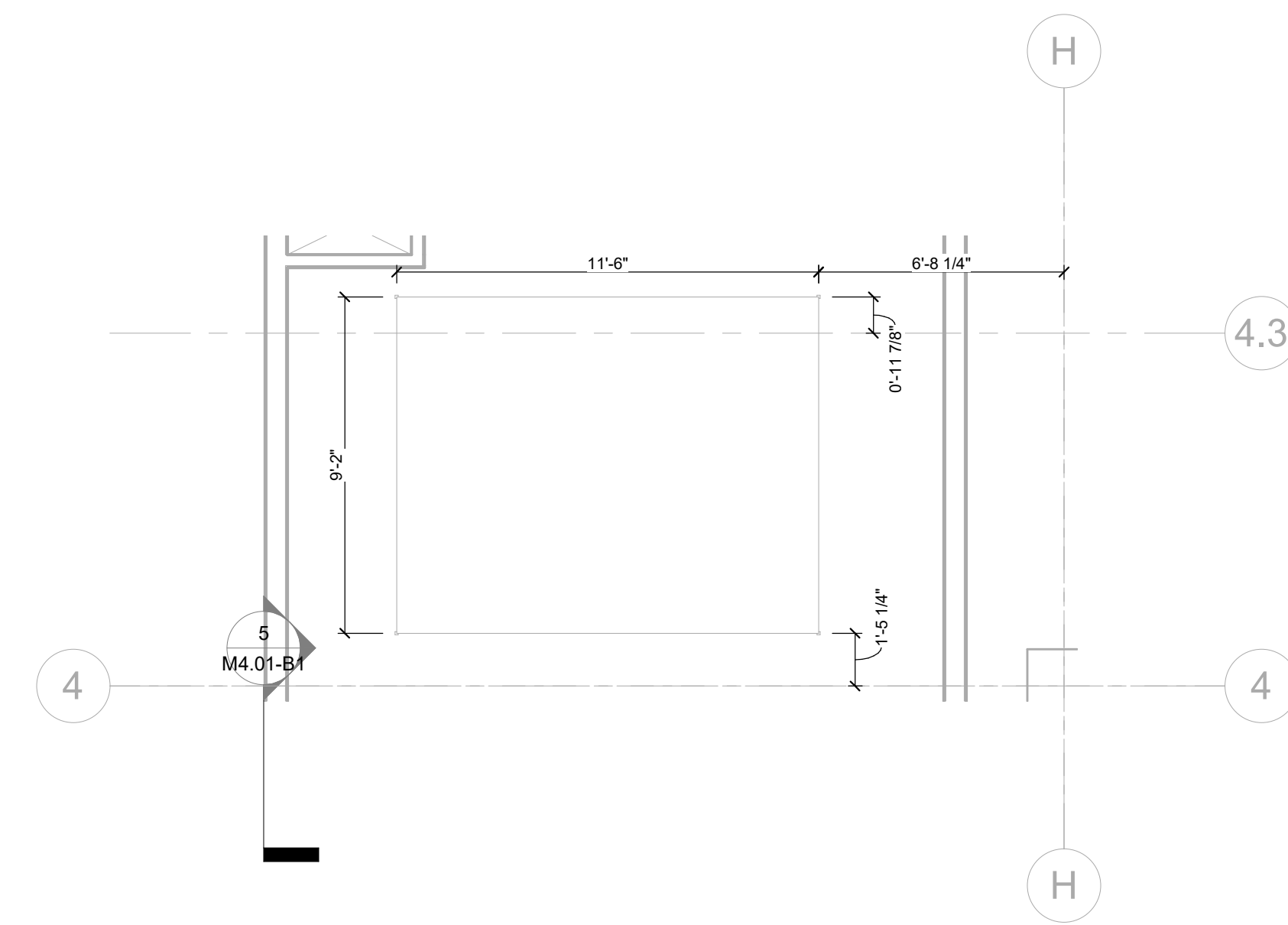

7 LEVEL 7 HVAC PRINT - B1 - EQUIPMENT PAD
1/4" = 1'-0"

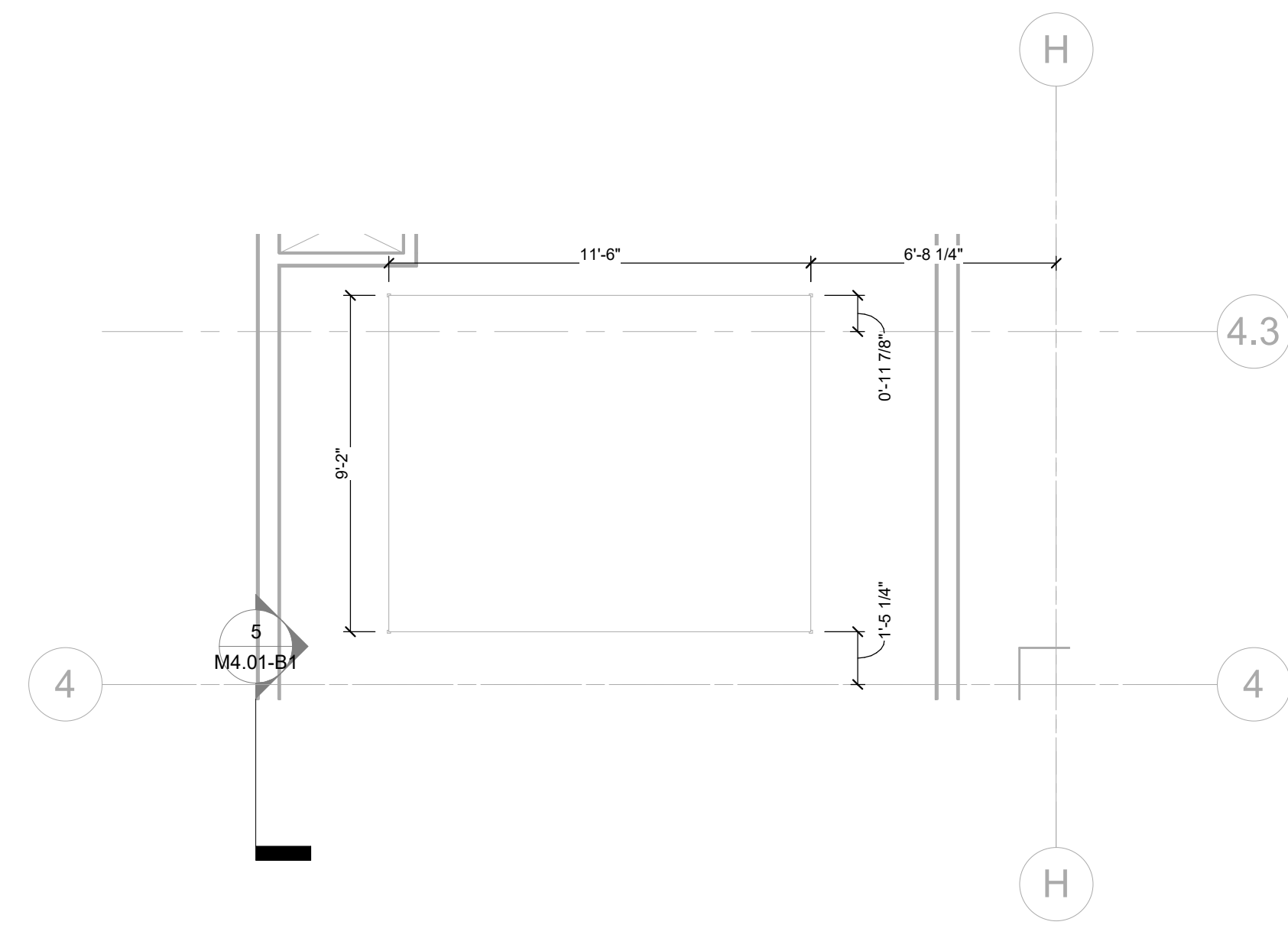

8 LEVEL 8 HVAC PRINT - B1 - EQUIPMENT PAD
1/4" = 1'-0"

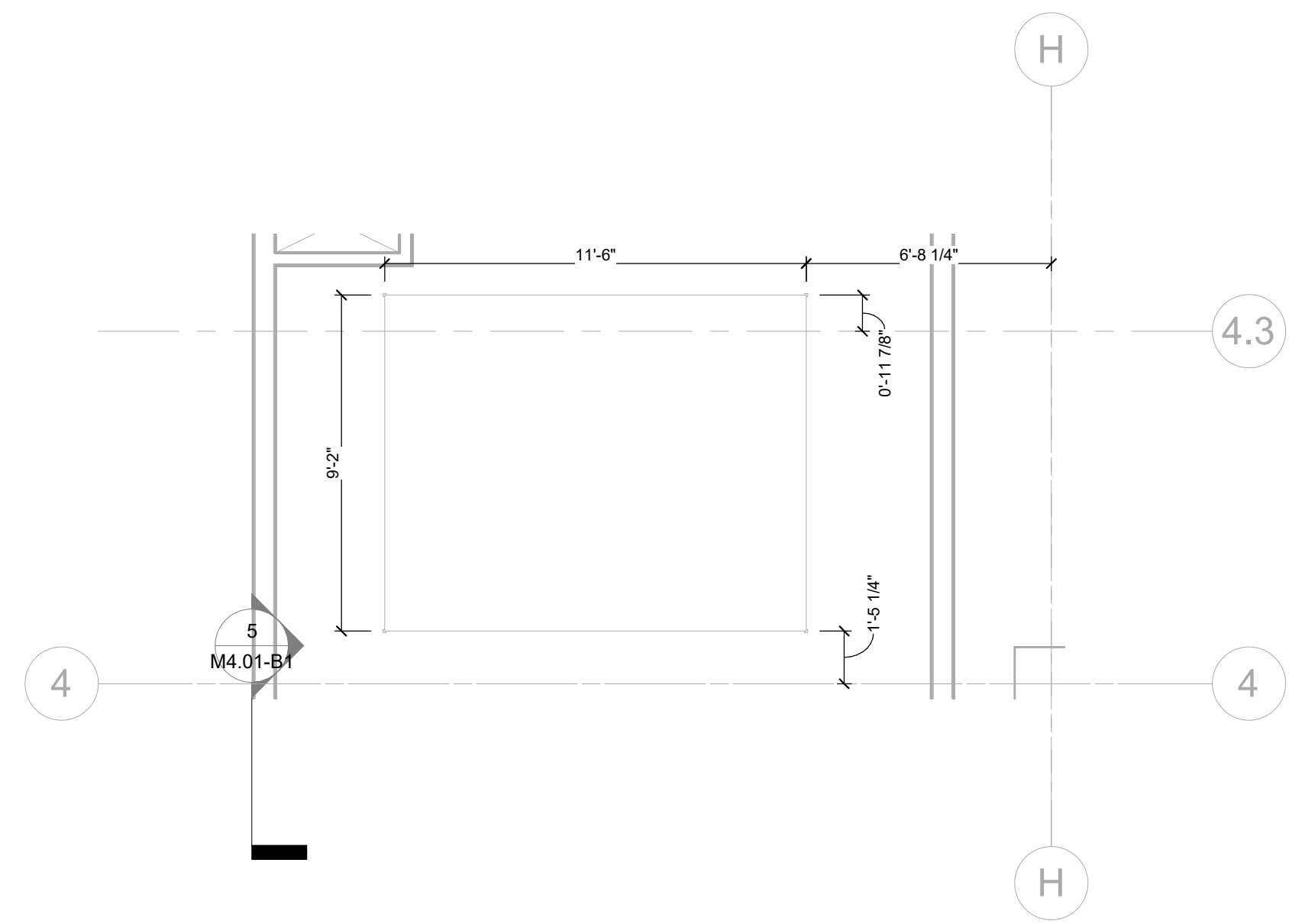

9 LEVEL 9 HVAC PRINT - B1 - EQUIPMENT PAD
1/4" = 1'-0"

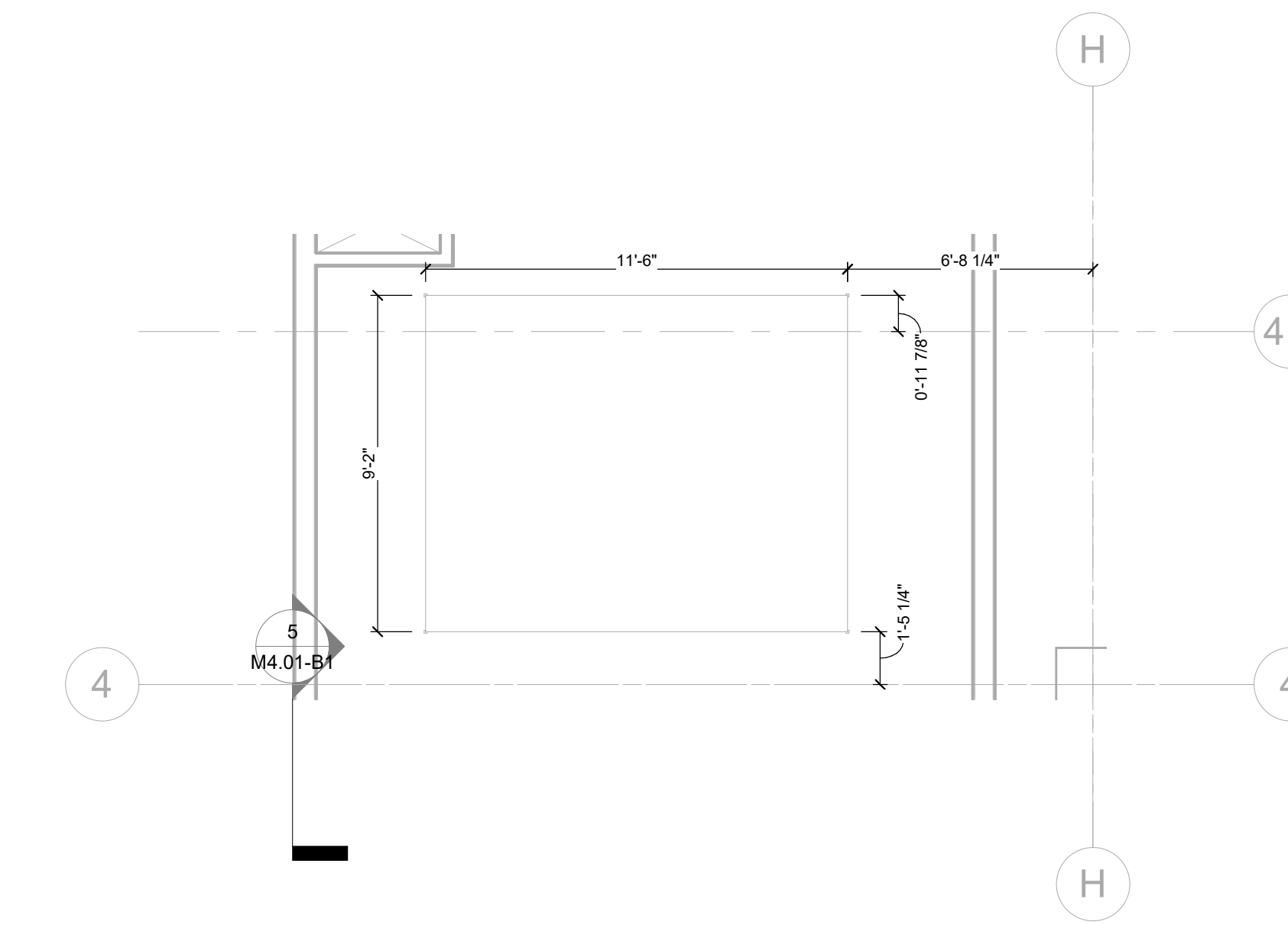

10 LEVEL 10 HVAC PRINT - B1 - EQUIPMENT PAD
1/4" = 1'-0"

KEY PLAN

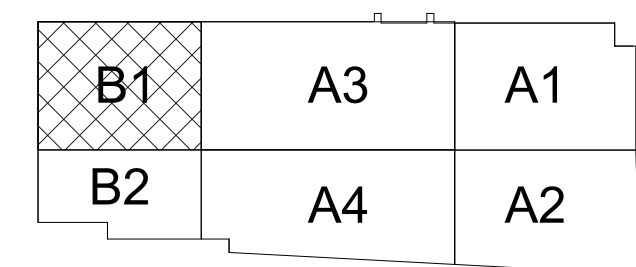

**NOT FOR CONSTRUCTION
ISSUED FOR REVIEW**

REV	DATE	BY	DESCRIPTION

2999 OLYMPUS
2999 Olympus, Dallas TX

TDIndustries
13850 Diplomat Drive
Dallas, TX 75234
(p) 972.888.9500

DRAWING TITLE
MECHANICAL EQUIPMENT PADS - AREA B1

JOB NUMBER: **B-27617-3-067** CD SHEET: **M5.01-B1**
CD REV DATE: **03/17/21**

DRAWN BY: **GO** CHECKED BY: **PC**

2999 OLYMPUS - MECHANICAL EQUIPMENT PADS - AREA B1

SCALE: 1/4" = 1'-0"