



Lennox National Accounts Project Submittal

Project Name: Culver's Washington, IL - Stock Alternatives
Project Number: 555739
Project Altitude: 757
Project Location:
115 N Cummings Lane
Washington, Illinois US

Date: 1/24/2024
Quote: 422898
Roof Top Units: 2
Split Systems: 0

Customer: Johns Svc & Sales Inc
Engineer: Ollmann Ernest Martin Architects
National Account: Culvers

Table of Contents

| Tag | Qty | Model | Description |
|-------------------------------|-----|-----------|-----------------------------|
| RTU-1 FB974 | 1 | LGT240H4M | LGT240H4M-Y 20T CONF E=12.0 |
| RTU-2 FB659 | 1 | LGT240H4M | LGT240H4M-Y 20T CONF E=12.0 |

Revit® Building Information Modeling (BIM) - [Click here](#)

AutoCAD® Templates - [Click here](#)



Lennox National Accounts Project Submittal

Tag: RTU-1 | FB974

Model: LGT240H4M - LGT240H4M-Y 20T CONF E=12.0

UNIT OVERVIEW

| Voltage | IEER EER | MCA/MOCP (amp) | Gross Cooling Ttl/Sens (MBH) | Net Cooling Ttl/Sens (MBH) | Supply Air Flow (cfm) | ESP/TSP (in.WC) | EAT DB/WB (°F) | LAT DB/WB (°F) |
|------------------|-------------|-------------------|------------------------------------|----------------------------------|-----------------------------|--------------------|----------------------|----------------------|
| 208V 3Ph 60Hz | 15.7 12 | 99 / 110 | 247.6 / 162.1 | 238.4 / 152.9 | 6,150 | 0.75 / 1.02 | 79.5 / 67.8 | 53.7 / 53.7 |

COOLING

| Cooling Performance | | Temperatures (DB/WB °F) | | |
|--------------------------|-------------------|-------------------------|------|------|
| Gross Cooling (Ttl/Sens) | 247.6 / 162.1 MBH | Ambient | 91.0 | 78.0 |
| Net Cooling (Ttl/Sens) | 238.4 / 152.9 MBH | Entering | 79.5 | 67.8 |
| Coil Moisture Removal | 80.56 lb/hr | Leaving - (Coil) | 53.7 | 53.7 |
| System Moisture Removal | 80.56 lb/hr | Leaving - (Unit) | 55.3 | 54.8 |

| ARI Performance | | Compressors | | Refrigerant | | Condensate Drain | |
|-----------------|-------------------|----------------|----------|-------------|--------|------------------|-------|
| ARI Cooling | 236.0 / 230.0 MBH | Cooling Stages | 4 | Type | R-410A | Qty | 1 |
| ARI Power | 19,100 W | Compressor Qty | 4 | Charge | 0.0 | Size | 1 in. |
| | | Compressor RLA | 52.8 amp | | | Pipe Thread | FPT |

HUMIDITROL - HOT GAS REHEAT

| Humiditrol Dehumidification Performance | | Temperatures (DB/WB °F) | | |
|---|------------------|-------------------------|------|------|
| Gross Cooling - Stage 1(Ttl/Sens) | 48.9 / 22.5 MBH | Ambient | 91.0 | |
| Gross Cooling - Stage 2 (Ttl/Sens) | 127.8 / 55.7 MBH | Entering | 79.5 | 67.8 |
| Moisture Removal - Stage 1 | 24.9 lb/hr | Leaving - (Stage 1) | 75.9 | 65.4 |
| Moisture Removal - Stage 2 | 68.0 lb/hr | Leaving - (Stage 2) | 70.7 | 61.3 |

HEATING

| Heating Performance | | Temperatures (DB/WB °F) | | Specifications | |
|---------------------|-------------------|-------------------------|-------|--------------------|---------|
| Output (High/Low) | 389.0 / 126.0 MBH | Ambient | -18.0 | Heat Stages | 2 |
| Input (High/Low) | 480.0 / 156.0 MBH | Entering | 50.0 | Thermal Efficiency | 81.0% |
| Heat Rise | 58.6 °F | Leaving | 108.6 | Gas Line Size | 1 in. |
| | | | | Gas Pressure | 7 in.WC |

VENTILATION

| Air Flow (cfm) | | Supply Fan | | Air Resistance (in.WC) | |
|----------------|-------|----------------|-----------------|------------------------|------|
| Supply | 6,150 | Nominal Power | 7.50 hp | Total | 1.02 |
| Outdoor | 1,750 | Required Power | 3.21 hp | Ext Supply | 0.75 |
| | | Drive Type | MSAV Belt Drive | | |
| | | RPM Range | 850 - 1,045 rpm | | |
| | | Required RPM | 862 rpm | | |

AIR RESISTANCE - OPTIONS/ACCESSORIES (in.WC)

| Wet Coil | Humiditrol | Heat | Economizer | Filters | Diffuser | Exhaust | ERW |
|----------|------------|------|------------|---------|----------|---------|-----|
| 0.08 | 0.03 | 0.15 | 0.01 | | | | |

ELECTRICAL

| | | | |
|---------------------|-----------------|-------------------|----------|
| Voltage | 208V 3Ph / 60Hz | Compressor RLA | 52.8 amp |
| MCA | 99 amp | Cooling FLA Total | 79.1 amp |
| MOCP | 110 amp | Condenser FLA | 15.2 amp |
| Condenser Power | 1950 W | Supply Fan FLA | 11.1 amp |
| Oper Range-Nom Volt | +/- 10% | | |

ADDITIONAL DATA

| | | | |
|-----------------|------------------------------------|----------------------|----------|
| Cabinet | 132.62 in. x 91.12 in. x 54.25 in. | Total Weight | 3,107 lb |
| Downflow Supply | 20.0 in. x 28.0 in. | Base Unit Net Weight | 2,601 lb |
| Downflow Return | 15.0 in. x 60.5 in. | OAS/Econ Weight | 167 lb |
| Filters | (6) 24.0 in. x 24.0 in. x 2.0 in. | Exhaust Weight | 20 lb |
| Sound Rating | 94 dBA | Humiditrol Weight | 50 lb |



Lennox National Accounts Project Submittal

| | | |
|--|------------------------|--------|
| | Gas Heat Weight | 64 lb |
| | Coil Hail Guard Weight | 36 lb |
| | Curb Weight | 169 lb |



Lennox National Accounts Project Submittal

Tag: RTU-1 | FB974

Factory Installed Options

- High Performance Economizer Upgrade Factory Installed
- Single Sensible High Performance Economizer
- Belt Drive
- Unit Orientation Downflow
- Supply Fan: Multi-Stage Air Volume Belt
- 208/220/230/240V 3Phase
- 150Amp Disconnect Factory Installed
- Built-in BACnet IP and MS/TP (standard)
- Supply Motor - 7.5 Hp Std- w/ MSAV
- Supply Drive Kit 6 (850-1045 RPM)
- Barometric Relief Damper Factory Installed
- 480K A.S. (Dual Stage)
- Combination Coil/Hail Guards Factory Installed
- Hinged Access Doors Factory Installed
- 15A GFCI Factory Installed/Field Wired
- Environ Condenser Coil System Factory Installed
- Humiditrol Factory Installed
- 2" MERV4 - Std. Filter Factory Installed

Field Installed Accessories

| Catalog Number | Qty | Description |
|----------------|-----|--|
| 11F59 | 1 | 14" Downflow - Hybrid Curb Field Installed |
| 22H54 | 1 | PVC Drain Trap Field Installed |
| 17G74 | 1 | CS7500 Comm'I Programmable T-stat w/ FDD Field Installed |
| 47W36 | 1 | Remote Temp Sensor Wall Mount 20K Field Installed |
| 17M50 | 1 | Humidity Sensor Kit Field Installed |
| 22H56 | 1 | Supply OR Return Smoke Detector Field Installed |
| 21Z07 | 1 | Drain Pan Overflow Switch Field Installed |
| 52W40 | 6 | 2" MERV13 - Filter Field Installed |

Product Features

Cabinet

- Hinged Access Panels
- Durable Outdoor Enamel Paint Finish
- Totally Enclosed Outdoor Fan Motor
- PVC Coated Fan Guard
- Corrosion-Resistant Drain Pan
- Isolated Compressor Compartment

Cooling System

- Scroll Compressor
- Expansion Valves
- High Capacity Driers
- Crankcase Heater
- System can operate from 0°F to 125°F without any additional controls
- Pre-charged Refrigeration System
- Timed Off Control
- Internal Pressure Relief Valve
- Building Automation Integrated Control - Up to 4 Stages of Cooling
- Thermostat Control – 4 Stages of Cooling
- Humiditrol - Hot Gas Reheat Dehumidification System

Heating System

- Redundant Automatic Gas Valve with Manual Shut-off
- Electronic Flame Sensor
- Direct Spark Ignition
- Inshot Burners
- AGA-CGA Certified

Control System



Lennox National Accounts Project Submittal

Fan and Limit Controls
Overload Protection
Microprocessor Controls – Lennox® CORE Control System
Auto reset high & low pressure switch with strike 3 lockout feature in Lennox® CORE Control System
Built-in BACnet IP & MS/TP
Phase/Voltage Detection
Return Air Sensor Factory Installed
Outdoor Air Sensor Factory Installed
Factory Installed Discharge Air Sensor

Compliance

Components are Bonded for Grounding
Factory Test Operated
All models are ASHRAE 90.1-2019 energy efficiency compliant and meet or exceed requirements of Section 6.8
All models meet DOE 2018 and 2023 energy efficiency standards
Model meets California Code of Regulations, Title 24 and ASHRAE 90.1-2016 Section 6.4.3.10 requirements for staged airflow
Model meets HCAI (formerly OSHPD) OSP and Special Seismic Certification (Number: OSP-0596) and meet 2018 International Building Code (IBC), 2019 California Building Code (CBC) ASCE 7, and ICC-ES AC156
ISO 9001 Registered Manufacturing Quality System

Warranty

Limited warranty on aluminized heat exchanger of 10 years
Limited warranty on compressor of 5 years
Limited warranty on Environ Coil System of 3 years
Limited warranty on High Performance Economizer of 5 years
Limited warranty on all other components of 1 year
See Limited Warranty Certificate included with unit for details
Limited warranty on Lennox® CORE Control System of 3 years



Lennox National Accounts Project Submittal

| Corner Weights (lb) | | | | | | | | Center of Gravity (in.) | | | |
|---------------------|-----|------|-----|------|-----|------|-----|-------------------------|-------|-------|-------|
| AA | | BB | | CC | | DD | | EE | | FF | |
| Base | Max | Base | Max | Base | Max | Base | Max | Base | Max | Base | Max |
| 519 | 628 | 611 | 702 | 796 | 821 | 676 | 735 | 58.25 | 56.87 | 39.57 | 42.00 |

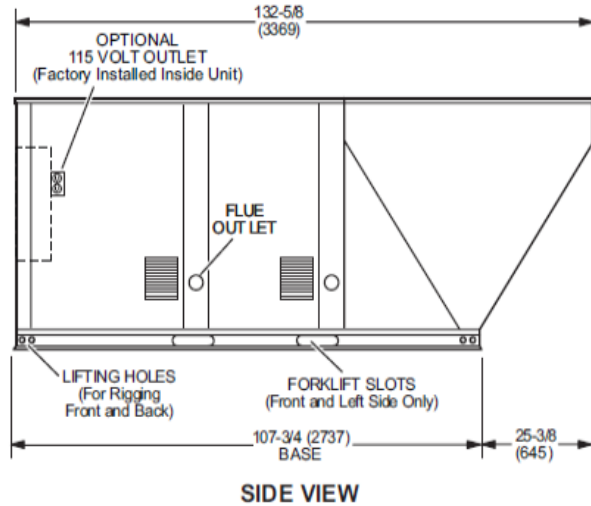
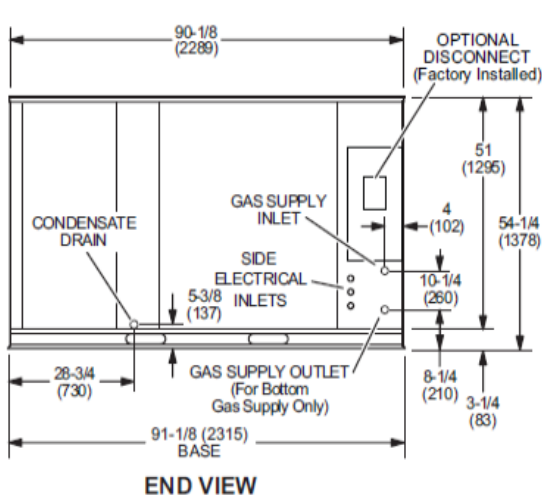
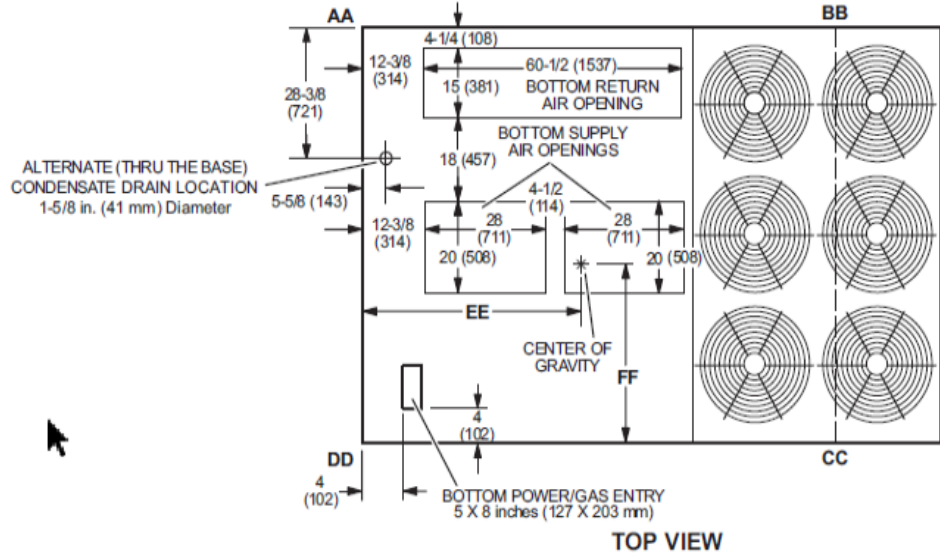



Lennox National Accounts Project Submittal

OUTDOOR AIR HOOD DETAIL

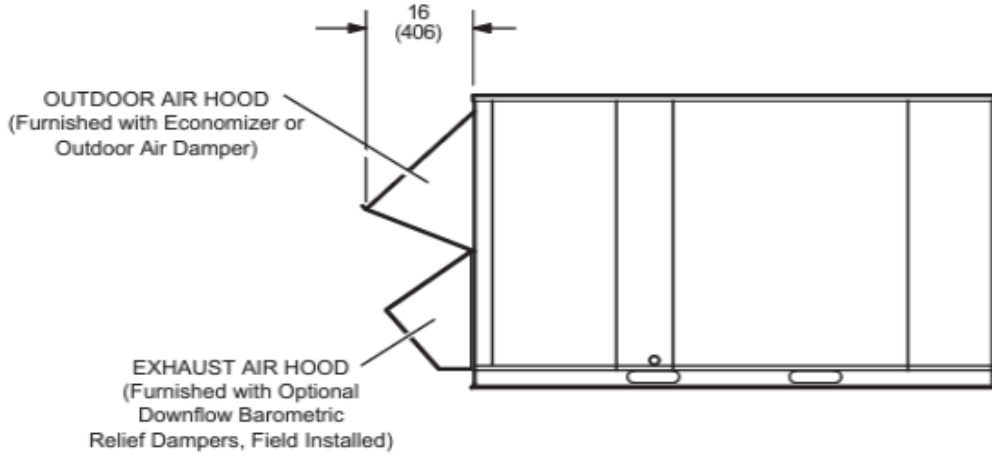

OPTIONAL HORIZONTAL BAROMETRIC RELIEF DAMPERS WITH HOOD (Field installed in horizontal return air duct adjacent to unit)

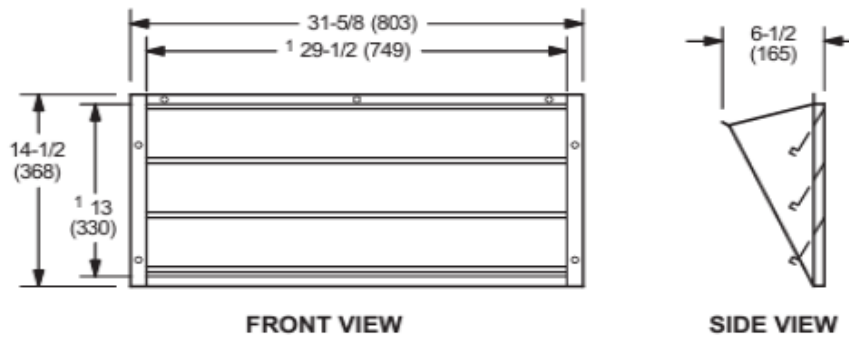

NOTE - Two furnished per order no.
1 NOTE - Opening size required in return air duct.



Lennox National Accounts Project Submittal

HYBRID ROOF CURBS - DOUBLE DUCT OPENING

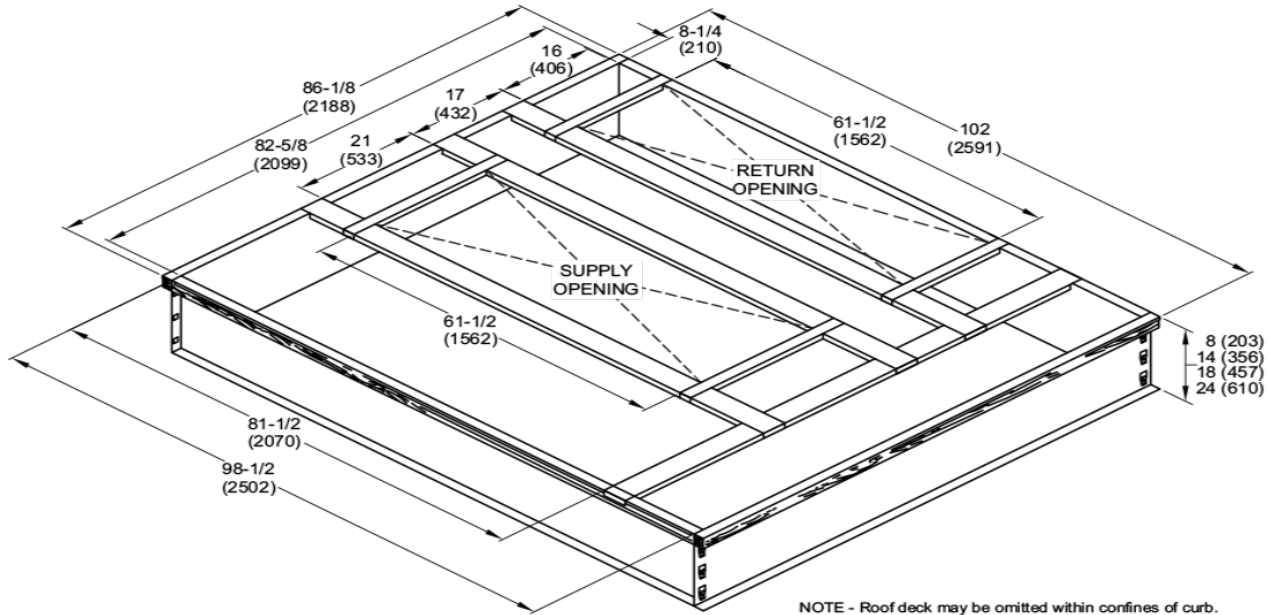

TYPICAL FLASHING DETAIL FOR ROOF CURB

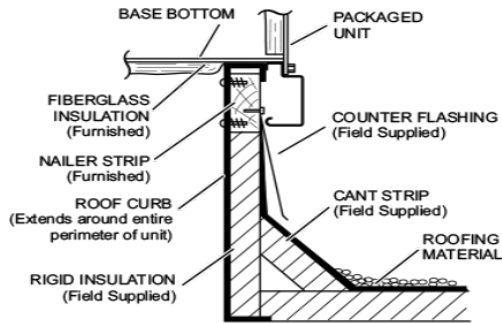

DETAIL ROOF CURB

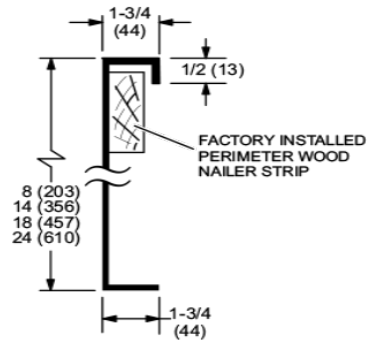



Lennox National Accounts Project Submittal

Unit With Economizer

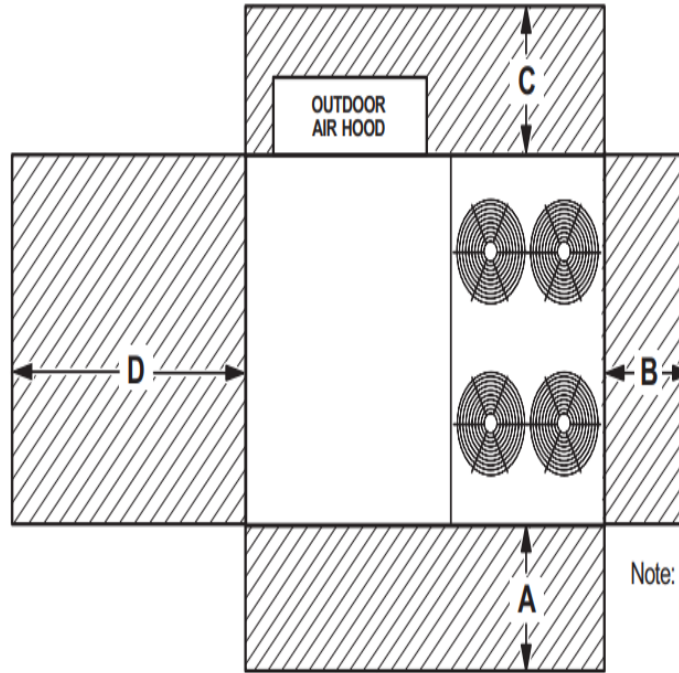

Note: Models with four outdoor fans shown.
Dimension clearances are for all sizes.

| ¹ Unit Clearance | A | | B | | C | | D | | Top Clearance |
|------------------------------------|-----|------|-----|-----|-----|-----|-----|------|---------------|
| | in. | mm | in. | mm | in. | mm | in. | mm | |
| Service Clearance | 60 | 1524 | 36 | 914 | 36 | 934 | 66 | 1676 | Unobstructed |
| Clearance to Combustibles | 36 | 914 | 1 | 25 | 1 | 25 | 1 | 25 | |
| Minimum Operation Clearance | 45 | 1143 | 36 | 914 | 36 | 914 | 41 | 1041 | |

NOTE - Entire perimeter of unit base requires support when elevated above the mounting surface.

¹ **Service Clearance** - Required for removal of serviceable parts.

Clearance to Combustibles - Required clearance to combustible material.

Minimum Operation Clearance - Required clearance for proper unit operation.



Lennox National Accounts Project Submittal

17G74: COMFORTSENSE® 7500 COMMERCIAL 7 DAY PROGRAMMABLE THERMOSTAT

| | |
|---------------------|---|
| Accessory | ✗ |
| Duct Mount | ✗ |
| Wall Mount | ✓ |
| Outdoor | ✗ |
| Thermostat | ✓ |
| Temperature Sensing | ✓ |
| CO2 Sensing | ✗ |
| RH Sensing | ✓ |
| Light Sensing | ✗ |
| Pressure Sensing | ✗ |
| Smoke Sensing | ✗ |
| Communicating | ✗ |
| Display | ✓ |



Precise, sophisticated control for conventional systems and heat pumps

The Lennox® ComfortSense line of programmable thermostats can help your customers manage their heating and cooling schedule, and their energy costs, without sacrificing comfort. The thermostat allows for the detection of economizer faults generated by the RTU's service relay, fulfilling FDD regulations and improving serviceability of Lennox rooftop units.

Energy Efficiency

- Programmable - 7-Day or 5-Day/2-Day - Versatile programming options offer custom comfort and energy savings
- Dual-fuel capability - Increases the efficiency of dual-fuel heating systems by automatically alternating between gas and electric operation
- One-Touch Away Mode - Turns down heating or cooling with one touch to save energy when the user is away
- Energy Reports - Show how often and how long the heating or cooling system has run

Enhanced Comfort

- Automatic changeover - decides between heating and cooling operation, depending on indoor temperature
- Built-in temperature and humidity sensors
- Smooth Setback Recovery - pre-cools a space to reach the desired setpoint temperature as soon as the scheduled period begins

Reliable Performance

- Touchscreen display - large (4.3"), easy-to-use display with adjustable brightness
- Customizable reminders - allow you to set a series of service and parts replacement reminders which display on the home screen
- Filter Reminder - Reminds the user when it is time to change the filter
- Outdoor temperature display - requires optional outdoor sensor
- Universal thermostat - Works with conventional systems and heat pumps and supports up to 4 stages of heat and 2 stages of cooling
- Compatible with Lennox-brand non-communicating equipment and most other brands of heating and cooling equipment



Lennox National Accounts Project Submittal

| SPECIFICATIONS - COMFORTSENSE7500 | | |
|-----------------------------------|--|--------------|
| Product Depth | 7/8 IN | |
| Product Height | 3-5/16 IN | |
| Product Width | 4-5/16 IN | |
| Gross Weight | 0.6 LB | |
| Hertz | 50/60 Hz | |
| Programs per Week | 7 Day | |
| Changeover | Auto changeover | |
| Wi-Fi Enabled | No WiFi | |
| Stages | Universal 4 Heat/2 Cool | |
| Temperature Setting Range | <ul style="list-style-type: none"> • Heating - 45 to 90°F • Cooling - 45 to 99°F | |
| Humidity Settings | <ul style="list-style-type: none"> • Operating range - 10 to 90% relative humidity • Humidity setpoint (Dehumidification) - 45 to 60% relative humidity, default 50% | |
| Power Supply | 24VAC (18 to 30VAC maximum), 50/60Hz | |
| Clock Accuracy | ± 10 minutes per year | |
| ACCESSORIES | | |
| Sensors/Accessories | Remote non-adjustable wall-mount 20k | 47W36 |
| | Remote non-adjustable wall-mount 10k | 47W37 |
| | Remote non-adjustable discharge air (duct mount) | 19L22 |
| | Outdoor temperature sensor | X2658 |



Lennox National Accounts Project Submittal





Lennox National Accounts Project Submittal

Tag: RTU-2 | FB659

Model: LGT240H4M - LGT240H4M-Y 20T CONF E=12.0

UNIT OVERVIEW

| Voltage | IEER EER | MCA/MOCP (amp) | Gross Cooling Ttl/Sens (MBH) | Net Cooling Ttl/Sens (MBH) | Supply Air Flow (cfm) | ESP/TSP (in.WC) | EAT DB/WB (°F) | LAT DB/WB (°F) |
|------------------|-------------|-------------------|------------------------------------|----------------------------------|-----------------------------|--------------------|----------------------|----------------------|
| 208V 3Ph 60Hz | 15.7 12 | 99 / 110 | 248.4 / 163.5 | 238.9 / 154.1 | 6,150 | 0.75 / 1.05 | 79.4 / 67.6 | 53.4 / 53.4 |

COOLING

| Cooling Performance | | Temperatures (DB/WB °F) | | |
|--------------------------|-------------------|-------------------------|------|------|
| Gross Cooling (Ttl/Sens) | 248.4 / 163.5 MBH | Ambient | 90.0 | 78.0 |
| Net Cooling (Ttl/Sens) | 238.9 / 154.1 MBH | Entering | 79.4 | 67.6 |
| Coil Moisture Removal | 79.95 lb/hr | Leaving - (Coil) | 53.4 | 53.4 |
| System Moisture Removal | 79.95 lb/hr | Leaving - (Unit) | 54.9 | 54.5 |

| ARI Performance | | Compressors | | Refrigerant | | Condensate Drain | |
|-----------------|-------------------|----------------|----------|-------------|--------|------------------|-------|
| ARI Cooling | 236.0 / 230.0 MBH | Cooling Stages | 4 | Type | R-410A | Qty | 1 |
| ARI Power | 19,100 W | Compressor Qty | 4 | Charge | 0.0 | Size | 1 in. |
| | | Compressor RLA | 52.8 amp | | | Pipe Thread | FPT |

HUMIDITROL - HOT GAS REHEAT

| Humiditrol Dehumidification Performance | | Temperatures (DB/WB °F) | | |
|---|------------------|-------------------------|------|------|
| Gross Cooling - Stage 1(Ttl/Sens) | 50.6 / 24.3 MBH | Ambient | 90.0 | |
| Gross Cooling - Stage 2 (Ttl/Sens) | 129.8 / 57.9 MBH | Entering | 79.4 | 67.6 |
| Moisture Removal - Stage 1 | 24.7 lb/hr | Leaving - (Stage 1) | 75.5 | 65.1 |
| Moisture Removal - Stage 2 | 67.7 lb/hr | Leaving - (Stage 2) | 70.2 | 61.0 |

HEATING

| Heating Performance | | Temperatures (DB/WB °F) | | Specifications | |
|---------------------|-------------------|-------------------------|-------|--------------------|---------|
| Output (High/Low) | 389.0 / 126.0 MBH | Ambient | -18.0 | Heat Stages | 2 |
| Input (High/Low) | 480.0 / 156.0 MBH | Entering | 50.0 | Thermal Efficiency | 81.0% |
| Heat Rise | 58.6 °F | Leaving | 108.6 | Gas Line Size | 1 in. |
| | | | | Gas Pressure | 7 in.WC |

VENTILATION

| Air Flow (cfm) | | Supply Fan | | Air Resistance (in.WC) | |
|----------------|-------|----------------|-----------------|------------------------|------|
| Supply | 6,150 | Nominal Power | 7.50 hp | Total | 1.05 |
| Outdoor | 1,700 | Required Power | 3.28 hp | Ext Supply | 0.75 |
| | | Drive Type | MSAV Belt Drive | | |
| | | RPM Range | 850 - 1,045 rpm | | |
| | | Required RPM | 871 rpm | | |

AIR RESISTANCE - OPTIONS/ACCESSORIES (in.WC)

| Wet Coil | Humiditrol | Heat | Economizer | Filters | Diffuser | Exhaust | ERW |
|----------|------------|------|------------|---------|----------|---------|-----|
| 0.08 | 0.03 | 0.15 | 0.01 | 0.04 | | | |

ELECTRICAL

| | | | |
|---------------------|-----------------|-------------------|----------|
| Voltage | 208V 3Ph / 60Hz | Compressor RLA | 52.8 amp |
| MCA | 99 amp | Cooling FLA Total | 79.1 amp |
| MOCP | 110 amp | Condenser FLA | 15.2 amp |
| Condenser Power | 1950 W | Supply Fan FLA | 11.1 amp |
| Oper Range-Nom Volt | +/- 10% | | |

ADDITIONAL DATA

| | | | |
|-----------------|------------------------------------|----------------------|----------|
| Cabinet | 132.62 in. x 91.12 in. x 54.25 in. | Total Weight | 3,107 lb |
| Downflow Supply | 20.0 in. x 28.0 in. | Base Unit Net Weight | 2,601 lb |
| Downflow Return | 15.0 in. x 60.5 in. | OAS/Econ Weight | 167 lb |
| Filters | (6) 24.0 in. x 24.0 in. x 2.0 in. | Exhaust Weight | 20 lb |
| Sound Rating | 94 dBA | Humiditrol Weight | 50 lb |



Lennox National Accounts Project Submittal

| | | |
|--|------------------------|--------|
| | Gas Heat Weight | 64 lb |
| | Coil Hail Guard Weight | 36 lb |
| | Curb Weight | 169 lb |



Lennox National Accounts Project Submittal

Tag: RTU-2 | FB659

Factory Installed Options

High Performance Economizer Upgrade Factory Installed
 Single Enthalpy High Performance Economizer
 Belt Drive
 Unit Orientation Downflow
 Supply Fan: Multi-Stage Air Volume Belt
 208/220/230/240V 3Phase
 150Amp Disconnect Factory Installed
 Built-in BACnet IP and MS/TP (standard)
 Supply Motor - 7.5 Hp Std- w/ MSAV
 Supply Drive Kit 6 (850-1045 RPM)
 Barometric Relief Damper Factory Installed
 480K A.S. (Dual Stage)
 Combination Coil/Hail Guards Factory Installed
 Hinged Access Doors Factory Installed
 15A GFCI Factory Installed/Field Wired
 Environ Condenser Coil System Factory Installed
 Humiditrol Factory Installed
 2" MERV8 - Filter Factory installed

Field Installed Accessories

| Catalog Number | Qty | Description |
|----------------|-----|--|
| 11F59 | 1 | 14" Downflow - Hybrid Curb Field Installed |
| 22H54 | 1 | PVC Drain Trap Field Installed |
| 17G74 | 1 | CS7500 Comm'I Programmable T-stat w/ FDD Field Installed |
| 47W36 | 1 | Remote Temp Sensor Wall Mount 20K Field Installed |
| 17M50 | 1 | Humidity Sensor Kit Field Installed |
| 22H56 | 1 | Supply OR Return Smoke Detector Field Installed |
| 21Z07 | 1 | Drain Pan Overflow Switch Field Installed |
| 52W40 | 6 | 2" MERV13 - Filter Field Installed |

Product Features

Cabinet

Hinged Access Panels
 Durable Outdoor Enamel Paint Finish
 Totally Enclosed Outdoor Fan Motor
 PVC Coated Fan Guard
 Corrosion-Resistant Drain Pan
 Isolated Compressor Compartment

Cooling System

Scroll Compressor
 Expansion Valves
 High Capacity Driers
 Crankcase Heater
 System can operate from 0°F to 125°F without any additional controls
 Pre-charged Refrigeration System
 Timed Off Control
 Internal Pressure Relief Valve
 Building Automation Integrated Control - Up to 4 Stages of Cooling
 Thermostat Control – 4 Stages of Cooling
 Humiditrol - Hot Gas Reheat Dehumidification System

Heating System

Redundant Automatic Gas Valve with Manual Shut-off
 Electronic Flame Sensor
 Direct Spark Ignition
 Inshot Burners
 AGA-CGA Certified

Control System



Lennox National Accounts Project Submittal

Fan and Limit Controls
Overload Protection
Microprocessor Controls – Lennox® CORE Control System
Auto reset high & low pressure switch with strike 3 lockout feature in Lennox® CORE Control System
Built-in BACnet IP & MS/TP
Phase/Voltage Detection
Return Air Sensor Factory Installed
Outdoor Air Sensor Factory Installed
Factory Installed Discharge Air Sensor

Compliance

Components are Bonded for Grounding
Factory Test Operated
All models are ASHRAE 90.1-2019 energy efficiency compliant and meet or exceed requirements of Section 6.8
All models meet DOE 2018 and 2023 energy efficiency standards
Model meets California Code of Regulations, Title 24 and ASHRAE 90.1-2016 Section 6.4.3.10 requirements for staged airflow
Model meets HCAI (formerly OSHPD) OSP and Special Seismic Certification (Number: OSP-0596) and meet 2018 International Building Code (IBC), 2019 California Building Code (CBC) ASCE 7, and ICC-ES AC156
ISO 9001 Registered Manufacturing Quality System

Warranty

Limited warranty on aluminized heat exchanger of 10 years
Limited warranty on compressor of 5 years
Limited warranty on Environ Coil System of 3 years
Limited warranty on High Performance Economizer of 5 years
Limited warranty on all other components of 1 year
See Limited Warranty Certificate included with unit for details
Limited warranty on Lennox® CORE Control System of 3 years



Lennox National Accounts Project Submittal

| Corner Weights (lb) | | | | | | | | Center of Gravity (in.) | | | |
|---------------------|-----|------|-----|------|-----|------|-----|-------------------------|-------|-------|-------|
| AA | | BB | | CC | | DD | | EE | | FF | |
| Base | Max | Base | Max | Base | Max | Base | Max | Base | Max | Base | Max |
| 519 | 628 | 611 | 702 | 796 | 821 | 676 | 735 | 58.25 | 56.87 | 39.57 | 42.00 |

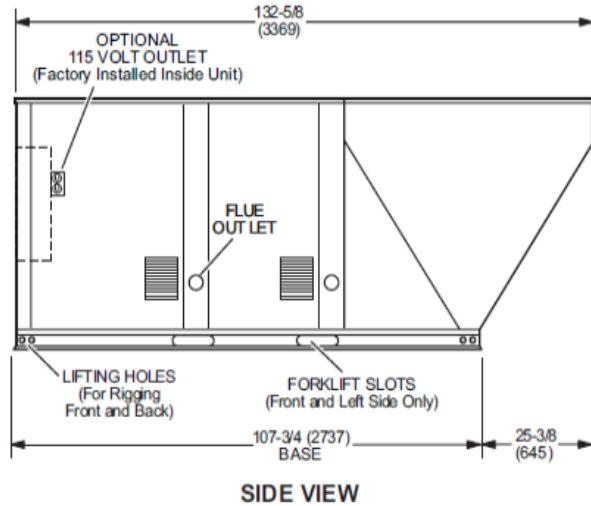
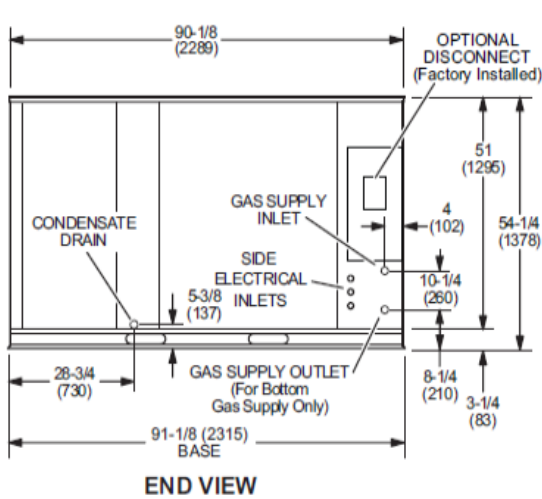
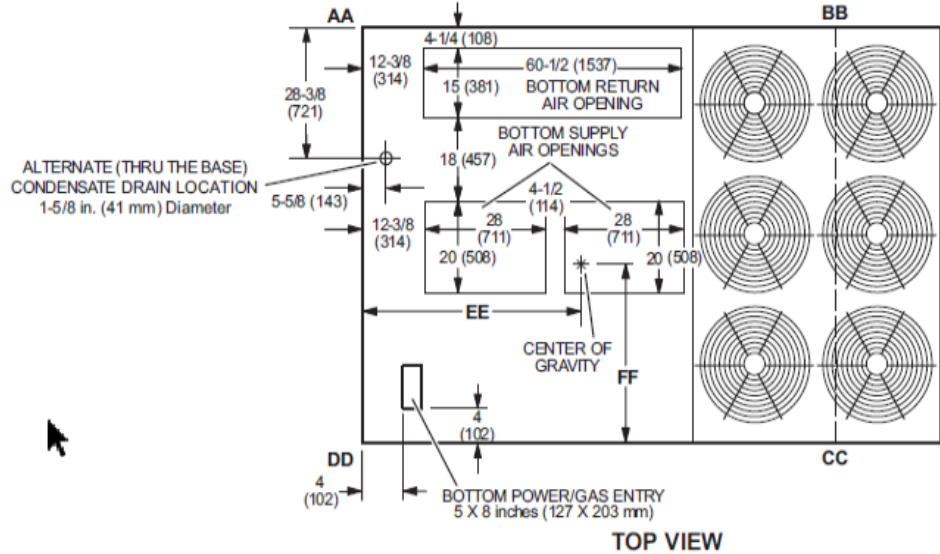



Lennox National Accounts Project Submittal

OUTDOOR AIR HOOD DETAIL

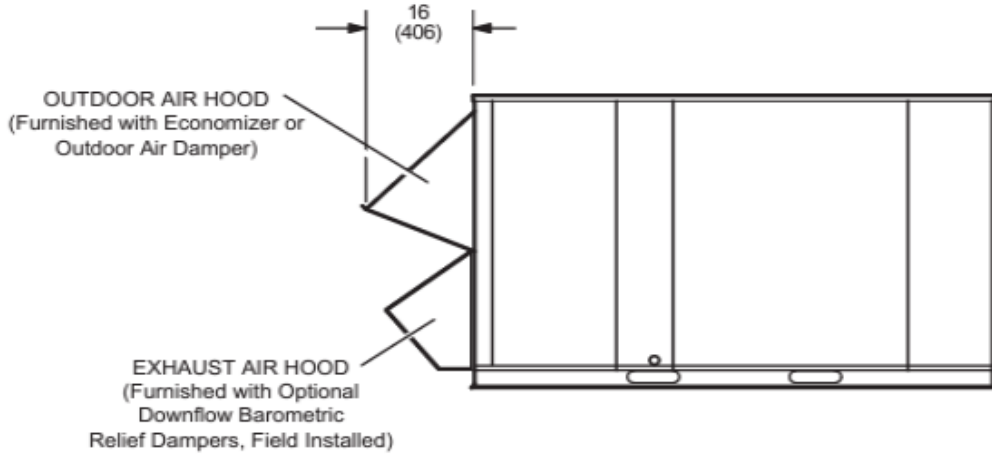

OPTIONAL HORIZONTAL BAROMETRIC RELIEF DAMPERS WITH HOOD (Field installed in horizontal return air duct adjacent to unit)

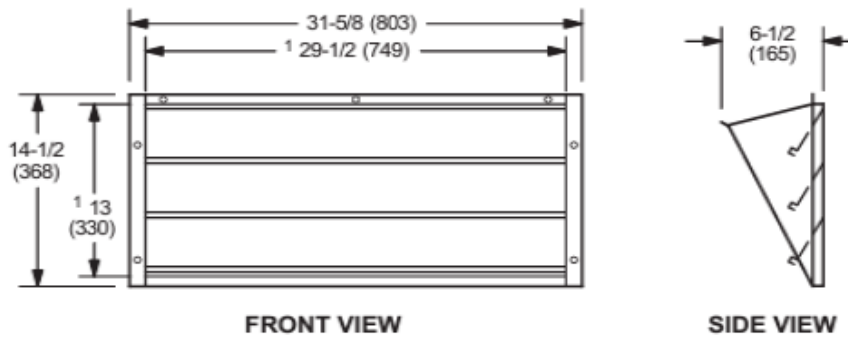

NOTE - Two furnished per order no.
1 NOTE - Opening size required in return air duct.



Lennox National Accounts Project Submittal

HYBRID ROOF CURBS - DOUBLE DUCT OPENING

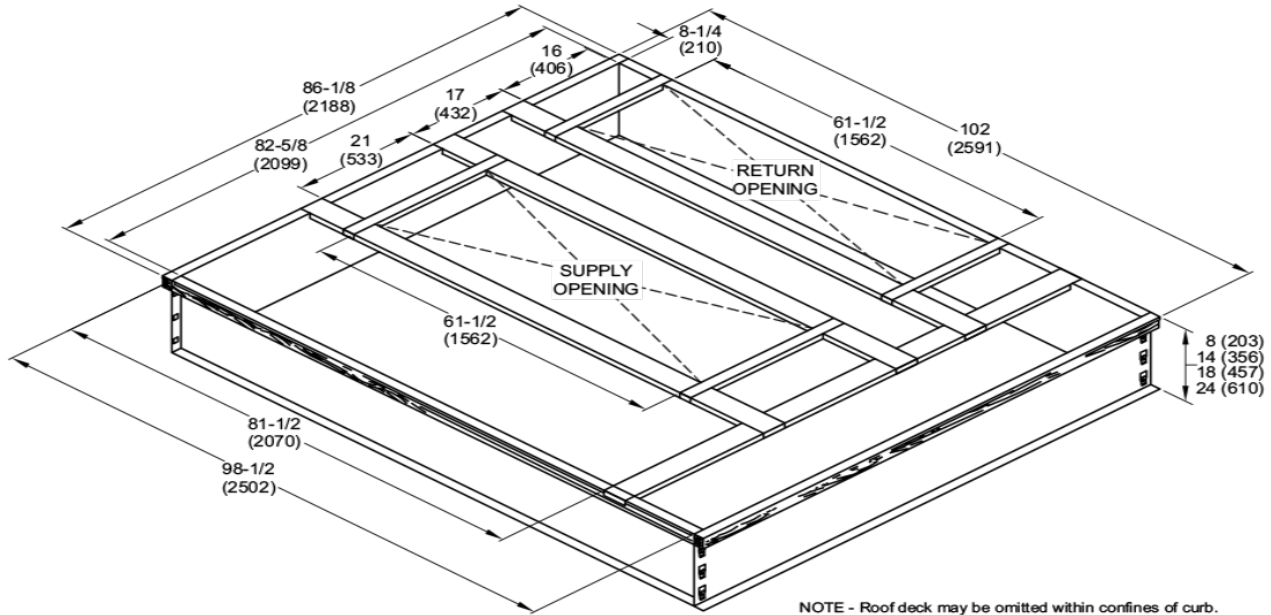

TYPICAL FLASHING DETAIL FOR ROOF CURB

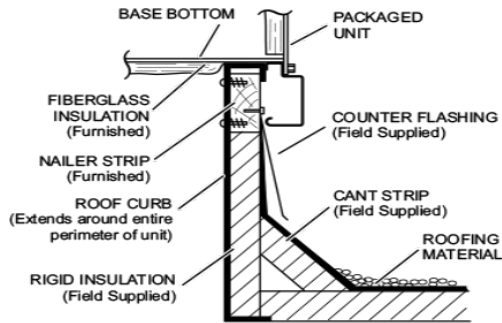

DETAIL ROOF CURB

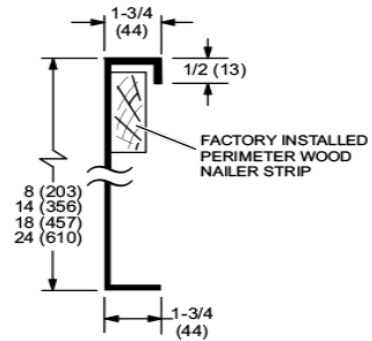



Lennox National Accounts Project Submittal

Unit With Economizer

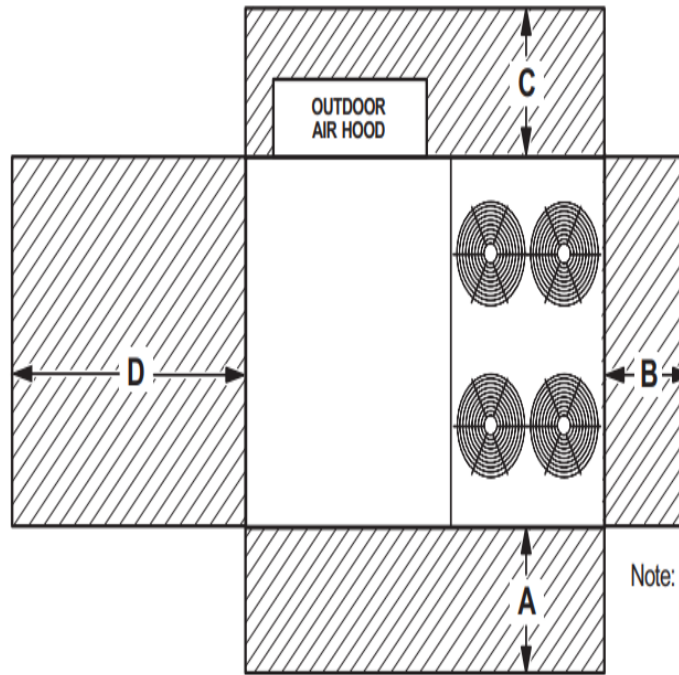

Note: Models with four outdoor fans shown.
Dimension clearances are for all sizes.

| 1 Unit Clearance | A | | B | | C | | D | | Top Clearance |
|------------------------------------|-----|------|-----|-----|-----|-----|-----|------|---------------|
| | in. | mm | in. | mm | in. | mm | in. | mm | |
| Service Clearance | 60 | 1524 | 36 | 914 | 36 | 934 | 66 | 1676 | Unobstructed |
| Clearance to Combustibles | 36 | 914 | 1 | 25 | 1 | 25 | 1 | 25 | |
| Minimum Operation Clearance | 45 | 1143 | 36 | 914 | 36 | 914 | 41 | 1041 | |

NOTE - Entire perimeter of unit base requires support when elevated above the mounting surface.

¹ **Service Clearance** - Required for removal of serviceable parts.

Clearance to Combustibles - Required clearance to combustible material.

Minimum Operation Clearance - Required clearance for proper unit operation.



Lennox National Accounts Project Submittal

17G74: COMFORTSENSE® 7500 COMMERCIAL 7 DAY PROGRAMMABLE THERMOSTAT

| | |
|---------------------|---|
| Accessory | X |
| Duct Mount | X |
| Wall Mount | ✓ |
| Outdoor | X |
| Thermostat | ✓ |
| Temperature Sensing | ✓ |
| CO2 Sensing | X |
| RH Sensing | ✓ |
| Light Sensing | X |
| Pressure Sensing | X |
| Smoke Sensing | X |
| Communicating | X |
| Display | ✓ |



Precise, sophisticated control for conventional systems and heat pumps

The Lennox® ComfortSense line of programmable thermostats can help your customers manage their heating and cooling schedule, and their energy costs, without sacrificing comfort. The thermostat allows for the detection of economizer faults generated by the RTU's service relay, fulfilling FDD regulations and improving serviceability of Lennox rooftop units.

Energy Efficiency

- Programmable - 7-Day or 5-Day/2-Day - Versatile programming options offer custom comfort and energy savings
- Dual-fuel capability - Increases the efficiency of dual-fuel heating systems by automatically alternating between gas and electric operation
- One-Touch Away Mode - Turns down heating or cooling with one touch to save energy when the user is away
- Energy Reports - Show how often and how long the heating or cooling system has run

Enhanced Comfort

- Automatic changeover - decides between heating and cooling operation, depending on indoor temperature
- Built-in temperature and humidity sensors
- Smooth Setback Recovery - pre-cools a space to reach the desired setpoint temperature as soon as the scheduled period begins

Reliable Performance

- Touchscreen display - large (4.3"), easy-to-use display with adjustable brightness
- Customizable reminders - allow you to set a series of service and parts replacement reminders which display on the home screen
- Filter Reminder - Reminds the user when it is time to change the filter
- Outdoor temperature display - requires optional outdoor sensor
- Universal thermostat - Works with conventional systems and heat pumps and supports up to 4 stages of heat and 2 stages of cooling
- Compatible with Lennox-brand non-communicating equipment and most other brands of heating and cooling equipment



Lennox National Accounts Project Submittal

| SPECIFICATIONS - COMFORTSENSE7500 | | |
|-----------------------------------|--|--------------|
| Product Depth | 7/8 IN | |
| Product Height | 3-5/16 IN | |
| Product Width | 4-5/16 IN | |
| Gross Weight | 0.6 LB | |
| Hertz | 50/60 Hz | |
| Programs per Week | 7 Day | |
| Changeover | Auto changeover | |
| Wi-Fi Enabled | No WiFi | |
| Stages | Universal 4 Heat/2 Cool | |
| Temperature Setting Range | <ul style="list-style-type: none"> • Heating - 45 to 90°F • Cooling - 45 to 99°F | |
| Humidity Settings | <ul style="list-style-type: none"> • Operating range - 10 to 90% relative humidity • Humidity setpoint (Dehumidification) - 45 to 60% relative humidity, default 50% | |
| Power Supply | 24VAC (18 to 30VAC maximum), 50/60Hz | |
| Clock Accuracy | ± 10 minutes per year | |
| ACCESSORIES | | |
| Sensors/Accessories | Remote non-adjustable wall-mount 20k | 47W36 |
| | Remote non-adjustable wall-mount 10k | 47W37 |
| | Remote non-adjustable discharge air (duct mount) | 19L22 |
| | Outdoor temperature sensor | X2658 |



Lennox National Accounts Project Submittal

