

HOOD INFORMATION																	
HOOD NO.	MARK	MODEL	HOOD DIMENSIONS (IN.)			HOOD CONSTR.	COOKING LOAD / DUTY RATING	EXHAUST					SUPPLY		HANGING WEIGHT LBS.	SECTION LOCATION	
			LENGTH	WIDTH	HEIGHT			TOTAL CFM	COLLAR(S)			MUA CFM	AC CFM				
1	HOOD-1	XXEW-153-S	153	54	24	430 SS WHERE EXPOSED	HEAVY	2550	10	24		2550	0.483	1300	700	732	SINGLE

HOOD INFORMATION															
HOOD NO.	MARK	LIGHTING DETAILS				GREASE FILTRATION DETAILS				UTILITY CABINET(S)					
		FIXTURE TYPE BULB / LAMP INFO		QTY	FOOT CANDLES	TYPE / MODEL MATERIAL		QTY	SIZE (IN.) L H	LOCATION	FIRE SYSTEM		CONTROLS		
1	HOOD-1	INCANDESCENT (GLOBE) 100W A19 (BULBS NOT INCL.)		8	54.77	X-TRACTOR (SPARK ARRESTOR INCL.) STAINLESS STEEL		2	16 20	20	RIGHT	ANSUL R102	6	XKC	MB TOUCHSCREEN

SUPPLY PLENUM INFORMATION																		
HOOD NO.	MARK	POS.	TYPE	SIZE (IN.)			INSULATED	DAMPER(S)	LED LIGHT(S)		TOTAL CFM	TOTAL S.P.	COLLARS					
				L	W	H			SUPPLIED	QTY			TYPE	MOUNTING	QTY	W	L	DIA.
1	HOOD-1	FRONT	SPLIT ASF	82.5	14	4	NO	NO		650	0	MUA	FACTORY	2	12	28	325	139
				82.5	10	4	YES	YES		350	0.02	AC	FACTORY	3			117	335
1	HOOD-1	FRONT	SPLIT ASF	82.5	14	4	NO	NO		650	0	MUA	FACTORY	2	12	28	325	139
				82.5	10	4	YES	YES		350	0.02	AC	FACTORY	3			117	335

HOOD OPTIONS

- UL 710 LISTED W/ OUT EXHAUST FIRE DAMPER - UL #R25625
- BACK INTEGRAL AIR SPACE - 3 IN WIDE - ZERO CLEARANCE
- 10 IN HIGH CEILING ENCLOSURES - FRONT LEFT RIGHT - FIELD INSTALLED
- FACTORY MOUNTED EXHAUST COLLAR(S)
- LEFT INSULD END PNL W/ ADJ LEG 80 IN HIGH 27.00 IN TOP WIDTH 21.0 IN BOTTOM WIDTH
- RIGHT INSULD END PNL W/ ADJ LEG 80 IN HIGH 27.00 IN TOP WIDTH 21.0 IN BOTTOM WIDTH
- PERFORMANCE ENHANCING LIP (PEL) TECHNOLOGY
- STANDING SEAM CONSTRUCTION FOR SUPERIOR STRENGTH

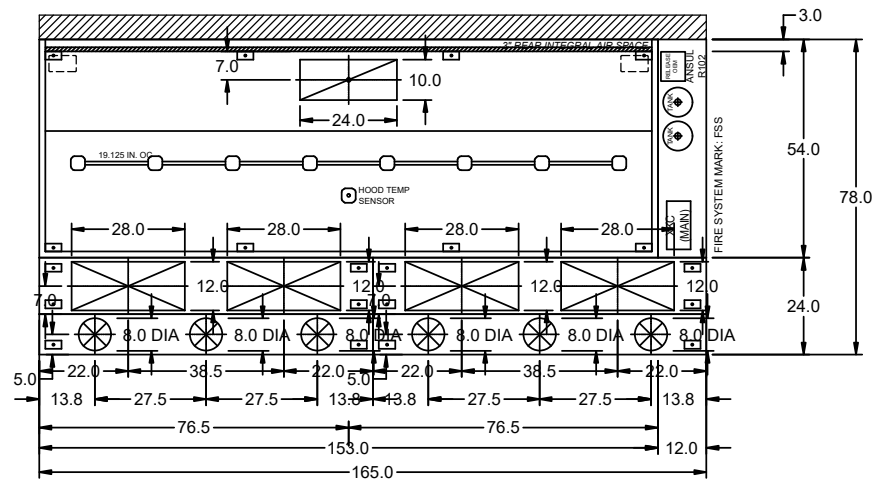

FIRE (PIPING/DROPS/NOZZLES/ETC.) SUBJECT TO CHANGE. AS-BUILT DRAWINGS CAN BE PROVIDED AT TIME OF ORDER AND INCLUDED WITH PRODUCT SHIPMENT

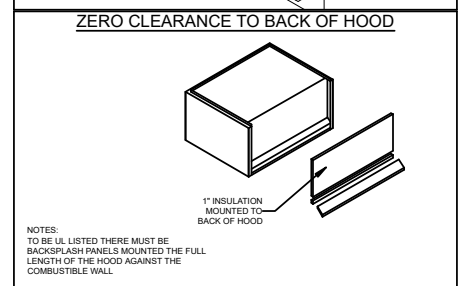
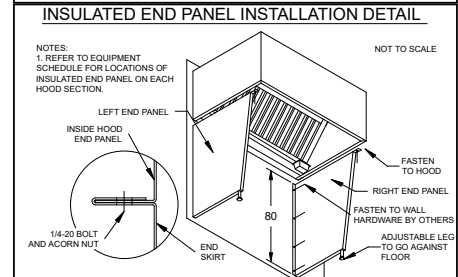
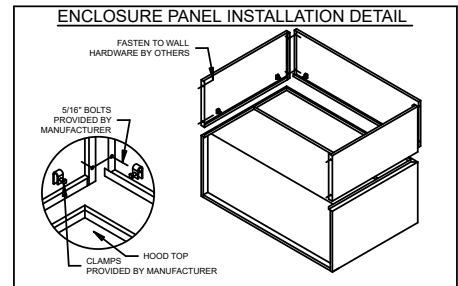
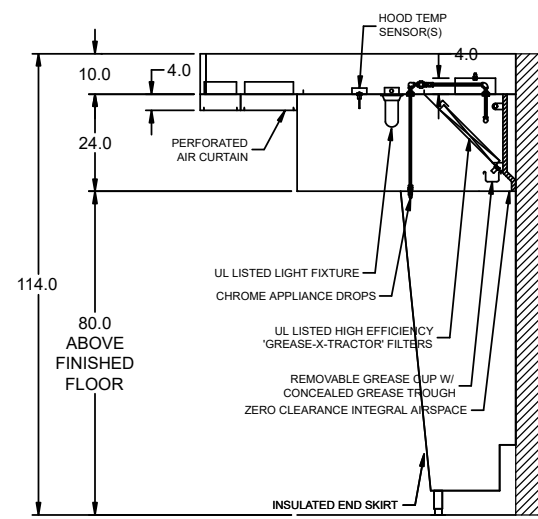
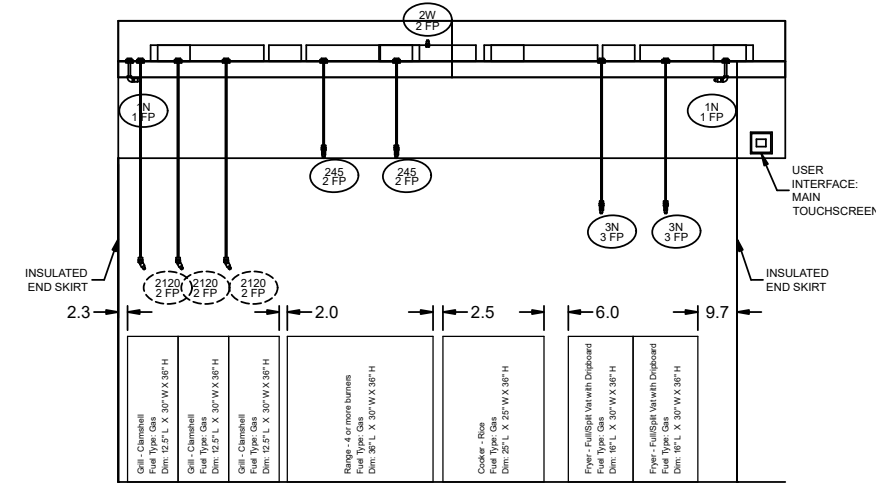

HOOD HANGING HEIGHT FOR FIRE SYSTEMS
 VERIFICATION OF HOOD HANGING HEIGHT ABOVE FINISHED FLOOR (A.F.F.) IS REQUIRED FOR CORRECT PLACEMENT OF FIRE SYSTEM NOZZLES.

- RECOMMENDED HANGING HEIGHT = 80" FROM FINISHED FLOOR TO LOWER FRONT EDGE OF HOOD.
- OTHER HANGING HEIGHT = * FROM FINISHED FLOOR TO LOWER EDGE OF HOOD.

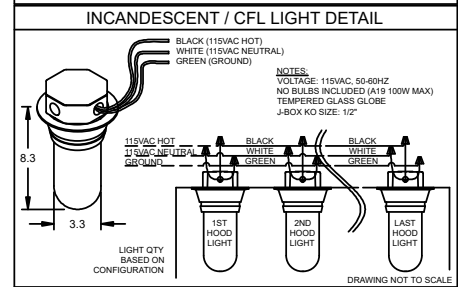
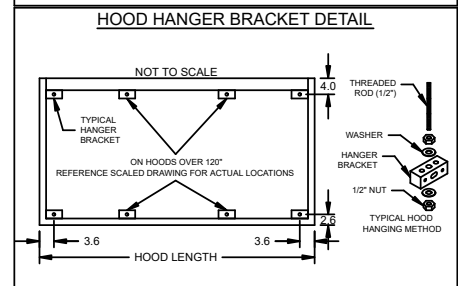
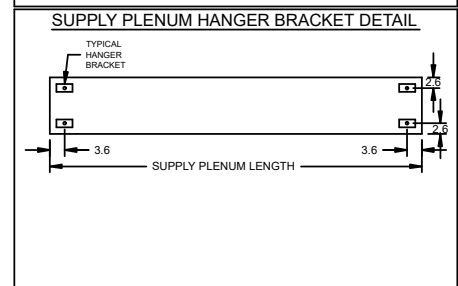

Direct Drive Centrifugal Roof Exhaust Fan

MARK INFORMATION		FAN INFORMATION									SOUND INFORMATION					MOTOR INFORMATION								
MARK	QTY	MODEL	DRIVE TYPE	VOLUME (CFM)	EXTERNAL SP (IN. WG)	TOTAL EXTERNAL SP (IN. WG)	FAN SPEED (RPM)	OUTLET VELOCITY (FT/MIN)	FEI	TOTAL WEIGHT (LB)	INLET dBA	INLET SONES	INLET SONES (SPHERICAL)	OUTLET dBA	OUTLET SONES	OPERATING POWER (HP)	MOTOR SIZE (HP)	FEP INPUT POWER (KW)	ENCLOSURE	VOLTAGE	CYCLE	PHASE	EC MOTOR	NEC FLA*
EF-2 (Restroom)	1	XRED-097-VG	Direct	150	0.6	0.6	1,317	156.25	0	43.2	51.64	6.13	0	0	0	0.05	0.25	0	TN	115	60	1	VariGreen	5.8

*NEC FLA - Based on table 430.250 or 430.248 of National Electrical Code 2020. Actual motor FLA may vary for sizing thermal overload, consult factory"

EF-2 (Restroom) : SELECTED OPTIONS AND ACCESSORIES

Curb Cap Size - 19 Square
 UL/cUL 705 Listed - "Power Ventilators"
 Switch, NEMA-1, Toggle,
 Damper Shipped Loose, BD-100-PB-12X12, Gravity Operated, Not Coated, Nominal Size
 Birdscreen: Galvanized, nom. 84% Free Area
 Conduit Chase Qty 1

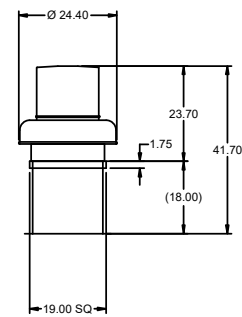
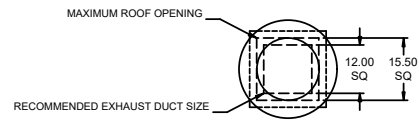

DUCT DIMENSIONS ARE LARGEST POSSIBLE DUCT TO FIT THROUGH CURB.
 CONSULT SYSTEM DESIGN ENGINEER FOR RECOMMENDED DUCT SIZE.
 OVERALL HEIGHT MAY BE GREATER DEPENDING ON MOTOR, ADAPTER, AND/OR HINGE BASE.

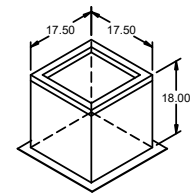
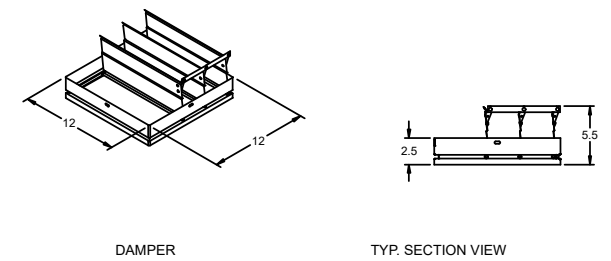

PROJECT
12/16/2025
MARK
CHIPOTLE-CELINA 4895
EF-2 (RESTROOM)

DIRECT CHAIN ACX
 JOE AYOUB
 JOE.AYOUB@ACCUREX.COM
 (857)272-8727

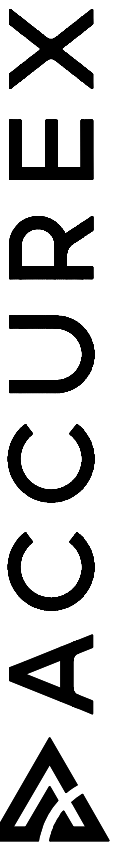

CONTROL INFORMATION

MARK	MAIN ELECTRICAL CONTROL PACKAGE		MAIN USER INTERFACE		FANS CONTROLLED											
	MODEL	LOCATION	TYPE	LOCATION	FAN #	TYPE	FAN	FAN MARK	ZONE	CFM	MOTOR HP	MOTOR VOLT	CYCLE	MOTOR PHASE	MOTOR STARTER IN PANEL	VFD IN PANEL
HOOD CONTROLS	XKC-CV-SB-11-1-0	RIGHT CABINET ON HOOD-1	FULL COLOR TOUCHSCREEN	CABINET - RIGHT CABINET ON HOOD-1	1	EXHAUST	E1	EF-1 (HOOD-1)	1	2550	2	208	60	1	NO	NO
					2	SUPPLY	S1	MAU-1	1	1300	1	115	60	1	NO	NO

CONTROL FEATURES
 HOOD LIGHT CONTROL
 TEMP SENSORS (FACTORY INSTALLED) - QTY. 1
 DRY FIRE CONTACTS - QTY. 2
 LIGHTS OFF DURING FIRE
 EXHAUST MAX DURING FIRE
 SUPPLY OFF DURING FIRE
 BMS INTEGRATION - BACNET MSTP

SPECIAL DESIGN REQUESTS
 SDR #K2300291-1 - APPLIANCE CONTACTORS - 20A



DOC NUMBER: --- REV: ---

CAUTION
 UNIT MUST BE GROUNDED IN ACCORDANCE WITH N.E.C. POWER MUST BE OFF WHILE SERVICING.

ATTENTION
 L'APPAREIL DOIT ÊTRE MIS À LA TERRE CONFORMÉMENT AU CODE C.E. L'ALIMENTATION DOIT ÊTRE COUPÉE DURANT L'ENTRETIEN.

COMMERCIAL APPLIANCE OUTLET CENTER
 ELECTRICAL RATINGS: 110-240V, 1PHASE, 50-60HZ, 15A
 BASE FILE #E200616, ML FILE #E313951

PRG VERSION: V5
 FIELD WIRING (CÂBLAGE LOCAL/LEMENT) FACTORY WIRING (CÂBLAGE À L'USINE)

NE PAS RETIRER CES DESSINS DE CET ÉQUIPEMENT SAUF INDICATION CONTRAIRE. UTILISER DES CONDUCTEURS EN CUIVRE CLASSÉS 90 °C. SERRER LES BORNES DE COMMANDE ET DE MISE À LA TERRE À 8 LB-PO. SERRER LES COSSÉS/VIS D'ALIMENTATION AUX COUPLES INDICUÉS POUR LE COMPOSANT. SERRER LES BORNES À VIS DE LA CARTE DE COMMANDE À 3.5 LB-PO. LA RÉSISTANCE DU CÂBLAGE DE COMMANDE LOCAL NE DOIT PAS DÉPASSER 0.75 OHM. POUR PLUS D'INFORMATION, CONSULTER LE MANUEL OU APPELER 1-800-371-8858.

WIRING DIAGRAM CODE: WDC#
 JOB NAME: CHIPOTLE-CELINA 4895
 MODEL: XKC-CV-SB-11-1-0
 SERIAL NUMBER: WDSN#
 MARK: HOOD CONTROLS

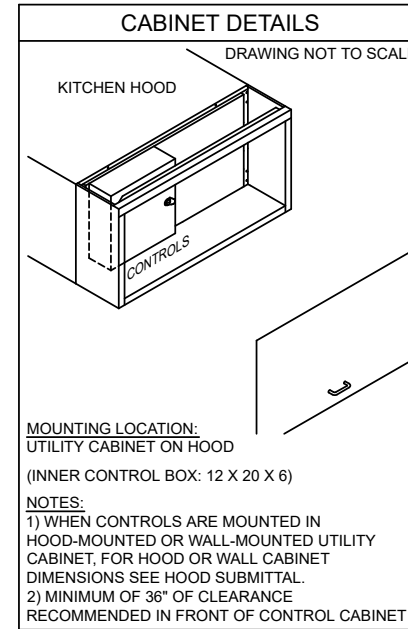
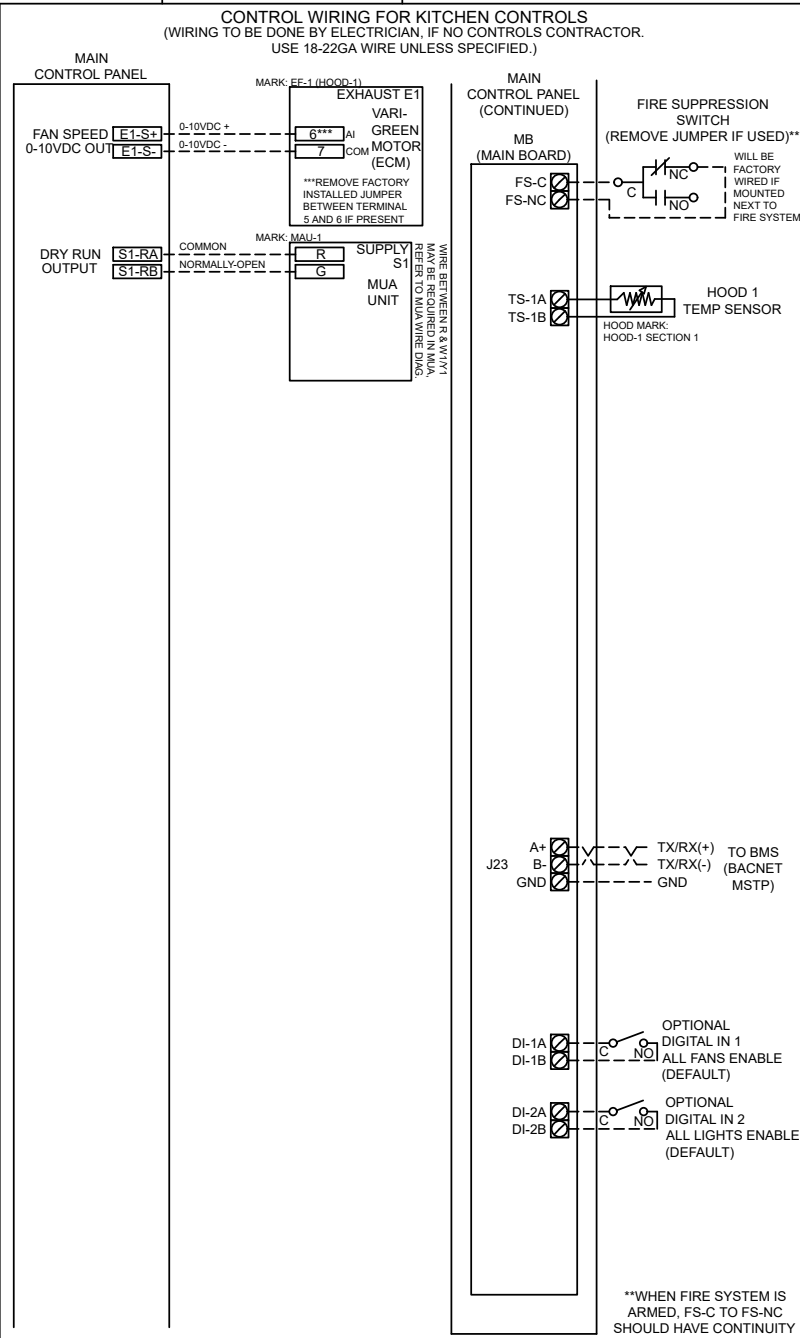
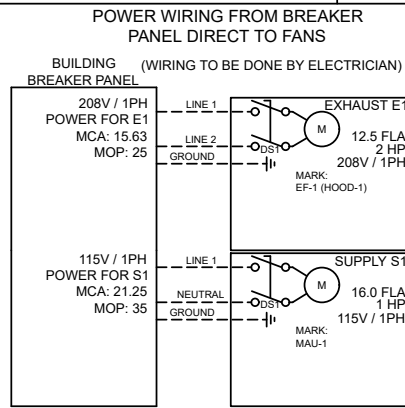
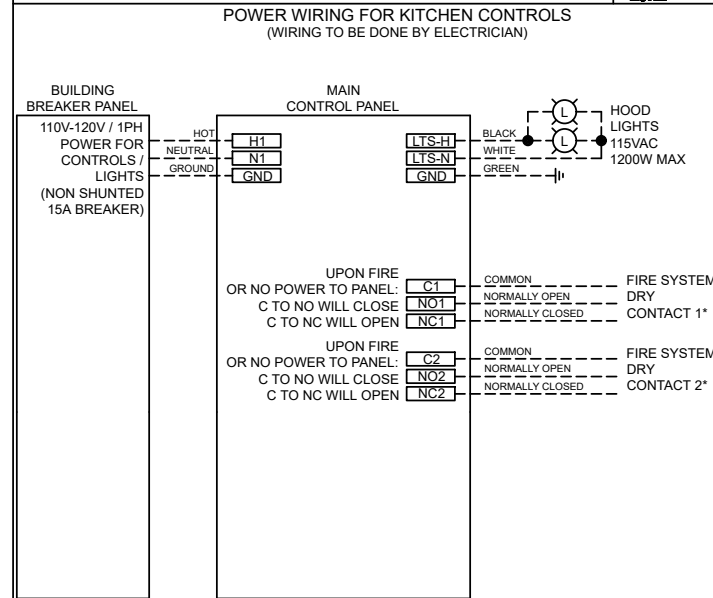

MAIN USER INTERFACE DETAILS

MOUNTING TYPE:
 FACTORY MOUNTED:
 UTILITY CABINET - RIGHT END OF HOOD

USER INTERFACE CONTROL:
 FANS AND LIGHTS

INTERFACE CABLE LENGTH:
 7FT (FACTORY PROVIDED)

MOUNTING LOCATION:
 UTILITY CABINET ON HOOD
 (INNER CONTROL BOX: 12 X 20 X 6)

NOTES:
 1) WHEN CONTROLS ARE MOUNTED IN HOOD-MOUNTED OR WALL-MOUNTED UTILITY CABINET, FOR HOOD OR WALL CABINET DIMENSIONS SEE HOOD SUBMITTAL.
 2) MINIMUM OF 36" OF CLEARANCE RECOMMENDED IN FRONT OF CONTROL CABINET

FACTORY SETTINGS
 TYPE: CV
 CONFIGURATION: STANDARD
 ZONES: 1
 HOODS: 1
 EXHAUST FANS: 1
 SUPPLY FANS: 1
 MB ROOM SENSOR: NO
 MB TEMP SENSORS: 1
 HIGH TEMP FAULT: NO
 FREEZE PROTECTION: YES
 MB GAS RESET: NO
 FAN PROVING: NO
 BMS: BACNET MSTP

EXHAUST FAN SETTINGS
 SEE FAN CONFIGURATION TABLE BELOW

SUPPLY FAN SETTINGS
 SEE FAN CONFIGURATION TABLE BELOW

SENSOR SETTINGS
 SEE HOOD CONFIGURATION TABLE BELOW

USER INTERFACE SETTINGS (MB)
 FAN & LIGHT BUTTONS: SHOW BOTH (SEPERATE)

GENERAL SETTINGS
 TIME ZONE: CENTRAL DAYLIGHT (DEFAULT)

MB FIRE/FAULT SETTINGS
 EXHAUST DURING FIRE: MAX
 SUPPLY DURING FIRE: OFF
 LIGHTS DURING FIRE: OFF

WIRING DIAGRAM CODE: WDC#
 JOB NAME: CHIPOTLE-CELINA 4895
 MODEL: XKC-CV-SB-11-1-0
 SERIAL NUMBER: WDSN#
 MARK: HOOD CONTROLS
 DOC NUMBER: --- REV: --- PRG VERSION: V5

ZONE CONFIGURATION

ZONE #	ZONE	ROOM TEMP
1	Z1	PRESET

HOOD CONFIGURATION

HOOD #	HOOD	HOOD MARK	ZONE	EXH A	EXH B	SUPPLY	MB TEMP SENSORS
1	H1	HOOD-1 SECTION 1	Z1	E1	-	S1	TS1

FAN CONFIGURATION

FAN #	TYPE	FAN	FAN MARK	ZONE	MIN CFM	MAX CFM	MODBUS VFD	VFD ADDRESS	MIN FREQ	MAX FREQ	MIN VDC	MAX VDC
1	EXHAUST	E1	EF-1 (HOOD-1)	Z1	-	2550	NO	-	-	-	-	7.8
2	SUPPLY	S1	MAU-1	Z1	-	1300	NO	-	-	-	-	10.0

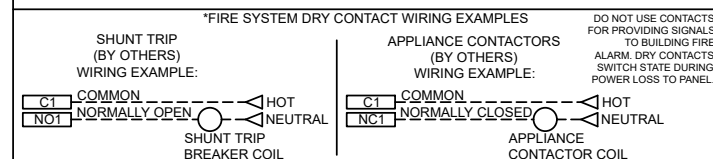

PROJECT: 12/8/2025
 MARK: HOOD CONTROLS

CHIPOTLE-CELINA 4895

DIRECT CHAIN ACX
 JOE AYUB
 JOE.AYUB@ACCUREX.COM
 (857)272-8727

ACCUREX

FIRE SYSTEM INFORMATION

MARK	MODEL	LOCATION	FLOW POINTS		SUPPLY LINE	DETECTION	MARK(S) PROTECTED BY FIRE SYSTEM
			HOODS	PCU			
FSS	ANSUL R-102 WET CHEMICAL	CABINET – RIGHT END OF HOOD-1	20 UTILIZED 22 AVAILABLE		CONTINUOUS	FUSIBLE LINK	HOOD-1 SECTION 1

FIRE SYSTEM OPTIONS AND ACCESSORIES

FULL INSTALLATION (INCLUDES PRE-PIPED HOOD(S) WITH DETECTION AND FACTORY COORDINATED INSTALL)
 CHROME SLEEVES FOR FACTORY PROVIDED APPLIANCES DROPS - INCLUDED
 METAL BLOW-OFF CAPS - INCLUDED
 GAS VALVE - INCLUDED - ELECTRICAL SHUTOFF VALVE, 1.5", 110V, 60HZ - PART# 455396
 HOOD SUPPRESSION TANK - INCLUDED - 6 GAL. - [(2) 3.0 TANK(S)]
 REMOTE PULL STATION - STANDARD - FIELD INSTALLATION AT SINGLE POINT OF EGRESS

ANSUL R102 (WET CHEMICAL) FIRE PROTECTION SYSTEM - MODEL FSSC

CONTROL PANEL

WIRING DIAGRAM FOR MICRO SWITCHES

WIRING DIAGRAM FOR MANUAL RESET RELAY (ELECTRIC GAS VALVE ONLY)

NOTES:

WET CHEMICAL FIRE PROTECTION SYSTEM TO BE ANSUL R-102, DESIGNED IN COMPLIANCE WITH UL 300 REQUIREMENTS.

- VERIFICATION OF ALL COOKING EQUIPMENT MAKE, MODEL AND LOCATION REQUIRED FOR ALL FIRE PROTECTION SYSTEMS.
- ALL FIRE SYSTEM PIPING IS STANDARDLY TO THE RIGHT END OF THE HOOD UNLESS A WALL IS LOCATED ON THE RIGHT END.
- ANSUL AUTOMAN RELEASE TO BE LOCATED WITHIN 60" OF HOOD.

THE BASIC FIRE SYSTEM WILL INCLUDE THE FOLLOWING:

- GAS SHUT-OFF VALVE, IF REQUIRED, TO BE SUPPLIED BY MANUFACTURER (UP TO 2" DIAMETER AS STANDARD), AND INSTALLED BY A LICENSED PLUMBER.
- MICRO SWITCH TO BE SUPPLIED BY MANUFACTURER FOR CONNECTION TO, BUT NOT LIMITED TO, BUILDING ALARM SYSTEM(S), EXHAUST AND SUPPLY FANS AND ELECTRICAL POWER SHUT DOWN. FIELD WIRING AND CONNECTIONS TO BE PERFORMED BY A LICENSED ELECTRICIAN.

THE BASIC FIRE SYSTEM DOES NOT INCLUDE THE FOLLOWING:

- FULL DUMP TEST OTHER THAN WHAT IS SPECIFIED PER THE INSTALLATION MANUAL, OR TO SATISFY A STATE OR LOCAL CODE. PERMIT AND TESTING FEES ARE NOT INCLUDED UNLESS NOTED UNDER THE EQUIPMENT SCHEDULE FOR THE FIRE SYSTEM.
- MORE THAN TWO TRIPS TO THE JOBSITE OR SPECIAL TRANSPORTATION, OR OVERNIGHT LODGING REQUIREMENTS IN REMOTE AREAS. NORMAL TRAVEL DISTANCE IS FIRST 50 MI. (80.5 KM) FROM OFFICE.
- SPECIAL CLASSES OR ADDITIONAL LABOR FOR ACCESS TO SECURITY SENSITIVE AREAS.
- INSTALLATION OF GAS SHUT-OFF VALVE.
- SPECIAL DRAWINGS REQUIRED TO SATISFY STATE OR LOCAL CODE. PLAN EXAMINATION FEES, PE OR P'S APPROVAL STAMP.
- UNION LABOR, GOVERNMENT LABOR, OR PREVAILING WAGES REQUIRED FOR FINAL FIELD HOOK-UP.
- ANY AND ALL ELECTRICAL COMPONENTS/CONNECTIONS REQUIRED TO SHUT DOWN FANS, SHUT OFF DEVICE FOR ELECTRIC COOKING EQUIPMENT (SHUNT TRIP BREAKER), OR ACTIVATE AN ALARM SYSTEM, ETC.
- ANY DISMANTLING OR REASSEMBLY REQUIRED TO GAIN ACCESS TO THE FIRE SUPPRESSION PIPING LOCATED ON THE TOP OF THE HOOD.
- ROUGH-IN HIDDEN CONDUIT FOR REMOTE PULL STATION OR GAS VALVE (FLUSH MOUNTED PULL STATION).
- INSTALLATION OF MORE THAN (1) REMOTE PULL STATIONS OR DISTANCES GREATER THAN 20 FT (6.1M).
- PARTS OR LABOR REQUIRED TO CORRECT PIPING DUE TO COOKING EQUIPMENT CHANGES OR DEVIATION FROM PLANS. OR ANY CHARGES FOR MISSING OR ADDITIONAL PARTS OTHER THAN THOSE INDICATED ON THE FIRE SUPPRESSION DETAIL.

IF ELECTRIC RELEASE, BOTH UPPER SWITCHES WILL BE USED FOR ACTUATING ADDITIONAL AUTOMANS (THEY WILL BE WIRED TO EACH OTHER AND TO THE BROWN WIRE ON THE ELECTRIC SOLENOID). THEREFORE, USE ONE OF THE UN-UTILIZED LOWER SWITCHES TO WIRE BACK TO CONTROL PANEL (DO NOT USE EITHER OF THE UPPER SWITCHES).

IF USING LOWER SWITCHES TO WIRE BACK TO CONTROL PANEL, NORMALLY-CLOSED WILL BE BLACK LEAD, AND NORMALLY-OPEN WILL BE BROWN LEAD.

DPDT SWITCHES PROVIDED BY MANUFACTURER MAY BE WIRED PER TYPICAL EXAMPLES SHOWN. VERIFY WITH LOCAL CODES AND EQUIPMENT SUPPLIED AS THE CONNECTION NEEDED FOR YOUR INSTALLATION.

CONNECTION TO BUILDINGS ALARM

CONNECTION TO KC (PCB) CONTROL PANEL

NOTES:

- 1. --- DENOTES FIELD INSTALLATION.
- 2. ——— DENOTES FACTORY INSTALLATION.

PROJECT
12/8/2025

MARK

DIRECT CHAIN ACX
JOE AYUB
JOE.AYUB@ACCUREX.COM
(857)272-8727

ANSUL R102 (WET CHEMICAL) FIRE PROTECTION SYSTEM - MODEL FSSC

UL LISTED

CHIPOTLE-CELINA 4895

FSS

ACCUREX

Direct Drive Upblast Centrifugal Roof Exhaust Fan

MARK INFORMATION		FAN INFORMATION									SOUND INFORMATION					MOTOR INFORMATION								
MARK	QTY	MODEL	DRIVE TYPE	VOLUME (CFM)	EXTERNAL SP (IN. WG)	TOTAL EXTERNAL SP (IN. WG)	FAN SPEED (RPM)	OUTLET VELOCITY (FT/MIN)	FEI	TOTAL WEIGHT (LB)	INLET dBA	INLET SONES	INLET SONES (SPHERICAL)	OUTLET dBA	OUTLET SONES	OPERATING POWER (HP)	MOTOR SIZE (HP)	FEP INPUT POWER (KW)	ENCLOSURE	VOLTAGE	CYCLE	PHASE	EC MOTOR	NEC FLA*
EF-1 (Hood-1)	1	XCUE-160-VG	Direct	2,550	1.2	1.2	1,334	1,482.56	1.4	105	68.8	16.88	0	0	0	0.87	2	0.78	TF	208	60	1	VariGreen	13.2

*NEC FLA - Based on table 430.250 or 430.248 of National Electrical Code 2020. Actual motor FLA may vary for sizing thermal overload, consult factory"

EF-1 (Hood-1) : SELECTED OPTIONS AND ACCESSORIES

One piece fully welded windband
 Tapered bushing wheel hub
 Breather tube outlet area min. 4.4 sq. in. (sizes 99-480), 2.0 sq. in. (sizes 60-95)
 Min. windband material thickness: 0.051" aluminum (060-240), 0.064" aluminum (240HP, 240XP), 0.080" aluminum (sizes 300-480)
 Curb Cap Size - 26 Square
 UL/cUL 705 Listed - Supplement SC - "Power Ventilators for Restaurant Exh. Appliances" (Formerly UL 762)
 Switch, NEMA-3R, Toggle,
 Fastener Material: Stainless
 Aluminum Wheel Material

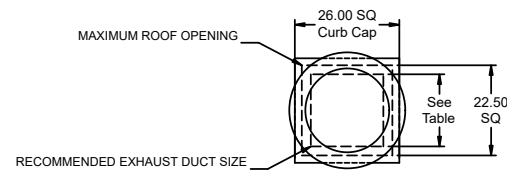

DUCT TYPE	SIZE
STANDARD	18 SQ
FIRE-WRAPPED	12 SQ

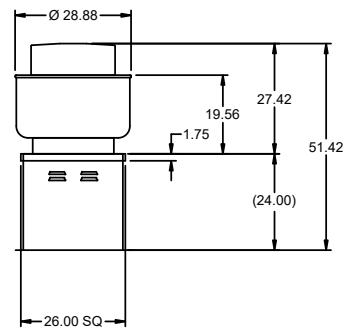

DUCT DIMENSIONS ARE LARGEST POSSIBLE DUCT TO FIT THROUGH CURB.
 CONSULT SYSTEM DESIGN ENGINEER FOR RECOMMENDED DUCT SIZE.

OVERALL HEIGHT MAY BE GREATER DEPENDING ON
 MOTOR, ADAPTER, AND/OR HINGE BASE.

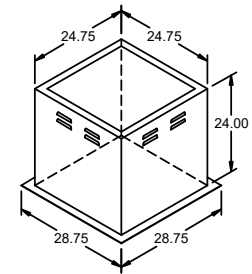

PROJECT
12/16/2025

MARK

CHIPOTLE-CELINA 4895

EF-1 (HOOD-1)

DIRECT CHAIN ACX
 JOE - AYUB
 JOE.AYUB@ACCUREX.COM
 (857)272-8727

